

A SECTION - STA. 11+630
 SCALE: H = 1:100 V = 1:50

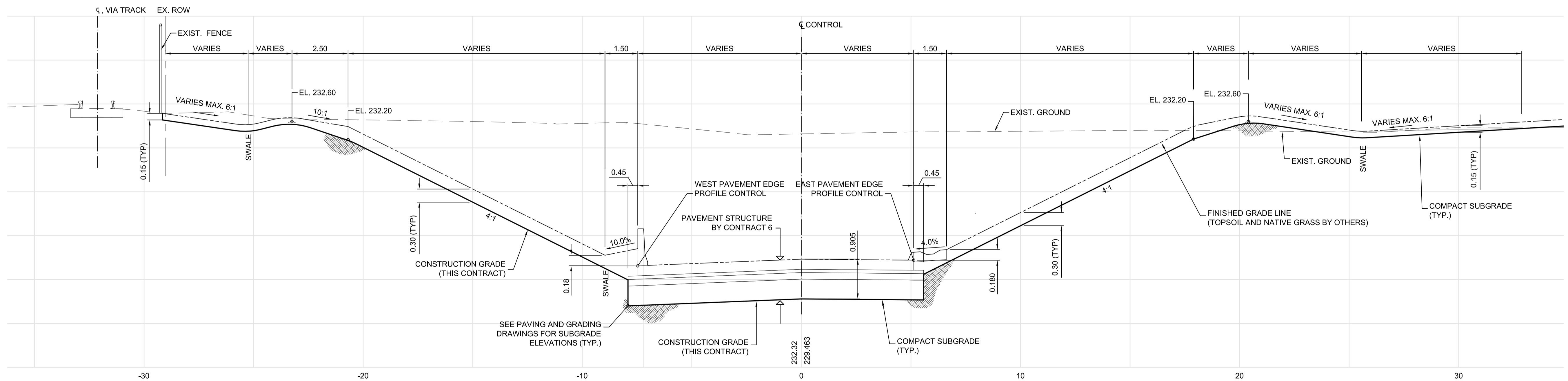

B SECTION - STA. 11+705.525
 SCALE: H = 1:100 V = 1:50

METRIC

WHOLE NUMBERS INDICATE MILLIMETRES
 DECIMALIZED NUMBERS INDICATE METRES.



LOCATION UNDERGROUND	APPROVED STRUCTURES	B.M. ELEV.
SUPV. U/G STRUCTURES COMMITTEE	DATE	
NOTE: LOCATION OF UNDERGROUND STRUCTURES AS SHOWN ARE BASED ON THE BEST INFORMATION AVAILABLE, BUT NO GUARANTEE IS GIVEN THAT ALL EXISTING UTILITIES ARE SHOWN OR THAT THE GIVEN LOCATIONS ARE EXACT. CONFIRMATION OF EXISTENCE AND EXACT LOCATION OF ALL SERVICES MUST BE OBTAINED FROM THE INDIVIDUAL UTILITIES BEFORE PROCEEDING WITH CONSTRUCTION.		
0	ISSUED FOR TENDER	10.13.2009 TJH
NO.	REVISIONS	DATE BY

DESIGNED BY	RTP
DRAWN BY	TJH/RTP
CHECKED BY	DPK
APPROVED BY	DPK
HOR. SCALE	1:100
VERTICAL	1:50
DATE	10/13/2009

RELEASED FOR CONSTRUCTION

DATE

ENGINEER'S SEAL
 PROVINCE OF MANITOBA
 ORIGINAL REGISTERED BY
D.P. KRAHN
 10/13/2009
 Member
 4226
 REGISTERED PROFESSIONAL ENGINEER

CONSULTANT PROJECT NO.
 088813

THE CITY OF WINNIPEG
 TRANSIT DEPARTMENT

Winnipeg

SOUTHWEST RAPID TRANSIT CORRIDOR - STAGE 1
 TRANSITWAY TUNNEL AT CN RIVERS SUBDIVISION
 MILEAGE 1.38 & ASSOCIATED WORKS

CITY DRAWING NUMBER
 U237-09-68

SHEET OF
 68 OF 73

CONSULTANT DRAWING NUMBER
 C4-C3006-T

CROSS SECTIONS - STA. 11+630 & 11+705.525