

**SEWER JUNCTION INFORMATION
FOR SEWER ID MA60013152**

REFERENCE—METERS NORTH OF MANHOLE MH60011590

DIST. FROM REF. MANHOLE	JUNCTION DIA.	CLOCK REF.	SERVICE TYPE	DESCRIPTION
4.5	150	01	JX	LIVE
6.0	150	09	JN	CAPPED
6.8	150	03	JN	CAPPED
10.2	150	10	CNI	LIVE
15.4	150	02	JN	
16.1	150	09	JN	CAPPED
33.8	150	02	JN	
33.9	150	10	JN	
34.7	150	03	JN	
35.4	150	10	CNI	

ALL JUNCTION INFORMATION
BASED ON CCTV INSPECTION

SEWER SERVICE INFORMATION

ADDRESS	SIZE	PROPERTY LINE LOCATION
#812 LYON ST RESIDENTIAL	NO INFORMATION	NO INFORMATION
#809 LYON ST RESIDENTIAL	NO INFORMATION	NO INFORMATION
#808 LYON ST RESIDENTIAL	NO INFORMATION	NO INFORMATION
#805 LYON ST RESIDENTIAL	NO INFORMATION	NO INFORMATION
#804 LYON ST RESIDENTIAL	NO INFORMATION	NO INFORMATION
#801 LYON ST RESIDENTIAL	NO INFORMATION	NO INFORMATION
#800 LYON ST RESIDENTIAL	NO INFORMATION	NO INFORMATION

WARNING

IF POWER EQUIPMENT OR EXPLOSIVES ARE TO BE USED FOR EXCAVATION ON THIS PROJECT THE CONTRACTOR MUST:

- 1) NOTIFY THE GAS COMPANY OF THE PROPOSED LOCATION OF EXCAVATION.
- 2) TAKE PRECAUTION TO AVOID DAMAGE TO GAS COMPANY INSTALLATIONS.

SEE PROVINCIAL REGULATION 140/92 FOR DETAILS

METRIC

WHOLE NUMBERS INDICATE MILLIMETRES
DECIMALIZED NUMBERS INDICATE METRES

BENCH MARK: 84R591 – N. side Dowker Ave.
@ South Dr., Tblt. on top of 0.05 m dia. x
2.4 m iron pipe, 1.5 m S. of N. L. of Dowker
Ave. & 8.2 m E. of W.L. of South Dr.

BID OPPORTUNITY 478-2009

FOR CONTINUATION
SEE DRAWING 8835

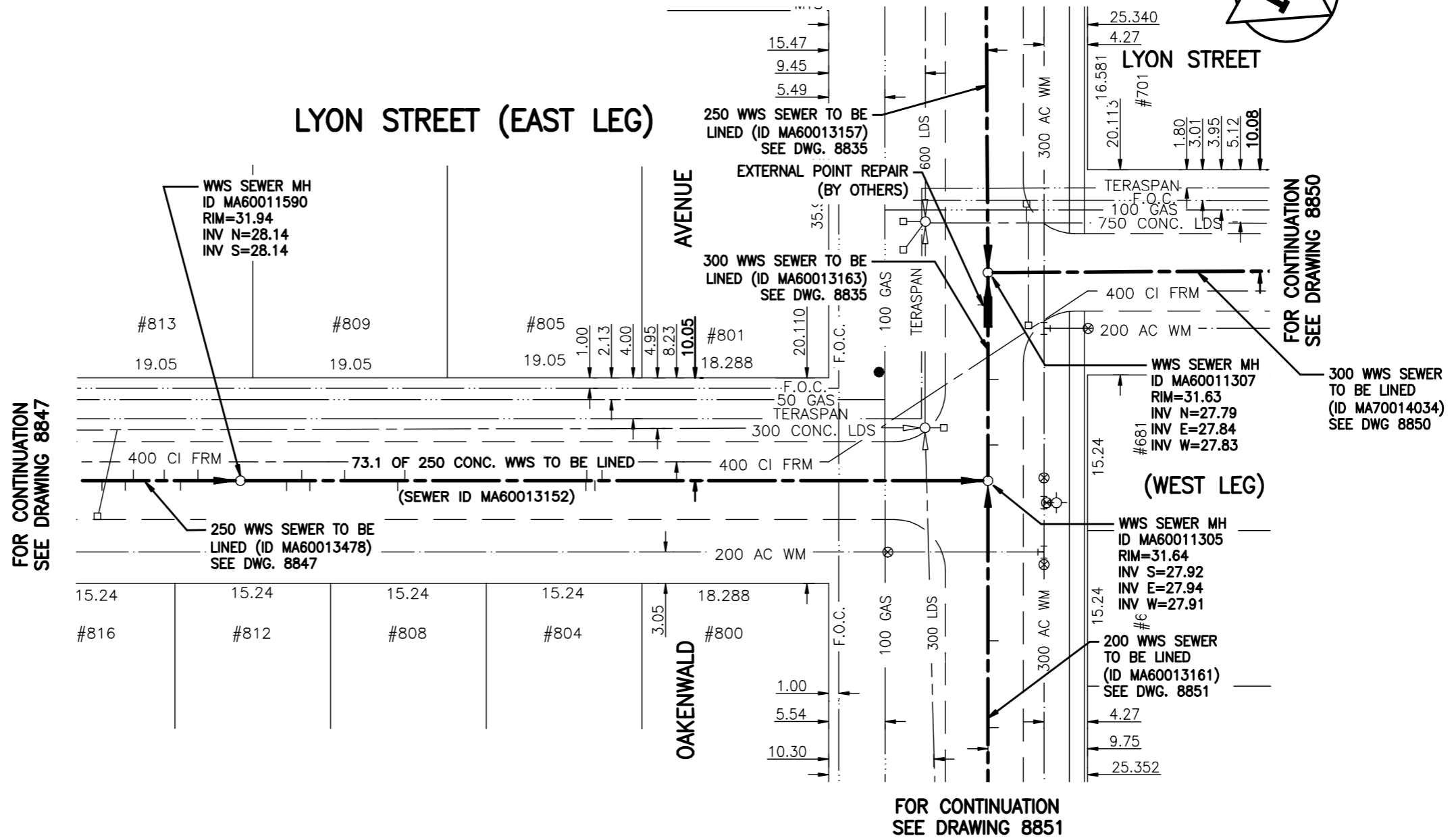
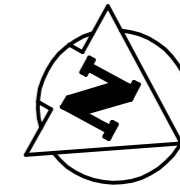

FOR CONTINUATION
SEE DRAWING 8847

FOR CONTINUATION
SEE DRAWING 8850

FOR CONTINUATION
SEE DRAWING 8851

APECM
Certificate of Authorization
Stantec Consulting Ltd.
No. 1301 Expiry: April 30, 2010

LOCATION APPROVED
UNDERGROUND STRUCTURES

SUPV. U/G STRUCTURES COMMITTEE DATE

NOTE:
LOCATION OF UNDERGROUND STRUCTURES AS SHOWN ARE BASED ON THE BEST INFORMATION AVAILABLE BUT NO GUARANTEE IS GIVEN THAT ALL EXISTING UTILITIES ARE SHOWN OR THAT THE GIVEN LOCATIONS ARE EXACT. CONFIRMATION OF EXISTENCE AND EXACT LOCATION OF ALL SERVICES MUST BE OBTAINED FROM THE INDIVIDUAL UTILITIES BEFORE PROCEEDING WITH CONSTRUCTION.

NO.	REVISIONS	DATE	BY

Stantec Consulting Ltd.
905 Waverley Street, Winnipeg, Manitoba
Tel 204-489-5900 Fax 204-453-9012

DESIGNED BY	J.K.H.	CHECKED BY	W.A.B.
DRAWN BY	J.K.H.	APPROVED BY	H.A.K.
HOR. SCALE:	1:500	RELEASED FOR CONSTRUCTION:	ORIGINAL SIGNED BY K. ZUREK
VERTICAL:	N/A	DATE	09.07.21

ENGINEER'S SEAL

ORIGINAL SEALED BY
H.A. KATZ
P. ENG.
09.07.21

CONSULTANT DRAWING NO.
C-III

THE CITY OF WINNIPEG
WATER AND WASTE DEPARTMENT

2009 SEWER RENEWALS
BY CIPP LINING - CONTRACT I7
LYON STREET
4TH MH N OF DOWKER AVE TO
MH AT OAKENWALD AVE

SHEET OF	II 22
CAD FILE DRAWING NUMBER	II490c-III-7II.dwg
CITY DRAWING NUMBER	8846