

NOTE: CHAINAGES SHOWN ARE ALONG N R_L OF HOWE AVE

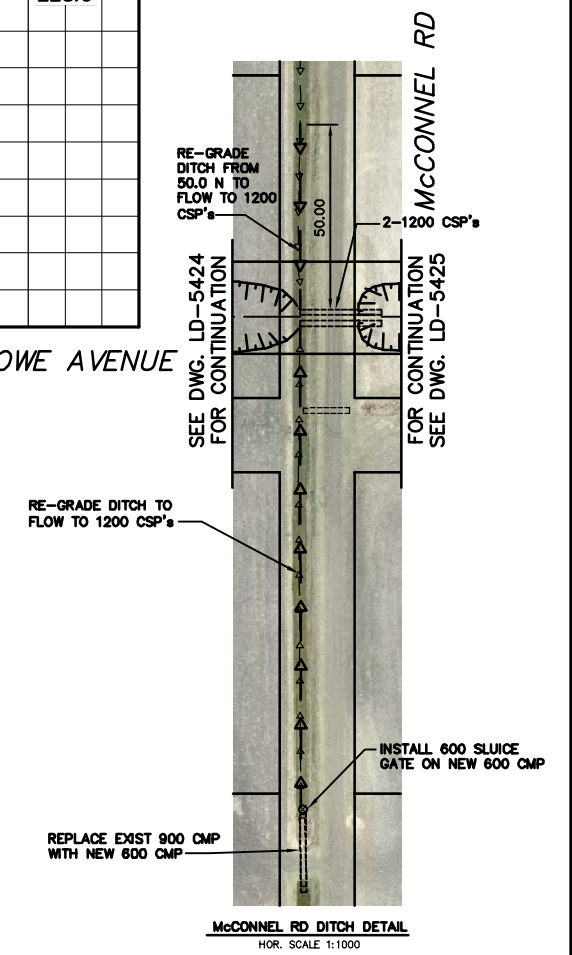

HOWE AVENUE

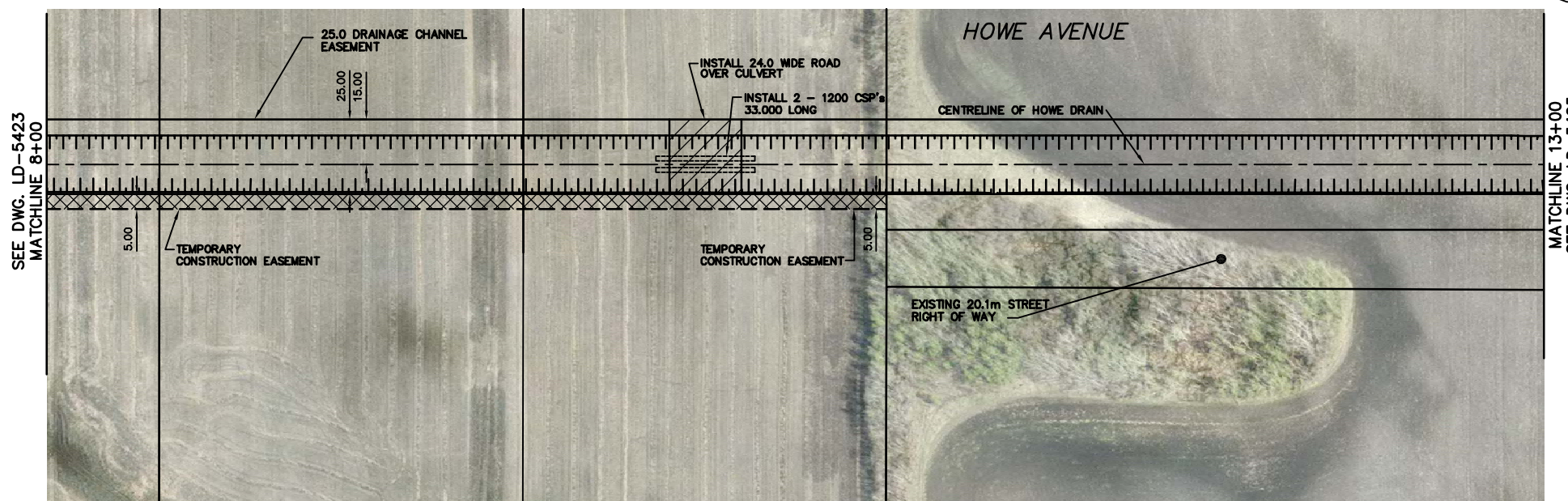

NOTE: FOR CLEARING AND GRUBBING AREAS SEE LD-5426

WARNING
 IF POWER EQUIPMENT OR EXPLOSIVES ARE TO BE USED FOR EXCAVATION ON THIS PROJECT THE CONTRACTOR MUST:
 1) NOTIFY THE GAS COMPANY OF THE PROPOSED LOCATION OF EXCAVATION.
 2) TAKE PRECAUTION TO AVOID DAMAGE TO GAS COMPANY INSTALLATIONS.
 SEE PROVINCIAL REGULATION 210/72 FOR DETAILS

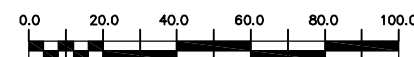

THIS DRAWING CONTAINS A 2005 AERIAL PHOTO

METRIC
 WHOLE NUMBERS INDICATE MILLIMETRES
 DECIMALIZED NUMBERS INDICATE METRES

200 WM	WATERMAIN	200 WM	SL, HYDRO	150 WM	WATERMAIN	150 WM
⊕	HYDRANT	⊕	MTS	⊕	HYDRANT	⊕
⊙	VALVE	⊙	TRAFFIC SIGNALS	⊙	VALVE	⊙
525 LDS	LAND DRAINAGE SEWER	525 LDS	50 GAS	300 LDS	LAND DRAINAGE SEWER	300 LDS
375 WWS	WASTEWATER SEWER	375 WWS	250 WWS	250 WWS	WASTEWATER SEWER	250 WWS
○	MANHOLE	○	⊕	⊕	PROFILE	⊕
□	CATCH BASIN	□	* * * * *	⊕	GROUND ABOVE PIPE	⊕
▽	CURB INLET	▽	POLE - HYDRO, MTS	⊕	⊕ DITCH (NORTH & WEST)	⊕
⊕	JUNCTIONS	⊕	CURB STOP	⊕	⊕ DITCH (SOUTH & EAST)	⊕
⊕	CULVERT	⊕	GY ANCHOR	⊕	⊕ GUTTER (NORTH & WEST)	⊕
⊕	ANODE	⊕	LIGHT STANDARD	⊕	⊕ GUTTER (SOUTH & EAST)	⊕
⊕	EXISTING	⊕	TREE	⊕		⊕
	LEGEND-PLAN		PROPOSED		LEGEND-PROFILE	

LOCATION APPROVED UNDERGROUND STRUCTURES	B.M. ELEV.	FIELD BOOK #
SUPV. U/G STRUCTURES COMMITTEE	POSTED TO LIS	
DATE		
NOTE: LOCATION OF UNDERGROUND STRUCTURES AS SHOWN ARE BASED ON THE BEST INFORMATION AVAILABLE BUT NO GUARANTEE IS GIVEN THAT THE GIVEN LOCATIONS ARE EXACT. CONFIRMATION OF EXISTENCE AND EXACT LOCATION OF ALL SERVICES MUST BE OBTAINED FROM THE INDIVIDUAL UTILITIES BEFORE PROCEEDING WITH CONSTRUCTION.	NO. REVISIONS	DATE BY

CITY OF WINNIPEG WATER AND WASTE ENGINEERING DIVISION		ENGINEER'S SEAL
DESIGNED BY AMc	CHECKED BY KZ	ORIGINAL SIGNED BY K.R. ZUREK 09/08/07
DRAWN BY WKT	APPROVED BY KZ	
HOR. SCALE 1:1000	RELEASED FOR CONSTRUCTION	BID OPPORTUNITY : 477-2009
VERTICAL 1:50		FILENAME : LD-5424.dwg
		PLOT DATE : 2009 08 07

THE CITY OF WINNIPEG
 WATER AND WASTE DEPARTMENT

2009 CONSTRUCTION OF THE HOWE AVENUE DRAIN AND ASSOCIATED WORKS
 HOWE AVENUE
 680 m EAST OF LOUDOUN ROAD TO 20 m WEST OF McCONNELL ROAD

SHEET 2 OF 5
 CITY DRAWING NUMBER
 LD-5424