

EXISTING SEWER SERVICE LOCATION RECORDS		
ADDRESS	SIZE/TYPE	SERVICE LOCATION AT PL
NO RECORD	NO RECORD	NO RECORD

EXISTING WATER SERVICE LOCATION RECORDS				
ADDRESS	SIZE/TYPE	SHORT/LONG	CORP. LOCATION	COMMENTS
456 WINCHESTER	20 COPPER	4.6 S/NPL	NO RECORD	
457 WINCHESTER	20 COPPER	4.0 N/SPL	NO RECORD	
460 WINCHESTER	20 COPPER	4.9 N/SPL	NO RECORD	
461 WINCHESTER	20 COPPER	3.0 N/SPL	NO RECORD	
464 WINCHESTER	20 COPPER	4.9 N/SPL	4.0 S/NHL	
465 WINCHESTER	20 COPPER	5.5 S/NPL	0.6 OF CS	
468 WINCHESTER	20 COPPER	5.5 S/NPL	NO RECORD	
469 WINCHESTER	20 COPPER	5.2 S/NPL	NO RECORD	
473 WINCHESTER	20 COPPER	1.6 S/SPL	0.9 N CURB BOX	
477 WINCHESTER	20 COPPER	1.2 S/SPL	NO RECORD	

NOTE: CHAINAGES SHOWN ARE ALONG EAST PL ON WINCHESTER ST.

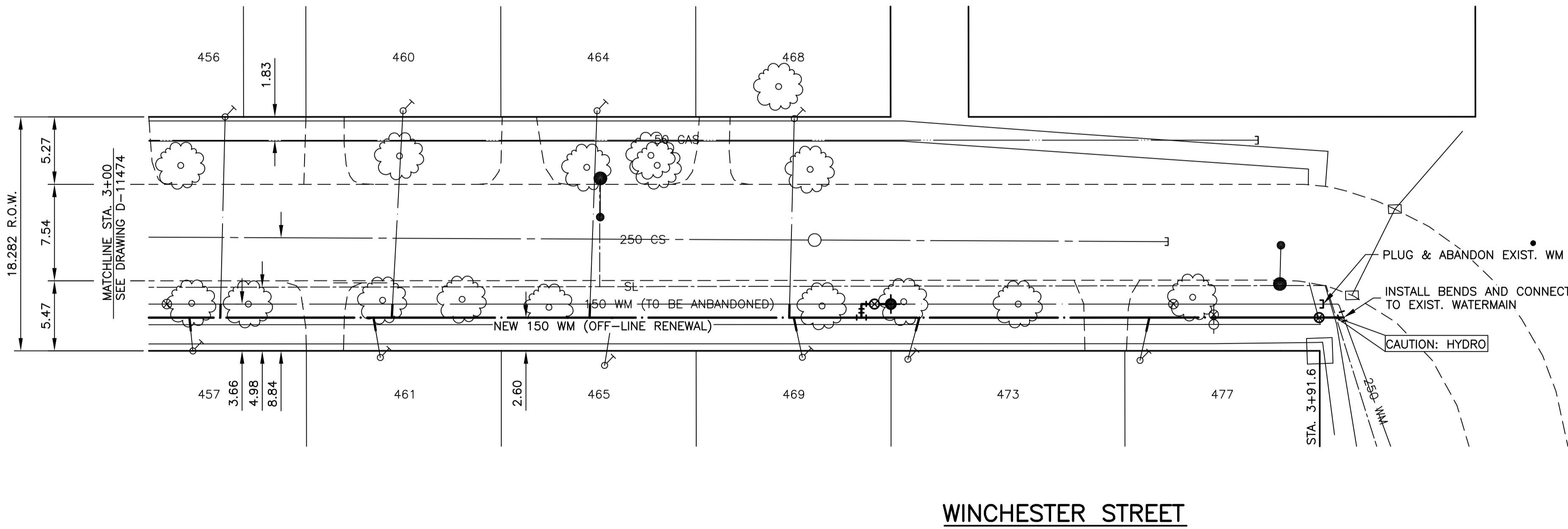

CONSTRUCTION NOTES:

1. EXPOSE EXISTING WATERMAIN & CONFIRM INVERTS PRIOR TO CONSTRUCTION.
2. LOCATION OF ALL SERVICES TO BE CONFIRMED IN THE FIELD.
3. INSTALL WATERMAIN BY TRENCHLESS METHODS.
4. TRENCHES & EXCAVATIONS WITHIN 1 METRE OF A PAVED AREA INCLUDING SIDEWALKS SHALL BE CLASS 3 BACKFILL.
5. ALL MATERIALS SHALL CONFORM TO THE CITY OF WINNIPEG STANDARD CONSTRUCTION SPECIFICATIONS.
6. MINIMUM COVER TO TOP OF WATERMAIN SHALL BE 2.4 m.
7. REPLACE ALL EXISTING LEAD SERVICES FROM PROPOSED WATERMAIN TO PL.
8. NOTIFY ALL RESIDENTS AND BUSINESSES 24 HOURS IN ADVANCE OF ANY WATER SHUTDOWNS OR DISRUPTION OF SERVICE.

WARNING

IF POWER EQUIPMENT OR EXPLOSIVES ARE TO BE USED FOR EXCAVATION ON THIS PROJECT THE CONTRACTOR MUST:

1. NOTIFY THE GAS COMPANY OF THE PROPOSED LOCATION OF EXCAVATION.
2. TAKE PRECAUTION TO AVOID DAMAGE TO GAS COMPANY INSTALLATIONS. SEE PROVINCIAL REGULATION 210/72 FOR DETAILS.

METRIC

WHOLE NUMBERS INDICATE MILLIMETRES
DECIMALIZED NUMBERS INDICATE METRES

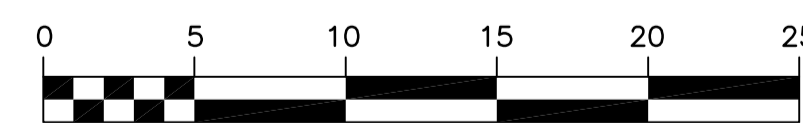

150 mm W.M.	WATERMAIN	150 mm W.M.	HYDRO	150 mm W.M.	WATERMAIN	150 mm W.M.
	WATERMAIN		HYDRO		WATERMAIN	
	HYDRANT		M.T.S.		HYDRANT	
	VALVE		CONCRETE		VALVE	
	LAND DRAINAGE SEWER		ASPHALT		LAND DRAINAGE SEWER	
	WASTE WATER SEWER		PROPERTY LINE		WASTE WATER SEWER	
	MANHOLE		SURVEY BAR		MANHOLE	
	CATCH BASIN		SERVICE VALVE		CATCH BASIN	
	CURB INLET		TREE		CURB INLET	
	JUNCTIONS		LIGHT STANDARD		JUNCTIONS	
	CULVERT		FENCE		CULVERT	
	GAS		GUY ANCHOR		GAS	
	EXISTING LEGEND-PLAN		PROPOSED		EXISTING LEGEND-PROFILE	

UNDERGROUND STRUCTURES

SUPV. U/G STRUCTURES COMMITTEE DATE

NOTE:
LOCATION OF UNDERGROUND STRUCTURES AS SHOWN ARE BASED ON THE BEST INFORMATION AVAILABLE. BUT NO GUARANTEE IS GIVEN THAT ALL EXISTING UTILITIES ARE SHOWN OR THAT THE GIVEN LOCATIONS ARE EXACT. CONFIRMATION OF EXISTENCE AND EXACT LOCATION OF ALL SERVICES MUST BE OBTAINED FROM THE INDIVIDUAL UTILITIES BEFORE PROCEEDING WITH CONSTRUCTION.

B.M. ELEV.	DESIGNED BY	C.L.P.
	DRAWN BY	C.L.P.
	CHECKED BY	S.C.C.
	APPROVED ORIGINAL SIGNED BY	D.P.K.
	3 RE-ISSUED FOR CLIENT REVIEW	06-01-09 S.C.C.
	2 ISSUED FOR TENDER	08-05-08 S.C.C.
	1 ISSUED FOR FINAL REVIEW	07-22-08 S.C.C.
	NO. REVISIONS	DATE BY

DESIGNED BY	C.L.P.
DRAWN BY	C.L.P.
CHECKED BY	S.C.C.
APPROVED ORIGINAL SIGNED BY	D.P.K.
3 RE-ISSUED FOR CLIENT REVIEW	06-01-09 S.C.C.
2 ISSUED FOR TENDER	08-05-08 S.C.C.
1 ISSUED FOR FINAL REVIEW	07-22-08 S.C.C.
NO. REVISIONS	DATE BY

DILLON CONSULTING

DESIGNED BY: C.L.P.
DRAWN BY: C.L.P.
CHECKED BY: S.C.C.
APPROVED ORIGINAL SIGNED BY: D.P.K.

HOR. SCALE: 1 : 250
VERTICAL: 1 : 50

RELEASED FOR CONSTRUCTION: ORIGINAL SIGNED BY KAS ZUREK, P.Eng.
DATE: AUGUST 5, 2008

ENGINEER'S SEAL

PROVINCE OF MANITOBA
D.P. KRAHN
08/5/08
Member
4226
REGISTERED PROFESSIONAL ENGINEER

CONSULTANT PROJECT NO.
091967

THE CITY OF WINNIPEG
WATER AND WASTE DEPARTMENT

2009 WATERMAIN RENEWALS
CONTRACT 27
WINCHESTER STREET
220m S OF SILVER AV.
TO SILVER AV.

CITY DRAWING NUMBER
D-11475
SHEET 4 OF 4

BID OPPORTUNITY
428-2009