

EXISTING GRADE	233.857	233.828	233.834	233.824	233.842	233.925	233.869	233.924	233.983	234.014	234.032	233.950	234.023	233.979
FINISH GRADE	234.38	234.37	234.36	234.35	234.34	234.33	234.32	234.31	234.30	234.28	234.25	234.22	234.20	234.21
WEST DITCH	233.351	233.368	233.386	233.403	233.420	233.425	233.412	233.400	233.398	233.375	233.362	233.350	233.326	233.326
EAST DITCH	232.976	232.963	232.951	232.938	232.926	232.913	232.901	232.888	232.876	232.863	232.851	232.838	232.826	232.813

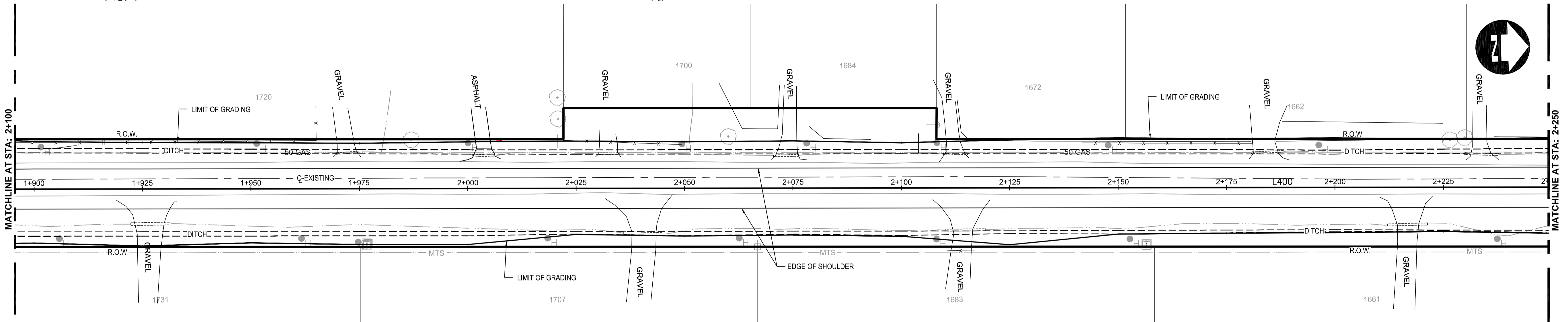
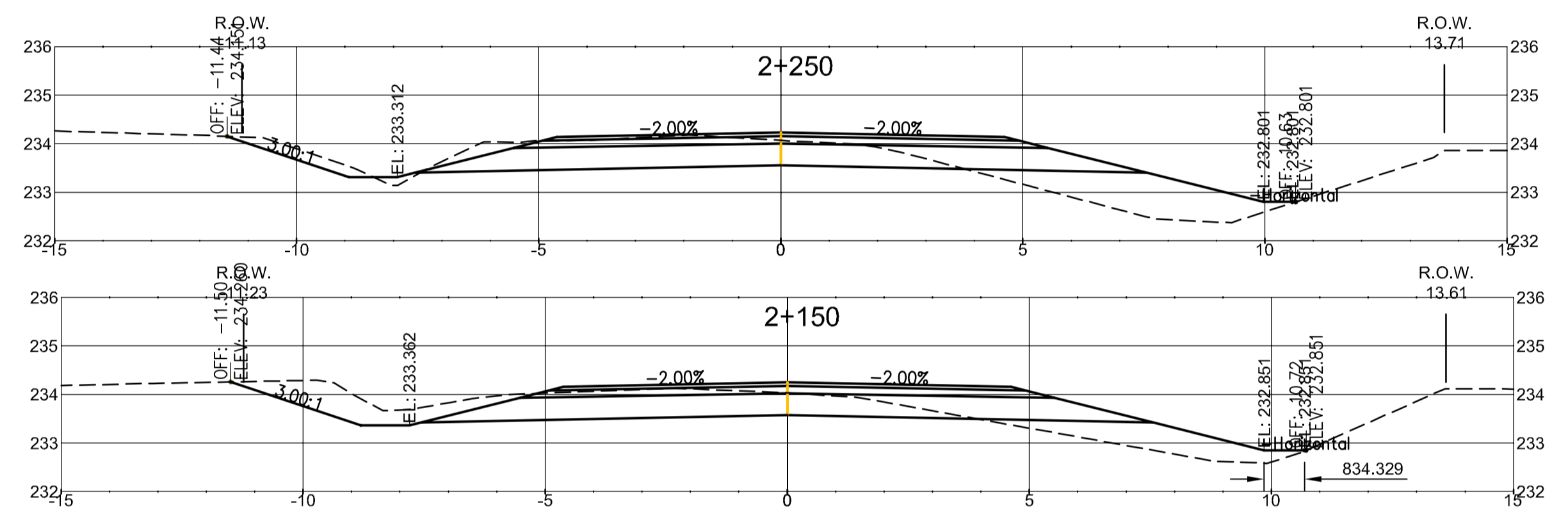
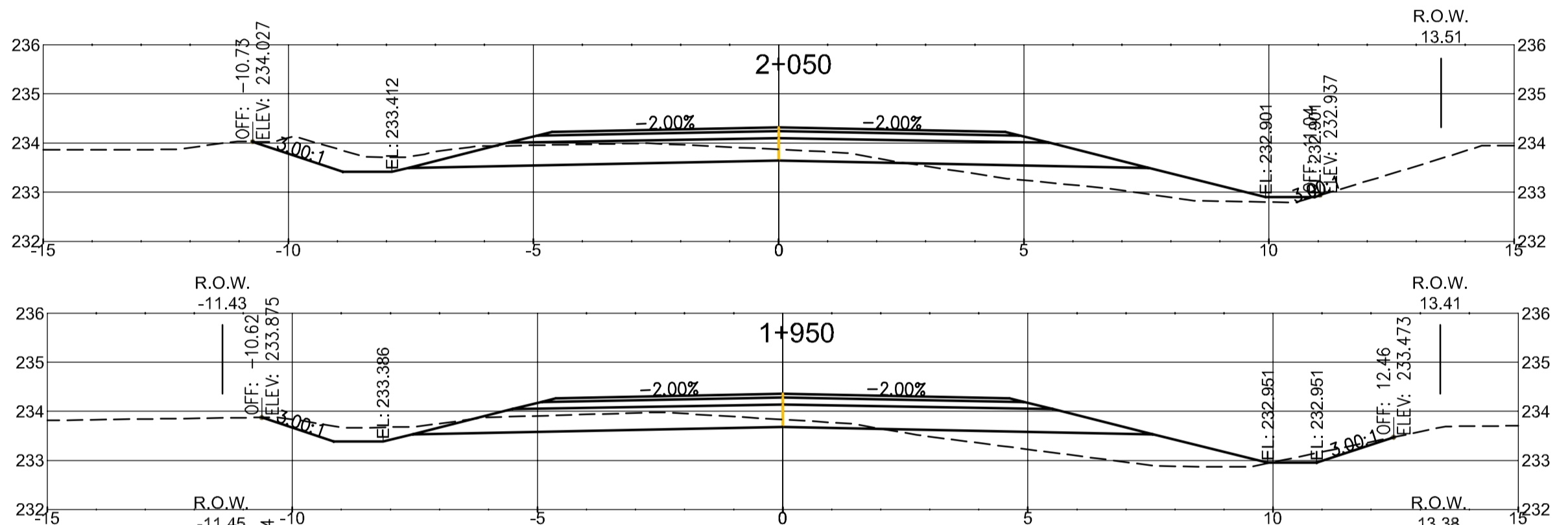

**CONSTRUCTION NOTES**

1. REGRADE EXISTING DITCHES AS DIRECTED BY CONTRACT ADMINISTRATOR.
2. RENEW EXISTING APPROACHES AS DIRECTED BY CONTRACT ADMINISTRATOR.
3. NEW CULVERTS TO BE INSTALLED ON ALL DRIVEWAYS AS DIRECTED BY CONTRACT ADMINISTRATOR.
4. CHAINAGE ALONG CENTRELINE OF NEW ROAD

**WARNING**

- IF POWER EQUIPMENT OR EXPLOSIVES ARE TO BE USED FOR EXCAVATION ON THIS PROJECT THE CONTRACTOR MUST:
1. NOTIFY THE GAS COMPANY OF THE PROPOSED LOCATION OF EXCAVATION.
  2. TAKE PRECAUTION TO AVOID DAMAGE TO GAS COMPANY INSTALLATIONS. SEE PROVINCIAL REGULATION 210/72 FOR DETAILS.

**METRIC**

WHOLE NUMBERS INDICATE MILLIMETRES  
DECIMALIZED NUMBERS INDICATE METRES.

**APEGM**  
Certificate of Authorization  
**Dillon Consulting Limited (MB)**  
No. 1789 Date: MAY 27/09

150 mm W.M.	WATER MAIN	150 mm W.M.	HYDRO	150 mm W.M.	WATERMAIN	150 mm W.M.	HYDRANT
300 mm L.D.S.	LAND DRAINAGE SEWER	300 mm L.D.S.	CONCRETE	300 mm L.D.S.	LAND DRAINAGE SEWER	300 mm L.D.S.	VALVE
250 mm W.W.S.	WASTE WATER SEWER	250 mm W.W.S.	ASPHALT	250 mm W.W.S.	WASTE WATER SEWER	250 mm W.W.S.	MANHOLE
			PLANING				CATCH BASIN
			SIDEWALK				CURB INLET
			PAVING STONES				JUNCTIONS
			PARTIAL DEPTH REPAIR				CULVERT
			PROPERTY LINE				GAS
			SURVEY BAR				
			PARAPLEGIC RAMP				
EXISTING	LEGEND-PLAN	PROPOSED	EXISTING	LEGEND-PROFILE	PROPOSED	EXISTING	

**UNDERGROUND STRUCTURES**

SUPPLY, U/G STRUCTURES COMMITTEE	DATE
NOTE:	
LOCATION OF UNDERGROUND STRUCTURES AS SHOWN ARE BASED ON THE BEST INFORMATION AVAILABLE, BUT NO GUARANTEE IS GIVEN THAT ALL EXISTING UTILITIES ARE SHOWN OR THAT THE GIVEN LOCATIONS ARE EXACT. CONFIRMATION OF EXISTENCE AND EXACT LOCATION OF ALL SERVICES MUST BE OBTAINED FROM THE INDIVIDUAL UTILITIES BEFORE PROCEEDING WITH CONSTRUCTION.	

B.M. ELEV.	
1. RELEASED FOR TENDER	MAY 27/09 TJP
NO. REVISIONS	DATE BY

DESIGNED BY	DTM
DRAWN BY	DTM
CHECKED BY	ORIGINAL SIGNED BY TARAN J. PETERS
APPROVED BY	ORIGINAL SIGNED BY DAVID P. KRAHN
HOR. SCALE	1 : 500
VERTICAL	1 : 25

**DILLON CONSULTING**

RELEASED FOR CONSTRUCTION ORIGINAL SIGNED BY KEN TURKO, 05/27/2009

ENGINEER'S SEAL  
PROVINCE OF MANITOBA  
T.J. PETERS  
08/27/09  
Member 22309  
REGISTERED PROFESSIONAL ENGINEER

CONSULTANT PROJECT NO.  
**08-9587**

**THE CITY OF WINNIPEG**  
PUBLIC WORKS DEPARTMENT

2009 GRANULAR ROADWAY IMPROVEMENTS  
**McCREARY ROAD**  
GRADING AND PAVING  
1+900 TO 2+250

CITY DRAWING NUMBER  
SHEET 5 OF 11