

EXISTING GRADE	234.34	233.932	233.714	233.692	233.766	233.784	233.768	233.818	233.859	233.901	233.954
FINISH GRADE		234.05	233.90	233.94	233.99	234.05	234.10	234.11	234.13	234.14	234.16
WEST DITCH		232.650	232.662	232.675	232.688	232.700	232.712	232.725	232.738	232.750	232.762
EAST DITCH		232.682	232.695	232.707	232.720	232.732	232.745	232.757	232.770	232.782	232.795

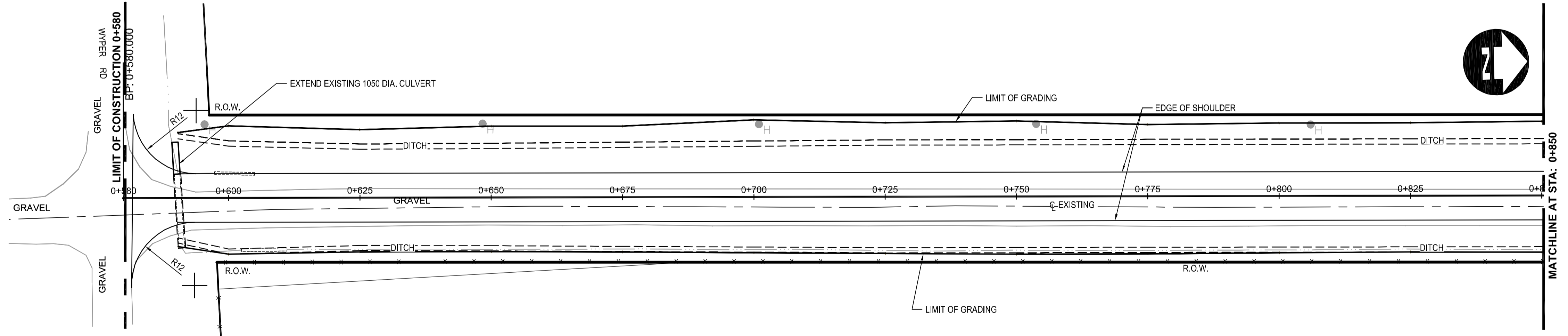
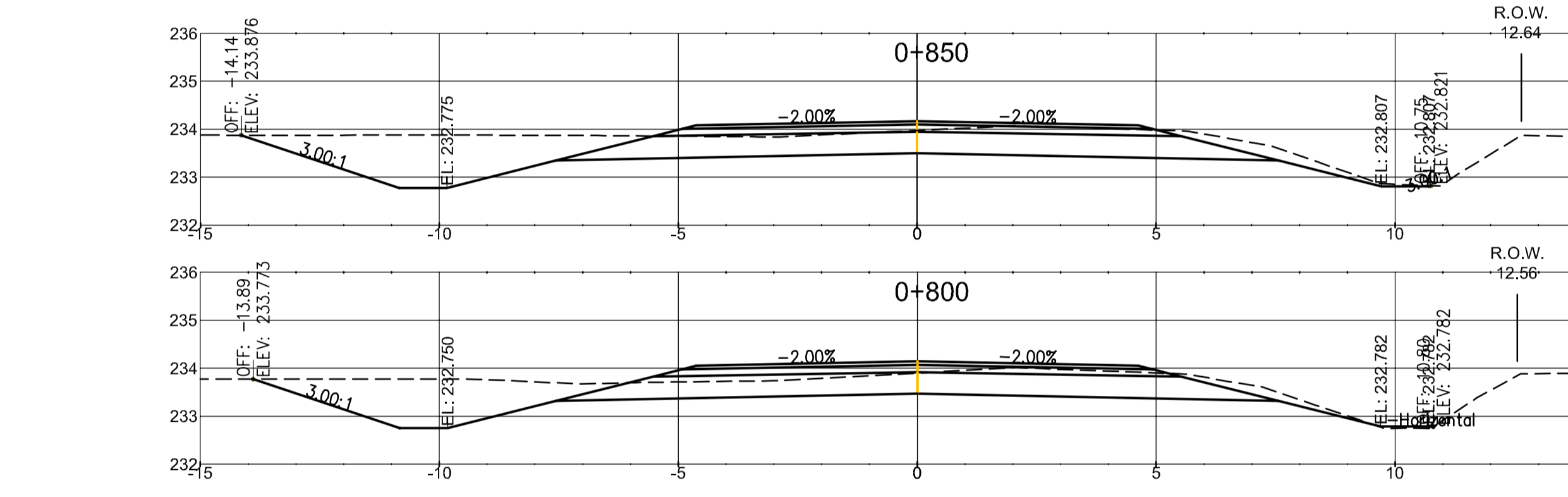
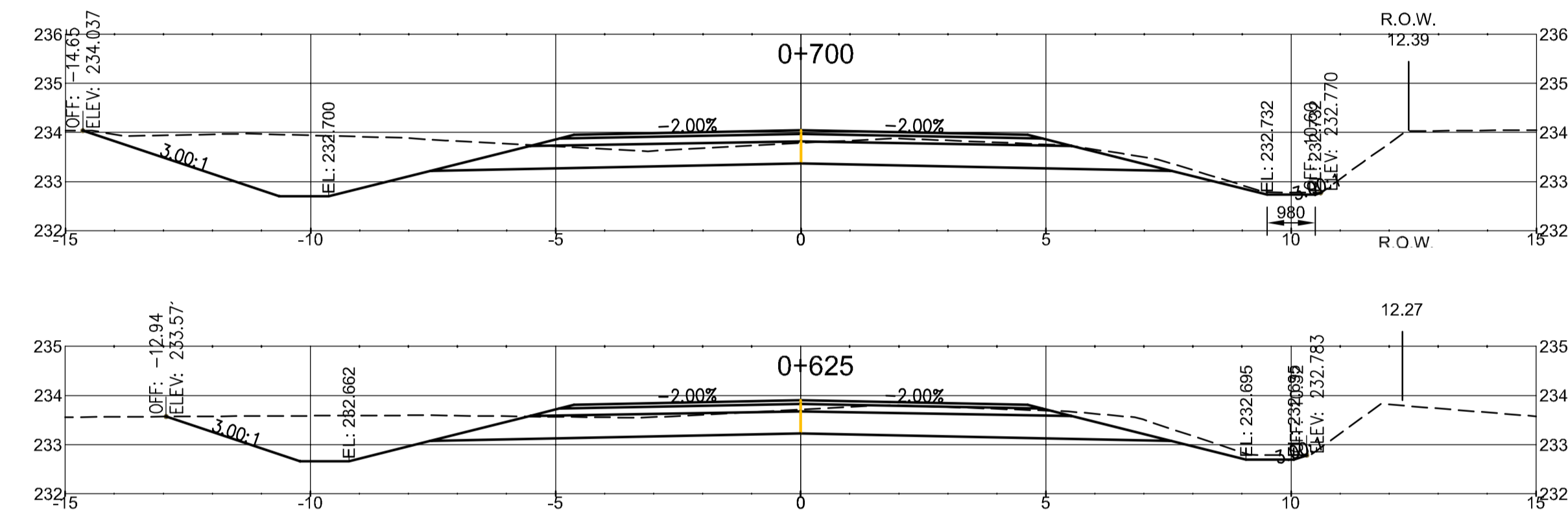

McCREARY ROAD

CONSTRUCTION NOTES

1. REGRADE EXISTING DITCHES AS DIRECTED BY CONTRACT ADMINISTRATOR.
2. RENEW EXISTING APPROACHES AS DIRECTED BY CONTRACT ADMINISTRATOR.
3. NEW CULVERTS TO BE INSTALLED ON ALL DRIVEWAYS AS DIRECTED BY CONTRACT ADMINISTRATOR.
4. CHAINAGE ALONG CENTRELINE OF NEW ROAD

WARNING

- IF POWER EQUIPMENT OR EXPLOSIVES ARE TO BE USED FOR EXCAVATION ON THIS PROJECT THE CONTRACTOR MUST:
1. NOTIFY THE GAS COMPANY OF THE PROPOSED LOCATION OF EXCAVATION.
  2. TAKE PRECAUTION TO AVOID DAMAGE TO GAS COMPANY INSTALLATIONS. SEE PROVINCIAL REGULATION 210/72 FOR DETAILS.

METRIC

WHOLE NUMBERS INDICATE MILLIMETRES  
DECIMALIZED NUMBERS INDICATE METRES.

**APEGM**  
Certificate of Authorization  
**Dillon Consulting Limited (MB)**  
No. 1789 Date: MAY 27/09

150 mm W.M.	WATER MAIN	150 mm W.M.	HYDRO	150 mm W.M.	WATERMAIN	150 mm W.M.
Hydrant	HYDRANT	Valve	M.T.S.	Hydrant	HYDRANT	Valve
300 mm L.D.S.	LAND DRAINAGE SEWER	300 mm L.D.S.	CONCRETE	300 mm L.D.S.	LAND DRAINAGE SEWER	300 mm L.D.S.
250 mm W.W.S.	WASTE WATER SEWER	250 mm W.W.S.	ASPHALT	250 mm W.W.S.	WASTE WATER SEWER	250 mm W.W.S.
Manhole	MANHOLE	Catch Basin	PAVING STONES	Manhole	MANHOLE	Catch Basin
Curb Inlet	CURB INLET	Junctions	PARTIAL DEPTH REPAIR	Curb Inlet	CURB INLET	Junctions
Culvert	CULVERT	Gas	PROPERTY LINE	Culvert	CULVERT	Gas
Existing	LEGEND-PLAN	Proposed	EXISTING	Proposed	LEGEND-PROFILE	Proposed

UNDERGROUND STRUCTURES	DATE
SUPPLY, U/G STRUCTURES COMMITTEE	
NOTE:	
LOCATION OF UNDERGROUND STRUCTURES AS SHOWN ARE BASED ON THE BEST INFORMATION AVAILABLE, BUT NO GUARANTEE IS GIVEN THAT ALL EXISTING UTILITIES ARE SHOWN OR THAT THE GIVEN LOCATIONS ARE EXACT. CONFIRMATION OF EXISTENCE AND EXACT LOCATION OF ALL SERVICES MUST BE OBTAINED FROM THE INDIVIDUAL UTILITIES BEFORE PROCEEDING WITH CONSTRUCTION.	

B.M. ELEV.	
DESIGNED BY	DTM
DRAWN BY	DTM
CHECKED BY	ORIGINAL SIGNED BY TARAN J. PETERS
APPROVED BY	ORIGINAL SIGNED BY DAVID P. KRAHN
HOR. SCALE	1 : 500
VERTICAL	1 : 25
1. RELEASED FOR TENDER	MAY 27/09 TJP
NO. REVISIONS	DATE BY

**DILLON CONSULTING**

RELEASED FOR CONSTRUCTION ORIGINAL SIGNED BY KEN TURKO, 05/27/2009

ENGINEER'S SEAL  
PROVINCE OF MANITOBA  
T.J. PETERS  
Member 22309  
REGISTERED PROFESSIONAL ENGINEER

CONSULTANT PROJECT NO.  
**08-9587**

**THE CITY OF WINNIPEG**  
PUBLIC WORKS DEPARTMENT

2009 GRANULAR ROADWAY IMPROVEMENTS  
**McCREARY ROAD**  
GRADING AND PAVING  
0+580 TO 0+850

CITY DRAWING NUMBER  
SHEET 1 OF 11