

HOUSE WATER SERVICE INFORMATION					
ADDRESS & NATURE OF SERVICE	SIZE (mm) & TYPE	SHORT & LONG MEASUREMENT	COORP LOCATION	REMARKS	
28 Pembroke Road Residential	19 Copper	7 LR CR OF HSE	SEWER/62		
29 Pembroke Road Residential	19 Copper	3.4 S/NHL	OPP S/C	DR/WY A2176 SEWER/62 JULY/03 USED BOSS CLAMP	
30 Pembroke Road Residential	19 Copper	6.4 RL CR OF HSE	SEWER/63 TAX-ST B-442530-08		
31 Pembroke Road Residential	19 Copper	7 N/SHL	DR/WY A2499 SEWER/62	OCT/02 RENEWED SERVICE BOX	
32 Pembroke Road Residential	19 Copper	6.9 LR CR OF HSE	SEWER/63 GRD STRAP		
33 Pembroke Road Residential	19 Copper	5.5 LR CR OF HSE	DR/WY A2092 SEWER/62		
34 Pembroke Road Residential	19 Copper	5.5 RL CR OF HSE	SEWER/62		
35 Pembroke Road Residential	19 Copper	7 LR CR OF HSE	DR/WY A2520 SEWER/62	TAX-STB-6-442570-06 A2537	
36 Pembroke Road Residential	19 Copper	8.2 RL CR OF HSE	SEWER/63		
37 Pembroke Road Residential	19 Copper	4.1 RL CR OF HSE	DR/WY A2893 SEWER/64	1 GRD STRAP	

CHAINAGE ALONG EAST PROPERTY LINE OF PEMBROKE ROAD  
PEMBROKE ROAD

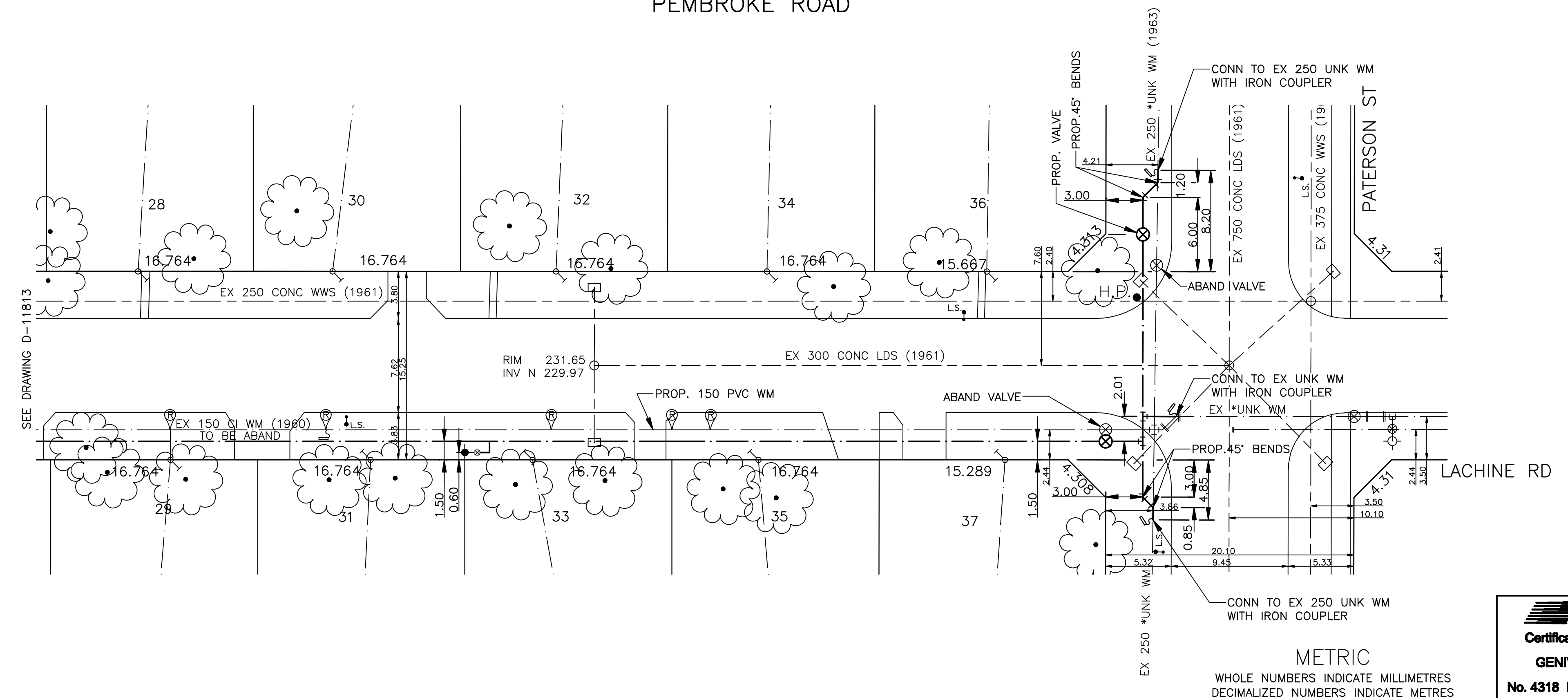

- NOTES:**
1. ALL GATE VALVES ARE COUNTER-CLOCKWISE TO OPEN WITH A BLACK OPERATING NUT.
  2. WATERMAIN TO BE INSTALLED BY TRENCHLESS METHODS.
  3. BACKFILL IS CLASS 5 WITHIN BOULEVARD AND CLASS 3 WHEN WITHIN PAVEMENT/SIDEWALK OR WHEN WITHIN 1.0m OF PAVEMENT OR SIDEWALK.
  4. WATER SERVICES ARE 19mm UNLESS OTHERWISE NOTED.
  5. MINIMUM COVER TO TOP OF WATERMAIN SHALL BE 2.4m.
  6. LOCATION OF ALL SERVICES TO BE CONFIRMED IN FIELD.
  7. EXPOSE EXISTING WATERMAIN TO CONFIRM DEPTH PRIOR TO CONSTRUCTION.
  8. ALL LEAD SERVICES TO BE RENEWED TO PROPERTY LINE.
  9. SERVICES TO BE RENEWED SHALL BE REPLACED FROM WATERMAIN TO PROPERTY LINE. ALL OTHERS TO BE RECONNECTED.

EXISTING	LEGEND - PLAN	PROPOSED	EXISTING	LEGEND - PLAN	PROPOSED	EXISTING	LEGEND - PROFILE	PROPOSED
---	WATERMAIN	---	---	REDUCER	---	---	WATERMAIN	---
⊕	HYDRANT VALVE	⊕	⊕	PLUG	⊕	---	WATERMAIN VALVE	---
---	LAND DRAINAGE SEWER	---	---	TRAFFIC SIGNAL	---	---	LAND DRAINAGE SEWER	---
---	WASTE WATER SEWER	---	---	GAS	---	---	WASTE WATER SEWER	---
○	MANHOLE	●	---	HYDRO	---	---	JUNCTIONS	---
□	CATCH BASIN	■	---	M.T.S.	---	---	CULVERT	---
△	CURB INLET	▲	---	SURVEY BAR	---	---		
+	TEE	+	---	CURB STOP	---	---		
∩	BEND	∩	---	C.B. LEAD	---	---		
⊕	ANODE	⊕	---	TREE	---	---		
---		---	---	LAMP STANDARD	---	---		

LOCATION APPROVED

SUPV. U/G STRUCTURES COMMITTEE

DATE

NOTE: LOCATION OF UNDERGROUND STRUCTURES AS SHOWN ARE BASED ON THE BEST INFORMATION AVAILABLE BUT NO GUARANTEE IS GIVEN THAT ALL EXISTING UTILITIES ARE SHOWN OR THAT THE GIVEN LOCATIONS ARE EXACT. CONFIRMATION OF EXISTENCE AND EXACT LOCATION OF ALL SERVICES MUST BE OBTAINED FROM THE INDIVIDUAL UTILITIES BEFORE PROCEEDING WITH CONSTRUCTION.

B.N. ELEV. 55-033 232.899

**GENIVAR**  
200 TACHE AVENUE, WINNIPEG, MANITOBA R2H 1A7  
PH: (204)-235-2115 FAX: (204)-235-2080

DESIGNED BY DJ  
CHECKED BY AB  
DRAWN BY AB  
APPROVED BY SM

HOR. SCALE: 1:250  
VERT. SCALE: 1:50

RELEASED FOR ORIGINAL CONSTRUCTION  
SIGNED BY K. ZUREK P. ENG  
DATE MAY 25, 2009

ENGINEERS SEAL  
PROVINCE OF MANITOBA  
REGISTERED PROFESSIONAL ENGINEER  
I. G. MCKINNON

CONSULTANT DRAWING NO. 09-049-18

**THE CITY OF WINNIPEG**  
WATER AND WASTE DEPARTMENT

2009 CAPITAL WORKS  
WATERMAIN RENEWALS  
PEMBROKE ROAD (EAST LEG)  
118 M NORTH OF PEMBROKE ROAD (SOUTH LEG)  
TO PATERSON STREET

SHEET 4 OF 4  
CITY DRAWING NO. D-11814

**APEGM**  
Certificate of Authorization  
GENIVAR Consultants  
No. 4318 Expiry: April 30, 2010