

HOUSE WATER SERVICES INFORMATION				
ADDRESS & NATURE OF SERVICE	SIZE (mm) & TYPE	SHORT & LONG MEASUREMENT	CORP LOCATION	REMARKS
151 Clonard Avenue Residential	19 Copper	2.7 R/L 606.9 E/EL OF ST ANNES	10.1 W OF 3rd HYDT	DRWY 136
152 Clonard Avenue Residential	19 Copper	1.2 L OF R 10.7 W OF 3rd HYDT DES MEURON		
155 Clonard Avenue Residential	19 Copper	0.6 R/L 620.3 E/EL OF ST ANNES		OPP S.C.
156 Clonard Avenue Residential	19 Copper	0.6 L/R 623.3 E/EL OF ST ANNES		4 E OF 3rd HYDT
157 Clonard Avenue Residential	13 Copper	7.9 L OF R 636.4 E/EL OF ST ANNES		NEW SEWER CROSSES P/L 1 E OF JUNC.
162 Clonard Avenue Residential	13 Copper	2.1 L OF R 639.5 E/EL OF ST ANNES		
166 Clonard Avenue Residential	13 Copper	3.1 L OF R 662.9 E/EL OF ST ANNES		
167 Clonard Avenue Residential		9.1 L OF R 651.7 E/EL OF ST ANNES		
171 Clonard Avenue Residential	19 Copper	1.5 E W HOUSE LINE 673.6 E/EL OF ST ANNES		1 E OF S/C
172 Clonard Avenue Residential	13 Copper	0.9 L OF R 677 E/EL OF ST ANNES		
173 Clonard Avenue Residential	13 Copper	8.5 L OF R 682.1 E/EL OF ST ANNES		
174 Clonard Avenue Residential	13 Lead	1.8 L OF R 689.2 E/EL OF ST ANNES		
177 Clonard Avenue Residential	13 Copper	12.2 L OF R 696.2 E/EL OF ST ANNES		

NOTES:

- ALL GATE VALVES ARE COUNTER-CLOCKWISE TO OPEN WITH A BLACK OPERATING NUT.
- WATERMAIN TO BE INSTALLED BY TRENCHLESS METHODS.
- BACKFILL IS CLASS 5 WITHIN BOULEVARD AND CLASS 3 WHEN WITHIN PAVEMENT/SIDEWALK OR WHEN WITHIN 1.0m OF PAVEMENT OR SIDEWALK.
- WATER SERVICES ARE 19mm UNLESS OTHERWISE NOTED.
- MINIMUM COVER TO TOP OF WATERMAIN SHALL BE 2.4m.
- LOCATION OF ALL SERVICES TO BE CONFIRMED IN FIELD.
- EXPOSE EXISTING WATERMAIN TO CONFIRM DEPTH PRIOR TO CONSTRUCTION.
- ALL LEAD SERVICES TO BE RENEWED TO PROPERTY LINE.
- SERVICES TO BE RENEWED SHALL BE REPLACED FROM WATERMAIN TO PROPERTY LINE. ALL OTHERS TO BE RECONNECTED.

CHAINAGE ALONG SOUTH PROPERTY LINE OF CLONARD AVENUE

CLONARD AVENUE

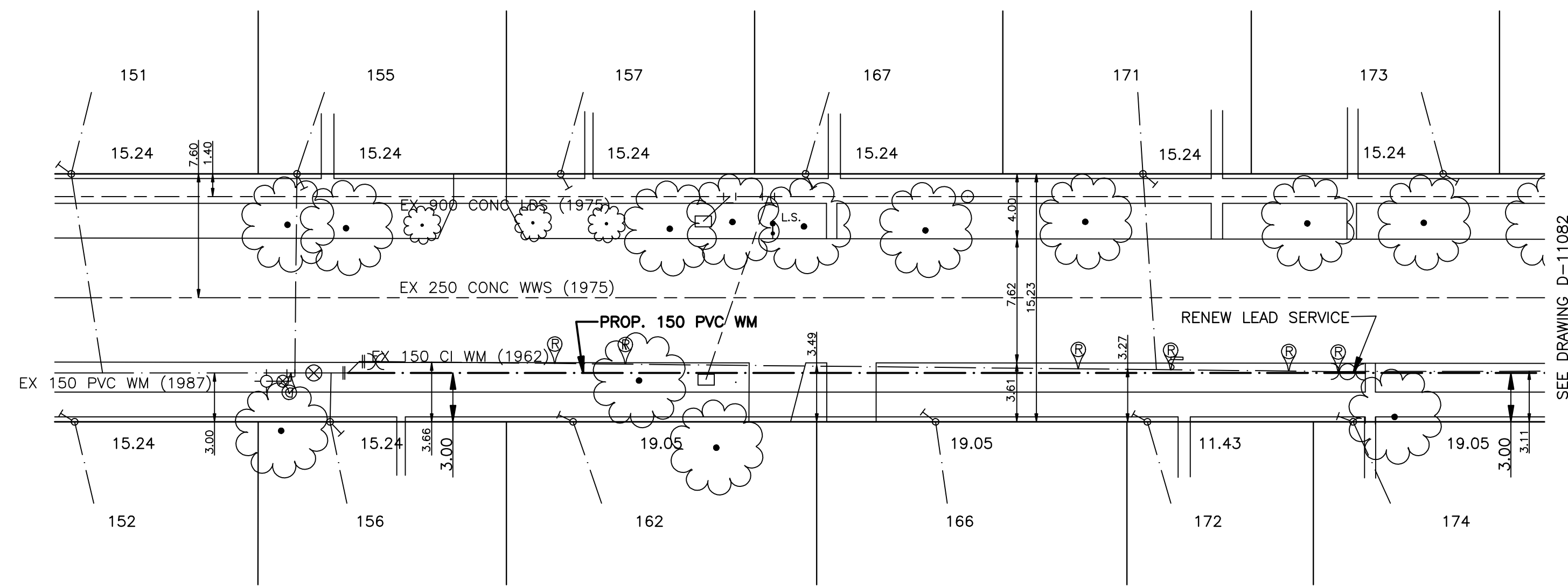

---	WATERMAIN	---	REDUCER	---	150mm W.W.	WATERMAIN	150mm W.W.
⊕	HYDRANT VALVE	⊕	PLUG	⊕	300mm L.D.S.	VALVE	300mm L.D.S.
⊕	LAND DRAINAGE SEWER	⊕	TRAFFIC SIGNAL	⊕	250mm W.W.S.	LAND DRAINAGE SEWER	300mm L.D.S.
⊕	WASTE WATER SEWER	⊕	GAS	⊕	250mm W.W.S.	WASTE WATER SEWER	250mm W.W.S.
○	MANHOLE	●	HYDRO	⊕		JUNCTIONS	
□	CATCH BASIN	⊕	M.T.S.	⊕		CULVERT	
△	CURB INLET	▲	SURVEY BAR	⊕			
⊕	TEE	⊕	CURB STOP	⊕			
⊕	BEND	⊕	C.B. LEAD	⊕			
⊕	ANODE	⊕	TREE	⊕			
---	EXISTING	---	LAMP STANDARD	---			
---	LEGEND - PLAN	---	PROPOSED	---			

LOCATION APPROVED			
SUPV. U/G STRUCTURES COMMITTEE	DATE		
NOTE: LOCATION OF UNDERGROUND STRUCTURES AS SHOWN ARE BASED ON THE BEST INFORMATION AVAILABLE BUT NO GUARANTEE IS GIVEN THAT ALL EXISTING UTILITIES ARE SHOWN OR THAT THE GIVEN LOCATIONS ARE EXACT. CONFIRMATION OF EXISTENCE AND EXACT LOCATION OF ALL SERVICES MUST BE OBTAINED FROM THE INDIVIDUAL UTILITIES BEFORE PROCEEDING WITH CONSTRUCTION.			
B.N. ELEV.	54-002	231.653	
NO.	REVISIONS	DATE	BY
1	BID OPPORTUNITY NUMBER 399-2009	MAY 09	AB

GENIVAR
10 PRAIRIE WAY WINNIPEG, MANITOBA R2J 3J8
PH: (204)-477-8650 FAX: (204)-474-2864

DESIGNED BY: DJ
CHECKED BY: AB
DRAWN BY: AB
APPROVED BY: SM

HOR. SCALE: 1:250
VERT. SCALE: 1:50

RELEASED FOR CONSTRUCTION: MAY 25, 2009
SIGNATURE: K. ZUREK P. ENG

ENGINEERS SEAL
PROVINCE OF MANITOBA
REGISTERED PROFESSIONAL ENGINEER
I. G. MCKINNON

CONSULTANT DRAWING NO. 09-049-07

THE CITY OF WINNIPEG
WATER AND WASTE DEPARTMENT

2009 CAPITAL WORKS
WATERMAIN RENEWALS
CLONARD AVENUE
90M WEST OF EGERTON ROAD TO
195M WEST OF EGERTON ROAD

SHEET 2 OF 4
CITY DRAWING NO. D-11803

GENIVAR Consultants
No. 4318 Expiry: April 30, 2010