

HOUSE WATER SERVICE INFORMATION					
ADDRESS & NATURE OF SERVICE	SIZE (mm) & TYPE	SHORT & LONG MEASUREMENT	CORP LOCATION	REMARKS	
154 Kenny Street Residential	19 Copper	4.1 R L COR HSE			
159 Kenny Street Residential	19 Copper	1.5 L R COR HSE		SEWER	
160 Kenny Street Residential		2.4 L/R			
		23.5 N/KENNY P/L			

CHAINAGE ALONG WEST PROPERTY LINE OF KENNY STREET

KENNY STREET

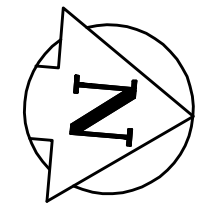

- NOTES:**
1. ALL GATE VALVES ARE COUNTER-CLOCKWISE TO OPEN WITH A BLACK OPERATING NUT. WATERMAIN TO BE INSTALLED BY TRENCHLESS METHODS.
 2. BACKFILL IS CLASS 5 WITHIN BOULEVARD AND CLASS 3 WHEN WITHIN PAVEMENT/SIDEWALK OR WHEN WITHIN 1.0m OF PAVEMENT OR SIDEWALK.
 3. WATER SERVICES ARE 19mm UNLESS OTHERWISE NOTED.
 4. MINIMUM COVER TO TOP OF WATERMAIN SHALL BE 2.4m.
 5. LOCATION OF ALL SERVICES TO BE CONFIRMED IN FIELD.
 6. EXPOSE EXISTING WATERMAIN TO CONFIRM DEPTH PRIOR TO CONSTRUCTION.
 7. ALL LEAD SERVICES TO BE RENEWED TO PROPERTY LINE.
 8. SERVICES TO BE RENEWED SHALL BE REPLACED FROM WATERMAIN TO PROPERTY LINE. ALL OTHERS TO BE RECONNECTED.

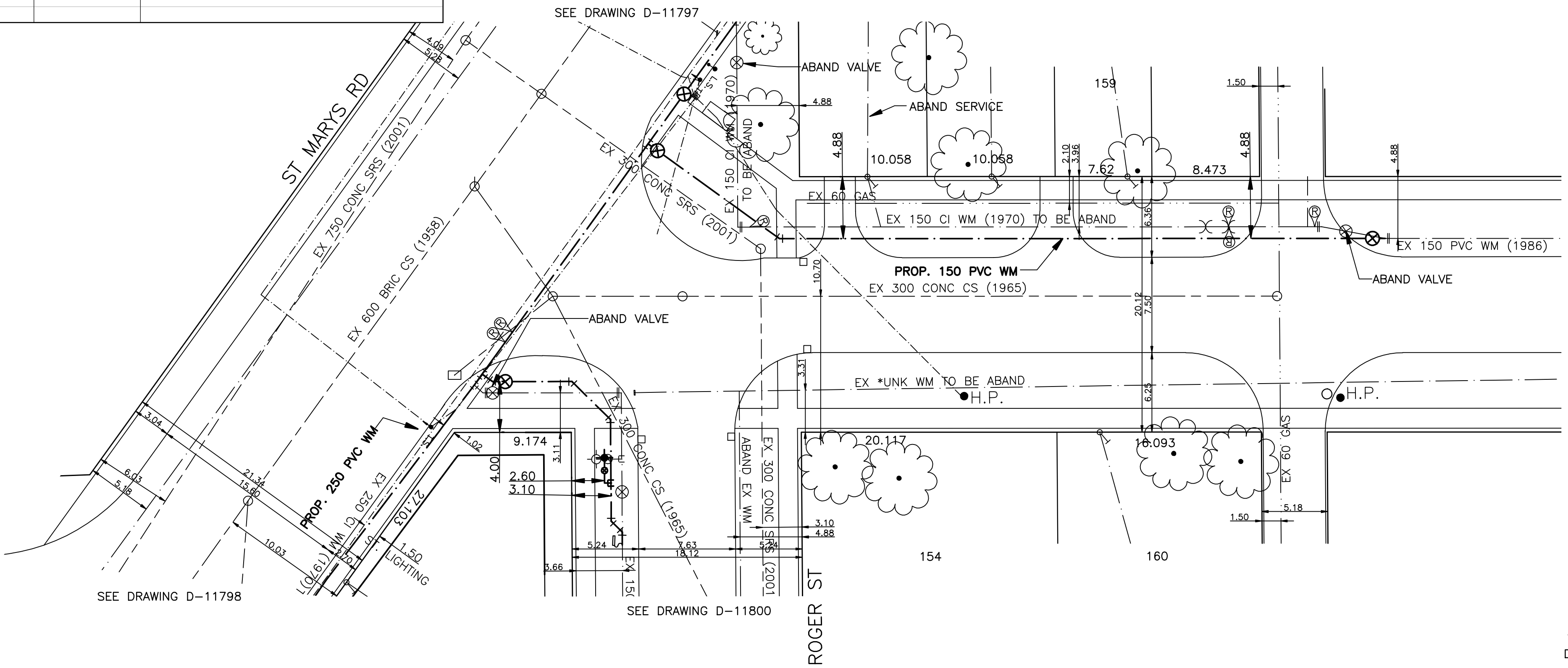

APEGM
Certificate of Authorization
GENIVAR Consultants
No. 4318 Expiry: April 30, 2010

METRIC
WHOLE NUMBERS INDICATE MILLIMETRES
DECIMALIZED NUMBERS INDICATE METRES

EXISTING	LEGEND - PLAN	PROPOSED	EXISTING	LEGEND - PLAN	PROPOSED	EXISTING	LEGEND - PROFILE	PROPOSED
---	WATERMAIN	---	---	REDUCER	---	---	150mm W.W.	---
⊕	HYDRANT	⊕	⊕	PLUG	⊕	---	150mm W.W.	---
⊕	VALVE	⊕	⊕	TRAFFIC SIGNAL	⊕	---	300mm L.D.S.	---
---	LAND DRAINAGE SEWER	---	---	GAS	---	---	250mm W.W.S.	---
---	WASTE WATER SEWER	---	---	HYDRO	---	---	---	---
○	MANHOLE	●	○	M.T.S.	○	---	---	---
□	CATCH BASIN	■	□	SURVEY BAR	□	---	---	---
△	CURB INLET	▲	△	CURB STOP	▲	---	---	---
+	TEE	+	+	C.B. LEAD	+	---	---	---
∩	BEND	∩	∩	TREE	∩	---	---	---
⊕	ANODE	⊕	⊕	LAMP STANDARD	⊕	---	---	---

LOCATION APPROVED

SUPPLY, U/G STRUCTURES COMMITTEE

NOTE:
LOCATION OF UNDERGROUND STRUCTURES AS SHOWN ARE BASED ON THE BEST INFORMATION AVAILABLE BUT NO GUARANTEE IS GIVEN THAT ALL EXISTING UTILITIES ARE SHOWN OR THAT THE GIVEN LOCATIONS ARE EXACT. CONFIRMATION OF EXISTENCE AND EXACT LOCATION OF ALL SERVICES MUST BE OBTAINED FROM THE INDIVIDUAL UTILITIES BEFORE PROCEEDING WITH CONSTRUCTION.

B.N. 34-005
ELEV. 229.798

GENIVAR
10 PRAIRIE WAY WINNIPEG, MANITOBA R2J 3J8
PH: (204)-477-8650 FAX: (204)-474-2864

DESIGNED BY: DJ
CHECKED BY: AB
DRAWN BY: AB
APPROVED BY: SM

HOR. SCALE: 1:250
VERT. SCALE: 1:50

RELEASED FOR ORIGINAL CONSTRUCTION
SIGNED BY: K. ZUREK P. ENG
DATE: MAY 25, 2009

ENGINEERS SEAL
PROVINCE OF MANITOBA
I. G. MCKINNON
REGISTERED PROFESSIONAL ENGINEER

CONSULTANT DRAWING NO. 09-049-03

THE CITY OF WINNIPEG
WATER AND WASTE DEPARTMENT

2009 CAPITAL WORKS
WATERMAIN RENEWALS
KENNY STREET

ST. MARY'S ROAD TO
45M NORTH OF ST. MARY'S ROAD

SHEET 3 OF 4
CITY DRAWING NO. D-11799