

B SIZE 11" x 17" (279mm x 432mm)

PLOT: 7/30/2009 4:22:12 PM

FILE NAME: D265-244-02_01-C-1030_RX.dwg Saved By: berarok

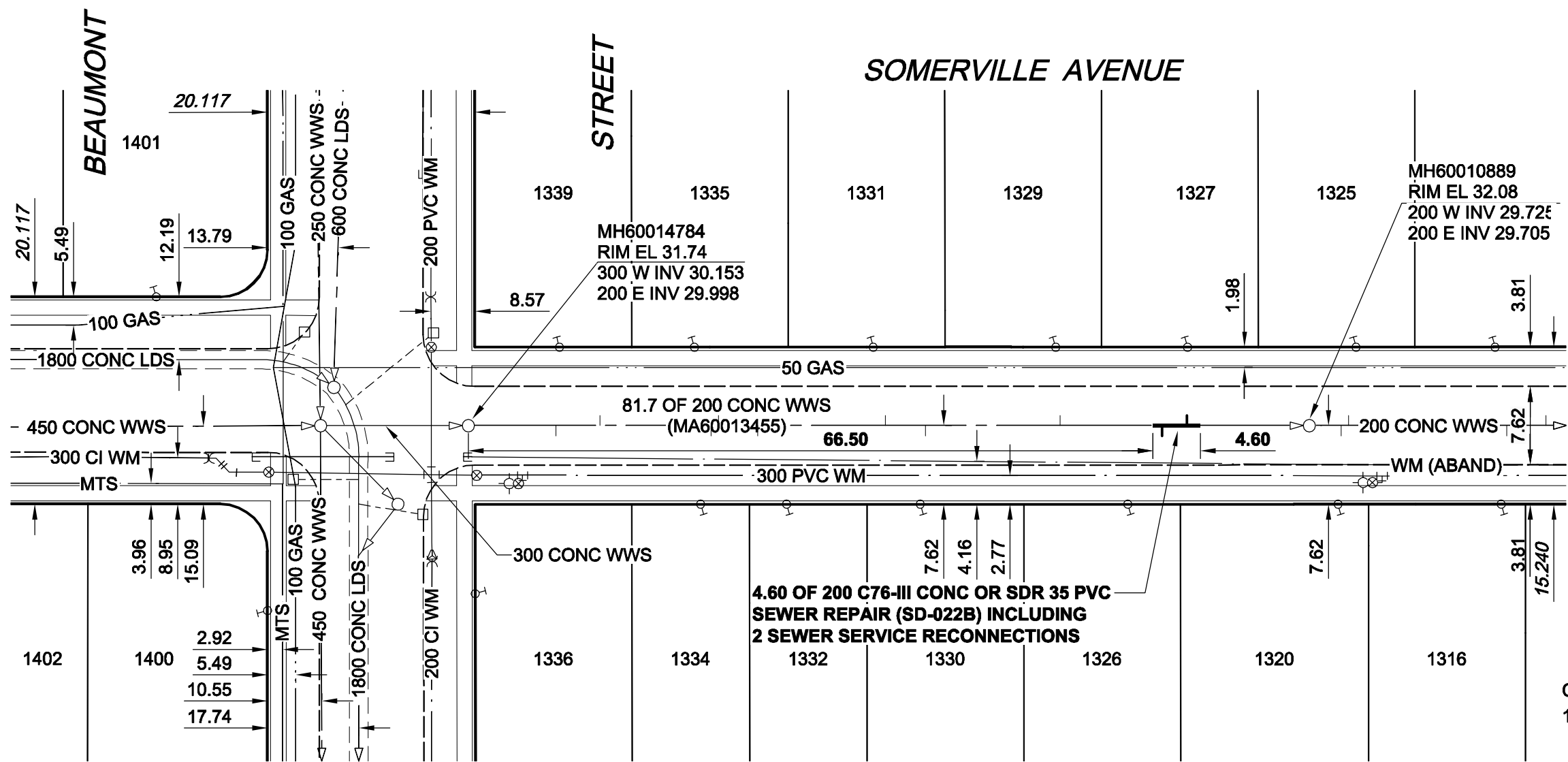
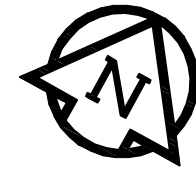

SEWER JUNCTION INFORMATION*

REF. MH	DIST FROM REF. MH	SIZE	CLOCK AT
MH60014784	8.50	100Ø	02
MH60014784	12.80	100Ø	10
MH60014784	23.60	100Ø	02
MH60014784	24.30	100Ø	10
MH60014784	28.10	100Ø	02
MH60014784	30.70	100Ø	02
MH60014784	40.50	100Ø	10
MH60014784	44.40	100Ø	02
MH60014784	57.50	100Ø	10
MH60014784	67.40	100Ø	02
MH60014784	69.80	100Ø	10

*JUNCTION INFORMATION FROM VIDEO INSPECTION

- CONSTRUCTION NOTES:**
1. CONTRACTOR TO VERIFY LIMITS OF SEWER REPAIRS PRIOR TO EXCAVATION BY MEANS OF VIDEO INSPECTION.
 2. CONTRACTOR TO PROVIDE VIDEO INSPECTION OF SEWER SERVICES WITHIN LIMITS OF REPAIR IN PRESENCE OF CONTRACT ADMINISTRATOR TO DETERMINE IF SERVICE RENEWAL IS REQUIRED.
 3. ALL BACKFILL TO BE CLASS 5 BACKFILL UNDER BOULEVARDS AND CLASS 3 UNDER OR WITHIN 1.0m OF PAVEMENTS AND SIDEWALKS.

WARNING
 IF POWER EQUIPMENT OR EXPLOSIVES ARE TO BE USED FOR EXCAVATION ON THIS PROJECT, THE CONTRACTOR MUST:
 1) NOTIFY THE GAS COMPANY OF THE PROPOSED LOCATION OF EXCAVATION.
 2) TAKE PRECAUTION TO AVOID DAMAGE TO GAS COMPANY INSTALLATIONS.
 SEE PROVINCIAL REGULATION 140/92 FOR DETAILS

METRIC
 WHOLE NUMBERS INDICATE MILLIMETRES
 DECIMALIZED NUMBERS INDICATE METRES

AECOM
 Certificate of Authorization
 AECOM Canada Ltd.
 No. 4671 Date: 09/07/29

BID OPPORTUNITY NO. 374-2009

AECOM REVIEW	ADL	LOCATION APPROVED		N. side Somerville Ave., E. of Planet St., Tbt. in E. Conc. foundation of No. 1431 Somerville Ave., 1.0m N. & 0.3m below stucco of S.E. Cor. of house.	
	DRAFT	UNDERGROUND STRUCTURES		BM 65-015 ELEV 232.691m	
REVIEW	CHK	SUPR. U/G STRUCTURES		DATE	
REVIEW	ADL	NOTE:			
		LOCATION OF UNDERGROUND STRUCTURES AS SHOWN ARE BASED ON THE BEST INFORMATION AVAILABLE. BUT NO GUARANTEE IS GIVEN THAT ALL EXISTING UTILITIES ARE SHOWN OR THAT THE GIVEN LOCATIONS ARE EXACT. CONFIRMATION OF EXISTENCE AND EXACT LOCATION OF ALL SERVICES MUST BE OBTAINED FROM THE INDIVIDUAL UTILITIES BEFORE PROCEEDING WITH CONSTRUCTION.			
		0	ISSUED FOR CONSTRUCTION	09/07/24	KMB
		NO.	REVISIONS	YY/MM/DD	BY

AECOM			
DESIGNED BY	PL	CHECKED BY	ALD
DRAWN BY	KMB	APPROVED BY	KWF
HOR. SCALE	1:500	RELEASED FOR CONSTRUCTION	KZ
VERT. SCALE	N/A		
DATE	09/07/29	DATE	July 30/09

PROFESSIONAL'S SEAL
 ISSUED FOR CONSTRUCTION
 WAS SEALED BY
 K. W. FITCHETT
 AND DATED
 JULY 29/09
 CONSULTANT DRAWING NO.
 D265-244-02_01-C-1030_RX.dwg

THE CITY OF WINNIPEG
WATER AND WASTE DEPARTMENT

2009 WASTE WATER SEWER RENEWALS BY REPAIRS AND REPLACEMENTS CONTRACT 18

SOMERVILLE AVENUE
 BEAUMONT STREET
 TO 87m W OF DANIEL STREET

SHEET 30 OF 35
 CITY DRAWING NUMBER
8900 REV 0