

SOMERVILLE AVENUE

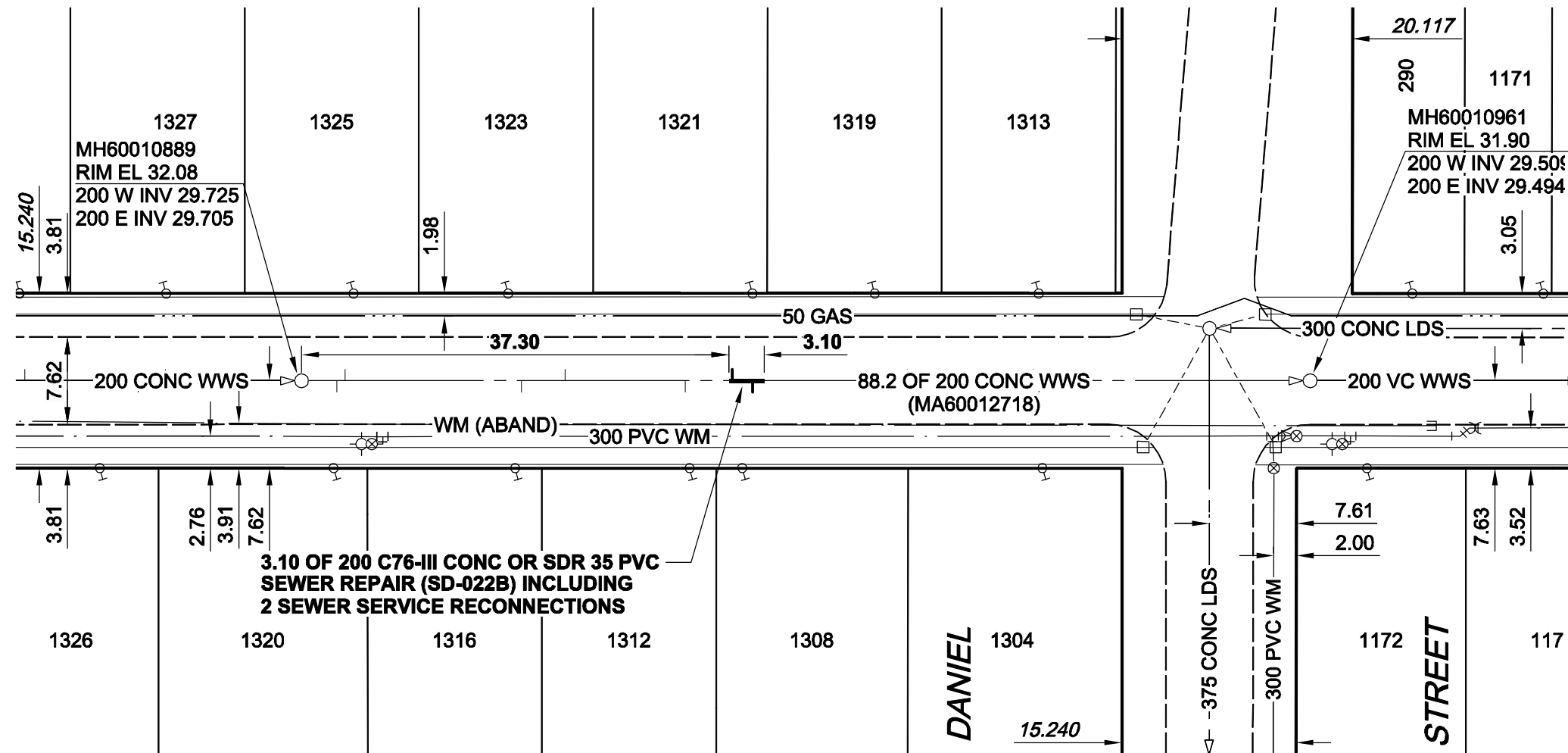
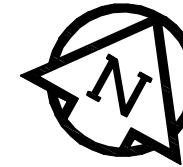

SEWER JUNCTION INFORMATION*

REF. MH	DIST FROM REF. MH	SIZE	CLOCK AT
MH60010889	3.10	100Ø	02
MH60010889	3.80	100Ø	10
MH60010889	19.20	100Ø	02
MH60010889	23.00	100Ø	10
MH60010889	33.50	100Ø	02
MH60010889	33.50	100Ø	02
MH60010889	37.60	100Ø	10
MH60010889	39.40	100Ø	02
MH60010889	52.90	100Ø	10
MH60010889	63.90	100Ø	10
MH60010889	64.40	100Ø	02

*JUNCTION INFORMATION FROM VIDEO INSPECTION

CONSTRUCTION NOTES:

1. CONTRACTOR TO VERIFY LIMITS OF SEWER REPAIRS PRIOR TO EXCAVATION BY MEANS OF VIDEO INSPECTION.
2. CONTRACTOR TO PROVIDE VIDEO INSPECTION OF SEWER SERVICES WITHIN LIMITS OF REPAIR IN PRESENCE OF CONTRACT ADMINISTRATOR TO DETERMINE IF SERVICE RENEWAL IS REQUIRED.
3. ALL BACKFILL TO BE CLASS 5 BACKFILL UNDER BOULEVARDS AND CLASS 3 UNDER OR WITHIN 1.0m OF PAVEMENTS AND SIDEWALKS.

WARNING

IF POWER EQUIPMENT OR EXPLOSIVES ARE TO BE USED FOR EXCAVATION ON THIS PROJECT, THE CONTRACTOR MUST:

- 1) NOTIFY THE GAS COMPANY OF THE PROPOSED LOCATION OF EXCAVATION.
 - 2) TAKE PRECAUTION TO AVOID DAMAGE TO GAS COMPANY INSTALLATIONS.
- SEE PROVINCIAL REGULATION 140/92 FOR DETAILS

METRIC
WHOLE NUMBERS INDICATE MILLIMETRES
DECIMALIZED NUMBERS INDICATE METRES



Certificate of Authorization

AECOM Canada Ltd.

No. 4671 Date: 09/07/29

BID OPPORTUNITY NO. 374-2009

LOCATION APPROVED UNDERGROUND STRUCTURES

BM 65-015 ELEV 232.691m	N. side Somerville Ave., E. of Planet St., Tbt. in E. Conc. foundation of No. 1431 Somerville Ave., 1.0m N. & 0.3m below stucco of S.E. Cor. of house.		
0	ISSUED FOR CONSTRUCTION	09/07/24	KMB
NO.	REVISIONS	YY/MM/DD	BY

AECOM			
DESIGNED BY PL			
DRAWN BY KMB			
HOR. SCALE 1:500			
VERT. SCALE N/A			
DATE 09/07/29			
CHECKED BY ALD		APPROVED BY KWF	
RELEASED FOR CONSTRUCTION		KZ	
DATE July 30/09		DATE July 30/09	

PROFESSIONAL'S SEAL
ISSUED FOR CONSTRUCTION
WAS SEALED BY
K. W. FITCHETT
AND DATED
JULY 29/09
CONSULTANT DRAWING NO.
D265-244-02_01-C-1029_RX.dwg

THE CITY OF WINNIPEG

WATER AND WASTE DEPARTMENT

2009 WASTE WATER SEWER RENEWALS BY REPAIRS AND REPLACEMENTS CONTRACT 18

SOMERVILLE AVENUE
66m E OF BEAUMONT STREET
TO DANIEL STREET

SHEET 29 OF 35

CITY DRAWING NUMBER

8899

REV 0

B SIZE 11" x 17" (279mm x 432mm) FILE NAME: D265-244-02_01-C-1029_RX.dwg Saved By: berarok PLOT: 7/30/2009 4:18:57 PM

AECOM REVIEW DRAFT CHK ADL