

MARS DRIVE (W LEG)

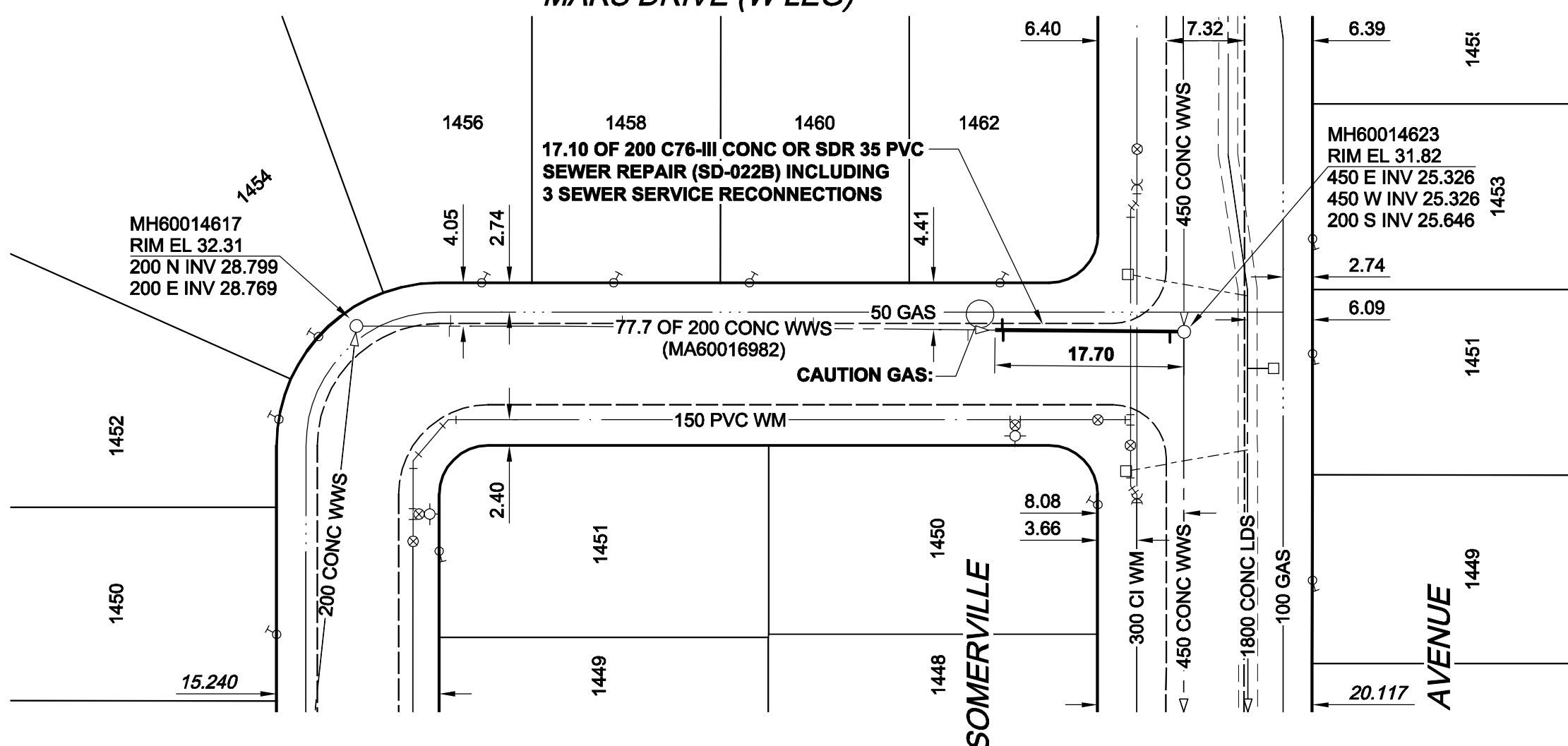

SEWER JUNCTION INFORMATION*

REF. MH	DIST FROM REF. MH	SIZE	CLOCK AT
MH60014617	8.70	150Ø	01
MH60014617	8.80	150Ø	10
MH60014617	24.90	150Ø	10
MH60014617	41.10	150Ø	10
MH60014617	42.80	150Ø	11
MH60014617	57.30	150Ø	02
MH60014617	60.50	150Ø	10
MH60014617	60.60	150Ø	01
MH60014617	76.20	150Ø	06

*JUNCTION INFORMATION FROM VIDEO INSPECTION

CONSTRUCTION NOTES:

1. CONTRACTOR TO VERIFY LIMITS OF SEWER REPAIRS PRIOR TO EXCAVATION BY MEANS OF VIDEO INSPECTION.
2. CONTRACTOR TO PROVIDE VIDEO INSPECTION OF SEWER SERVICES WITHIN LIMITS OF REPAIR IN PRESENCE OF CONTRACT ADMINISTRATOR TO DETERMINE IF SERVICE RENEWAL IS REQUIRED.
3. ALL BACKFILL TO BE CLASS 5 BACKFILL UNDER BOULEVARDS AND CLASS 3 UNDER OR WITHIN 1.0m OF PAVEMENTS AND SIDEWALKS.

WARNING

IF POWER EQUIPMENT OR EXPLOSIVES ARE TO BE USED FOR EXCAVATION ON THIS PROJECT, THE CONTRACTOR MUST:
 1) NOTIFY THE GAS COMPANY OF THE PROPOSED LOCATION OF EXCAVATION.
 2) TAKE PRECAUTION TO AVOID DAMAGE TO GAS COMPANY INSTALLATIONS.
 SEE PROVINCIAL REGULATION 140/92 FOR DETAILS

METRIC
 WHOLE NUMBERS INDICATE MILLIMETRES
 DECIMALIZED NUMBERS INDICATE METRES

AECOM
 Certificate of Authorization
 AECOM Canada Ltd.
 No. 4671 Date: 09/07/29

BID OPPORTUNITY NO. 374-2009

AECOM REVIEW DRAFT CHK ADL

NO.	REVISIONS	YY/MM/DD	BY
0	ISSUED FOR CONSTRUCTION	09/07/24	KMB

BM 65-015 ELEV 232.691m	N. side Somerville Ave., E. of Planet St., Tbt. in E. Conc. foundation of No. 1431 Somerville Ave., 1.0m N. & 0.3m below stucco of S.E. Cor. of house.
----------------------------	---

AECOM			
DESIGNED BY	PL	CHECKED BY	ALD
DRAWN BY	KMB	APPROVED BY	KWF
HOR. SCALE	1:500	RELEASED FOR CONSTRUCTION	KZ
VERT. SCALE	N/A	DATE	July 30/09
DATE	09/07/29	DATE	July 30/09

PROFESSIONAL'S SEAL
 ISSUED FOR CONSTRUCTION
 WAS SEALED BY
 K. W. FITCHETT
 AND DATED
 JULY 29/09
 CONSULTANT DRAWING NO.
 D265-244-02_01-C-1017_RX.dwg

THE CITY OF WINNIPEG
WATER AND WASTE DEPARTMENT

**2009 WASTE WATER SEWER RENEWALS
 BY REPAIRS AND REPLACEMENTS
 CONTRACT 18**

**MARS DRIVE (W LEG)
 MARS DRIVE (S LEG)
 TO SOMERVILLE AVENUE**

SHEET 17 OF 35
 CITY DRAWING NUMBER
8887 REV 0

B SIZE 11" x 17" (279mm x 432mm) PLOT: 7/30/2009 3:48:36 PM FILE NAME: D265-244-02_01-C-1017_RX.dwg Saved By: berarok