

INKSTER BOULEVARD

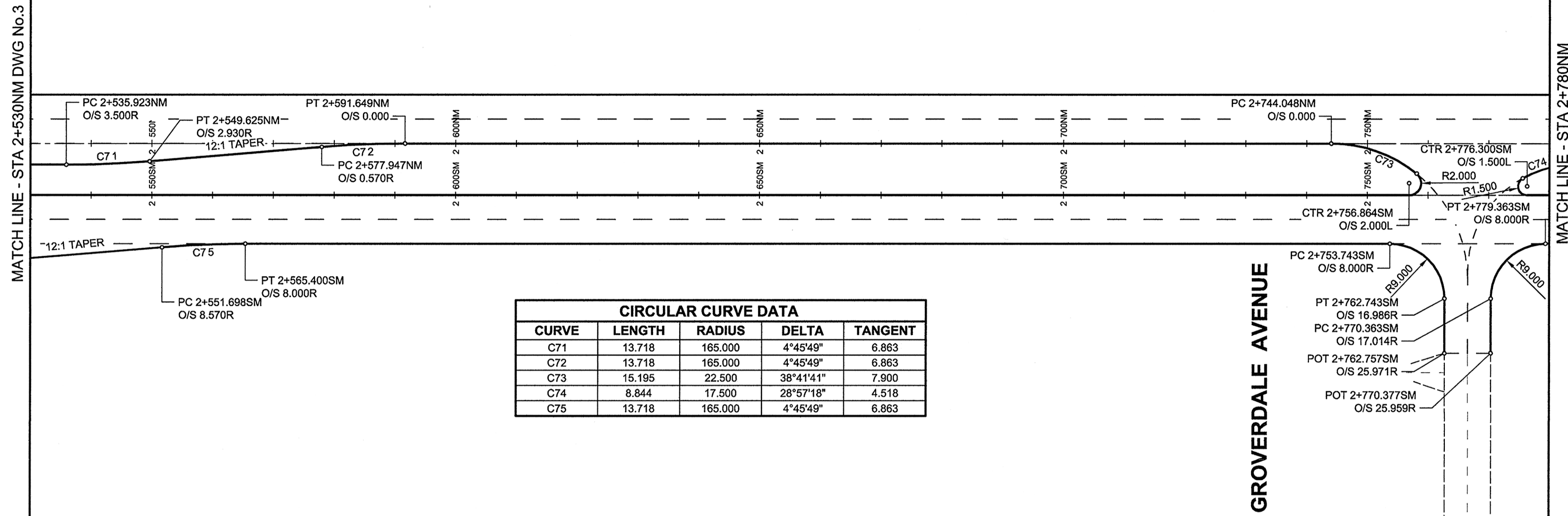

CIRCULAR CURVE DATA				
CURVE	LENGTH	RADIUS	DELTA	TANGENT
C71	13.718	165.000	4°45'49"	6.863
C72	13.718	165.000	4°45'49"	6.863
C73	15.195	22.500	38°41'41"	7.900
C74	8.844	17.500	28°57'18"	4.518
C75	13.718	165.000	4°45'49"	6.863

INKSTER BOULEVARD

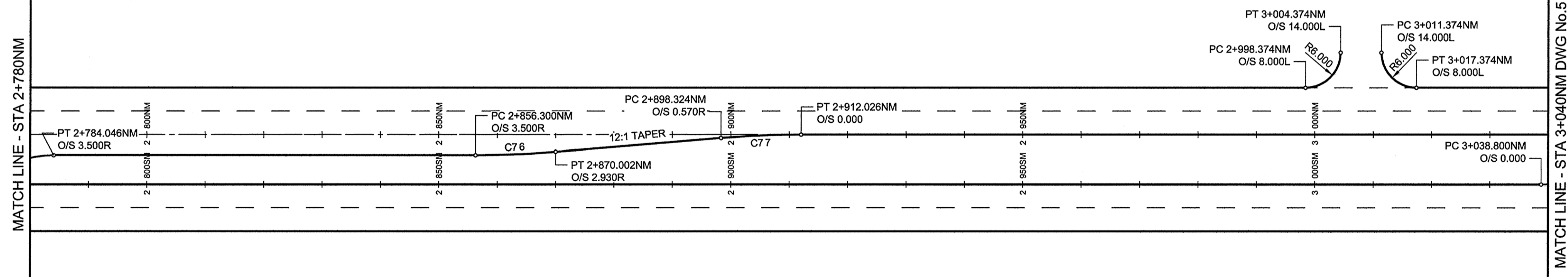

CIRCULAR CURVE DATA				
CURVE	LENGTH	RADIUS	DELTA	TANGENT
C76	13.718	165.000	4°45'49"	6.863
C77	13.718	165.000	4°45'49"	6.863

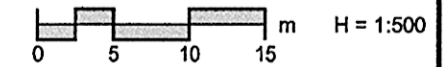

**APEGM**  
 Certificate of Authorization  
 AECOM Canada Ltd.  
 No. 4671 Date: July 15, 09

BID OPPORTUNITY NO. 368-2009

**LOCATION APPROVED**  
 UNDERGROUND STRUCTURES

SUPR. U/G STRUCTURES DATE COMMITTEE

**NOTE:**  
 LOCATION OF UNDERGROUND STRUCTURES AS SHOWN ARE BASED ON THE BEST INFORMATION AVAILABLE. BUT NO GUARANTEE IS GIVEN THAT ALL EXISTING UTILITIES ARE SHOWN OR THAT THE GIVEN LOCATIONS ARE EXACT. CONFIRMATION OF EXISTENCE AND EXACT LOCATION OF ALL SERVICES MUST BE OBTAINED FROM THE INDIVIDUAL UTILITIES BEFORE PROCEEDING WITH CONSTRUCTION.

NO.	REVISIONS	DATE	BY
0	ISSUED FOR CONSTRUCTION	09/07/15	DID
		YYMMDD	

**AECOM**

DESIGNED BY: WRJ  
 CHECKED BY: RPB  
 DRAWN BY: DID  
 APPROVED BY: TGS

HOR. SCALE: 1:500  
 VERT. SCALE: N/A

RELEASED FOR CONSTRUCTION

DATE: 09/07/15

PROFESSIONAL'S SEAL

PROVINCE OF MANITOBA  
 REGISTERED PROFESSIONAL ENGINEER  
 R. P. BRUCE  
 CONSULTANT DRAWING NO.  
 0265-411-00\_03-CT1004\_RX.dwg

**THE CITY OF WINNIPEG**  
 PUBLIC WORKS DEPARTMENT  
 ENGINEERING DIVISION

**INKSTER BOULEVARD  
 WIDENING PROJECT  
 BROOKSIDE BOULEVARD  
 TO KEEWATIN STREET**  
 HORIZONTAL GEOMETRY  
 STA 2+530NM TO STA 3+040NM

CITY DRAWING NUMBER: P-3301-4  
 SHEET: 4 OF 31  
 DRAWING No.: 4  
 REV: 0

**METRIC**  
 WHOLE NUMBERS INDICATE MILLIMETRES  
 DECIMALIZED NUMBERS INDICATE METRES