

236.0  
 235.0  
 234.0  
 233.0  
 232.0  
 231.0  
 230.0  
 229.0  
 228.0  
 227.0

236.0  
 235.0  
 234.0  
 233.0  
 232.0  
 231.0  
 230.0  
 229.0  
 228.0  
 227.0

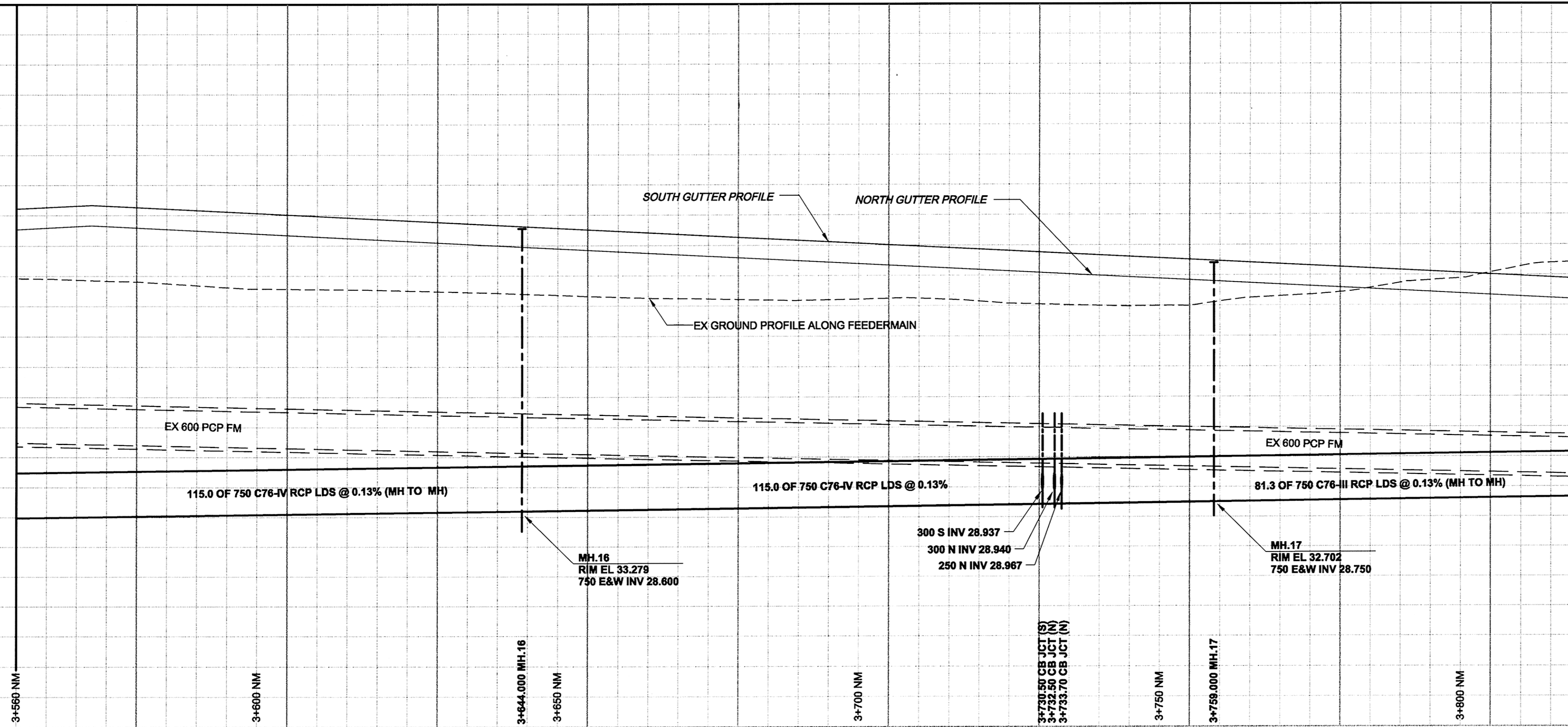

CHAINAGE ALONG NORTH MEDIAN CONTROL LINE

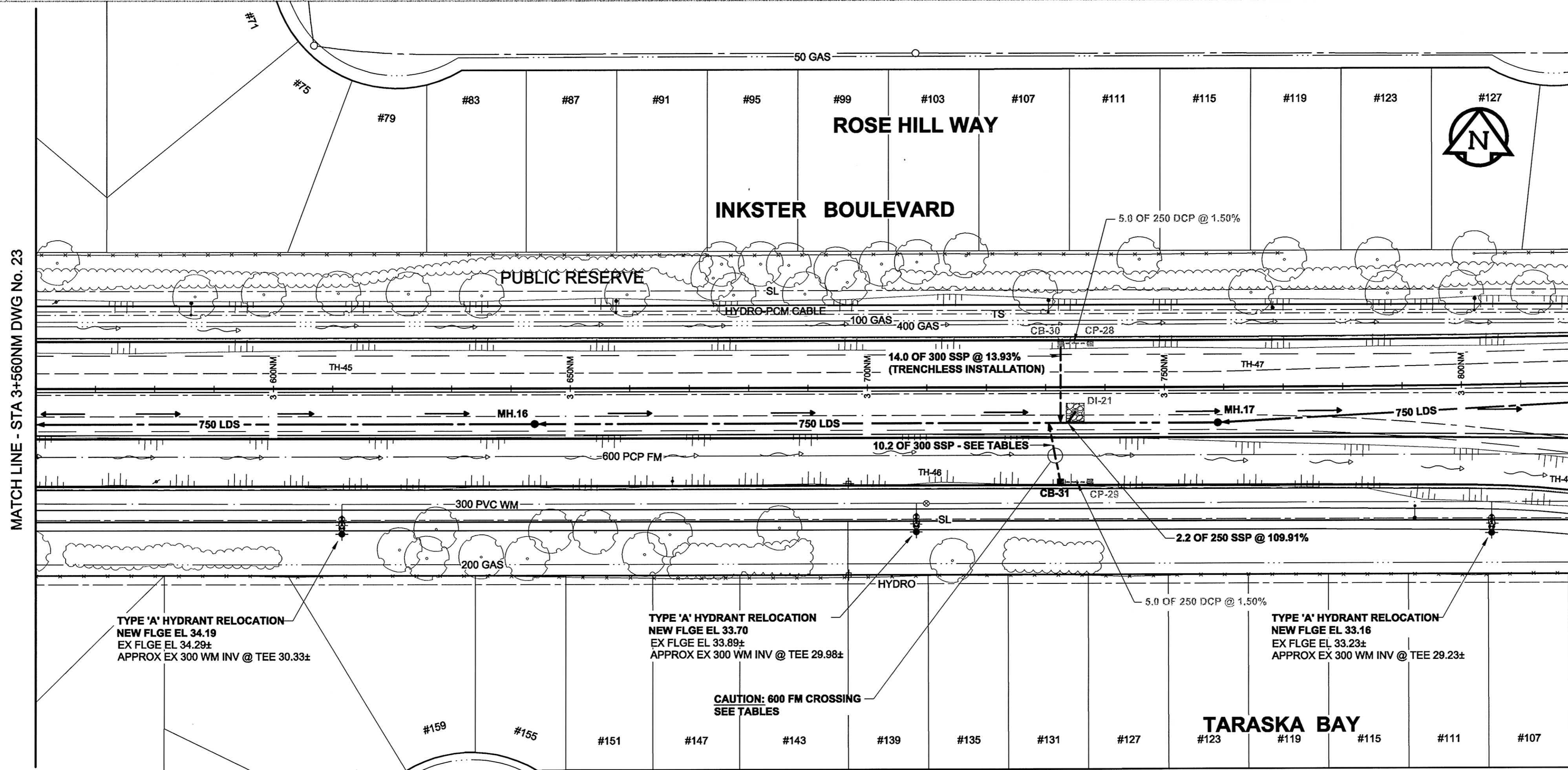

GENERAL CONSTRUCTION NOTES:

- BACKFILL TO BE CLASS 3 UNLESS NOTED OTHERWISE.
- INSTALLATION OF ALL LDS TO BE IN A TRENCH UNLESS OTHERWISE NOTED.
- SEE SPECIFICATION FOR DETAILS & RESTRICTIONS WHEN WORKING AROUND EXISTING 600 FEEDERMAIN.
- REFER TO STRUCTURE & LOCATION SCHEDULE ON DRAWING 31 FOR FURTHER CATCHBASIN, CATCH PIT, DITCH INLET & MANHOLE DETAILS.
- TEMPORARILY PLUG SSP STUBS & BACKFILL AS PER THE DIRECTION OF THE CONTRACT ADMINISTRATOR.
- ALL HYDRANT RELOCATIONS ARE TO BE 0.5m SOUTH OF THE FUTURE MULTI-USE PATH.
- SEE DRAWING 26 FOR TYPICAL LDS INSTALLATION TRENCH WHEN THE LDS IS NEAR THE EXISTING 600 FEEDERMAIN.

MATCH LINE - STA 3+560NM DWG No. 23

MATCH LINE - STA 3+820NM DWG No. 25

TYPE 'A' HYDRANT RELOCATION  
 NEW FLGE EL 34.19  
 EX FLGE EL 34.29±  
 APPROX EX 300 WM INV @ TEE 30.33±

TYPE 'A' HYDRANT RELOCATION  
 NEW FLGE EL 33.70  
 EX FLGE EL 33.89±  
 APPROX EX 300 WM INV @ TEE 29.98±

TYPE 'A' HYDRANT RELOCATION  
 NEW FLGE EL 33.16  
 EX FLGE EL 33.23±  
 APPROX EX 300 WM INV @ TEE 29.23±

CAUTION: 600 FM CROSSING  
 SEE TABLES

150 WM	WATERMAIN	150 WM	○	CURB STOP	○	150 WM	WATERMAIN	○	LOCATION APPROVED
○	HYDRANT	○	○	REDUCER	○	○	HYDRANT	○	UNDERGROUND STRUCTURES
○	VALVE	○	○	COUPLING	○	○	VALVE	○	
○	LAND DRAINAGE SEWER	○	○	ANODE	○	○	LAND DRAINAGE SEWER	○	SUPR. U/G STRUCTURES DATE COMMITTEE
○	WASTE WATER SEWER	○	○	HYDRO	○	○	WASTE WATER SEWER	○	NOTE:
○	MANHOLE	○	○	MTS	○	○	PAVEMENT CROWN	○	LOCATION OF UNDERGROUND STRUCTURES AS SHOWN ARE BASED ON THE BEST INFORMATION AVAILABLE. BUT NO GUARANTEE IS GIVEN THAT ALL EXISTING UTILITIES ARE SHOWN OR THAT THE GIVEN LOCATIONS ARE EXACT. CONFIRMATION OF EXISTENCE AND EXACT LOCATION OF ALL SERVICES MUST BE OBTAINED FROM THE INDIVIDUAL UTILITIES BEFORE PROCEEDING WITH CONSTRUCTION.
○	CATCH BASIN	○	○	GAS	○	○	N/W PROPERTY LINE	○	
○	CURB INLET	○	○	TESTHOLE	○	○	S/E PROPERTY LINE	○	
○	CULVERT	○	○	LAMP STANDARD	○	○	N/W GUTTER	○	
○	PIPE ABANDONMENTS	○	○	TREE	○	○	S/E GUTTER	○	
○	SURVEY BAR	○	○		○	○		○	
○	EXISTING	○	○	LEGEND - PLAN	○	○	LEGEND - PROFILE	○	
○	NEW	○	○	LEGEND - PLAN	○	○	NEW	○	

NO.	REVISIONS	DATE	BY
0	ISSUED FOR CONSTRUCTION	06/07/15	WJD
		YYMMDD	

DESIGNED BY	DME	CHECKED BY	<i>[Signature]</i>
DRAWN BY	WJD	APPROVED BY	<i>[Signature]</i>
HOR. SCALE	1:500	RELEASED FOR CONSTRUCTION	<i>[Signature]</i>
VERT. SCALE	1:50	DATE	July 15, 2009
DATE	09/07/15	CONSULTANT DRAWING NO.	0285-411-00_01-C-1009_RX.dwg

© 2009 AECOM Canada Ltd. All Rights Reserved. This document is protected by copyright law and may not be used, reproduced or modified in any manner or for any purpose except with the written permission of AECOM Canada Ltd. (AECOM) or a party to which its copyright has been assigned. AECOM accepts no responsibility, and denies any liability whatsoever, to any party that uses, reproduces, modifies, or relies on this document without AECOM's express written consent.

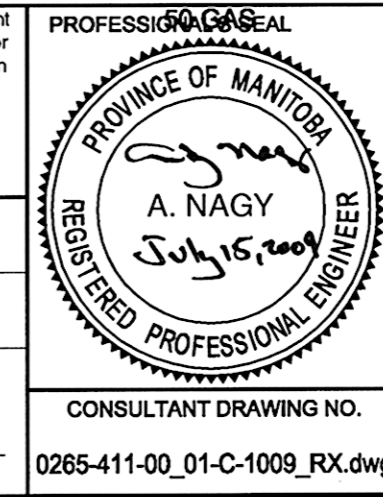

**THE CITY OF WINNIPEG**  
 PUBLIC WORKS DEPARTMENT  
 ENGINEERING DIVISION

**INKSTER BOULEVARD WIDENING PROJECT**  
 BROOKSIDE BOULEVARD TO KEEWATIN STREET  
 LAND DRAINAGE SYSTEM  
 STA 3+560 TO STA 3+820

CITY DRAWING NUMBER P-3301-24  
 SHEET 24 OF 31  
 DRAWING No. 24  
 REV 0

PROFESSIONAL ENGINEER  
 A. NAGY  
 July 15, 2009

CONSULTANT DRAWING NO. 0285-411-00\_01-C-1009\_RX.dwg

BID OPPORTUNITY NO. 368-2009