

ADDRESS	SIZE (mm) & TYPE (STREET)	SHORT & LONG MEASUREMENT	CORP. LOCATION	REMARKS
#400 DAY ST. COMMERCIAL	50 COPPER	19.2 N/S HST LINE	-	MD-TOWN ASSESSD UNDER ROAD USED TRANSIT 150 PIPECEMENT USED SADDLE
#400 DAY ST. COMMERCIAL	19 COPPER	5.9 N/S HSE LINE	-	
#415 DAY ST. RESIDENTIAL	19 COPPER	0.3 WEL. OF HOUSE 6.4 FROM HSE FRONT	1.5 E E H/L	
#501 DAY ST. RESIDENTIAL	19 COPPER	4.5 NSL. OF HOUSE 0.3 STREET LINE	-	LOT S 1/2 OF 5, 6
#525 DAY ST. COMMERCIAL	NO INFO	7.9 W/E BUILDING LINE	-	JUL23/03 S/B 50 BELOW GRADE 429/H/L DW
#105/107 YALE AVE E RESIDENTIAL	19 COPPER	2.4 E W H/L 8.2 OUT	-	DUPLEX SING SERV-M LALT MET W/105
#111 YALE AVE E RESIDENTIAL	19 COPPER	2.4 E W/L BLDG. 5.2 OUT	2.7 E W/L BLDG.	
#111 YALE AVE E RESIDENTIAL	19 COPPER	2.1 E OF W. LINE 6.9 FR. HSE. FR.	OPP S/C	
#114 YALE AVE E RESIDENTIAL	150 UNKNOWN	1.7 E W/L BLDG. 7.8 OUT	-	
#114 YALE AVE E RESIDENTIAL	150 UNKNOWN	1.4 W. E. LINE 5.8 OUT	-	
#115 YALE AVE E RESIDENTIAL	19 COPPER	0.5 W. E. LINE 5.8 OUT	-	
#115 YALE AVE E RESIDENTIAL	19 COPPER	0.6 W. E/L BLDG. 6.1 FR. HSE. FR.	1.7 E S/C	

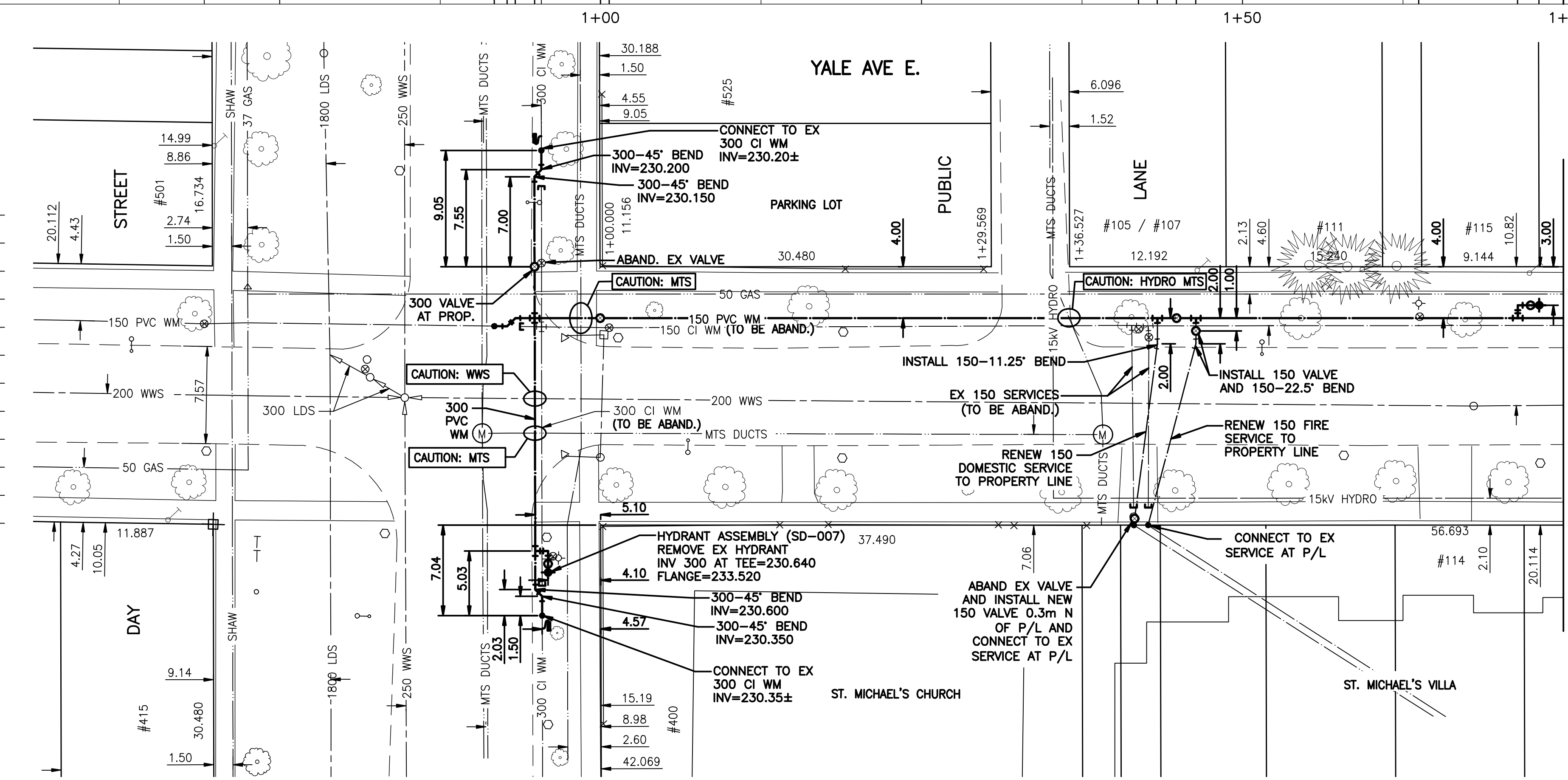

- NOTES:**
- CONTRACTOR TO EXPOSE EXISTING WATERMANS AT THE IN'S AND CONFIRM INVERTS OF PIPE.
 - CONTRACTOR TO FOLLOW LATEST VERSION OF THE CITY OF WINNIPEG STANDARD CONSTRUCTION SPECIFICATION. WATERMANS TO BE INSTALLED BY TRENCHLESS METHODS.
 - CLASS 3 BACKFILL TO BE USED WITHIN 1 METER OF PAVED SURFACES.
 - CONTRACTOR TO NOTIFY RESIDENTS AT LEAST 24 HOURS PRIOR TO ANY DISRUPTION OF WATER SERVICE.

MATCH LINE 1+75
SEE DRAWING D-11774

WARNING

IF POWER EQUIPMENT OR EXPLOSIVES ARE TO BE USED FOR EXCAVATION ON THIS PROJECT THE CONTRACTOR MUST:
 1) NOTIFY THE GAS COMPANY OF THE PROPOSED LOCATION OF EXCAVATION.
 2) TAKE PRECAUTION TO AVOID DAMAGE TO GAS COMPANY INSTALLATIONS.
 SEE PROVINCIAL REGULATION 140/92 FOR DETAILS

METRIC

WHOLE NUMBERS INDICATE MILLIMETRES
 DECIMALIZED NUMBERS INDICATE METRES

BENCH MARK: 87R494 - S.W. Cor. Ravelston Ave. W. & Day St., Tblt. on top of 0.05m dia. x 2.4m iron tube, 7.0 m N. of S.L. Ravelston Ave. W. & 10.1 m E. of W.L. Day St.

NOTE: STATIONS ALONG N E OF YALE AVE E.

BID OPPORTUNITY 311-2009



150 WM		150 WM		HYDRO		150 WM		150 WM	
+	HYDRANT	+	HYDRANT	M.T.S.	CONCRETE	+	HYDRANT, VALVE	+	HYDRANT, VALVE
+	VALVE	+	VALVE	CONCRETE	CONCRETE	+	LAND DRAINAGE SEWER	+	LAND DRAINAGE SEWER
+	LAND DRAINAGE SEWER	+	LAND DRAINAGE SEWER	ASPHALT	ASPHALT	+	WASTE WATER SEWER	+	WASTE WATER SEWER
+	WASTE WATER SEWER	+	WASTE WATER SEWER	SIDEWALK	SIDEWALK	+	WASTE WATER SEWER	+	WASTE WATER SEWER
+	MANHOLE	+	MANHOLE	PROPERTY LINE	PROPERTY LINE	+	NORTH OR WEST GUTTER	+	NORTH OR WEST GUTTER
+	CATCH BASIN	+	CATCH BASIN	SURVEY BAR	SURVEY BAR	+	SOUTH OR EAST GUTTER	+	SOUTH OR EAST GUTTER
+	CURB INLET	+	CURB INLET	DITCH	DITCH	+	NORTH OR WEST P.	+	NORTH OR WEST P.
+	JUNCTIONS	+	JUNCTIONS	CURB STOP	CURB STOP	+	SOUTH OR EAST P.	+	SOUTH OR EAST P.
+	STREET REHABILITATION LIMIT	+	STREET REHABILITATION LIMIT	TREE	TREE	+	NORTH OR WEST DITCH	+	NORTH OR WEST DITCH
+	GAS	+	GAS	FENCE	FENCE	+	SOUTH OR EAST DITCH	+	SOUTH OR EAST DITCH
+	EXISTING	+	LEGEND-PLAN	+	PROPOSED	+	EXISTING	+	LEGEND-PROFILE
+	PROPOSED	+	EXISTING	+	LEGEND-PLAN	+	PROPOSED	+	LEGEND-PROFILE
+	PROPOSED	+	EXISTING	+	LEGEND-PLAN	+	PROPOSED	+	LEGEND-PROFILE

LOCATION APPROVED UNDERGROUND STRUCTURES	
SUPV. U/G STRUCTURES COMMITTEE	DATE
NOTE:	
LOCATION OF UNDERGROUND STRUCTURES AS SHOWN ARE BASED ON THE BEST INFORMATION AVAILABLE BUT NO GUARANTEE IS GIVEN THAT THE GIVEN LOCATIONS ARE EXACT CONFIRMATION OF EXISTENCE AND EXACT LOCATION OF ALL SERVICES MUST BE OBTAINED FROM THE INDIVIDUAL UTILITIES BEFORE PROCEEDING WITH CONSTRUCTION.	

NO.	REVISIONS	DATE	BY

Stantec Consulting Ltd.
 905 Waverley Street, Winnipeg, Manitoba
 Tel 204-489-5900 Fax 204-453-9012

DESIGNED BY	J.K.H.	CHECKED BY	H.A.K.
DRAWN BY	J.K.H.	APPROVED BY	H.A.K.
HOR. SCALE:	1:250	RELEASED FOR CONSTRUCTION:	
VERTICAL:	1:50	DATE	

ENGINEER'S SEAL
 ORIGINAL SEALED BY
 H.A. KATZ
 P. ENG.
 09.05.01
 CONSULTANT DRAWING NO.
 C-211

THE CITY OF WINNIPEG
 WATER AND WASTE DEPARTMENT
 ENGINEERING DIVISION

2009 WATERMAIN RENEWALS
 - CONTRACT 5
 YALE AVE EAST
 DAY STREET TO
 75.00 EEL OF DAY STREET

SHEET II OF 14
 CAD FILE DRAWING NUMBER
 I1210c-211-711.dwg
 CITY DRAWING NUMBER
 D-11773