

NOTE:
CHAINAGE IS ALONG CENTRELINE OF
ARTHUR WRIGHT CRESCENT (WEST LEG)
RIGHT-OF-WAY.

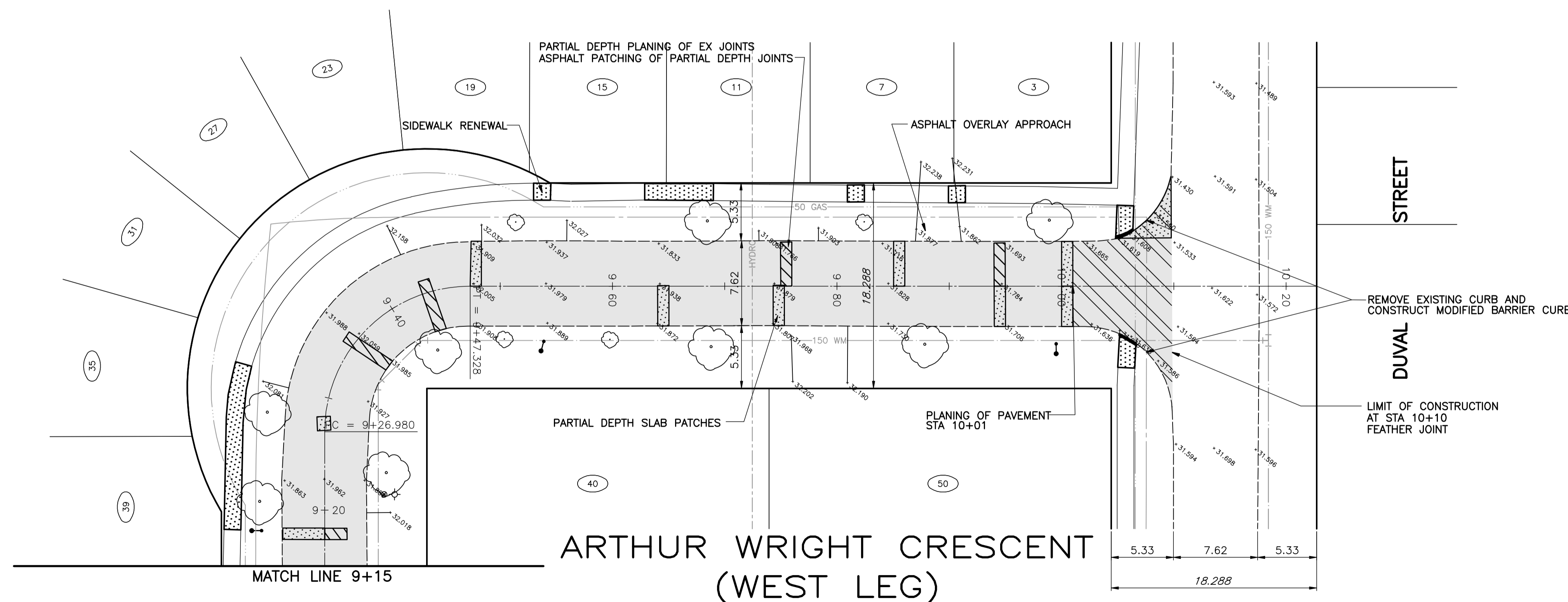

APEGN
Certificate of Authorization
Wardrop Engineering Inc.
No. 195 Expiry: April 30, 2009

150 WM	WATERMAIN	150 WM	○	MANHOLE	●	GAS	
400 FM	FEEDERMAIN	400 FM	□	CATCHBASIN	■	HYDRO	
300 LDS	LAND DRAINAGE SEWER	300 LDS	▽	CURB INLET	▼	MTS	
250 WWS	WASTEWATER SEWER	250 WWS	•	HYDRO POLE	×	ELEVATION	(32.000)
300 CS	COMBINED SEWER	300 CS	⊕	LIGHT STANDARD	⊕	SIDEWALK	
200 FCM	FORCEMAIN	200 FCM	⊖	ANCHOR	⊖	CURB	
	JUNCTIONS		⊕	TREE	⊕	ASPHALT	
⊕	HYDRANT	⊕	⊕	LEGAL DIMENSION	⊕	CONCRETE	
⊕	VALVE	⊕	⊕	SURVEY BAR	⊕		
⊕	CURB STOP	⊕	⊕	FENCE	⊕		
EXISTING	LEGEND-PLAN	PROPOSED	EXISTING	LEGEND-PLAN	PROPOSED	EXISTING	LEGEND-PLAN/PROFILE

LOCATION APPROVED UNDERGROUND STRUCTURES

SUPV. U/G STRUCTURES COMMITTEE DATE

NOTE: LOCATION OF UNDERGROUND STRUCTURES AS SHOWN ARE BASED ON THE BEST INFORMATION AVAILABLE. BUT NO GUARANTEE IS GIVEN THAT ALL EXISTING UTILITIES ARE SHOWN OR THAT THE GIVEN LOCATIONS ARE EXACT. CONFIRMATION OF EXISTENCE AND EXACT LOCATION OF ALL SERVICES MUST BE OBTAINED FROM THE INDIVIDUAL UTILITIES BEFORE PROCEEDING WITH CONSTRUCTION.

B.M. ELEV.	
DESIGNED BY	NH
CHECKED BY	
DRAWN BY	GMD
APPROVED BY	
HOR. SCALE:	1 : 250
VERTICAL:	1 : 10
RELEASED FOR CONSTRUCTION	
DATE	09.01.09

WARDROP | Engineering Inc.

00 ISSUED FOR TENDER 09.04.17 NH

NO. REVISIONS DATE BY

PRELIMINARY DRAWING

NOT TO BE USED FOR CONSTRUCTION

CONSULTANT DRAWING NO. 0900070200-SKT-C0016-00

THE CITY OF WINNIPEG
PUBLIC WORKS DEPARTMENT
ENGINEERING DIVISION

2009 LOCAL STREET RENEWALS
PAVEMENT REHABILITATION

ARTHUR WRIGHT CRESCENT (WEST LEG)
92m WEST OF DUVAL STREET TO
DUVAL STREET
STA 9+15 TO STA 10+10

CITY DRAWING NUMBER
SHEET 16 OF 21
C0016