

232.2  
232.0  
231.8  
231.6  
231.4  
231.2  
231.0

232.2  
232.0  
231.8  
231.6  
231.4  
231.2  
231.0

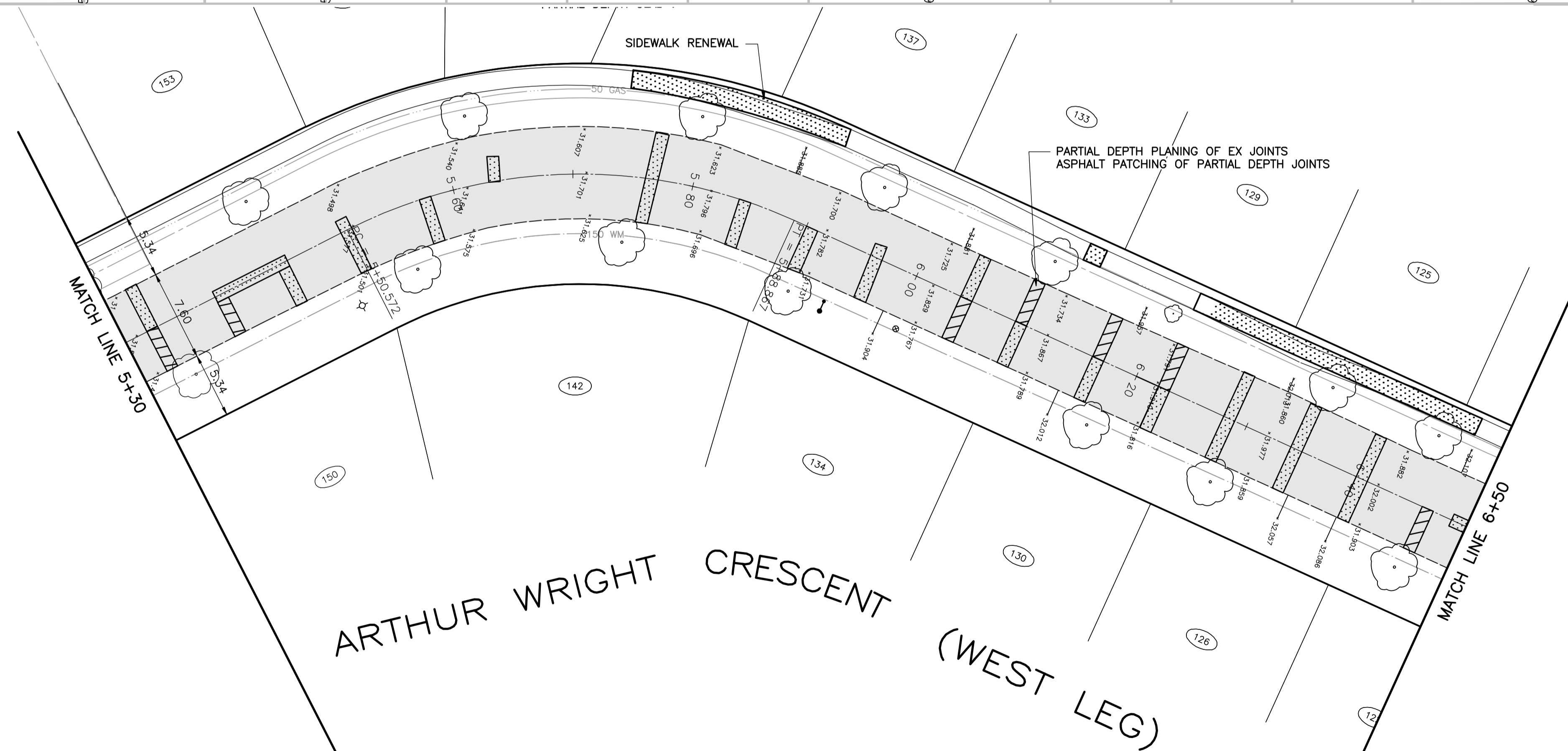
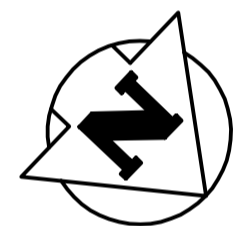
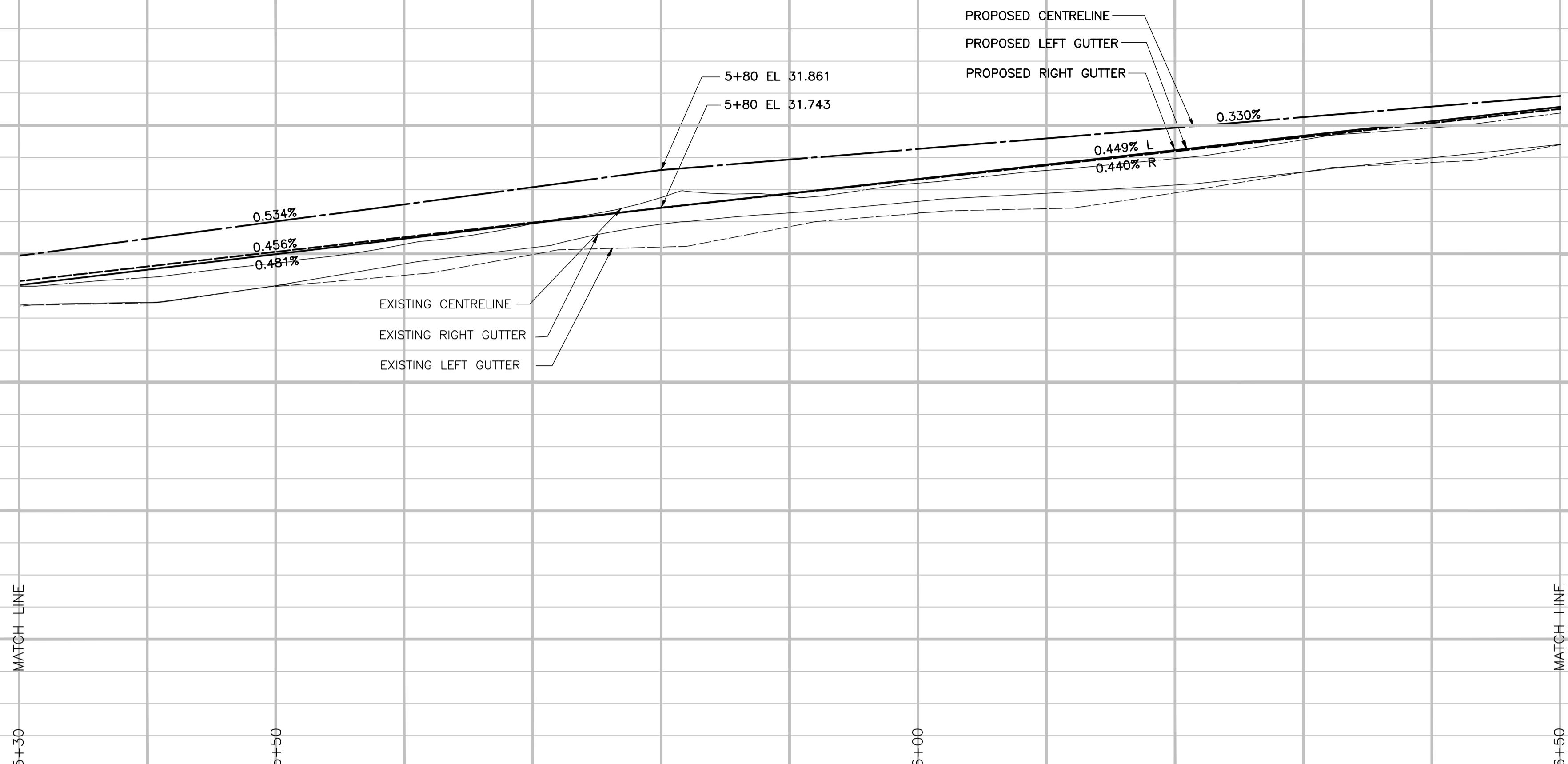

NOTE:  
CHAINAGE IS ALONG CENTRELINE OF  
ARTHUR WRIGHT CRESCENT (WEST LEG)  
RIGHT-OF-WAY.

**APEGN**  
Certificate of Authorization  
Wardrop Engineering Inc.  
No. 195 Expiry: April 30, 2009

150 WM	WATERMAIN	150 WM	○	MANHOLE	●	GAS	
400 FM	FEEDERMAIN	400 FM	□	CATCHBASIN	■	HYDRO	
300 LDS	LAND DRAINAGE SEWER	300 LDS	▽	CURB INLET	▼	MTS	
250 WWS	WASTEWATER SEWER	250 WWS	•	HYDRO POLE	×31.175	ELEVATION	(32.000)
300 CS	COMBINED SEWER	300 CS	⊕	LIGHT STANDARD		SIDEWALK	▨
200 FCM	FORCEMAIN	200 FCM	⊖	ANCHOR		CURB	▩
	JUNCTIONS		⊕	TREE		ASPHALT	▨
⊕	HYDRANT	⊕	15.240	LEGAL DIMENSION		CONCRETE	▩
⊕	VALVE	⊕		SURVEY BAR			
⊕	CURB STOP	⊕	×	FENCE			
EXISTING	LEGEND-PLAN	PROPOSED	EXISTING	LEGEND-PLAN	PROPOSED	EXISTING	LEGEND-PLAN/PROFILE

LOCATION APPROVED UNDERGROUND STRUCTURES

SUPV. U/G STRUCTURES DATE COMMITTEE

NOTE:  
LOCATION OF UNDERGROUND STRUCTURES AS SHOWN ARE BASED ON THE BEST INFORMATION AVAILABLE. BUT NO GUARANTEE IS GIVEN THAT ALL EXISTING UTILITIES ARE EXACT. CONFIRMATION OF EXISTENCE AND EXACT LOCATION OF ALL SERVICES MUST BE OBTAINED FROM THE INDIVIDUAL UTILITIES BEFORE PROCEEDING WITH CONSTRUCTION.

B.M. ELEV.	
00	ISSUED FOR TENDER
NO.	REVISIONS

<b>WARDROP   Engineering Inc.</b>	
DESIGNED BY	NH
CHECKED BY	
DRAWN BY	GMD
APPROVED BY	
HOR. SCALE:	1 : 250
VERTICAL:	1 : 10
RELEASED FOR CONSTRUCTION	
DATE	09.01.09

**PRELIMINARY DRAWING**

**NOT TO BE USED FOR CONSTRUCTION**

CONSULTANT DRAWING NO.  
0900070200-SKT-C0013-00

**THE CITY OF WINNIPEG**  
PUBLIC WORKS DEPARTMENT  
ENGINEERING DIVISION

2009 LOCAL STREET RENEWALS  
PAVEMENT REHABILITATION

ARTHUR WRIGHT CRESCENT (WEST LEG)  
13m WEST OF FILKOW BAY (W LEG) TO  
91m SOUTH OF MARGATE ROAD  
STA 5+30 TO STA 6+50

CITY DRAWING NUMBER  
SHEET 13 OF 21  
C0013