

- CONSTRUCTION NOTES FOR ROADWAY:**
1. STATIONING IN SOUTH GUTTER OF BISHOP GRANDIN BLVD. UNLESS NOTED OTHERWISE.
  2. STATIONING CONTINUES FROM 2007 REHABILITATION, SEE P-3284.
  3. SEE P-3300-22 FOR TYPICAL CROSS SECTIONS AND DETAILS.
  4. FINAL CURB HEIGHT TYPICALLY 75-100 mm. CURB TO BE REPLACED AS DIRECTED BY CONTRACT ADMINISTRATOR IF FINAL REVEAL IS LESS THAN 75 mm.
  5. ALL DIMENSIONS ARE TO BACK OF CURB.
  6. ADJUST OR REPLACE EXISTING DRAINAGE INLETS WITH NEW SD-024 OR SD-023 AS DIRECTED BY THE CONTRACT ADMINISTRATOR.
  7. ISOLATE MISCELLANEOUS ITEMS IN NEW CONCRETE WORKS AS PER SD-228C.
  8. PLANE HEADERS AT ALL INTERSECTING PUBLIC STREETS.
  9. LEGAL PLAN AND UNDERGROUND INFORMATION FROM CITY OF WINNIPEG LBIS.
  10. TRAFFIC SIGNAL POLES, CONTROLLERS AND UNDERGROUND APPURTENANCES IN PROJECT AREA TO BE UPGRADED BY OTHERS.
  11. CONTRACTOR TO TAKE PRECAUTIONARY STEPS TO AVOID DAMAGE FROM CONSTRUCTION ACTIVITIES TO TREES WITHIN THE LIMITS OF CONSTRUCTION.
  12. LOCATION OF EXISTING SERVICES TO BE CONFIRMED IN THE FIELD BY THE CONTRACTOR.
  13. PLANE EXISTING ASPHALT OVERLAY WITHIN CONTRACT LIMITS TO DEPTH INDICATED BY THE CONTRACT ADMINISTRATOR.
  14. LIMITS OF CURB AND GUTTER REPLACEMENT, JOINT AND SLAB REPAIRS, GRANULAR SHOULDER REGRADING, AND TIE INS TO BE FINALIZED IN THE FIELD BY THE CONTRACT ADMINISTRATOR.

**METRIC**

WHOLE NUMBERS INDICATE MILLIMETRES  
DECIMALIZED NUMBERS INDICATE METRES

**WARNING**

- IF POWER EQUIPMENT OR EXPLOSIVES ARE TO BE USED FOR EXCAVATION ON THIS PROJECT THE CONTRACTOR MUST:
1. NOTIFY THE GAS COMPANY OF THE PROPOSED LOCATION OF EXCAVATION.
  2. TAKE PRECAUTION TO AVOID DAMAGE TO GAS COMPANY INSTALLATIONS SEE PROVINCIAL REGULATION 210/72 FOR DETAILS.

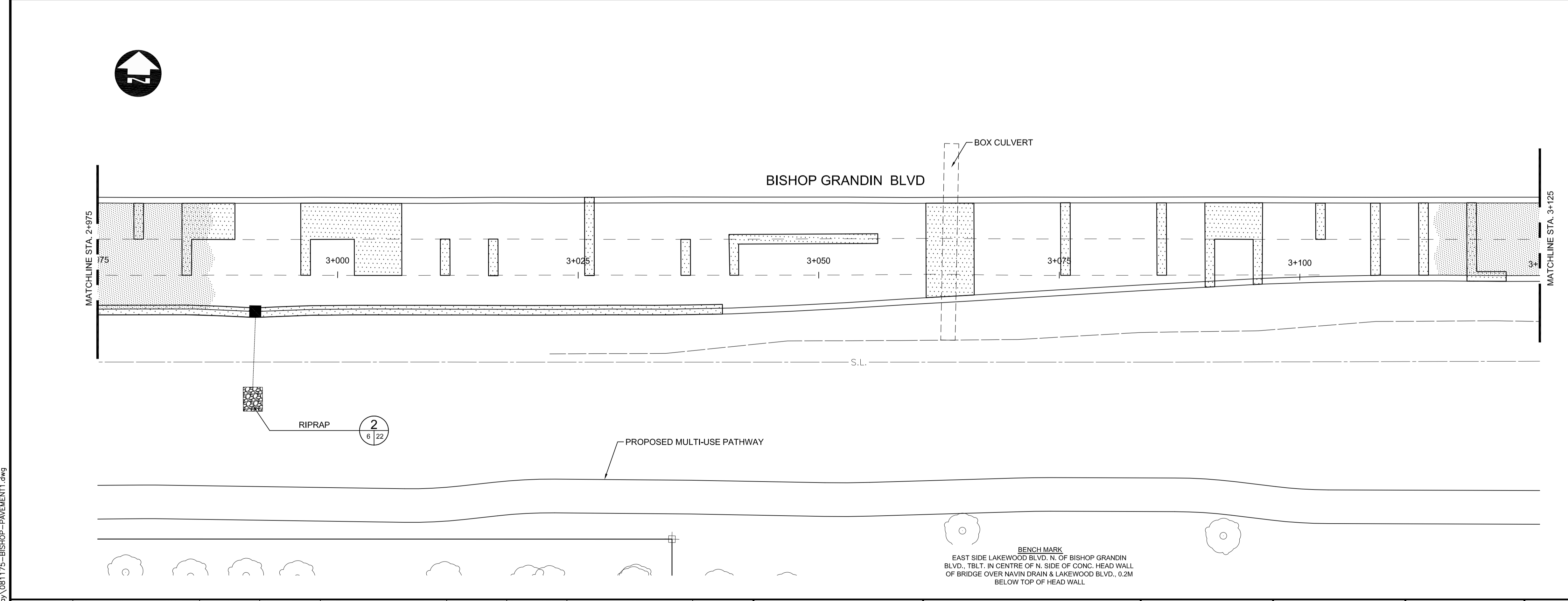

150 WM	150 WM	HYDRO	HYDRO	HYDRO	150 mm W.M.	WATERMAIN	150 mm W.M.
WATERMAIN	HYDRANT	MTS	CONCRETE	ASPHALT	PLANING	MANHOLE	CATCH BASIN
VALVE	LAND DRAINAGE SEWER	WASTE WATER SEWER	PAVING STONES	PARTIAL DEPTH REPAIR	PROPERTY LINE	SURVEY BAR	PARAPLEGIC RAMP
300 LDS	250 WWS	300 LDS	250 WWS	300 mm L.D.S.	250 mm W.W.S.	300 mm L.D.S.	250 mm W.W.S.
LAND DRAINAGE SEWER	WASTE WATER SEWER	LAND DRAINAGE SEWER	WASTE WATER SEWER	LAND DRAINAGE SEWER	WASTE WATER SEWER	LAND DRAINAGE SEWER	WASTE WATER SEWER
MANHOLE	CATCH BASIN	CURB INLET	JUNCTIONS	CULVERT	100 GAS	GAS	100 GAS
EXISTING	LEGEND-PLAN	PROPOSED	EXISTING	LEGEND-PLAN	PROPOSED	EXISTING	LEGEND-PROFILE
PROPOSED	LEGEND-PROFILE	PROPOSED	EXISTING	LEGEND-PLAN	PROPOSED	EXISTING	LEGEND-PROFILE

**UNDERGROUND STRUCTURES**

DATE: \_\_\_\_\_

NOTE:  
LOCATION OF UNDERGROUND STRUCTURES AS SHOWN ARE BASED ON THE BEST INFORMATION AVAILABLE. BUT NO GUARANTEE IS GIVEN THAT ALL EXISTING UTILITIES ARE SHOWN OR THAT THE GIVEN LOCATIONS ARE EXACT. CONFIRMATION OF EXISTENCE AND EXACT LOCATION OF ALL SERVICES MUST BE OBTAINED FROM THE INDIVIDUAL UTILITIES BEFORE PROCEEDING WITH CONSTRUCTION.

NO.	REVISIONS	DATE	BY
3	ISSUED FOR TENDER	04-29-09	TJH
2	ISSUED FOR REVIEW	03-20-09	TJH
1	ISSUED FOR 50% REVIEW	03-05-09	TJH

DESIGNED BY	SPC
DRAWN BY	TJH
CHECKED BY	DBW
APPROVED BY	DPK
HOR. SCALE	1:250
VERTICAL	1:10

ENGINEER'S SEAL

PROVINCE OF MANITOBA  
REGISTERED PROFESSIONAL ENGINEER

D.B. WIEBE  
04/29/09  
Member 22480

CONSULTANT PROJECT NUMBER  
08-1175

**THE CITY OF WINNIPEG**  
PUBLIC WORKS DEPARTMENT

**BISHOP GRANDIN BLVD - EASTBOUND**  
LAKEWOOD TO LAGIMODIERE

PAVEMENT REHABILITATION - STA. 2+975 TO STA. 3+125

CITY DRAWING NUMBER  
P-3300-06

SHEET 06 OF 27

CONSULTANT DRAWING NUMBER  
-

G:\CAD\081175\Contract\Roadway\081175-BISHOP-PAVEMENT1.dwg