

| DESCRIPTION | RIM | INVERT | | |
|-------------|--------|--------|--------|------|
| | | NORTH | SOUTH | WEST |
| CB5 | 234.98 | 233.38 | | |
| CB6 | 234.98 | | 233.38 | |

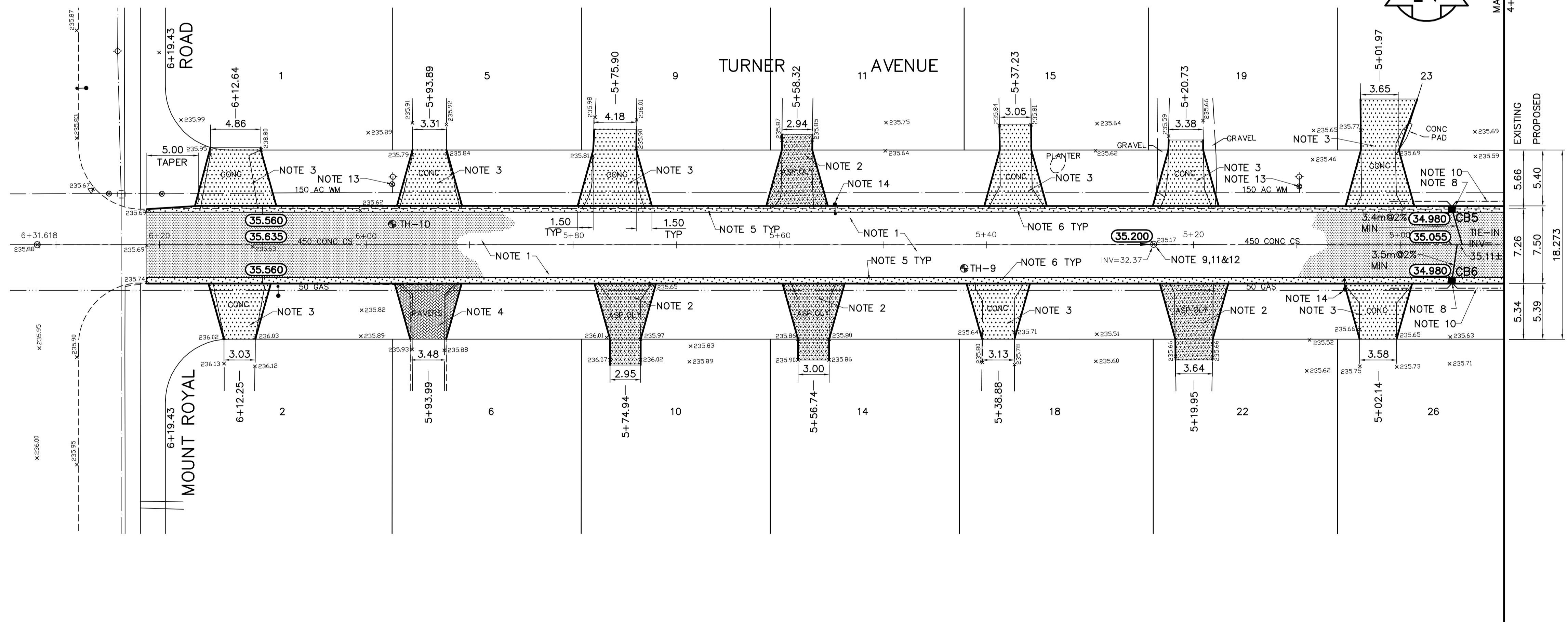

REFERENCE NOTES

- A. PAVEMENT DIMENSIONS ARE TO BACK OF CURB
- B. ADD 200.000 TO DESIGN ELEVATIONS TO OBTAIN GEODETIC DATUM
- C. BASELINE IS CENTRE LINE RIGHT-OF-WAY
- D. PROPERTY LINES OBTAINED FROM CITY OF WINNIPEG L.B.I.S., AND NO SCALE FACTOR WAS APPLIED
- E. REFER TO AECOM FIELD BOOK NO. 4618
- F. ALL DRIVEWAYS SHOWN ON PLAN TO BE RECONSTRUCTED LESS THAN 3.0m WIDE AT PROPERTY LINE SHALL BE REVIEWED WITH THE HOME OWNER. UPON APPROVAL FROM THE HOME OWNER THE APPROACHES SHALL BE CONSTRUCTED TO 3.0m WIDE AT THE PROPERTY LINE

CONSTRUCTION NOTES

1. REMOVE EXISTING PAVEMENT AND CONSTRUCT NEW 100mm ASPHALTIC PAVEMENT (TYPE 1A)
2. REMOVE EXISTING PAVEMENT AND CONSTRUCT NEW 150mm REINFORCED CONCRETE PAVEMENT c/w 50mm ASPHALT OVERLAY (TYPE 1A)
3. REMOVE EXISTING CONCRETE AND CONSTRUCT NEW 150mm REINFORCED CONCRETE PAVEMENT
4. REMOVE AND REINSTALL EXISTING PAVING STONES AND CONSTRUCT 150mm HT. CONCRETE BARRIER CURB EDGING
5. CONSTRUCT NEW BARRIER CURB AND GUTTER (180mm HT)
6. CONSTRUCT NEW LIP CURB AND GUTTER (40mm HT)
7. CONSTRUCT NEW CURB RAMP AND GUTTER (10mm HT INTEGRAL)
8. INSTALL NEW CURB AND GUTTER INLET c/w CATCH BASIN (SD-024) AND CONNECT NEW 250mm LEAD TO EXISTING COMBINED SEWER
9. REMOVE EXISTING COVER AND PLACE NEW SOLID COVER (AP-005)
10. INSTALL 150mm SUBDRAIN
11. ADJUST EXISTING MANHOLE/CATCH BASIN TO GRADE
12. INSTALL NEW CAST IRON RISER RING
13. ADJUST EXISTING WATER VALVE TO GRADE
14. REMOVE AND RELOCATE EXISTING LIGHT STANDARD (BY OTHERS)



METRIC
WHOLE NUMBERS INDICATE MILLIMETRES
DECIMALIZED NUMBERS INDICATE METRES

| EXISTING | LEGEND - PLAN | PROPOSED | EXISTING | LEGEND - PLAN | PROPOSED | EXISTING | LEGEND - PROFILE | PROPOSED |
|--------------|---------------------|--------------|-------------------|-------------------|-------------------|----------|-------------------|-------------------|
| 150 mm W.M. | WATERMAIN | 150 mm W.M. | HYDRO | HYDRO | HYDRO | × | PROFILE | PROFILE |
| 300mm L.D.S. | LAND DRAINAGE SEWER | 300mm L.D.S. | M.T.S. | M.T.S. | M.T.S. | ○ | NORTH/WEST GUTTER | NORTH/WEST GUTTER |
| 250mm W.W.S. | WASTEWATER SEWER | 250mm W.W.S. | CONCRETE | CONCRETE | CONCRETE | ○ | SOUTH/EAST GUTTER | SOUTH/EAST GUTTER |
| ○ | MANHOLE | ○ | ASPHALT | ASPHALT | ASPHALT | ○ | N/W PROPERTY LINE | N/W PROPERTY LINE |
| □ | CATCH BASIN | □ | PROPERTY LINE | PROPERTY LINE | PROPERTY LINE | ○ | S/E PROPERTY LINE | S/E PROPERTY LINE |
| ▽ | CURB INLET | ▽ | SURVEY BAR | SURVEY BAR | SURVEY BAR | ○ | | |
| + | JUNCTIONS | + | ELEVATION | ELEVATION | ELEVATION | ○ | | |
| — | CULVERT | — | TREE | TREE | TREE | ○ | | |
| — | GAS | — | SIDEWALK RAMP | SIDEWALK RAMP | SIDEWALK RAMP | ○ | | |
| | | | CONCRETE SIDEWALK | CONCRETE SIDEWALK | CONCRETE SIDEWALK | ○ | | |
| | | | FENCE | FENCE | FENCE | ○ | | |

LOCATION APPROVED UNDERGROUND STRUCTURES

SUPV. U/G STRUCTURES DATE COMMITTEE

NOTE:
LOCATION OF UNDERGROUND STRUCTURES AS SHOWN ARE BASED ON THE BEST INFORMATION AVAILABLE, BUT NO GUARANTEE IS GIVEN THAT ALL EXISTING UTILITIES ARE SHOWN OR THAT THE GIVEN LOCATIONS ARE EXACT. CONFIRMATION OF EXISTENCE AND EXACT LOCATION OF ALL SERVICES MUST BE OBTAINED FROM THE INDIVIDUAL UTILITIES BEFORE PROCEEDING WITH CONSTRUCTION.

B.M. 39-003 1/4 in. in East end face of N. Conc. foundation of N. side of Steeple Tower of Silver Heights United Church No. 199 Gerrich St.

| NO. | REVISIONS | DATE | BY |
|-----|-------------------|----------|----|
| 0 | ISSUED FOR TENDER | 03/23/09 | BC |
| A | ISSUED FOR REVIEW | 03/09/09 | BC |

| DESIGNED BY | | CHECKED BY | |
|-------------------|-----|-------------------------------|-----|
| BC | TGS | BC | TGS |
| DRAWN BY | | APPROVED BY | |
| BC | | | |
| HOR. SCALE: 1=250 | | RELEASED FOR CONSTRUCTION BY: | |
| VERTICAL: 1=10 | | DATE | |
| DATE JAN/09 | | DATE | |

ENGINEER'S SEAL
PROVINCE OF MANITOBA
ORIGINAL SIGNED
T.G. SMITH
MAR 23/09
REGISTERED PROFESSIONAL ENGINEER

THE CITY OF WINNIPEG
PUBLIC WORKS DEPARTMENT
ENGINEERING DIVISION

TURNER AVENUE
MOUNT ROYAL ROAD TO MOUNT ROYAL ROAD

PAVEMENT RECONSTRUCTION
PLAN/PROFILE
STATION 4+90 TO MOUNT ROYAL ROAD

CITY DRAWING NUMBER
SHEET 4 OF 4

CONSULTANT DRAWING NO. CT04