

RADIUS IMPROVEMENT COORDINATE LAYOUT (COORDINATES ARE TO BACK OF CURB)

POINT I.D.	DESC. / STATION	NORTHING	EASTING	POINT I.D.	DESC. / STATION	NORTHING	EASTING
7	PC	5524486.726	635681.257	14	PC	5524487.232	635691.890
8	MIDPT	5524506.998	635680.015	15	MIDPT	5524497.637	635691.028
9	PI	5524527.309	635679.916	16	PT	5524508.063	635690.491
10	PI	5524527.297	635680.416	17	PC	5524519.767	635690.275
11	PT	5524520.000	635680.320	18	MIDPT	5524536.692	635690.687
12	MIDPT	5524512.471	635680.703	19	PT	5524553.580	635691.954
13	PC	5524505.026	635681.894				

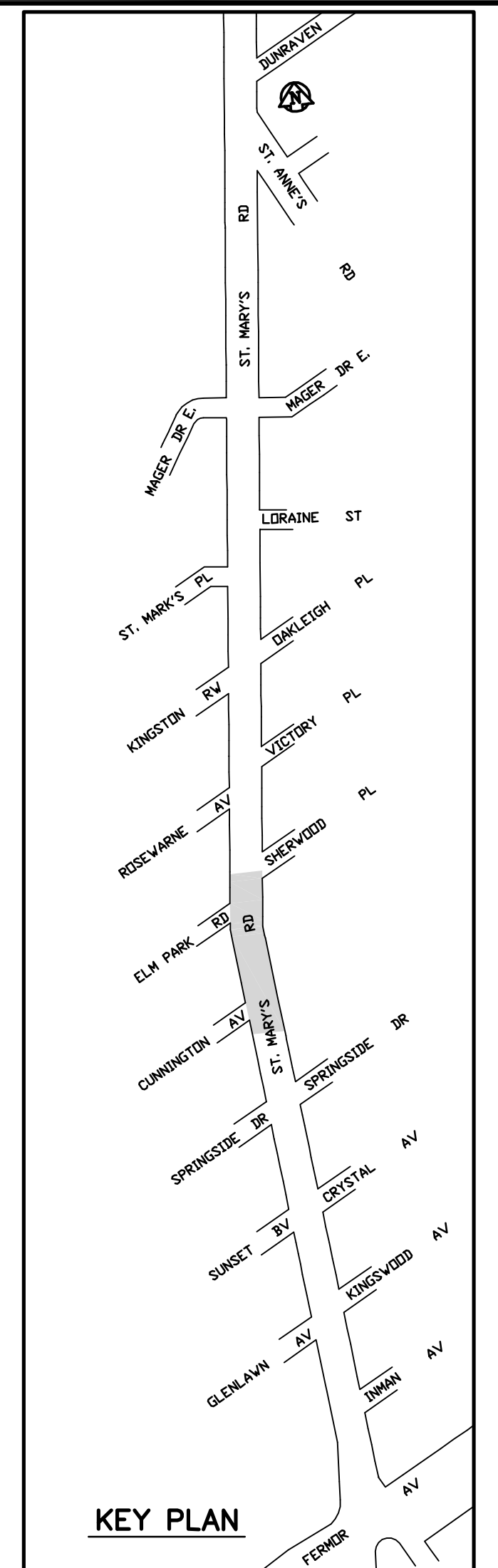
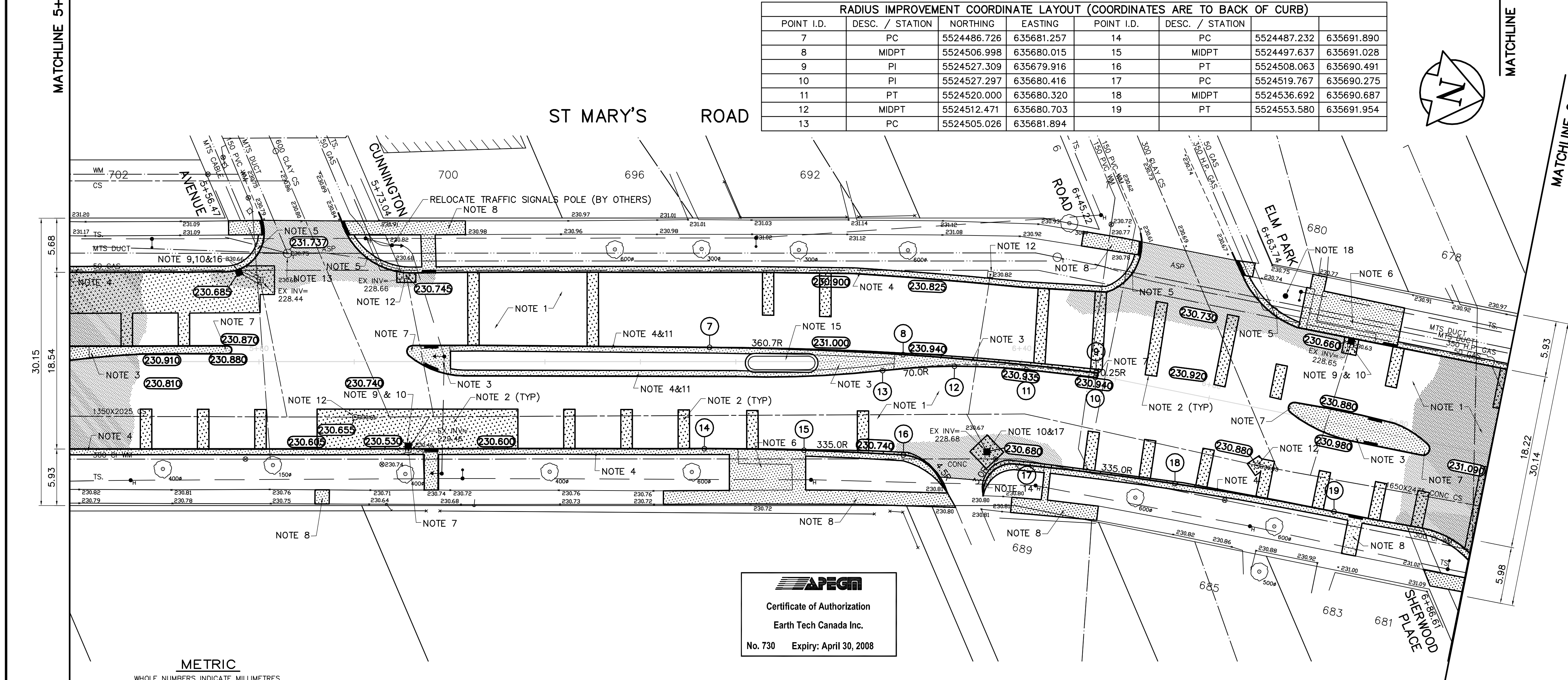

- REFERENCE NOTES:**
- BASELINE IS CENTERED BETWEEN NORTHBOUND AND SOUTHBOUND GUTTER BACK OF CURB
 - LEGAL PLAN - L.B.I.S.
 - EARTH TECH FIELD BOOK No. 4574
 - PAVEMENT DIMENSIONS ARE TO BACK OF CURB
 - ALL WORK TO CONFORM TO CITY OF WINNIPEG STANDARD CONSTRUCTION SPECIFICATIONS

- CONSTRUCTION NOTES:**
- PLANE EXISTING ASPHALT AND CONSTRUCT NEW 80mm ASPHALTIC CONCRETE OVERLAY.
 - CONSTRUCT NEW 200mm PLAIN DOWELED CONCRETE. PAVEMENT C/W ASPHALTIC CONCRETE OVERLAY.
 - CONSTRUCT NEW MONOLITHIC CONCRETE MEDIAN SLAB.
 - CONSTRUCT NEW MONOLITHIC CONCRETE SPLASH STRIP.
 - CONSTRUCT NEW MONOLITHIC CONCRETE MODIFIED SPLASH STRIP.
 - CONSTRUCT NEW MONOLITHIC CONCRETE BARRIER CURB AND SIDEWALK.
 - CONSTRUCT NEW MONOLITHIC CONCRETE BULLNOSE.
 - CONSTRUCT NEW CONCRETE SIDEWALK.
 - INSTALL NEW CURB AND GUTTER INLET C/W CATCHBASIN (SD-024) AND CONNECT NEW 250mm LEAD TO EXISTING LEAD.
 - ABANDON EXISTING CATCHBASIN.
 - REMOVE EXISTING PATIO BLOCK SPLASH STRIP.
 - ADJUST EXISTING CATCHBASIN/MANHOLE TO GRADE.
 - ADJUST EXISTING MTS MANHOLE (BY OTHERS).
 - INSTALL NEW WATERMAIN VALVE BOX EXTENDABLE SECTION INSERT.
 - CONSTRUCT NEW MEDIAN PLANTER.
 - ABANDON EXISTING DRAINAGE INLET.
 - INSTALL NEW CATCHBASIN C/W OPEN GRATE COVER AND CONNECT NEW 250mm LEAD TO EXISTING LEAD.
 - CONSTRUCT NEW 450x X 3.0m CONCRETE PILE.

APEGM
Certificate of Authorization
Earth Tech Canada Inc.
No. 730 Expiry: April 30, 2008

METRIC
WHOLE NUMBERS INDICATE MILLIMETRES
DECIMALIZED NUMBERS INDICATE METRES

EXISTING	LEGEND - PLAN	PROPOSED	EXISTING	LEGEND - PLAN	PROPOSED	EXISTING	LEGEND - PROFILE	PROPOSED
150 mm W.M.	WATERMAIN	150 mm W.M.	HYDRO	HYDRO	32.750	—	PROFILE	—
300mm L.D.S.	LAND DRAINAGE SEWER	300mm L.D.S.	CONCRETE	CONCRETE	—	—	WEST GUTTER	—
250mm W.W.S.	WASTEWATER SEWER	250mm W.W.S.	ASPHALT	ASPHALT	—	—	EAST GUTTER	—
—	MANHOLE	—	PROPERTY LINE	PROPERTY LINE	—	—	WEST MEDIAN GUTTER	—
—	CATCH BASIN	—	SURVEY BAR	SURVEY BAR	—	—	EAST MEDIAN GUTTER	—
—	CURB INLET	—	ELEVATION	ELEVATION	—	—	—	—
—	JUNCTIONS	—	TREE	TREE	—	—	—	—
—	TEST HOLE (07-R-03)	—	SIDEWALK RAMP	SIDEWALK RAMP	—	—	—	—
—	GAS	—	CONCRETE SIDEWALK	CONCRETE SIDEWALK	—	—	—	—
—	—	—	FENCE	FENCE	—	—	—	—

LOCATION APPROVED UNDERGROUND STRUCTURES

SUPV. U/G STRUCTURES DATE COMMITTEE

NOTE:
LOCATION OF UNDERGROUND STRUCTURES AS SHOWN ARE BASED ON THE BEST INFORMATION AVAILABLE. BUT NO GUARANTEE IS GIVEN THAT ALL EXISTING UTILITIES ARE SHOWN OR THAT THE GIVEN LOCATIONS ARE EXACT. CONFIRMATION OF EXISTENCE AND EXACT LOCATION OF ALL SERVICES MUST BE OBTAINED FROM THE INDIVIDUAL UTILITIES BEFORE PROCEEDING WITH CONSTRUCTION.

B.M. 54-003 TBLT IN E. CONC FOUNDATION OF ST. VITAL CIVIC OFFICE 604 ST MARY'S W. SIDE OF FRONT ENTRANCE
ELEV.232.245

NO.	REVISIONS	DATE	BY
0	ISSUED FOR TENDER	MAR 6/08	KWR
A	ISSUED FOR REVIEW	FEB 25/08	BC

EarthTech
A Tyco International Ltd. Company

DESIGNED BY	RC	CHECKED BY	KWR/BC
DRAWN BY	RC/RAM	APPROVED BY	ORIGINAL SIGNED
HOR. SCALE:	1:250	RELEASED FOR CONSTRUCTION BY:	ORIGINAL SIGNED
VERTICAL:	1:10	DATE	MARCH 6, 2008

ENGINEER'S SEAL
PROVINCE OF MANITOBA
ORIGINAL SIGNED
K.W. RAE
MAR 6/08
REGISTERED PROFESSIONAL ENGINEER

THE CITY OF WINNIPEG
PUBLIC WORKS DEPARTMENT
TRANSPORTATION ENGINEERING DIVISION

ST. MARY'S ROAD
ST. ANNE'S ROAD TO FERMOY AVENUE
CONCRETE REPAIRS AND ASPHALT RESURFACING

CITY DRAWING NUMBER
P-3292-06
SHEET 6 OF 12

PLAN PROFILE
STA 5+40 TO STA 6+90

CONSULTANT DRAWING NO.
CT06