

**General Notes**

1. All dimensions are in meters unless otherwise noted.
2. All existing trees, sidewalks, curbs, catch basins, culverts, survey markers, to remain are to be protected during construction. Any damage to them is to be made good by the Contractor. Maintain positive drainage into all catch basins and curb inlets.
3. Contractor is to limit operations to the area within the area of work shown on the drawing. Should areas outside of this limit be damaged during the course of construction, Contractor is to make good the damage at his own expense. Contractor is to obtain location of all utilities prior to construction. If using power equipment to excavate contractor must notify Hydro and Gas and telephone utilities and take steps to avoid damaging their installations.
5. Contractor is to verify dimensions and grade information prior to beginning construction. Contractor is to report any discrepancies to the contract administrator immediately.
6. All elevations are Geodetic and in Meters.
7. Contractor to confirm all dimensions and report any discrepancies to Contract Administrator prior to construction.
8. Layout is to be approved by Contract Administrator prior to any construction or demolition/removals.
9. No item is to be demolished or removed from the site without prior approval of the Contract Administrator. The extent of these removals is to be reviewed on site prior to beginning work.
10. All construction traffic shall be restricted to the limits of construction shown on the drawings.
11. Excavate in a manner to minimize damage to the tree root systems. Keep exposed roots in excavations and trenches moist or shaded. If stockpiling of excavated soil material is required, stockpile in areas away from the tree roots if possible.
12. Excavation equipment shall be track based.
13. The Contractor shall take reasonable and prudent precautionary steps to prevent damage from construction activities to existing trees, and trees within the Site, within the limits of the construction area.
14. Alignment of the path shown on drawings is intended as a general indication of the alignment only. The actual alignment will be field staked by the Contract Administrator. Contractor to provide marking material and equipment and to maintain layout staking during construction.
15. Contractor to prune to provide a corridor free of obstruction extending 0.9 m from each edge of the walking surface and to a height of 2.4 m.

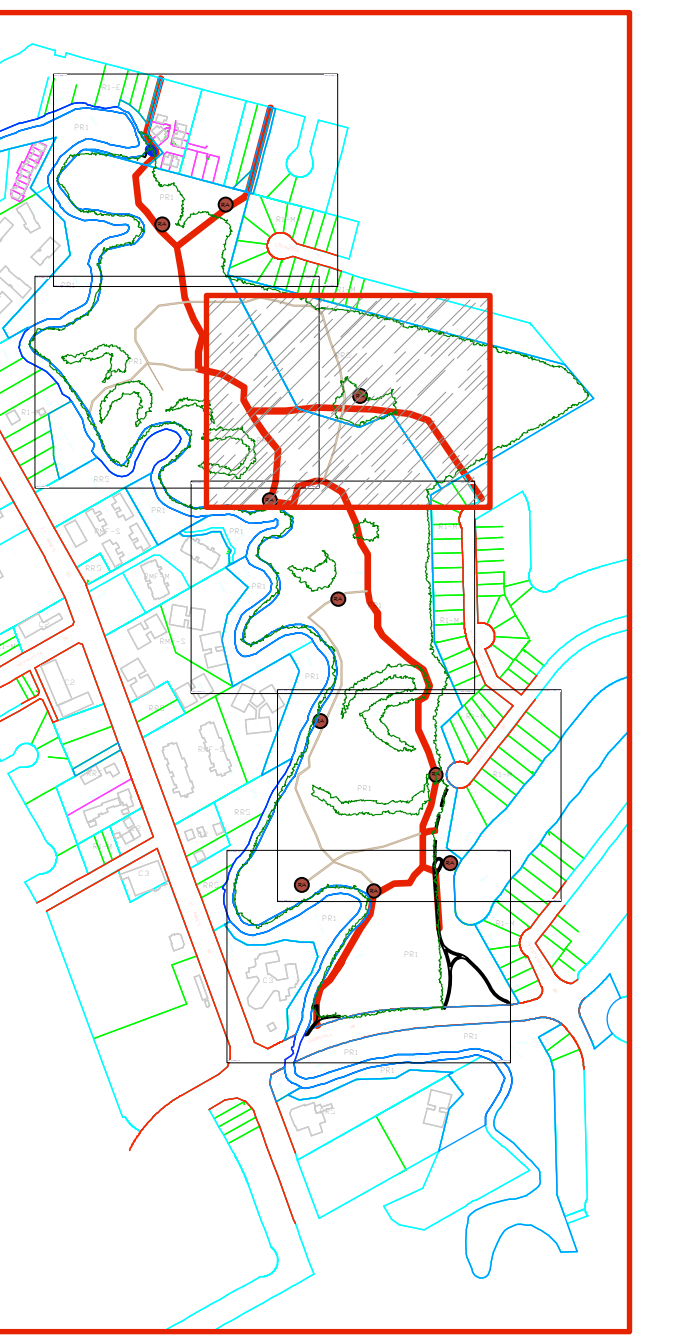

RR5

PR1

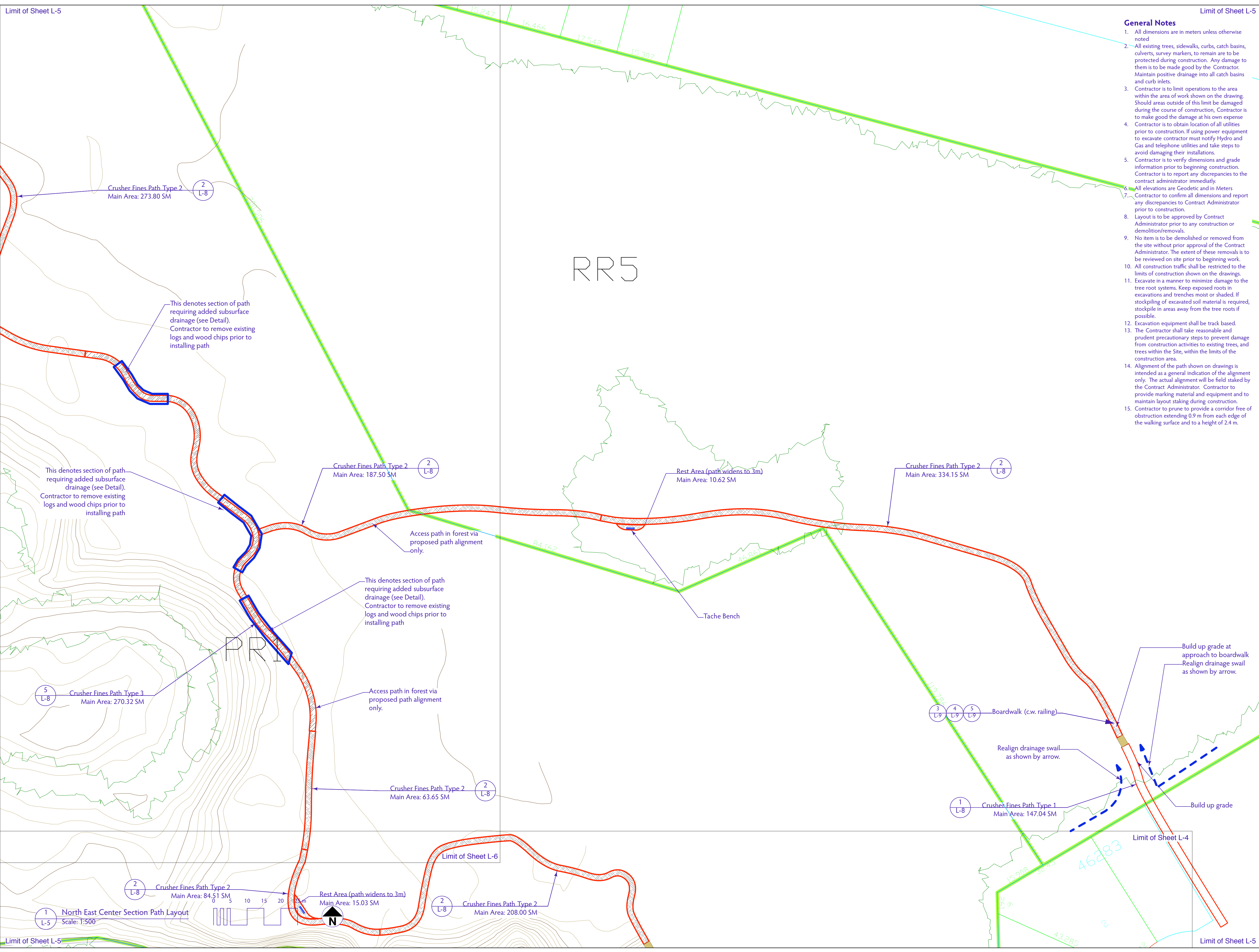

1. This drawing shall not be used for construction unless signed and sealed by Landscape Architect.
2. Variations and modifications to the work shown will not be allowed without prior written consent of Landscape Architect.
3. Drawing and Specifications, as instruments of service, are the property of the Landscape Architect. The copyright is reserved in the name of the Landscape Architect. No reproduction may be made without the prior written consent of the Landscape Architect.
4. Contractors/bidders are hereby granted a limited licence to reproduce these drawings for the purposes of bidding. Such reproductions are not to be used for construction.

A 10/1/08 For Bid Opportunity

NO.	DATE	ISSUE NOTES

CONSULTANT

PROJECT TITLE

Bois des Esprits

DRAWING TITLE

North East Center Section  
Path Layout

DRAWING NO.

L-5

of 9

1 North East Center Section Path Layout  
Scale: 1:500

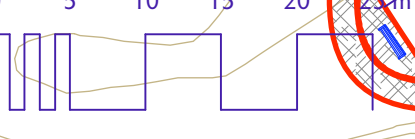

Rest Area (path widens to 3m)  
Main Area: 15.03 SM

2 Crusher Fines Path Type 2  
Main Area: 208.00 SM

2 Crusher Fines Path Type 2  
Main Area: 84.51 SM

2 Crusher Fines Path Type 2  
Main Area: 63.65 SM

5 Crusher Fines Path Type 3  
Main Area: 270.32 SM

2 Crusher Fines Path Type 2  
Main Area: 187.50 SM

3 Boardwalk (c.w. railing)  
4  
5

1 Crusher Fines Path Type 1  
Main Area: 147.04 SM

2 Crusher Fines Path Type 2  
Main Area: 334.15 SM

Rest Area (path widens to 3m)  
Main Area: 10.62 SM

2 Crusher Fines Path Type 2  
Main Area: 273.80 SM

2 Crusher Fines Path Type 2  
Main Area: 273.80 SM