

NOTES:

1. ALL SIDEWALK, CURB, AND CONCRETE REPAIRS TO BE MARKED OUT IN FIELD BY CONTRACT ADMINISTRATOR.
2. ALL ADJUSTMENTS FOR CATCHBASINS, MANHOLES, VALVES & INLETS TO BE MARKED IN FIELD BY CONTRACT ADMINISTRATOR.

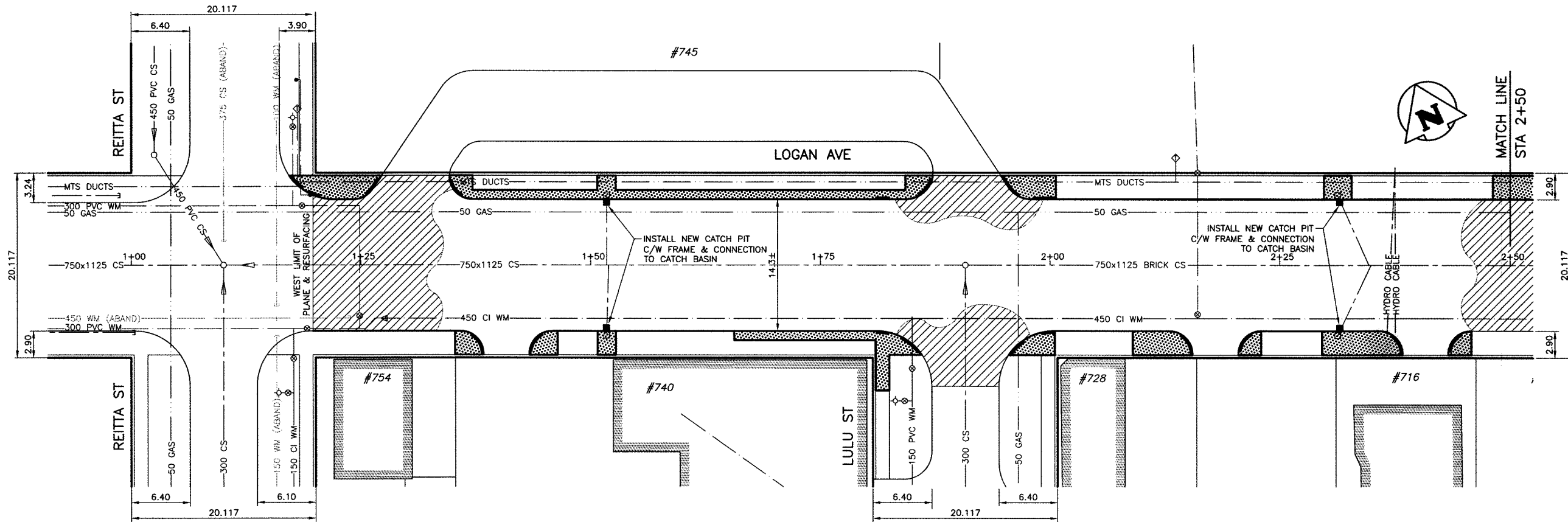

PLAN
SCALE: 1:250

PROPERTY LIMITS DELINEATION

DELINEATION OF PROPERTY LIMITS AS SHOWN ON THIS DWG DOES NOT REPRESENT A "LEGAL SURVEY". KGS GROUP MAKES NO REPRESENTATION OR WARRANTY AS TO THE ACCURACY OF PROPERTY LIMITS DELINEATED ON THIS DWG, NOR ON THE DIMENSIONAL ACCURACY OF DWG FEATURES RELATIVE TO THOSE PROPERTY LIMITS.

WARNING

1. NOTIFY THE GAS COMPANY OF THE PROPOSED LOCATION OF EXCAVATION.
2. TAKE PRECAUTION TO AVOID DAMAGE TO GAS COMPANY INSTALLATIONS.
3. SEE PROVINCIAL REGULATION 210/72 FOR DETAILS.

METRIC

WHOLE NUMBERS INDICATE MILLIMETRES
DECIMALIZED NUMBERS INDICATE METRES

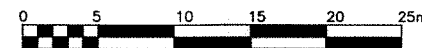

SCALE: 1:250 METRIC A1
1:500 METRIC A3



Certificate of Authorization

KGS Group

No. 245 Date: Sept 02/08

| EXISTING | LEGEND-PLAN | PROPOSED | EXISTING | LEGEND-PLAN | PROPOSED | EXISTING | LEGEND-PROFILE | PROPOSED |
|----------|---------------------|----------|--------------------|-------------------|----------|----------|----------------|----------|
| 300 LDS | LAND DRAINAGE SEWER | 300 LDS | TEST HOLE | PLANE & RESURFACE | | | | |
| 250 WWS | WASTE WATER SEWER | 250 WWS | GUY WIRE | | | | | |
| | GAS | | LIGHT STANDARD | | | | | |
| | HYDRO | | BACK OF CURB | | | | | |
| | M.T.S. | | CONCRETE | | | | | |
| 150 WM | WATERMAIN | 150 WM | ASPHALT | | | | | |
| | HYDRANT | | SIDEWALK | | | | | |
| | VALVE | | PROPERTY LINE | | | | | |
| | MANHOLE | | SURVEY BAR | | | | | |
| | CATCH BASIN | | GEODETIC BENCHMARK | | | | | |
| | CURB INLET | | ELEVATION | | | | | |
| | POLES | | | | | | | |

LOCATION APPROVED UNDERGROUND STRUCTURES

SUPV. U/G STRUCTURES COMMITTEE DATE

NOTE:
LOCATION OF UNDERGROUND STRUCTURES AS SHOWN ARE BASED ON THE BEST INFORMATION AVAILABLE BUT NO GUARANTEE IS GIVEN THAT ALL EXISTING UTILITIES ARE SHOWN OR THAT THE GIVEN LOCATIONS ARE EXACT. CONFIRMATION OF EXISTENCE AND EXACT LOCATION OF ALL SERVICES MUST BE OBTAINED FROM THE INDIVIDUAL UTILITIES BEFORE PROCEEDING WITH CONSTRUCTION.

| | | |
|-------------------|----------|---------|
| B.M. ELEV. | 36-017 | 232.313 |
| DESIGNED BY | BJM | |
| CHECKED BY | CR | |
| DRAWN BY | DW | |
| APPROVED BY | | |
| HOR. SCALE: | 1:250 | |
| VERTICAL: | 1:50 | |
| ISSUED FOR TENDER | 02/09/08 | BJM |
| NO. REVISIONS | | |
| DATE | | |
| BY | | |
| DATE | 16/07/08 | |

KGS GROUP CONSULTING ENGINEERS & PROJECT MANAGERS
WINNIPEG (204) 896-1209
THUNDER BAY (807) 345-2233

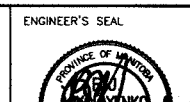

THE CITY OF WINNIPEG PUBLIC WORKS DEPARTMENT TRANSPORTATION ENGINEERING DIVISION

| | | | |
|------------------------|--|---------------------|----------------|
| PROJECT TITLE | LOGAN AVENUE REITTA STREET TO BUSHNELL STREET CONCRETE REPAIRS AND ASPHALT RESURFACING | SHEET OF | 01 05 |
| CONSULTANT DRAWING NO. | 08-107-08 | COMPUTER FILE NAME | LOGAN-PLOT.DWG |
| | | CITY DRAWING NUMBER | P-3297-01 |