

EXISTING WATER SERVICE LOCATION RECORDS				
ADDRESS	SIZE/TYPE	SHORT/LONG	CORP. LOCATION	COMMENTS
67 YOUVILLE ST.	20 COPPER	0.9 L/RHL 7.0 N/SPL 67 YOUVILLE	NO RECORD	
71 YOUVILLE ST.	20 COPPER	0.6 L/RHL 15.2 N/SPL 67 YOUVILLE	NO RECORD	DUPLEX
75 YOUVILLE ST.	20 COPPER	1.8 L/RHL 29.3 N/SPL 67 YOUVILLE	NO RECORD	
79 YOUVILLE ST.	20 COPPER	0.5 L/RHL 42.1 N/SPL 67 YOUVILLE	NO RECORD	
83 YOUVILLE ST.	20 COPPER	1.8 L/RHL 55.5 N/SPL 67 YOUVILLE	NO RECORD	
85 YOUVILLE ST.	20 COPPER	0.3 R/RHL 75.0 N/SPL 67 YOUVILLE	NO RECORD	
89 YOUVILLE ST.	20 COPPER	2.7 L/RHL 4.3 S/NPL 89 YOUVILLE	NO RECORD	
97 YOUVILLE ST.	20 COPPER	0.6 L/RHL 11.9 N/SPL 97 YOUVILLE	NO RECORD	
100 YOUVILLE ST.	25	NO RECORD	NO RECORD	

* - INFORMATION FROM EXISTING SERVICE RECORDS

NOTE: CHAINAGES SHOWN ARE ALONG WEST PL OF YOUVILLE ST.

EXISTING SEWER SERVICE LOCATION RECORDS		
ADDRESS	SIZE/TYPE	SERVICE LOCATION AT PL
NO RECORD	NO RECORD	NO RECORD

- CONSTRUCTION NOTES:**
- EXPOSE EXISTING WATERMAIN & CONFIRM INVERTS PRIOR TO CONSTRUCTION.
 - CONFIRM LOCATION OF ALL SERVICES IN THE FIELD.
 - INSTALL WATERMAIN BY TRENCHLESS METHODS.
 - TRENCHES & EXCAVATIONS WITHIN 1 METRE OF A PAVED AREA INCLUDING SIDEWALKS SHALL BE CLASS 3 BACKFILL.
 - ALL MATERIALS SHALL CONFORM TO THE CITY OF WINNIPEG STANDARD CONSTRUCTION SPECIFICATIONS.
 - MINIMUM COVER TO TOP OF WATERMAIN SHALL BE 2.4 m.
 - REPLACE ALL EXISTING LEAD SERVICES FROM PROPOSED WATERMAIN TO PL.
 - NOTIFY ALL RESIDENTS AND BUSINESSES 24 HOURS IN ADVANCE OF ANY WATER SHUTDOWNS OR DISRUPTION OF SERVICE.

WARNING

IF POWER EQUIPMENT OR EXPLOSIVES ARE TO BE USED FOR EXCAVATION ON THIS PROJECT THE CONTRACTOR MUST:

- NOTIFY THE GAS COMPANY OF THE PROPOSED LOCATION OF EXCAVATION.
- TAKE PRECAUTION TO AVOID DAMAGE TO GAS COMPANY INSTALLATIONS SEE PROVINCIAL REGULATION 210/72 FOR DETAILS

METRIC

WHOLE NUMBERS INDICATE MILLIMETRES
DECIMALIZED NUMBERS INDICATE METRES

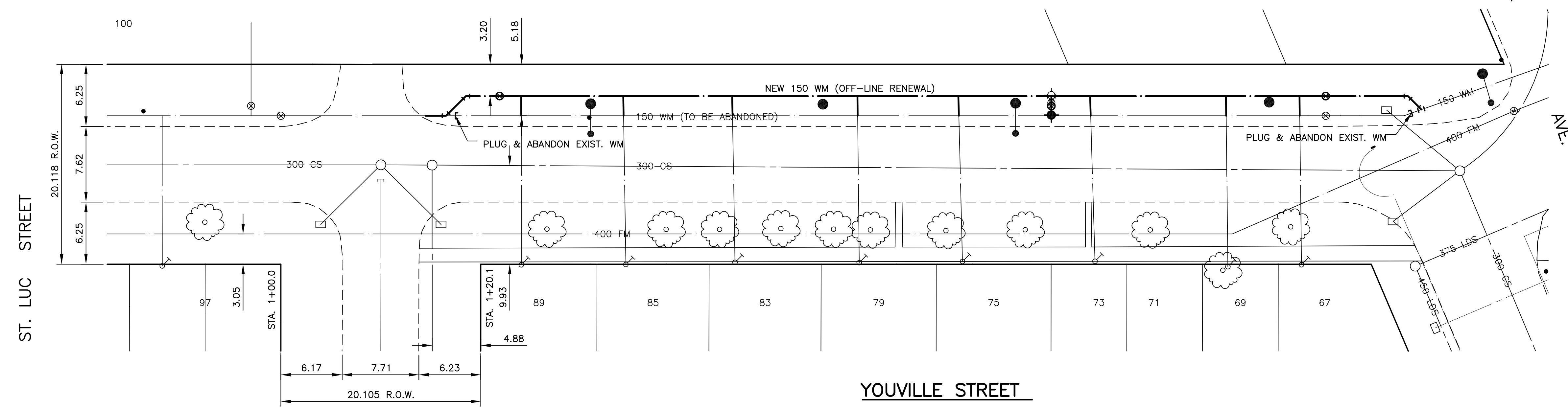

NOTE:
HYRDO EXCAVATE AND EXPOSE TOP OF FEEDERMAIN PRIOR TO CONSTRUCTION CONTACT ANDY VINCENT 48 HOURS PRIOR TO CROSSING 600 FEEDERMAIN PH# 986-3823.

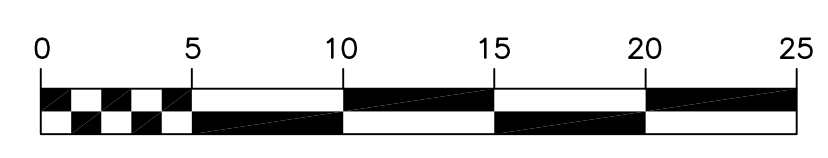

<table border="1"> <tr> <td>150 mm W.M.</td> <td>WATERMAIN</td> <td>150 mm W.M.</td> <td>HYDRO</td> <td>150 mm W.M.</td> <td>WATERMAIN</td> <td>150 mm W.M.</td> </tr> <tr> <td>Hydrant</td> <td>HYDRANT</td> <td>Valve</td> <td>M.T.S.</td> <td>Hydrant</td> <td>HYDRANT</td> <td>Valve</td> </tr> <tr> <td>300 mm L.D.S.</td> <td>LAND DRAINAGE SEWER</td> <td>300 mm W.W.S.</td> <td>CONCRETE</td> <td>300 mm L.D.S.</td> <td>LAND DRAINAGE SEWER</td> <td>300 mm W.W.S.</td> </tr> <tr> <td>250 mm W.W.S.</td> <td>WASTE WATER SEWER</td> <td>250 mm W.W.S.</td> <td>ASPHALT</td> <td>250 mm W.W.S.</td> <td>WASTE WATER SEWER</td> <td>250 mm W.W.S.</td> </tr> <tr> <td>Manhole</td> <td>MANHOLE</td> <td>Survey Bar</td> <td>PROPERTY LINE</td> <td>North/West Gutter</td> <td>NORTH/WEST GUTTER</td> <td>South/East Gutter</td> </tr> <tr> <td>Catch Basin</td> <td>CATCH BASIN</td> <td>Service Valve</td> <td>SURVEY BAR</td> <td>Light Standard</td> <td>Light Standard</td> <td>Fence</td> </tr> <tr> <td>Curb Inlet</td> <td>CURB INLET</td> <td>Tree</td> <td>Tree</td> <td>Guy Anchor</td> <td>GUY ANCHOR</td> <td></td> </tr> <tr> <td>Junctions</td> <td>JUNCTIONS</td> <td>Proposed</td> <td>Proposed</td> <td>Proposed</td> <td>Proposed</td> <td>Proposed</td> </tr> <tr> <td>Culvert</td> <td>CULVERT</td> <td>Proposed</td> <td>Proposed</td> <td>Proposed</td> <td>Proposed</td> <td>Proposed</td> </tr> <tr> <td>Gas</td> <td>GAS</td> <td>Proposed</td> <td>Proposed</td> <td>Proposed</td> <td>Proposed</td> <td>Proposed</td> </tr> </table>	150 mm W.M.	WATERMAIN	150 mm W.M.	HYDRO	150 mm W.M.	WATERMAIN	150 mm W.M.	Hydrant	HYDRANT	Valve	M.T.S.	Hydrant	HYDRANT	Valve	300 mm L.D.S.	LAND DRAINAGE SEWER	300 mm W.W.S.	CONCRETE	300 mm L.D.S.	LAND DRAINAGE SEWER	300 mm W.W.S.	250 mm W.W.S.	WASTE WATER SEWER	250 mm W.W.S.	ASPHALT	250 mm W.W.S.	WASTE WATER SEWER	250 mm W.W.S.	Manhole	MANHOLE	Survey Bar	PROPERTY LINE	North/West Gutter	NORTH/WEST GUTTER	South/East Gutter	Catch Basin	CATCH BASIN	Service Valve	SURVEY BAR	Light Standard	Light Standard	Fence	Curb Inlet	CURB INLET	Tree	Tree	Guy Anchor	GUY ANCHOR		Junctions	JUNCTIONS	Proposed	Proposed	Proposed	Proposed	Proposed	Culvert	CULVERT	Proposed	Proposed	Proposed	Proposed	Proposed	Gas	GAS	Proposed	Proposed	Proposed	Proposed	Proposed	<p>UNDERGROUND STRUCTURES</p> <p>SUPV. U/G STRUCTURES COMMITTEE DATE</p> <p>NOTE: LOCATION OF UNDERGROUND STRUCTURES AS SHOWN ARE BASED ON THE BEST INFORMATION AVAILABLE. BUT NO GUARANTEE IS GIVEN THAT ALL EXISTING UTILITIES ARE SHOWN OR THAT THE GIVEN LOCATIONS ARE EXACT. CONFIRMATION OF EXISTENCE AND EXACT LOCATION OF ALL SERVICES MUST BE OBTAINED FROM THE INDIVIDUAL UTILITIES BEFORE PROCEEDING WITH CONSTRUCTION.</p>	<p>B.M. ELEV.</p> <p>DESIGNED BY C.L.P.</p> <p>DRAWN BY C.L.P.</p> <p>CHECKED BY S.C.C.</p> <p>APPROVED BY ORIGINAL SIGNED BY D.P.K.</p> <p>HOR. SCALE 1 : 250</p> <p>VERTICAL 1 : 50</p> <p>RELEASED FOR CONSTRUCTION ORIGINAL SIGNED BY KAS ZUREK, P.Eng.</p>	<p>ENGINEER'S SEAL</p> <p>PROVINCE OF MANITOBA</p> <p>D.P. KRAHN</p> <p>08500 Member 4226</p> <p>REGISTERED PROFESSIONAL ENGINEER</p> <p>CONSULTANT PROJECT NO. 08-9100-0201</p>	<p>THE CITY OF WINNIPEG</p> <p>WATER AND WASTE DEPARTMENT</p> <p>2008 WATERMAIN RENEWALS, SEWER RENEWALS AND REPAIRS, CONTRACT 19</p> <p>YOUVILLE STREET</p> <p>THE GLEN TO ST LUC ST.</p>	<p>CITY DRAWING NUMBER D-11476</p> <p>SHEET 5 OF 27</p> <p>BID OPPORTUNITY 525-2008</p>
150 mm W.M.	WATERMAIN	150 mm W.M.	HYDRO	150 mm W.M.	WATERMAIN	150 mm W.M.																																																																					
Hydrant	HYDRANT	Valve	M.T.S.	Hydrant	HYDRANT	Valve																																																																					
300 mm L.D.S.	LAND DRAINAGE SEWER	300 mm W.W.S.	CONCRETE	300 mm L.D.S.	LAND DRAINAGE SEWER	300 mm W.W.S.																																																																					
250 mm W.W.S.	WASTE WATER SEWER	250 mm W.W.S.	ASPHALT	250 mm W.W.S.	WASTE WATER SEWER	250 mm W.W.S.																																																																					
Manhole	MANHOLE	Survey Bar	PROPERTY LINE	North/West Gutter	NORTH/WEST GUTTER	South/East Gutter																																																																					
Catch Basin	CATCH BASIN	Service Valve	SURVEY BAR	Light Standard	Light Standard	Fence																																																																					
Curb Inlet	CURB INLET	Tree	Tree	Guy Anchor	GUY ANCHOR																																																																						
Junctions	JUNCTIONS	Proposed	Proposed	Proposed	Proposed	Proposed																																																																					
Culvert	CULVERT	Proposed	Proposed	Proposed	Proposed	Proposed																																																																					
Gas	GAS	Proposed	Proposed	Proposed	Proposed	Proposed																																																																					