

EXISTING WATER SERVICE LOCATION RECORDS				
ADDRESS	SIZE/TYPE	SHORT/LONG	CORP. LOCATION	COMMENTS
NO RECORD	NO RECORD	NO RECORD	NO RECORD	

EXISTING SEWER SERVICE LOCATION RECORDS		
ADDRESS	SIZE/TYPE	SERVICE LOCATION AT PL
NO RECORD	NO RECORD	NO RECORD

NOTE: CHAINAGES SHOWN ARE ALONG SOUTH PL OF MCDERMOT AVE.

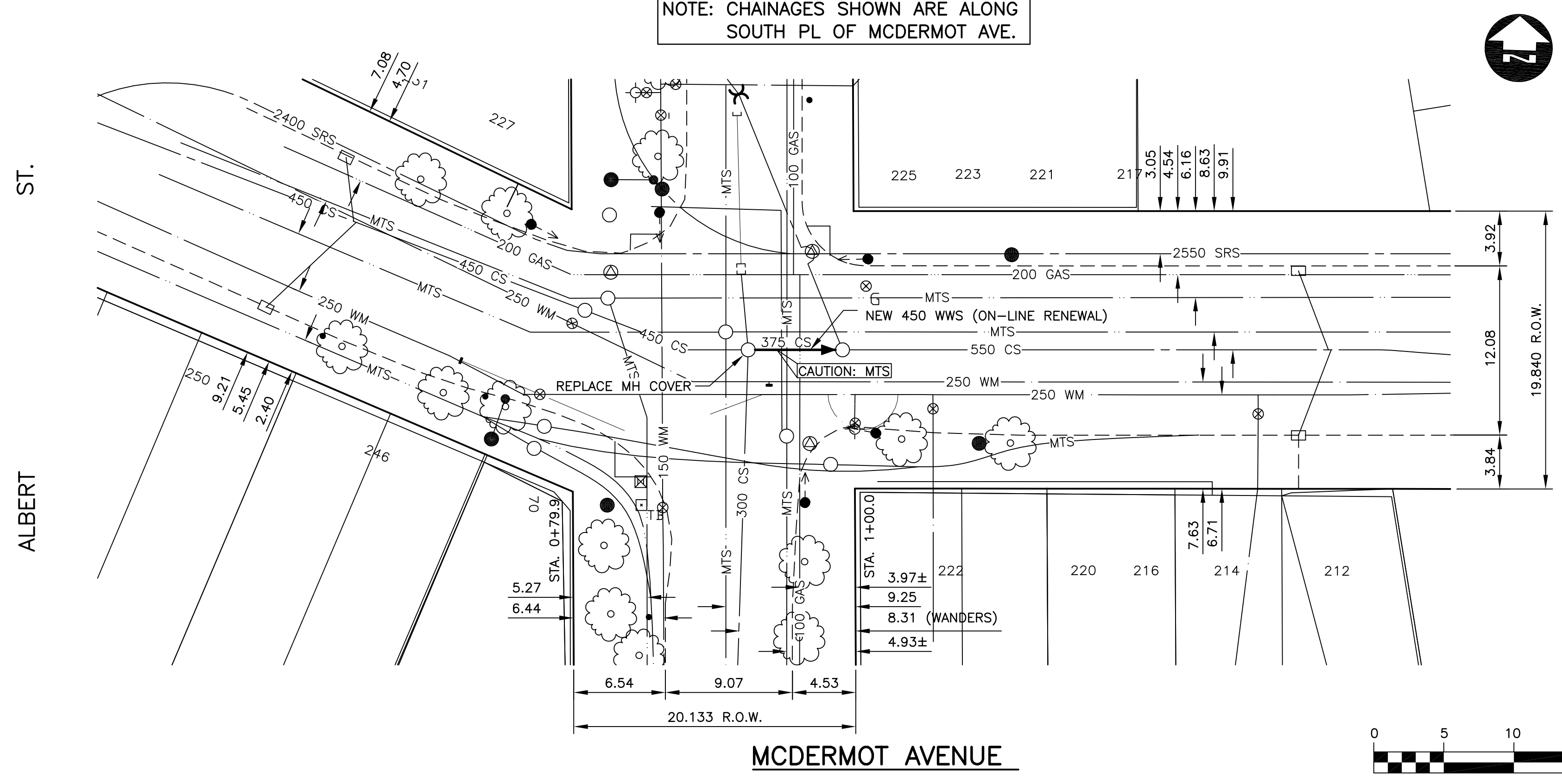

- CONSTRUCTION NOTES:**
1. ALL PVC PIPE SHALL HAVE CLASS B-TYPE 2 BEDDING AND ALL CONCRETE PIPE SHALL HAVE CLASS B-SAND BEDDING.
 2. SEWER TO BE RENEWED BY TRENCHLESS METHODS.
 3. CONFIRM THE LOCATION OF ALL SEWER SERVICES.
 4. RENEW SEWER SERVICES TO PROPERTY LINE.
 5. BACKFILL UNDER PAVEMENT, IN SIDEWALKS, & WITHIN 1.0 OF PAVEMENT TO BE CLASS 3.
 6. BACKFILL IN BOULEVARD TO BE CLASS 5.
 7. CATCHBASIN LEADS TO BE INSTALLED AT MIN. 1.0% SLOPE OR AS DIRECTED BY CONTRACT ADMINISTRATOR.

WARNING

- IF POWER EQUIPMENT OR EXPLOSIVES ARE TO BE USED FOR EXCAVATION ON THIS PROJECT THE CONTRACTOR MUST:
1. NOTIFY THE GAS COMPANY OF THE PROPOSED LOCATION OF EXCAVATION.
 2. TAKE PRECAUTION TO AVOID DAMAGE TO GAS COMPANY INSTALLATIONS SEE PROVINCIAL REGULATION 210/72 FOR DETAILS

METRIC

WHOLE NUMBERS INDICATE MILLIMETRES
DECIMALIZED NUMBERS INDICATE METRES

150 mm W.M.	WATERMAIN	150 mm W.M.	HYDRO	150 mm W.M.	WATERMAIN	150 mm W.M.
Hydrant	Hydrant	Hydrant	M.T.S.	Hydrant	Hydrant	Hydrant
Valve	Valve	Valve	Concrete	Valve	Valve	Valve
300 mm L.D.S.	LAND DRAINAGE SEWER	300 mm L.D.S.	Asphalt	300 mm L.D.S.	LAND DRAINAGE SEWER	300 mm L.D.S.
250 mm W.W.S.	WASTE WATER SEWER	250 mm W.W.S.	Property Line	250 mm W.W.S.	WASTE WATER SEWER	250 mm W.W.S.
Manhole	Manhole	Manhole	Survey Bar	Manhole	Manhole	Manhole
Catch Basin	Catch Basin	Catch Basin	Service Valve	Catch Basin	Catch Basin	Catch Basin
Curb Inlet	Curb Inlet	Curb Inlet	Tree	Curb Inlet	Curb Inlet	Curb Inlet
Junctions	Junctions	Junctions	Light Standard	Junctions	Junctions	Junctions
Culvert	Culvert	Culvert	Fence	Culvert	Culvert	Culvert
Gas	Gas	Gas	Guy Anchor	Gas	Gas	Gas
EXISTING	LEGEND-PLAN	PROPOSED	EXISTING	LEGEND-PLAN	PROPOSED	EXISTING

UNDERGROUND STRUCTURES		B.M. ELEV.	DESIGNED BY	C.L.P.
SUPV. U/G STRUCTURES COMMITTEE			DRAWN BY	C.L.P.
DATE			CHECKED BY	S.C.C.
NOTE:			APPROVED BY	ORIGINAL SIGNED BY D.P.K.
LOCATION OF UNDERGROUND STRUCTURES AS SHOWN ARE BASED ON THE BEST INFORMATION AVAILABLE, BUT NO GUARANTEE IS GIVEN THAT ALL EXISTING UTILITIES ARE SHOWN OR THAT THE GIVEN LOCATIONS ARE EXACT. CONFIRMATION OF EXISTENCE AND EXACT LOCATION OF ALL SERVICES MUST BE OBTAINED FROM THE INDIVIDUAL UTILITIES BEFORE PROCEEDING WITH CONSTRUCTION.			HOR. SCALE	1 : 250
2	ISSUED FOR TENDER	08-5-08	VERTICAL	1 : 50
1	ISSUED FOR FINAL REVIEW	07-22-08	DATE	JULY 21, 2008
NO.	REVISIONS	DATE	BY	

DILLON CONSULTING

RELEASED FOR CONSTRUCTION ORIGINAL SIGNED BY KAS ZUREK, P.Eng.

ENGINEER'S SEAL
PROVINCE OF MANITOBA
D.P. KRAHN
085106
Member
4226
REGISTERED PROFESSIONAL ENGINEER

THE CITY OF WINNIPEG
WATER AND WASTE DEPARTMENT

2007 WATERMAIN RENEWALS, SEWER RENEWALS AND REPAIRS, CONTRACT 19
MCDERMOT AVENUE
MH AT ALBERT ST. (CL)
TO 1ST MH E OF ALBERT ST.

CITY DRAWING NUMBER
08632
SHEET 7 OF 27
BID OPPORTUNITY
525-2008

CONSULTANT PROJECT NO.
08-9100-0201