

D SIZE 22" x 34" (559mm x 864mm)

PLOT: 08/07/07 3:14:36 PM

UMA REVIEW DRAFT CHK CA
UMA FILE NAME: D265-228-01 00-C-1016 RX.dwg Saved By: lberard

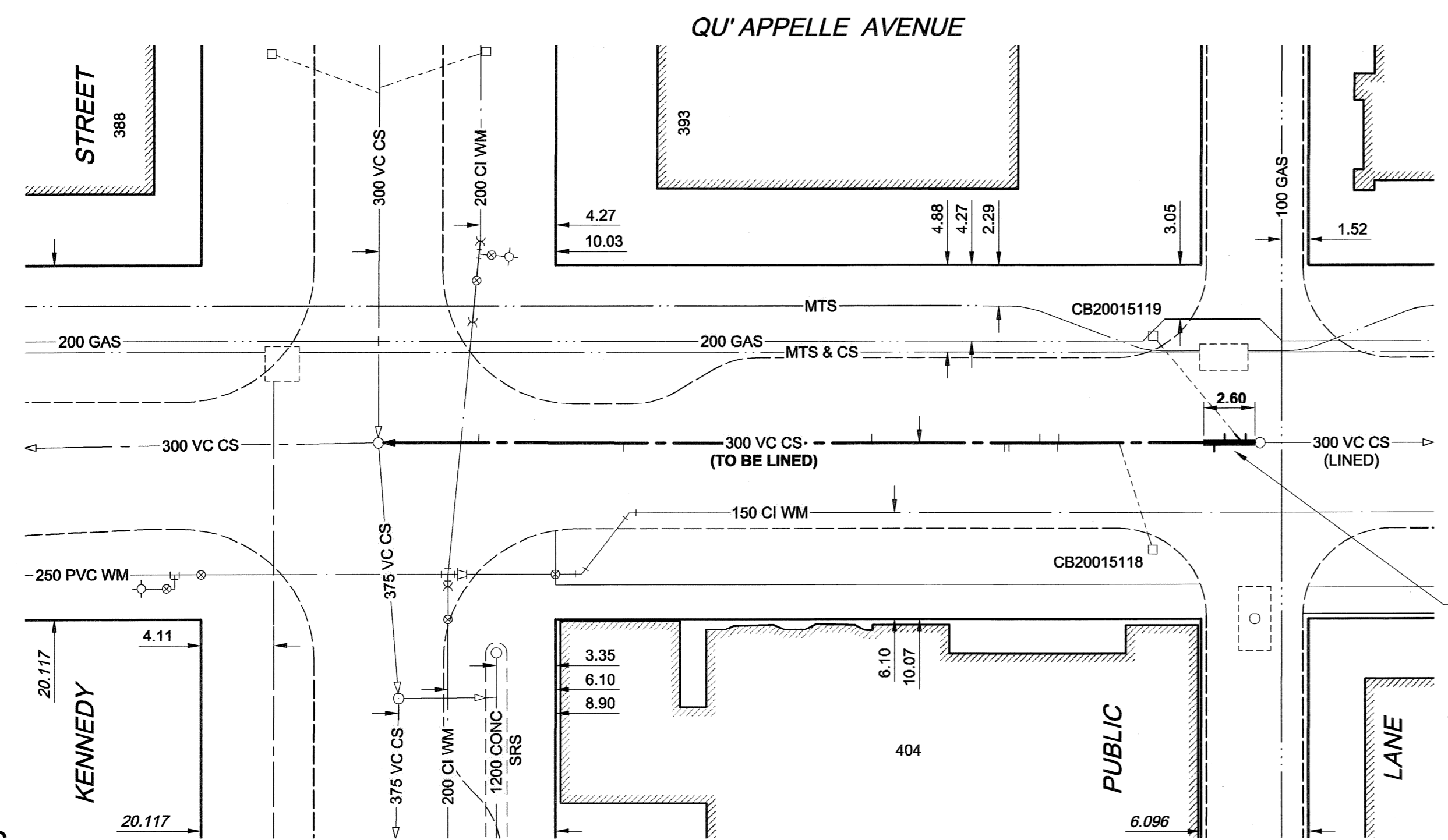
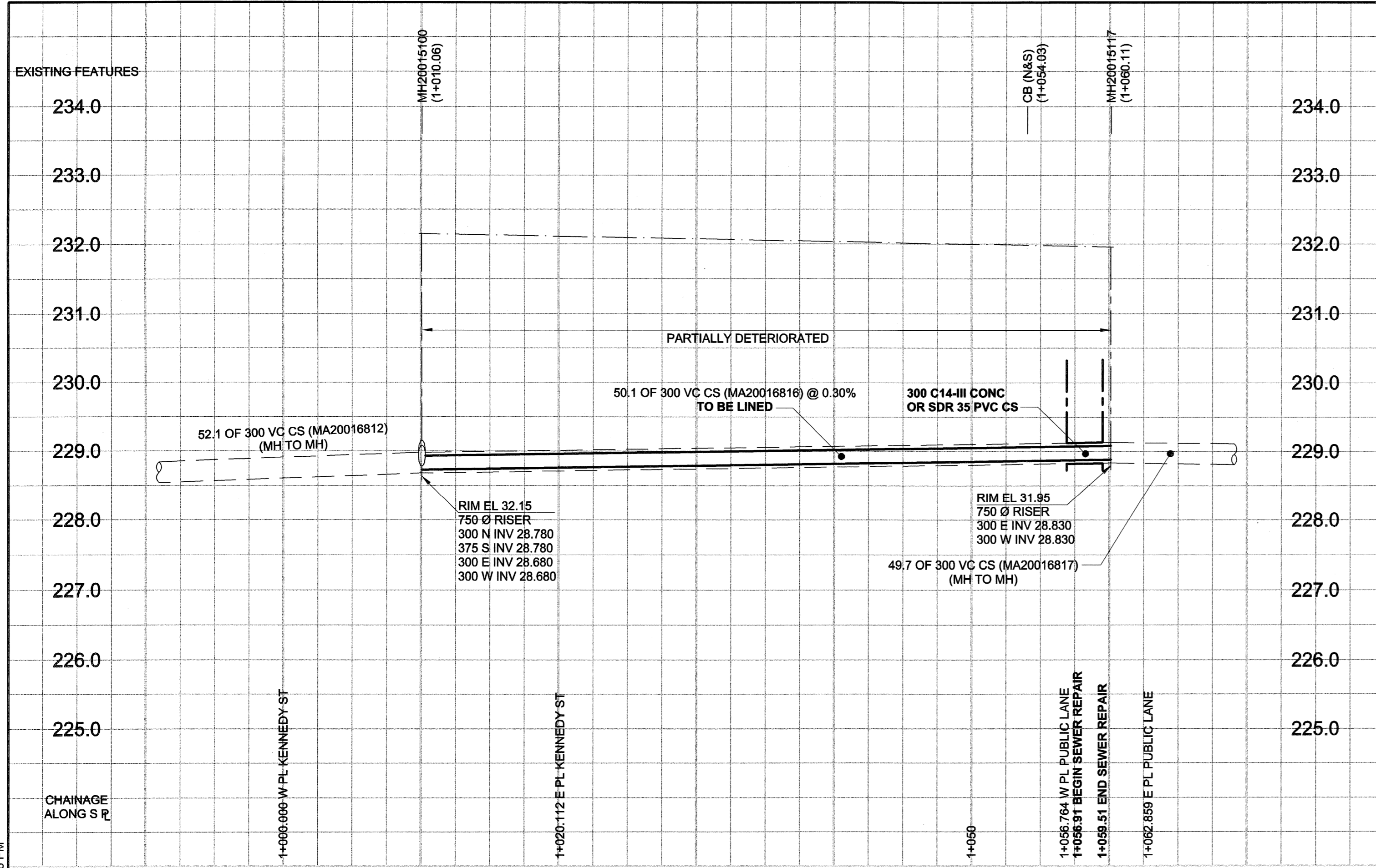

SEWER JUNCTION INFORMATION

REF. MH	DIST FROM REF. MH	SIZE	CLOCK AT
MH20015117	0.80	1000	02
MH20015117	1.00	3000	12
MH20015117	2.00	1500	02
MH20015117	2.60	1500	10
MH20015117	8.00	2000	10
MH20015117	11.40	1500	02
MH20015117	11.50	1500	10
MH20015117	12.50	1500	02
MH20015117	14.50	1500	10
MH20015100	5.70	1500	10
MH20015100	13.90	1500	02
MH20015100	28.00	1500	10
MH20015100	35.80	1500	02

*JUNCTION INFORMATION FROM VIDEO INSPECTION

WARNING
IF POWER EQUIPMENT OR EXPLOSIVES ARE TO BE USED FOR EXCAVATION ON THIS PROJECT, THE CONTRACTOR MUST:
1) NOTIFY THE GAS COMPANY OF THE PROPOSED LOCATION OF EXCAVATION.
2) TAKE PRECAUTION TO AVOID DAMAGE TO GAS COMPANY INSTALLATIONS.
SEE PROVINCIAL REGULATION 140/92 FOR DETAILS

METRIC
WHOLE NUMBERS INDICATE MILLIMETRES
DECIMAL NUMBERS INDICATE METRES

150 WM		150 WM		CURB STOP		150 WM		WATERMAIN		150 WM	
○	HYDRANT	●	VALVE	— —	REDUCER	— —	HYDRANT	— —	WATERMAIN	— —	150 WM
○	LAND DRAINAGE SEWER	○	300 LDS	— —	COUPLING	— —	VALVE	— —	LAND DRAINAGE SEWER	— —	300 LDS
○	WASTE WATER SEWER	○	250 WWS	— —	ANODE	— —	WASTE WATER SEWER	— —	WASTE WATER SEWER	— —	250 WWS
○	MANHOLE	●	HYDRO	— —	MTS	— —	PAVEMENT CROWN	— —	N/W PROPERTY LINE	— —	250 WWS
□	CATCH BASIN	— —	GAS	— —	TESTHOLE	— —	N/W GUTTER	— —	S/E PROPERTY LINE	— —	250 WWS
△	CURB INLET	— —	TREE	— —	LAMP STANDARD	— —	S/E GUTTER	— —		— —	
— —	CULVERT	— —		— —		— —		— —		— —	
— —	PIPE ABANDONMENTS	— —		— —		— —		— —		— —	
— —	SURVEY BAR	— —		— —		— —		— —		— —	
— —	EXISTING	— —	NEW	— —	EXISTING	— —	NEW	— —	EXISTING	— —	NEW

LOCATION APPROVED
UNDERGROUND STRUCTURES

BM 35-048 ELEV 232.422m
E side Kennedy St. Btwn. Qu'Appelle Ave. & Ellice Ave., 7ft. in W. Conc. foundation of No. 355 Kennedy St., 1 m S. & 1.6 m below top of Conc. wall of N.W. Cor. of Bldg.

DESIGNED BY: ALD / MJR
CHECKED BY: [Signature]
DRAWN BY: KMB
APPROVED BY: [Signature]
HOR. SCALE: 1:250
VERT. SCALE: 1:50
DATE: 08/07/08

ISSUED FOR CONSTRUCTION 08/07/08 KMB
NO. REVISIONS YYMMDD BY

UMA | AECOM

© 2006 UMA ENGINEERING LTD. ALL RIGHTS RESERVED.

DESIGNED BY: ALD / MJR
CHECKED BY: [Signature]
DRAWN BY: KMB
APPROVED BY: [Signature]
HOR. SCALE: 1:250
VERT. SCALE: 1:50
DATE: 08/07/08

UMA ENGINEERING
Certificate of Authorization
UMA Engineering Ltd. (MB)
No. 256 Date: 08/07/08

PROFESSIONAL'S SEAL
C. C. MACEY
REGISTERED ENGINEER
CONSULTANT DRAWING NO. 12
D265-228-01

THE CITY OF WINNIPEG
WATER AND WASTE DEPARTMENT

2008 COMBINED SEWER RENEWALS
BY CIPP LINING
CONTRACT 15
QU'APPELLE AVENUE
KENNEDY STREET
TO 30m W OF EDMONTON STREET

SHEET 12 OF 19
CITY DRAWING NUMBER
8591
REV 0

BID OPPORTUNITY NO. 467-2008