

D SIZE 22" x 34" (559mm x 864mm)

PLOT: 08/07/07 3:02:38 PM

UMA REVIEW DRAFT CHK

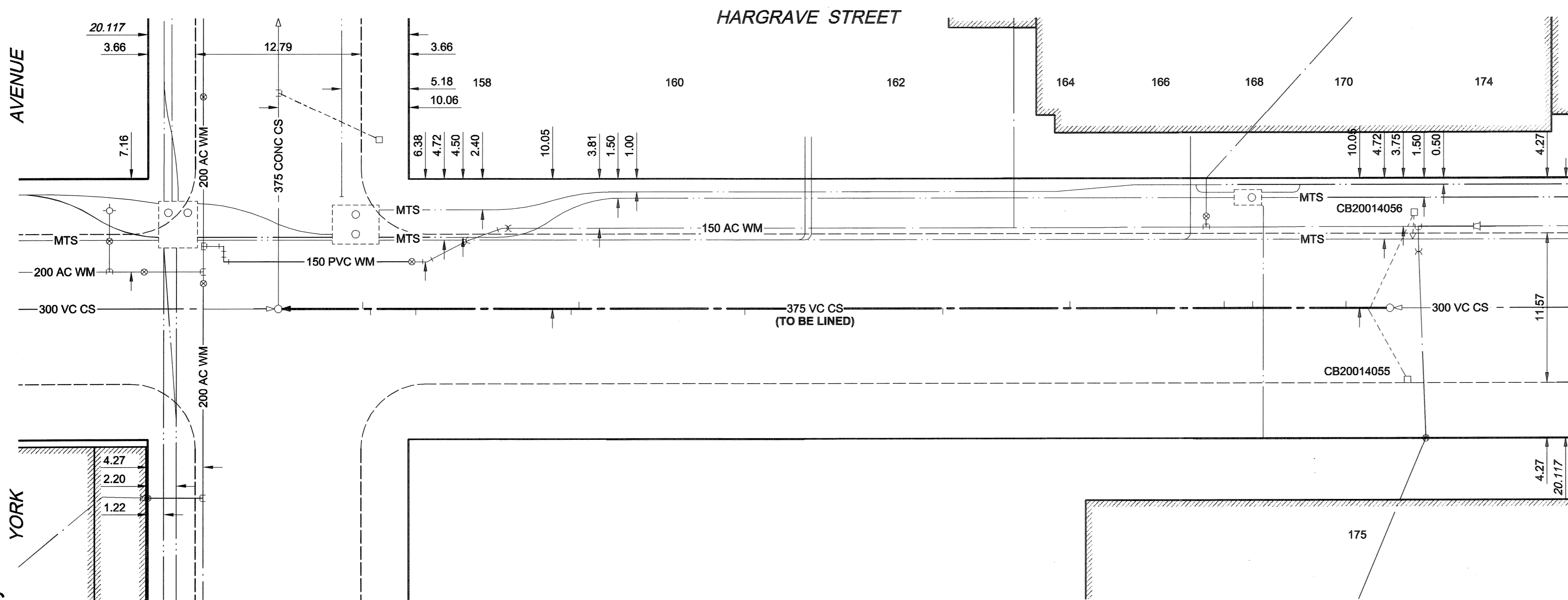
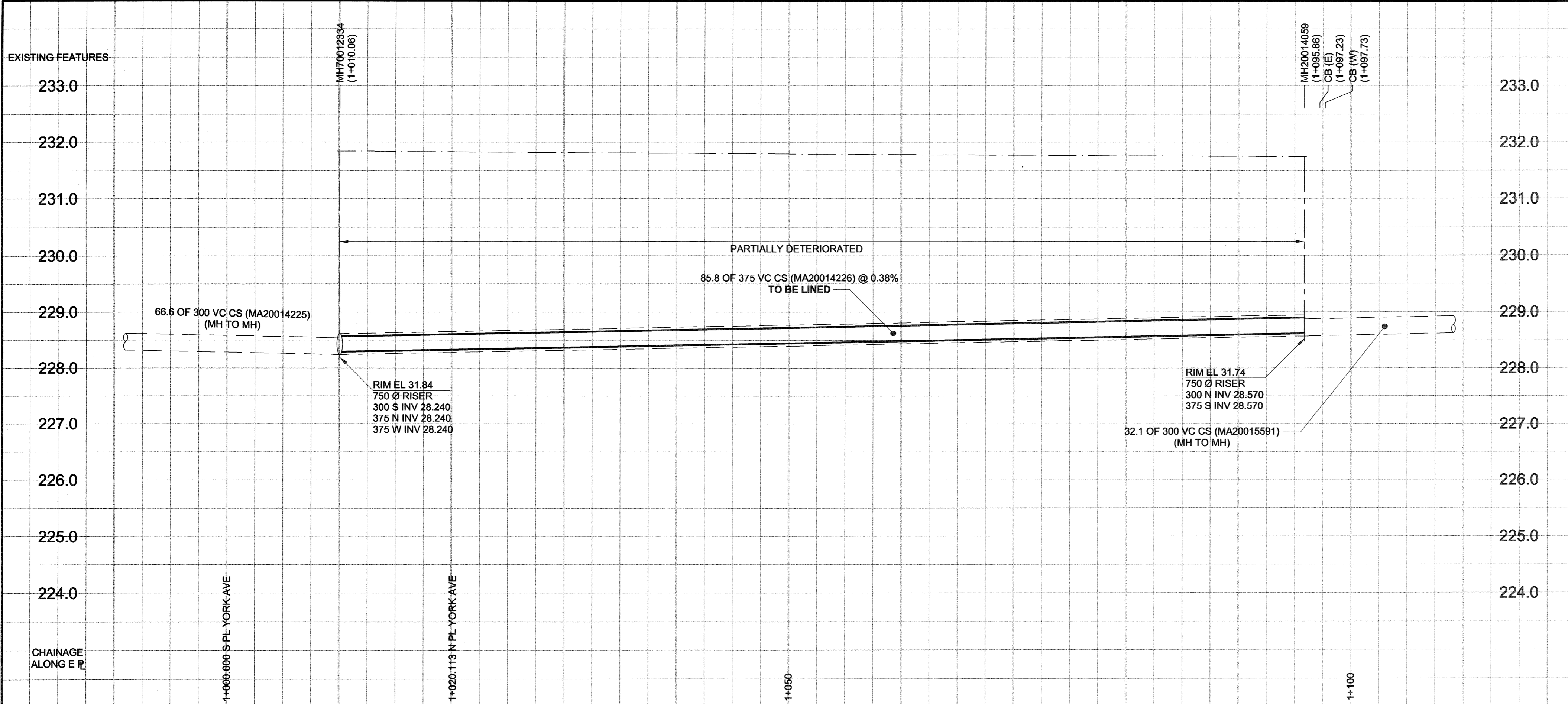

SEWER JUNCTION INFORMATION

REF. MH	DIST FROM	SIZE	CLOCK AT
MH20014059	3.40	1500	02
MH20014059	10.80	1500	02
MH20014059	12.80	1500	02
MH20014059	18.00	1500	10
MH20014059	24.70	1500	02
MH20014059	34.50	1500	10
MH20014059	49.90	1500	09
MH20014059	62.80	1500	02
MH20014059	63.20	1500	10
MH20014059	75.20	1500	09
MH20014059	78.70	1500	09
MH20014059	79.30	1500	03

*JUNCTION INFORMATION FROM VIDEO INSPECTION

WARNING
 IF POWER EQUIPMENT OR EXPLOSIVES ARE TO BE USED FOR EXCAVATION ON THIS PROJECT, THE CONTRACTOR MUST:
 1) NOTIFY THE GAS COMPANY OF THE PROPOSED LOCATION OF EXCAVATION.
 2) TAKE PRECAUTION TO AVOID DAMAGE TO GAS COMPANY INSTALLATIONS.
 SEE PROVINCIAL REGULATION 140/92 FOR DETAILS.

METRIC
 WHOLE NUMBERS INDICATE MILLIMETRES
 DECIMALIZED NUMBERS INDICATE METRES

EXISTING	LEGEND - PLAN	NEW	EXISTING	LEGEND - PLAN	NEW	EXISTING	LEGEND - PROFILE	NEW
150 WM	WATERMAIN	150 WM	150 WM	WATERMAIN	150 WM	150 WM	WATERMAIN	150 WM
300 LDS	LAND DRAINAGE SEWER	300 LDS	300 LDS	LAND DRAINAGE SEWER	300 LDS	300 LDS	LAND DRAINAGE SEWER	300 LDS
250 WWS	WASTE WATER SEWER	250 WWS	250 WWS	WASTE WATER SEWER	250 WWS	250 WWS	WASTE WATER SEWER	250 WWS
○	MANHOLE	●	○	MANHOLE	●	○	MANHOLE	●
□	CATCH BASIN	■	□	CATCH BASIN	■	□	CATCH BASIN	■
△	CURB INLET	▲	△	CURB INLET	▲	△	CURB INLET	▲
▭	CULVERT	▭	▭	CULVERT	▭	▭	CULVERT	▭
—	PIPE ABANDONMENTS	—	—	PIPE ABANDONMENTS	—	—	PIPE ABANDONMENTS	—
+	SURVEY BAR	+	+	SURVEY BAR	+	+	SURVEY BAR	+
○	HYDRANT	○	○	HYDRANT	○	○	HYDRANT	○
○	VALVE	○	○	VALVE	○	○	VALVE	○
○	ANODE	○	○	ANODE	○	○	ANODE	○
○	MTS	○	○	MTS	○	○	MTS	○
○	GAS	○	○	GAS	○	○	GAS	○
○	TESTHOLE	○	○	TESTHOLE	○	○	TESTHOLE	○
○	LAMP STANDARD	○	○	LAMP STANDARD	○	○	LAMP STANDARD	○
○	TREE	○	○	TREE	○	○	TREE	○

LOCATION APPROVED
 UNDERGROUND STRUCTURES

SUPR. U/G STRUCTURES DATE COMMITTEE

NOTE: LOCATION OF UNDERGROUND STRUCTURES AS SHOWN ARE BASED ON THE BEST INFORMATION AVAILABLE. BUT NO GUARANTEE IS GIVEN THAT ALL EXISTING UTILITIES ARE SHOWN OR THAT THE GIVEN LOCATIONS ARE EXACT. CONFIRMATION OF EXISTENCE AND EXACT LOCATION OF ALL SERVICES MUST BE OBTAINED FROM THE INDIVIDUAL UTILITIES BEFORE PROCEEDING WITH CONSTRUCTION.

BM 35-049 ELEV 232.275m	E. side Carlton St. Btw'n Portage Ave. & Graham Ave., Tbl. in Conc. Pier N.W. Cor. Eaton's Parkside, 0.3 m S. & 0.3 m above sidewalk of N.W. Cor. of structure.
DESIGNED BY	ALD / MJR
CHECKED BY	[Signature]
DRAWN BY	KMB
APPROVED BY	[Signature]
HOR. SCALE	1:250
VERT. SCALE	1:50
RELEASED FOR CONSTRUCTION	[Signature]
DATE	08/07/08

APEGM
 Certificate of Authorization
 UMA Engineering Ltd. (MB)
 No. 256 Date: 08/07/08

PROFESSIONAL'S SEAL
 PROVINCE OF MANITOBA
 08 July 2008
C. C. MACEY
 REGISTERED ENGINEER
 CONSULTANT DRAWING NO. 08
 D265-228-01

THE CITY OF WINNIPEG
 WATER AND WASTE DEPARTMENT

2008 COMBINED SEWER RENEWALS
 BY CIPP LINING
 CONTRACT 15
 HARGRAVE STREET
 YORK AVENUE
 TO 63M S OF ST. MARY AVENUE

SHEET 8 OF 19
 CITY DRAWING NUMBER
8587 REV 0

BID OPPORTUNITY NO. 467-2008