

- NOTES:**
- ALL CURBS AND DOWELS FOR CMU WALLS ARE IN THE SCOPE OF BO 583-2005. WALLS AND PARTITIONS SHOWN ON THIS DRAWING INDICATE GENERAL WALL LOCATIONS. CONFIRM AND VERIFY EXACT WALL LOCATIONS AS SHOWN ON THE ARCHITECTURAL DRAWINGS.
 - SEE DETAIL **2** FOR OPENING REINFORCING.
WB-S4451
 - FOR CMU OPENINGS SEE ARCHITECTURAL, MECHANICAL AND ELECTRICAL DRAWINGS.
 - USE NO.9 ASWG@400 JOINT REINFORCEMENT.
 - FOR STAIRS AND HANDRAILS TO PLATFORMS AT ALL LEVELS SEE ARCHITECTURAL DRAWINGS.
 - COORDINATE ALL FABRICATION WITH BO 742-2005 CONTRACTOR.
 - CEILING SUPPORT BEAMS
B1 W200x19
B2 254S89-218M (COLD FORM)
 - STEEL FRAMING BEAM CONNECTIONS:
TO SIDE OF CONC. COL / WALL : SEE **1**
WB-S4452
TO STEEL BEAM : SEE **3**
WB-S4452
AT TOP OF CMU WALL CONN : SEE **2**
WB-S4453 (SIM)
AT SIDE OF CMU WALL : SEE **3**
WB-S4453
 - ALL INTERIOR CMU WALLS ARE 3m HIGH FROM EL. 245.00. FRAMING BEAMS WILL SEAT ON TOP OF INTERIOR WALLS AND SIDE OF EXTERIOR CMU WALLS.

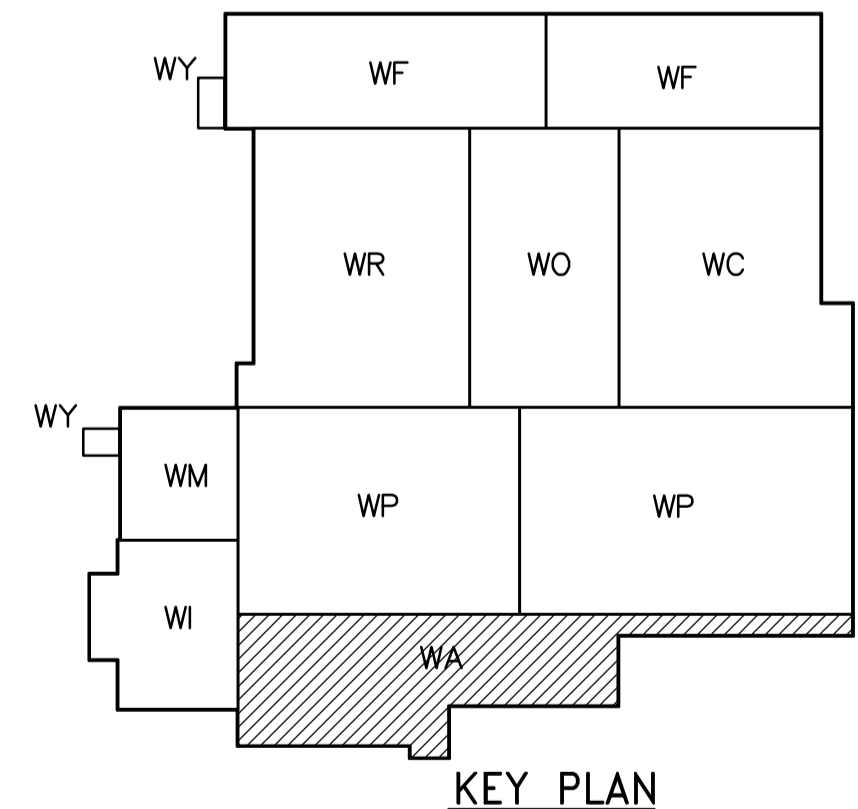

THIRD FLOOR PLAN
1:100

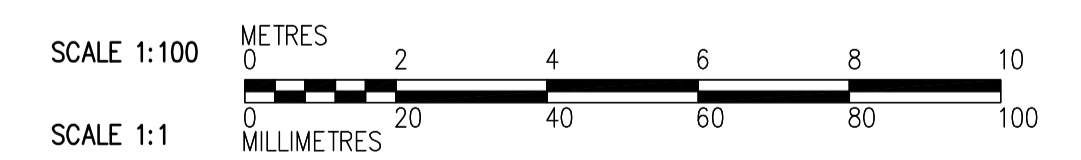

 Certificate of Authorization CH2M HILL Canada Ltd. No. 1441 Expiry: April 30, 2008	 Frederickson Cooper ARCHITECTS	 A Tyco International Ltd. Company	ENGINEER'S SEAL	 THE CITY OF WINNIPEG WATER AND WASTE DEPARTMENT ENGINEERING DIVISION
			DESIGNED BY: MH CHECKED BY: AP DRAWN BY: CR APPROVED BY: AHL SCALE: 1:100 RELEASED FOR CONSTRUCTION BY: R. SOROKOWSKI DATE: 2007/05/06	
B.M. ELEV.			WATER TREATMENT PLANT ADMINISTRATION OFFICE AND PLANT INTERIOR FINISHES	
NO. REVISIONS: 00 ISSUED FOR TENDER: 07/06/05 DATE: 07/06/05 BY: MH			CITY FILE NUMBER: _____ SHEET OF: _____ CITY DRAWING NUMBER: 1-0601A-A-S4131-001-000	
DATE: 2007/06/05			STRUCTURAL ADMINISTRATION AREA THIRD FLOOR PLAN	