

ALLEY PAVEMENT PROFILE

SCALE HOR 1:250
VER 1:10

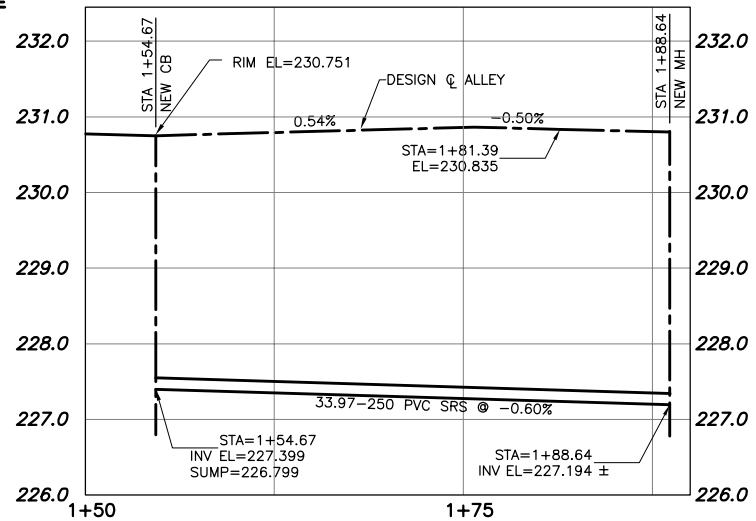

CATCH BASIN & CATCH BASIN LEAD PROFILE

SCALE HOR 1:250
VER 1:50

HARGRAVE ST.

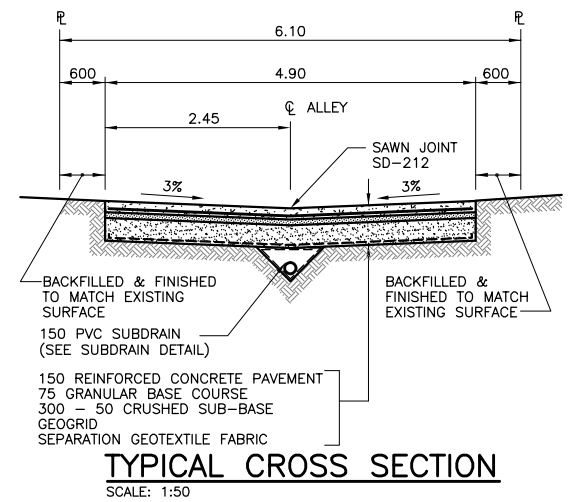

TYPICAL CROSS SECTION

SCALE: 1:50

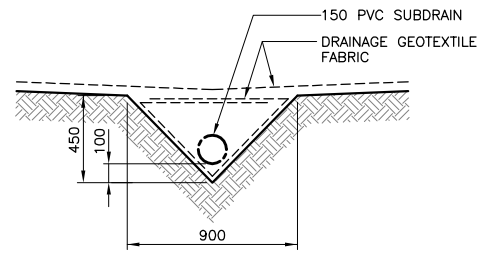

SUBDRAIN DETAIL

SCALE: 1:20

GENERAL NOTES:

- STATION CHAINAGE IS BASED ON CENTERLINE OF ALLEY RIGHT OF WAY.
- ADJUST MH AND CB RIMS TO NEW GRADES.
- PLUG SUBDRAINS AT TERMINAL ENDS.
- REGRADE EXISTING PRIVATE SIDEWALKS AS REQUIRED.
- INSTALLATION OF LIP CURBS AND THEIR EXTENTS TO BE DETERMINED BY THE CONTRACT ADMINISTRATOR.
- LIGHT STANDARDS, HYDRO POLES AND ANCHORS MAY REQUIRE TEMPORARY SUPPORT/REMOVAL OR REPLACEMENT AT THE CONTRACTOR'S EXPENSE.
- ISOLATE ALL POLES, BASES AND PILES WITHIN ALLEY RIGHT OF WAY (SD-228C).
- AVOID DAMAGE TO EXISTING TREES WITHIN THE LIMITS OF CONSTRUCTION.

FENCING NOTES:

- REMOVE AND RESTORE 3.0m WOOD FENCE
- REMOVE AND RESTORE 6.5m WOOD FENCE
- REMOVE AND RESTORE 6.5m WOOD FENCE C/W ATTACHED ELECTRICAL POWER OUTLETS

WARNING

IF POWER EQUIPMENT OR EXPLOSIVES ARE TO BE USED FOR EXCAVATION ON THIS PROJECT THE CONTRACTOR MUST:
1) NOTIFY THE GAS COMPANY OF THE PROPOSED LOCATION OF EXCAVATION.
2) TAKE PRECAUTION TO AVOID DAMAGE TO GAS COMPANY INSTALLATIONS.
SEE PROVINCIAL REGULATION 210/72 FOR DETAILS.

METRIC

WHOLE NUMBERS INDICATE MILLIMETRES
DECIMALIZED NUMBERS INDICATE METRES

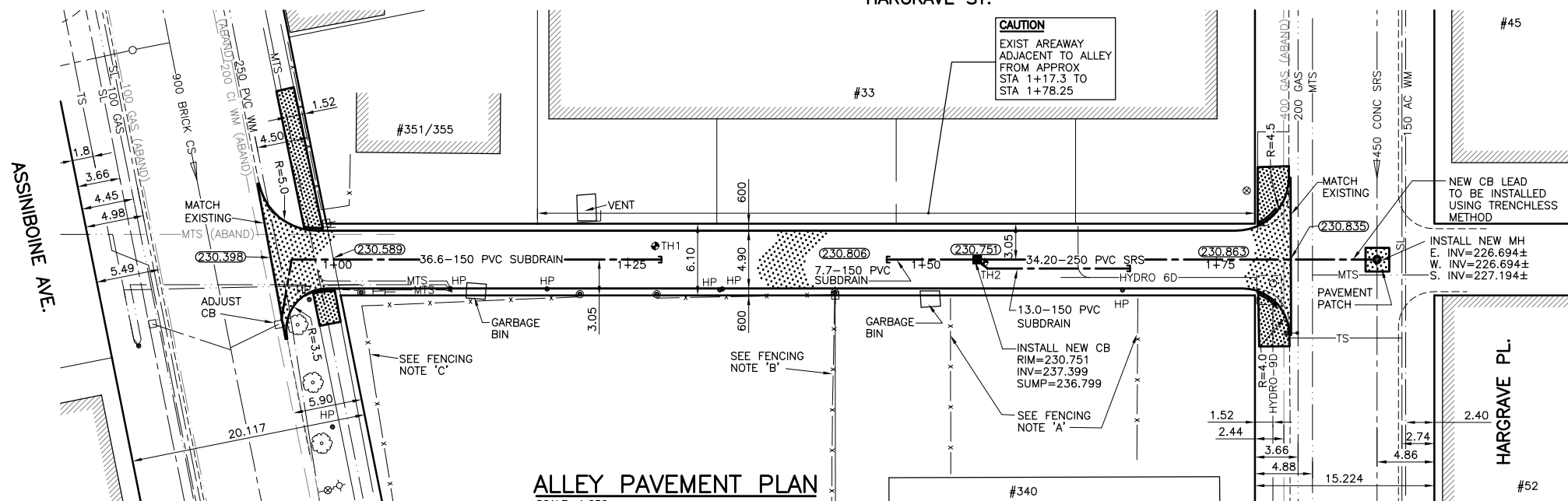
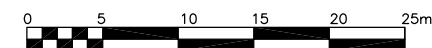
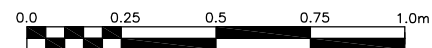
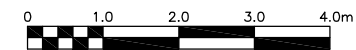

ALLEY PAVEMENT PLAN

SCALE: 1:250

DONALD ST.

300 LBS	LAND DRAINAGE SEWER	300 LBS		TEST HOLE	
250 WWS	WASTE WATER SEWER	250 WWS		GUY WIRE	
---	GAS	---		LIGHT STANDARD	
---	HYDRO	---		BACK OF CURB	
---	M.T.S.	---		CONCRETE	
150 WM	WATERMAIN	150 WM		ASPHALT	
+	HYDRANT	+		SIDEWALK	
o	VALVE	o		PROPERTY LINE	
o	MANHOLE	o		SURVEY BAR	
□	CATCH BASIN	□		GEODETIC BENCHMARK	
▽	CURB INLET	▽		ELEVATION	
•	POLES	•			
EXISTING	LEGEND-PLAN	PROPOSED	EXISTING	LEGEND-PROFILE	PROPOSED

LOCATION APPROVED UNDERGROUND STRUCTURES

SUPV. U/G STRUCTURES DATE COMMITTEE

NOTE:
LOCATION OF UNDERGROUND STRUCTURES AS SHOWN ARE BASED ON THE BEST INFORMATION AVAILABLE BUT NO GUARANTEE IS GIVEN THAT ALL EXISTING UTILITIES ARE SHOWN OR THAT THE GIVEN LOCATIONS ARE EXACT. CONFIRMATION OF EXISTENCE AND EXACT LOCATION OF ALL SERVICES MUST BE OBTAINED FROM THE INDIVIDUAL UTILITIES BEFORE PROCEEDING WITH CONSTRUCTION.

B.M. 35-053
ELEV. 231.410m

N.E. COR. OF CARLTON ST. & ASSINIBOINE AVE.,
TABL. IN S. CONC. FOUNDATION NO. 15
CARLTON ST. (THE KELLY HOUSE) 0.3m E. &
0.8m BELOW BRICK OF S.W. COR. OF BLDG.

KGS CONSULTING ENGINEERS & PROJECT MANAGERS
WINNIPEG (204) 896-1209
THUNDER BAY (807) 345-2233

DESIGNED BY	RO	CHECKED BY	CR
DRAWN BY	DW	APPROVED BY	
HOR. SCALE:	1:250	RELEASED FOR CONSTRUCTION:	
VERTICAL:	1:50	DATE	05/01/07

ENGINEER'S SEAL
ORIGINAL SIGNED BY
M.C. ROWBOTHAM
FEB 07/2007
CONSULTANT DRAWING NO.
06-0107-18

THE CITY OF WINNIPEG
PUBLIC WORKS DEPARTMENT
ENGINEERING SERVICES DIVISION

PROJECT TITLE
2007 ALLEY RENEWAL PROGRAM

SHEET OF
05 OF 09

COMPUTER FILE NAME
06-0107-18

CITY DRAWING NUMBER
0005

HARGRAVE ST./DONALD ST. ALLEY
ASSINIBOINE AVE. TO HARGRAVE PL.
STA. 0+94.58 TO STA. 1+81.39

P:\PROJ\2006\06-0107-18\MUN\DWGS\HARGRAVE\DWG\HARGRAVE_ALLEY-PLAN.DWG
PLOT 1:1 (A1)