

KEY PLAN

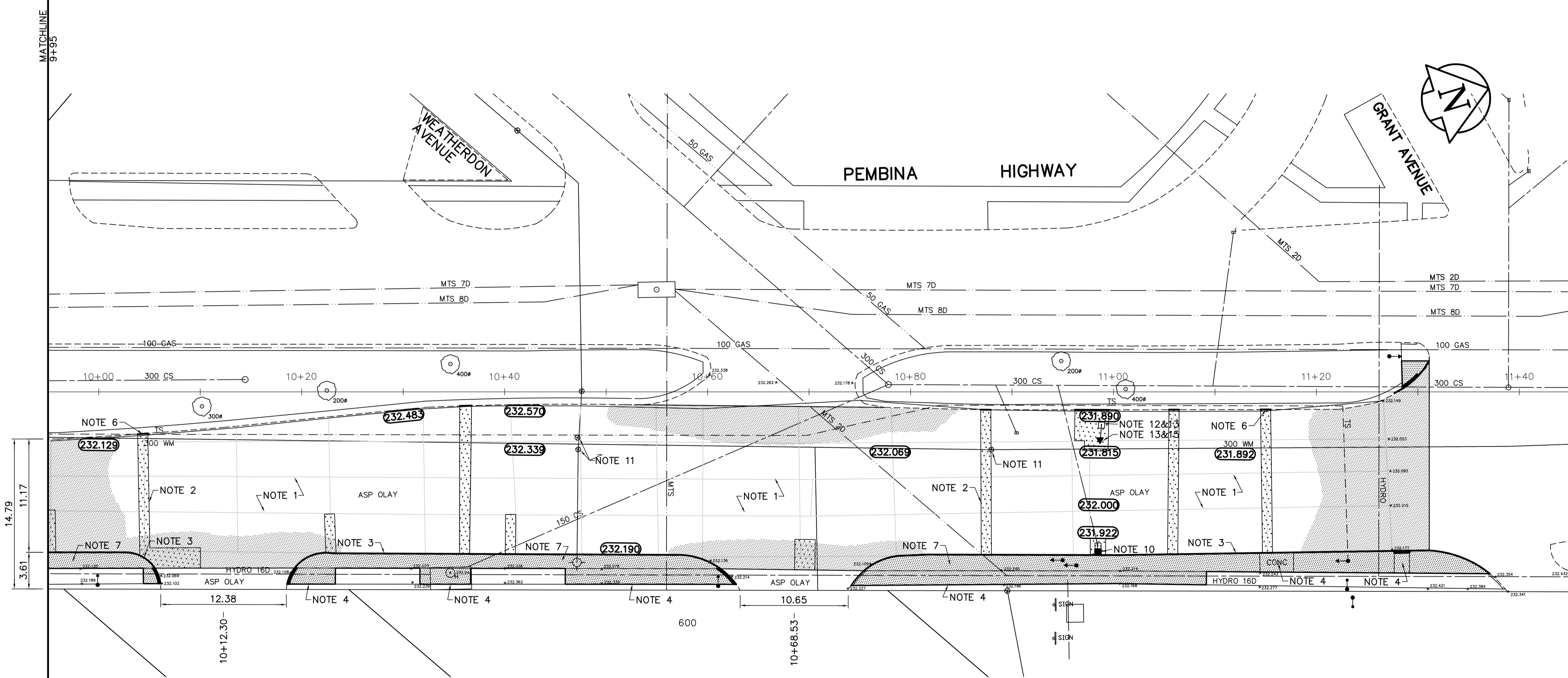

REFERENCE NOTES

- A. BASELINE IS CENTRED BETWEEN SOUTHBOUND MEDIAN AND GUTTER BACK OF CURB LINES.
- B. LEGAL PLAN - L.B.I.S.
- C. ADD 200.000 TO OBTAIN GEODETIC DATUM.
- D. PAVEMENT DIMENSIONS ARE TO BACK OF CURB.
- E. EARTH TECH FIELD BOOK NO. 452B.

CONSTRUCTION NOTES

1. PLANE EXISTING OVERLAY AND CONSTRUCT NEW ASPHALTIC CONCRETE OVERLAY
2. CONSTRUCT NEW 230mm PLAIN DOWELLED CONCRETE PAVEMENT c/w ASPHALTIC CONCRETE OVERLAY
3. REMOVE EXISTING CONCRETE BARRIER CURB
4. REMOVE EXISTING CONCRETE SIDEWALK
5. REMOVE EXISTING PRECAST SIDEWALK BLOCK
6. RENEW CONCRETE BARRIER CURB AND ADJUST EXISTING PRECAST SIDEWALK BLOCK
7. CONSTRUCT NEW MONOLITHIC CONCRETE CURB AND SIDEWALK
8. ABANDON EXISTING DRAINAGE INLET
9. INSTALL NEW CURB AND GUTTER FRAME INLET c/w CATCHPIT (SD-023) AND CONNECT TO EXISTING CATCHBASIN
10. INSTALL NEW CURB AND GUTTER FRAME INLET c/w CATCHBASIN (SD-024) AND CONNECT TO EXISTING CATCHBASIN LEAD
11. ADJUST EXISTING WATER VALVE TO GRADE
12. ADJUST EXISTING MANHOLE/CATCHBASIN FRAME AND COVER
13. INSTALL NEW CAST IRON RISER RING
14. INSTALL NEW CURB AND GUTTER FRAME AND COVER
15. INSTALL NEW MANHOLE FRAME AND GRATED COVER c/w CATCHPIT (SD-023) AND CONNECT TO EXISTING CATCHBASIN

APEGM
 Certificate of Authorization
 Earth Tech Canada Inc.
 No. 730 Expiry: April 30, 2007

METRIC
 WHOLE NUMBERS INDICATE MILLIMETRES
 DECIMALIZED NUMBERS INDICATE METRES

150 mm W.M.	WATERMAIN	150 mm W.M.	HYDRO	— — — — —	⊗	PROFILE
⊕	HYDRANT	⊕	M.T.S.	— — — — —	⊗	WEST MEDIAN GUTTER
⊕	VALVE	⊕	CONCRETE	— — — — —	⊗	EAST MEDIAN GUTTER
⊕	LAND DRAINAGE SEWER	300mm L.D.S.	ASPHALT	— — — — —	⊗	WEST GUTTER
⊕	WASTEWATER SEWER	250mm W.W.S.	PROPERTY LINE	— — — — —	⊗	EAST GUTTER
⊕	MANHOLE	⊕	SURVEY BAR	— — — — —	⊗	
⊕	CATCH BASIN	⊕	ELEVATION	(32.750)	⊗	
⊕	CURB INLET	⊕	TREE	⊗	⊗	
⊕	JUNCTIONS	⊕	SIDEWALK RAMP	— — — — —	⊗	
⊕	CULVERT	⊕	CONCRETE SIDEWALK	— — — — —	⊗	
⊕	GAS	⊕	FENCE	— — — — —	⊗	
EXISTING	LEGEND - PLAN	PROPOSED	EXISTING	LEGEND - PLAN	PROPOSED	EXISTING
EXISTING	LEGEND - PROFILE	PROPOSED	EXISTING	LEGEND - PROFILE	PROPOSED	EXISTING

LOCATION APPROVED UNDERGROUND STRUCTURES
 SUPV. U/G STRUCTURES DATE COMMITTEE
 NOTE:
 LOCATION OF UNDERGROUND STRUCTURES AS SHOWN ARE BASED ON THE BEST INFORMATION AVAILABLE, BUT NO GUARANTEE IS GIVEN THAT ALL EXISTING UTILITIES ARE SHOWN OR THAT THE GIVEN LOCATIONS ARE EXACT. CONFIRMATION OF EXISTENCE AND EXACT LOCATION OF ALL SERVICES MUST BE OBTAINED FROM THE INDIVIDUAL UTILITIES BEFORE PROCEEDING WITH CONSTRUCTION.

B.M. 52-006	Tab. in W. Conc. foundation of No. 750		
ELEV. 232.631	Pembina Hwy, opposite Taylor Ave., 0.5 m N. of S.W. Cor.		
NO.	REVISIONS	DATE	BY
0	ISSUED FOR TENDER	FEB 27/07	KWR
A	ISSUED FOR REVIEW	JAN 31/07	KWR

EarthTech
 A Tyco International Ltd. Company

DESIGNED BY	RC	CHECKED BY	KWR
DRAWN BY	RC	APPROVED BY	
HOR. SCALE:	1:250	RELEASED FOR CONSTRUCTION BY:	
VERTICAL:	1:10	DATE	2007/01/31

ENGINEER'S SEAL
 ORIGINAL SIGNED
 K.W.
 RAJ
 FEB 27/07
 REGISTERED PROFESSIONAL ENGINEER

THE CITY OF WINNIPEG
 PUBLIC WORKS DEPARTMENT
 TRANSPORTATION ENGINEERING DIVISION

PEMBINA HIGHWAY (NORTHBOUND)
STAFFORD STREET TO GRANT AVENUE
CONCRETE REPAIRS AND ASPHALT RESURFACING

CITY DRAWING NUMBER P-3274-B
 SHEET 8 OF 13

PLAN/PROFILE
 STA. 9+95 TO GRANT AVENUE