

### SUPERVISOR'S DESK

- KEYBOARD TRAY/DRAWER
- 3 GROMMETS
- 2 @ MOBILE, LOCKABLE PEDS  
KEYED ALIKE 1 @ BBF,  
1 @ FF
- CLOSED QA HOOTH
- TACKBOARD
- 2 LIGHTS
- COLOURS TO FOLLOW

### MULTI-USE

#### COMPUTER WORKSTATION

- KEYBOARD TRAY/DRAWER
- GROMMET
- 2 @ MOBILE PEDS, LOCKABLE,  
KEYED ALIKE, 1 @ BBF  
1 @ F.F.
- DESK TOPPER
- COLOURS TO FOLLOW

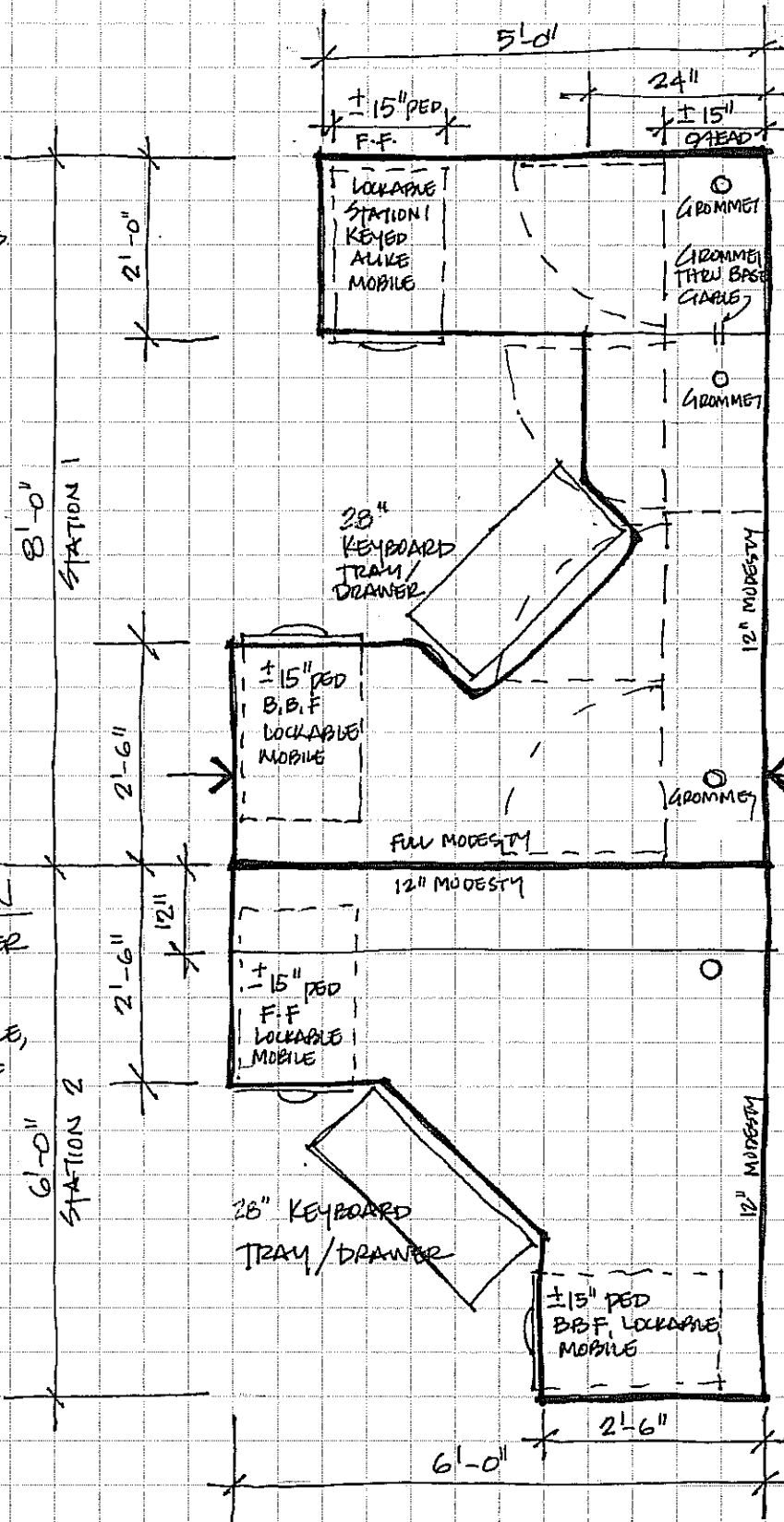

- 2 SHELF  
CLOSED QA
- 2 @ 3' LIGHTS
- TACKBOARDS  
UNDER ALL  
OVERHEADS

DESK TOPPER  
12" X 6'-0" X  
13" H (INSIDE)

PEMBINA TRAIL LIBRARY  
2724 PEMBINA HWY  
SUPERVISOR'S DESK = MULTI-USE  
COMPUTER WORKSTATION  
DRAWING A15 R1  
SGDW AUG 07