

- CONSTRUCTION NOTES:**
- SEWER TO BE RENEWED BY TRENCHLESS METHODS.
  - CONFIRM THE LOCATION OF ALL SEWER SERVICES WITHIN LIMITS OF RENEWAL.
  - RENEW SEWER SERVICES TO R.
  - BACKFILL UNDER PAVEMENT, IN SIDEWALKS, & WITHIN 1.0 m OF PAVEMENT TO BE CLASS 3.
  - BACKFILL IN BOULEVARD TO BE CLASS 5.
  - SEWER SERVICES TO BE INSTALLED AT A MINIMUM 1.0% SLOPE.
  - SEWER SERVICE RISERS TO BE INSTALLED WHEN SEWER EXCEEDS 4.25 m IN DEPTH.

SEWER SERVICE INFORMATION		
ADDRESS	SIZE	€ DIST
2610 ASSINIBONE CR RESIDENTIAL		NO INFORMATION AVAILABLE
2611 ASSINIBONE CR RESIDENTIAL	0.93 E OF WL	
2614 ASSINIBONE CR RESIDENTIAL	7.36 W 1ST MH E THOMPSON	
2615 ASSINIBONE CR RESIDENTIAL		NO INFORMATION AVAILABLE
2617 ASSINIBONE CR RESIDENTIAL	19.64 S OF NL	
2622 ASSINIBONE CR RESIDENTIAL	35.85 N MH AT ASSINIBONE	
171 THOMPSON DR RESIDENTIAL	2.94 N OF SL	
175 THOMPSON DR RESIDENTIAL	8.74 E MH AT ASSINIBONE	
177 THOMPSON DR RESIDENTIAL	5.61 N OF SL	
	10.90 N MH AT ASSINIBONE	
	4.05 N OF SL	
	26.40 N MH AT ASSINIBONE	

NOTE: CHAINAGES SHOWN ARE ALONG E R OF THOMPSON DR.

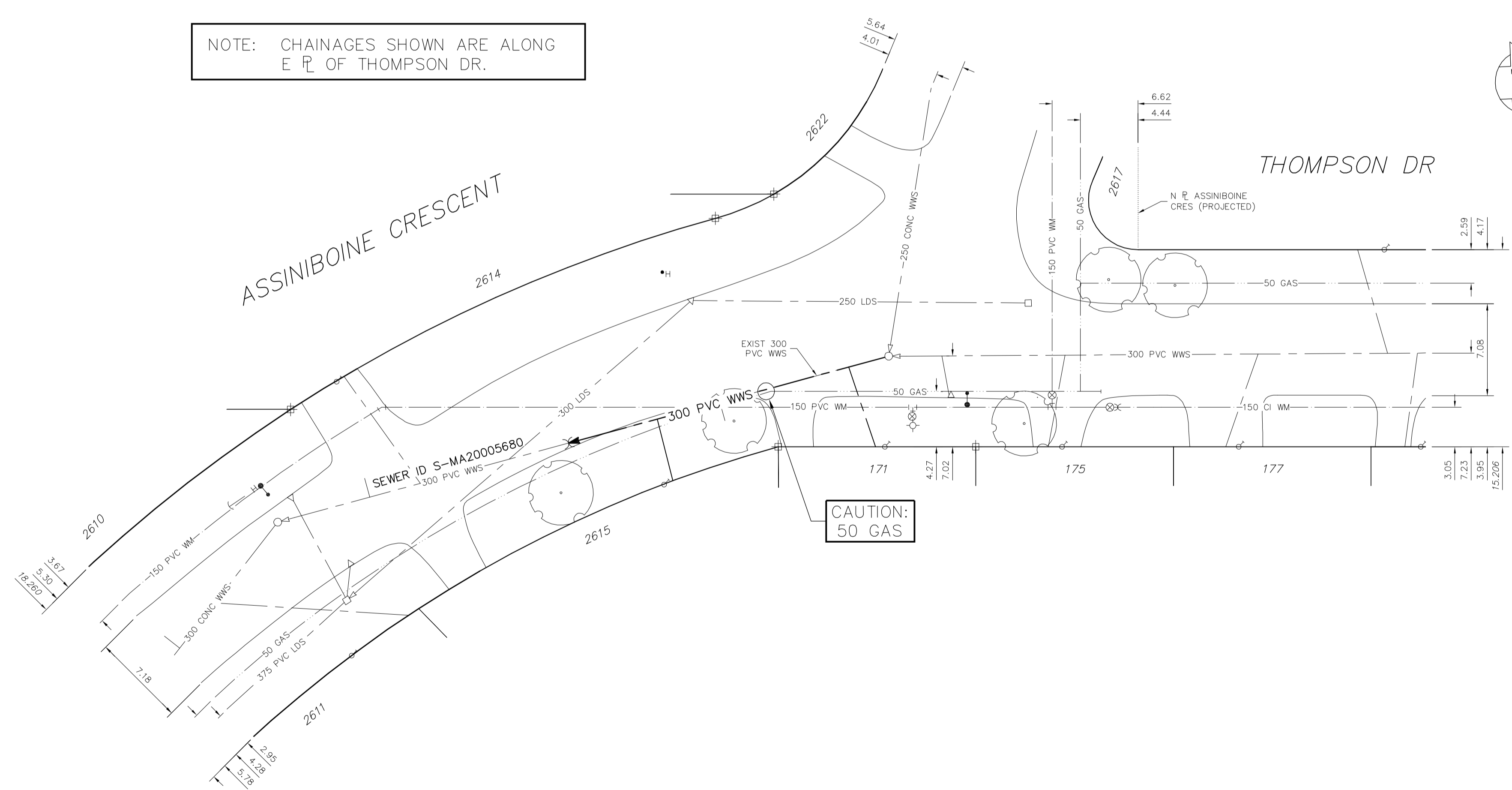

**WATER SERVICE INFORMATION**

ADDRESS	SIZE(mm) & TYPE (STREET)	SIZE(mm) & TYPE (PROP)	SHORT & LONG MEASUREMENT	CORP. LOCATION
2610 ASSINIBONE CR RESIDENTIAL	20 COPPER	-	5.19 N OF SHL	4.65 E OF S/C
2611 ASSINIBONE CR RESIDENTIAL	20 COPPER	-	57.28 WML WNDHAM	
2614 ASSINIBONE CR RESIDENTIAL	20 COPPER	-	2.75 S OF NHL	5.74 W OF S/C
2615 ASSINIBONE CR RESIDENTIAL	20 COPPER	-	65.43 WML WNDHAM	
2617 ASSINIBONE CR RESIDENTIAL	20 COPPER	-	1.37 W OF EHL	4.0 N OF S/C
2615 ASSINIBONE CR RESIDENTIAL	20 COPPER	-	94.22 WML WNDHAM	
2617 ASSINIBONE CR RESIDENTIAL	20 COPPER	-	OFF NHL	6.05 N OF S/C
2617 ASSINIBONE CR RESIDENTIAL	20 COPPER	-	9.33 EEL THOMPSON	
2622 ASSINIBONE CR RESIDENTIAL	20 COPPER	-	5.46 S OF NHL	SERV. OFF THOMPSON
2622 ASSINIBONE CR RESIDENTIAL	20 COPPER	-	19.01>NNL ASSINIBONE	
171 THOMPSON DR RESIDENTIAL	20 COPPER	-	37.89 EEL WOODBRIDGE	4.65 W OF S/C
175 THOMPSON DR RESIDENTIAL	20 COPPER	-	5.26 NSL HSE	3.4 N OF S/C
177 THOMPSON DR RESIDENTIAL	20 COPPER	-	19.57 SNL ASSINIBONE	
	12 COPPER	-	OPP SHL	4.8 N OF S/C
	20 LEAD	-	5.89 SNL ASSINIBONE	
	20 HSE	-	1.80 SSL HSE	
	20 COPPER	-	7.75 NHL ASSINIBONE	

SEWER JUNCTION INFORMATION FROM SEWER VIDEO INSPECTION SEWER ID S-MA20005680

DISTANCE FROM MH ID S-MH20005190			
3.2 E	150Ø	NORTH	CNI
13.5 E	150Ø	NORTH	JN
18.5 E	150Ø	NORTH	CN
41.5 E	150Ø	SOUTH	CN

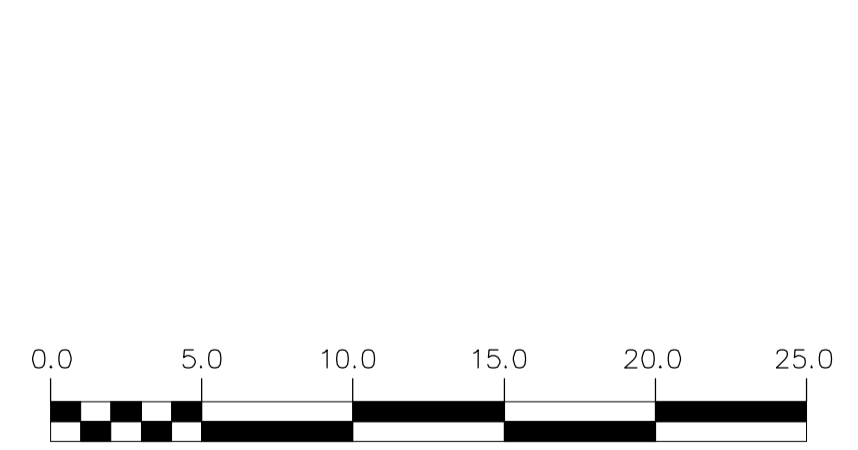

**METRIC**  
WHOLE NUMBERS INDICATE MILLIMETRES  
DECIMALIZED NUMBERS INDICATE METRES

**WARNING**

IF POWER EQUIPMENT OR EXPLOSIVES ARE TO BE USED FOR EXCAVATION ON THIS PROJECT THE CONTRACTOR MUST:  
1) NOTIFY THE GAS COMPANY OF THE PROPOSED LOCATION OF EXCAVATION.  
2) TAKE PRECAUTION TO AVOID DAMAGE TO GAS COMPANY INSTALLATIONS.  
SEE PROVINCIAL REGULATION 210/72 FOR DETAILS

EXISTING	LEGEND-PLAN	PROPOSED	EXISTING	LEGEND-PLAN	PROPOSED	EXISTING	LEGEND-PROFILE	PROPOSED
200 WM	WATERMAIN	200 WM	SL, HYDRO	150 WM	WATERMAIN	150 WM	WATERMAIN	150 WM
525 LDS	LAND DRAINAGE SEWER	525 LDS	50 GAS	50 GAS	50 GAS	300 LDS	LAND DRAINAGE SEWER	300 LDS
375 WWS	WASTEWATER SEWER	375 WWS	300 WWS	300 WWS	300 WWS	250 WWS	WASTEWATER SEWER	250 WWS
MANHOLE	MANHOLE	MANHOLE	FENCE	€ PROFILE	€ PROFILE	GROUND ABOVE PIPE	GROUND ABOVE PIPE	GROUND ABOVE PIPE
CATCH BASIN	CATCH BASIN	CATCH BASIN	POLE - HYDRO, MTS	? DITCH (NORTH & WEST)	? DITCH (NORTH & WEST)	? DITCH (SOUTH & EAST)	? DITCH (SOUTH & EAST)	? DITCH (SOUTH & EAST)
CURB INLET	CURB INLET	CURB INLET	GUY ANCHOR	GUY ANCHOR	GUY ANCHOR	GUTTER (NORTH & WEST)	GUTTER (NORTH & WEST)	GUTTER (NORTH & WEST)
JUNCTIONS	JUNCTIONS	JUNCTIONS	LIGHT STANDARD	LIGHT STANDARD	LIGHT STANDARD	GUTTER (SOUTH & EAST)	GUTTER (SOUTH & EAST)	GUTTER (SOUTH & EAST)
CULVERT	CULVERT	CULVERT	TREE	TREE	TREE			
ANODE	ANODE	ANODE						
EXISTING	LEGEND-PLAN	PROPOSED	EXISTING	LEGEND-PLAN	PROPOSED	EXISTING	LEGEND-PROFILE	PROPOSED

LOCATION APPROVED UNDERGROUND STRUCTURES		B.M. ELEV.	FIELD BOOK #:
SUPV. U/G STRUCTURES COMMITTEE <td>DATE <td>POSTED TO LBIS</td> <td></td> </td>	DATE <td>POSTED TO LBIS</td> <td></td>	POSTED TO LBIS	
NO.	REVISIONS	DATE	BY

**CITY OF WINNIPEG WATER AND WASTE ENGINEERING DIVISION**

DESIGNED BY: NC  
CHECKED BY: TW  
DRAWN BY: CJH  
APPROVED BY: KZ  
HOR. SCALE: 1:250  
VERTICAL: 1:50  
DATE: 2007 09 10

ENGINEER'S SEAL  
ORIGINAL SIGNED BY K.R. ZUREK  
07/09/10  
BID OPPORTUNITY: 653-2007  
FILENAME: 06178.dwg  
PLOT DATE: 2007 09 10

**THE CITY OF WINNIPEG**  
WATER AND WASTE DEPARTMENT

2007 SEWER RENEWALS  
CONTRACT 16  
ASSINIBONE CRESCENT  
MH AT THOMPSON STREET TO  
1ST MH W OF THOMPSON STREET

SHEET 20 OF 25  
CITY DRAWING NUMBER  
06178