



**PROPOSED TREES:**

**2 x Bur Oak**  
(*Quercus macrocarpa*) (BO)

**1 x Harvest Gold Linden** (*Tilia mongolica 'Harvest Gold'*) (HL)

**1 x Manchurian Ash** (*Fraxinus mandshurica*) (MA)

**1 x Silver Maple** (*Acer saccharinum*) (SM)

**Exact location to be determined on site by Contract Administrator**

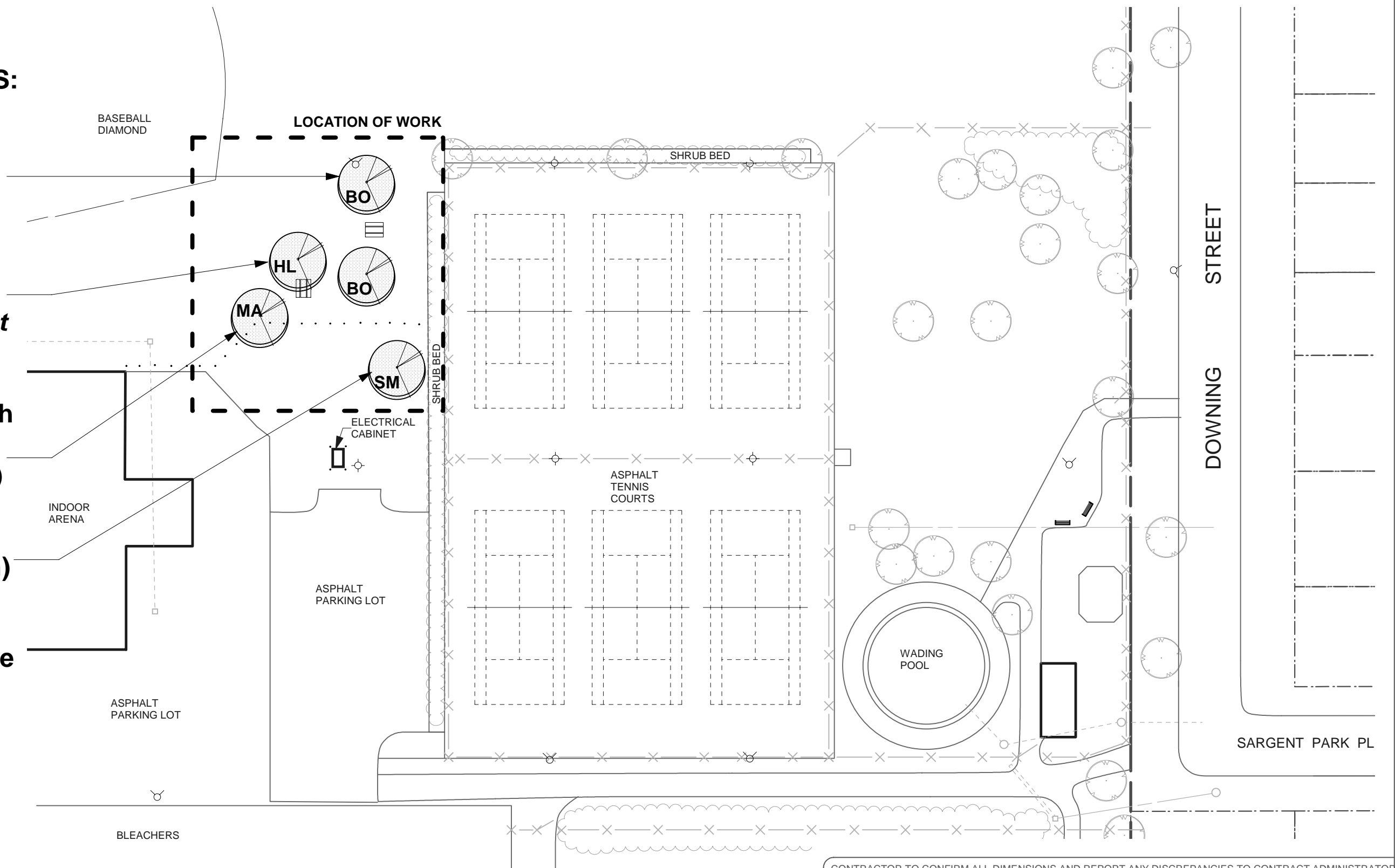

CONTRACTOR TO CONFIRM ALL DIMENSIONS AND REPORT ANY DISCREPANCIES TO CONTRACT ADMINISTRATOR PRIOR TO CONSTRUCTION. LOCATION OF UNDERGROUND STRUCTURES AS SHOWN ARE BASED ON THE BEST INFORMATION AVAILABLE BUT NO GUARANTEE IS GIVEN THAT ALL EXISTING UTILITIES ARE SHOWN OR THAT THE GIVEN LOCATIONS ARE EXACT. CONFIRMATION OF EXISTENCE AND EXACT LOCATION OF ALL SERVICES MUST BE OBTAINED FROM THE INDIVIDUAL UTILITIES BEFORE PROCEEDING WITH CONSTRUCTION.



THE CITY OF WINNIPEG  
Planning, Property and Development Department  
Planning and Land Use Division  
Unit 15 - 30 Fort Street, Winnipeg, MB, (R3C 4X5)

DESIGNED BY	CHECKED BY	MANAGER, PARK AND OPEN SPACES	DATE
DRAWN BY SP	APPROVED BY		
HORIZ. SCALE 1:500		MANAGER, PLANNING AND LAND USE DIVISION	DATE
VERT. SCALE			
DATE SEPT. 2007			

DRAWING TITLE <b>Cindy Klassen Recreation Complex</b>
Proposed Tree Planting
SITE ADDRESS

DRAWING NO. <b>C.80-A</b>
BID OPPORTUNITY NO. <b>651-2007</b>