

BASEMENT FLOOR PLAN - PLUMBING/FLOOR DEMOLITION
SCALE: 1/8"=1'-0"

PLUMBING DEMOLITION NOTES

- ① REMOVE DRAIN TILES & PERIMETER WEEPING TILE AS SHOWN. CONSULT WITH CLIENT ON CONDITION OF DRAINAGE STONES TO BE REPLACED OR NOT.
- ② AREA OF BASEMENT CONCRETE SLAB CUT-OUT FOR REPLACEMENT/NEW DRAIN TILES, NEW SUMP PIT, BACKWATER VALVE, CLOSET FLANGES, FLOOR DRAINS, SHOWER DRAINS. SEE BASEMENT PLUMBING RENOVATION DRAWING.
- ③ DIMENSION GOVERNED BY ACTUAL EXISTING LOCATION OF DRAIN TILES & SANITARY SEWER. CUT WIDTH SHALL BE 18" WIDE FROM CENTERLINE.
- ④ REMOVE EXISTING CLOSET FLANGE & LINE CONNECTION TO SANITARY SEWER. REWORK SECTION TO ACCEPT RENOVATION.

PLUMBING RENOVATION NOTES:

SUPPLY & INSTALL, UNLESS OTHERWISE NOTED.

- ① REPLACE EXISTING DRAIN TILES FROM NEW PERIMETER WEEPING TILES TO EXISTING CATCH BASIN. SIZE TO MATCH EXISTING.
- ② SUMP PIT - REPLACE EXISTING CB DRAIN TILE LINE WITH NEW 3" PVC PIPE SLOPE TO DRAIN INTO NEW SUMP PIT.
- ③ CONNECT NEW WEEPING TILE FOR NEW LIFT VESTIBLE TO NEW BUILDING PERIMETER WEEPING TILE SYSTEM.
- ④ IN-FLOOR CONDENSATE 1-1/2" PVC PIPE TRANSITION FROM SOUTH WALL TO NEW FLOOR DRAIN, SEE DRAWING M5.

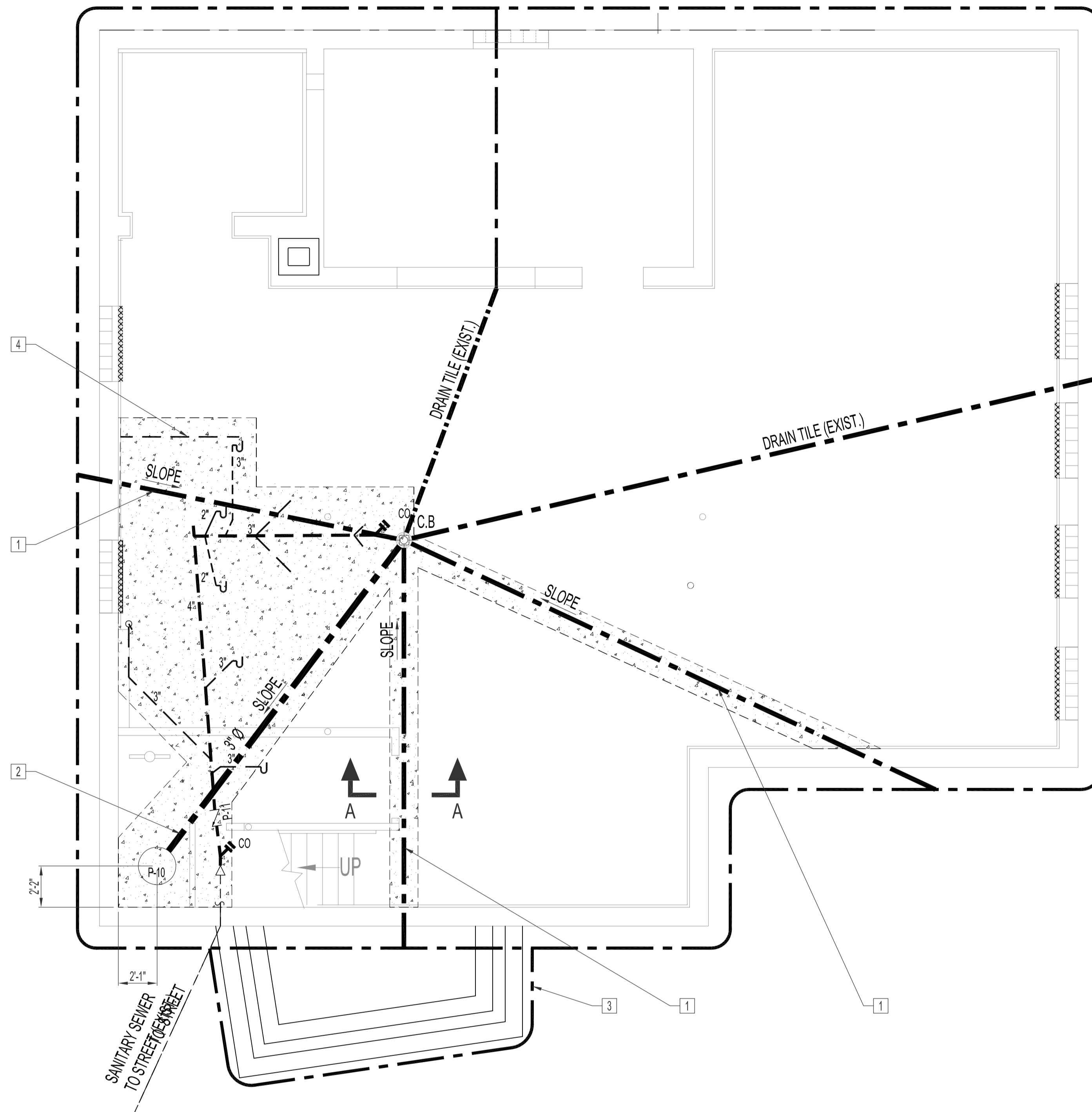

BASEMENT FLOOR PLAN - IN-FLOOR PLUMBING RENOVATION
SCALE: 1/4"=1'-0"

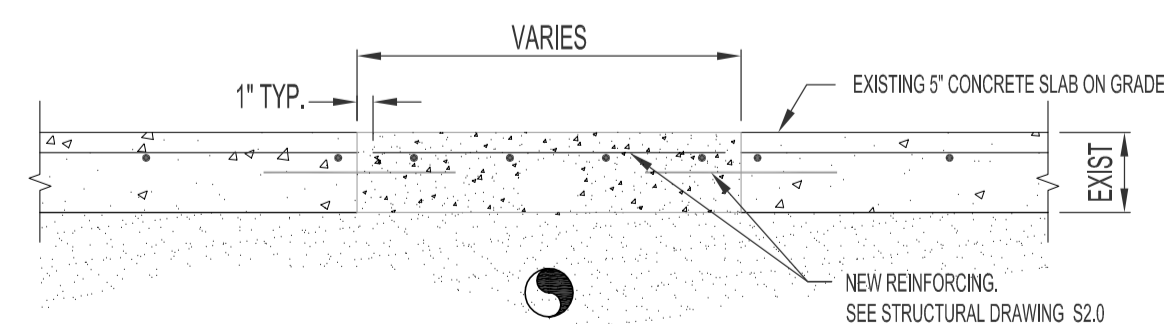

SECTION "A-A"
TYPICAL CONCRETE FLOOR CUT
SCALE: 1"=1'-0"

NOTES :
SEE NOTES ON DRAWING M1.

| NO. | REVISION/DESCRIPTION | BY | DATE |
|-------|----------------------|----|------|
| SEALS | | | |

ORIGINAL STAMPED BY: DOUG PALEY, P. ENG.
DATE: 2007.10.17

| DRAWN BY | DATE | CHECKED BY | APPROVED |
|----------|------------|---------------|----------|
| DTA | 2007.10.11 | USER APPROVAL | |

CITY OF WINNIPEG
PLANNING, PROPERTY &
DEVELOPMENT DEPARTMENT
CIVIC ACCOMMODATIONS DIVISION
300 - 65 GARRY ST. R3C 4K4

PROJECT
COMMUNITY POLICE SERVICE CENTRE

1400 HENDERSON HWY.
SHEET TITLE
BASEMENT FLOOR PLAN
IN-FLOOR PLUMBING & CONCRETE FLOOR
DEMOLITION AND RENOVATION

| SCALE | PROJECT NO. | SHEET NO. |
|----------|-------------|-----------|
| AS SHOWN | 2004-023 | M4 |