

WATER SERVICE INFORMATION						
ADDRESS	DISTANCE	SIZE (mm)	SHORT & LONG	CORPORATION	CATHODIC PROTECTION	REMARKS
382 OAKVIEW ST (RESIDENTIAL)						NO INFO
383 OAKVIEW ST (RESIDENTIAL)						NO INFO
386 OAKVIEW ST (RESIDENTIAL)						NO INFO
400 OAKVIEW ST (RESIDENTIAL)						NO INFO
401 OAKVIEW ST (RESIDENTIAL)						NO INFO
404 OAKVIEW ST (RESIDENTIAL)						NO INFO
407 OAKVIEW ST (RESIDENTIAL)						NO INFO
408 OAKVIEW ST (RESIDENTIAL)						NO INFO
412 OAKVIEW ST (RESIDENTIAL)						NO INFO
413 OAKVIEW ST (RESIDENTIAL)						NO INFO
416 OAKVIEW ST (RESIDENTIAL)						NO INFO
419 OAKVIEW ST (RESIDENTIAL)						NO INFO
420 OAKVIEW ST (RESIDENTIAL)						NO INFO
424 OAKVIEW ST (RESIDENTIAL)						NO INFO
425 OAKVIEW ST (RESIDENTIAL)						NO INFO
435 OAKVIEW ST (RESIDENTIAL)						NO INFO
439 OAKVIEW ST (RESIDENTIAL)						NO INFO

SEWER SERVICE INFORMATION				
ADDRESS	SIZE	PL TIE (SHORT/LONG)	JUNCTION TIE	REMARKS
382 OAKVIEW ST				NO INFO
383 OAKVIEW ST				NO INFO
400 OAKVIEW ST			99.97 W OF 2ND MH OF WATT ST	
401 OAKVIEW ST			99.36 E MH WATT ST	
404 OAKVIEW ST				NO INFO
407 OAKVIEW ST			83.52 W OF 2ND MH OFF WATT ST	
408 OAKVIEW ST				NO INFO
412 OAKVIEW ST				NO INFO
413 OAKVIEW ST				NO INFO
416 OAKVIEW ST				NO INFO
419 OAKVIEW ST				NO INFO
420 OAKVIEW ST				NO INFO
424 OAKVIEW ST			7.92 W OF 2ND MH W OF WATT ST	
425 OAKVIEW ST				NO INFO
435 OAKVIEW ST			22.56 W OF 2ND MH WEST OF WATT	
439 OAKVIEW ST			7.01 W OF 2ND MH OFF WATT	NO INFO

SEWER JUNCTION INFORMATION				
REF. MH*	DIST FROM*	SIZE*	CLOCK AT*	REF. MH
MH40006027	23.10	150	01	
MH40006027	26.10	150	09	
MH40006027	32.40	150	02	
MH40006027	41.60	150	09	
MH40006027	48.50	150	01	
MH40006027	54.90	200	10	
MH40006027	56.30	150	10	
MH40006027	70.20	150	01	
MH40006027	70.30	100	10	
MH40006027	70.50	150	11	
MH40006027	71.10	100	02	
MH40006027	74.90	150	10	
MH40006027	78.30	150	02	
MH40006027	85.70	150	02	
MH40006027	93.40	150	02	
MH40006027	98.20	100	10	
MH40006027	101.40	150	02	
MH40006027	102.20	150	10	
MH40006027	108.30	150	09	
MH40006027	112.30	150	03	
MH40006027	119.20	100	01	

*JUNCTION LOCATION FROM VIDEO INSPECTION

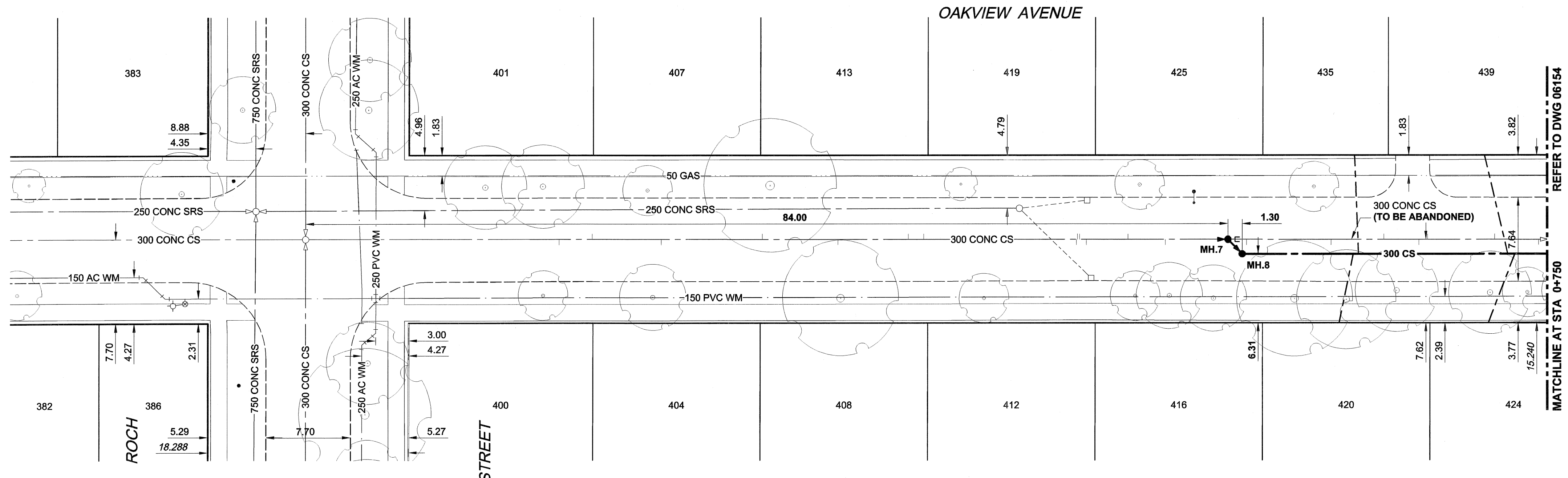

WARNING
 IF POWER EQUIPMENT OR EXPLOSIVES ARE TO BE USED FOR EXCAVATION ON THIS PROJECT, THE CONTRACTOR MUST:
 1) NOTIFY THE GAS COMPANY OF THE PROPOSED LOCATION OF EXCAVATION.
 2) TAKE PRECAUTION TO AVOID DAMAGE TO GAS COMPANY INSTALLATIONS.
 SEE PROVINCIAL REGULATION 140/92 FOR DETAILS

150 WM	WATERMAIN	150 WM	CURB STOP	150 WM	WATERMAIN	150 WM	WATERMAIN
○	HYDRANT	○	REDUCER	○	HYDRANT	○	HYDRANT
⊗	VALVE	⊗	COUPLING	⊗	VALVE	⊗	VALVE
⊙	LAND DRAINAGE SEWER	⊙	ANODE	⊙	LAND DRAINAGE SEWER	⊙	LAND DRAINAGE SEWER
⊚	WASTE WATER SEWER	⊚	HYDRO	⊚	WASTE WATER SEWER	⊚	WASTE WATER SEWER
○	MANHOLE	○	MTS	○	PAVEMENT CROWN	○	PAVEMENT CROWN
□	CATCH BASIN	□	GAS	□	N/W PROPERTY LINE	□	N/W PROPERTY LINE
△	CURB INLET	△	TESTHOLE	△	S/E PROPERTY LINE	△	S/E PROPERTY LINE
▭	CULVERT	▭	LAMP STANDARD	▭	N/W GUTTER	▭	N/W GUTTER
⊞	PIPE ABANDONMENTS	⊞	TREE	⊞	S/E GUTTER	⊞	S/E GUTTER
+	SURVEY BAR						
---	EXISTING	---	LEGEND - PLAN	---	EXISTING	---	LEGEND - PROFILE
---	NEW	---	LEGEND - PLAN	---	NEW	---	LEGEND - PROFILE

METRIC
 WHOLE NUMBERS INDICATE MILLIMETRES
 DECIMALIZED NUMBERS INDICATE METRES

LOCATION APPROVED
 UNDERGROUND STRUCTURES

NOTE: LOCATION OF UNDERGROUND STRUCTURES AS SHOWN ARE BASED ON THE BEST INFORMATION AVAILABLE, BUT NO GUARANTEE IS GIVEN THAT ALL EXISTING UTILITIES ARE SHOWN OR THAT THE GIVEN LOCATIONS ARE EXACT. CONFIRMATION OF EXISTENCE AND EXACT LOCATION OF ALL SERVICES MUST BE OBTAINED FROM THE INDIVIDUAL UTILITIES BEFORE PROCEEDING WITH CONSTRUCTION.

BM 12-057	N.W. Cor. Linden Ave. & Watt St. Tblt. on top of 0.05m dia. x 2.4m iron pipe, 1.8m S. of N.L. of Linden Ave. & on W.L. of Watt St.	ELEV 230.475m
NO.	REVISIONS	YY/MM/DD BY

DESIGNED BY	MJR	CHECKED BY	[Signature]
DRAWN BY	KMB	APPROVED BY	[Signature]
HOR. SCALE	1:250	RELEASED FOR CONSTRUCTION	[Signature]
VERT. SCALE	1:50	DATE	07/08/21

UMA AECOM
 Certificate of Authorization
 UMA Engineering Ltd. (MB)
 No. 256 Date: 07/08/21

PROFESSIONAL'S SEAL
 PROVINCE OF MANITOBA
 21 Aug. 2021
 C. C. ACEY
 REGISTERED ENGINEER

THE CITY OF WINNIPEG
 WATER AND WASTE DEPARTMENT

2007 COMBINED SEWER RENEWALS
 BY EXTERNAL POINT REPAIRS AND REPLACEMENTS
 CONTRACT 15
 OAKVIEW AVENUE
 ROCH STREET TO STA 0+750

SHEET 25 OF 29
 CITY DRAWING NUMBER
06153
 REV 0

BID OPPORTUNITY NO. 573-2007

CONSTRUCTION NOTES:
 1. INSTALL NEW SEWER BY TRENCHLESS METHODS
 2. RENEW SEWER SERVICES TO PROPERTY LINE.
 3. ALL SEWER AND WATER SERVICES TO BE LOCATED IN THE FIELD BY THE CONTRACTOR
 4. ABANDON EXISTING SEWER & SEWER SERVICES