

BREDIN DRIVE (W LEG)

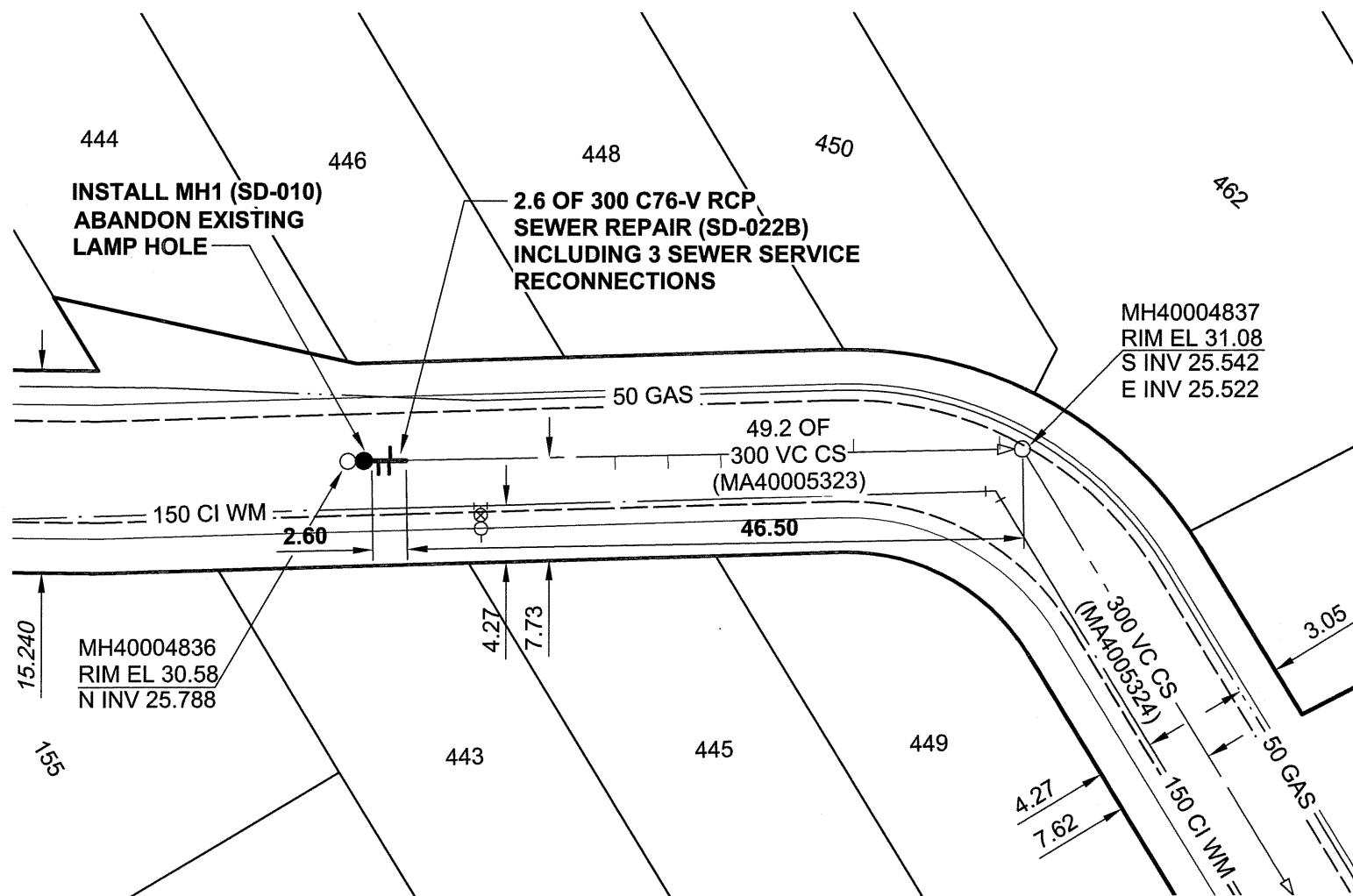
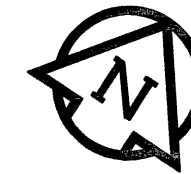

SEWER JUNCTION INFORMATION

REF. MH*	DIST FROM* REF. MH	SIZE*	CLOCK AT*
MH40004837	1.70	150Ø	01
MH40004837	12.60	150Ø	01
MH40004837	22.70	150Ø	11
MH40004837	26.70	150Ø	10
MH40004837	30.70	150Ø	02
MH40004837	47.70	150Ø	02
MH40004837	47.80	150Ø	08
MH40004837	48.60	150Ø	12

*JUNCTION INFORMATION FROM VIDEO INSPECTION

WARNING

IF POWER EQUIPMENT OR EXPLOSIVES ARE TO BE USED FOR EXCAVATION ON THIS PROJECT, THE CONTRACTOR MUST:

- 1) NOTIFY THE GAS COMPANY OF THE PROPOSED LOCATION OF EXCAVATION.
 - 2) TAKE PRECAUTION TO AVOID DAMAGE TO GAS COMPANY INSTALLATIONS.
- SEE PROVINCIAL REGULATION 140/92 FOR DETAILS

METRIC

WHOLE NUMBERS INDICATE MILLIMETRES
DECIMALIZED NUMBERS INDICATE METRES



Certificate of Authorization

UMA Engineering Ltd. (MB)

No. 256 Date: 07/08/21

CONSTRUCTION NOTES:

1. ALL SEWER AND WATER SERVICES WITHIN THE REPAIR LIMITS TO BE LOCATED IN THE FIELD BY THE CONTRACTOR

BID OPPORTUNITY NO. 573-2007

LOCATION APPROVED UNDERGROUND STRUCTURES

BM 27-026
ELEV 230.932m
N.E. Cor. Henderson Hwy. & Washington Ave.
Tbht. on top of 0.05m dia. x 2.4m iron pipe, 1.8m S.
of N.L. of Washington Ave. & on E.L. of
Henderson Hwy.

SUPR. U/G STRUCTURES DATE COMMITTEE

NOTE:
LOCATION OF UNDERGROUND STRUCTURES AS SHOWN ARE BASED ON THE BEST INFORMATION AVAILABLE. BUT NO GUARANTEE IS GIVEN THAT ALL EXISTING UTILITIES ARE SHOWN OR THAT THE GIVEN LOCATIONS ARE EXACT. CONFIRMATION OF EXISTENCE AND EXACT LOCATION OF ALL SERVICES MUST BE OBTAINED FROM THE INDIVIDUAL UTILITIES BEFORE PROCEEDING WITH CONSTRUCTION.

NO.	REVISIONS	YY/MM/DD	BY
0	ISSUED FOR CONSTRUCTION	07/08/21	KMB

UMA | AECOM

©2006 UMA ENGINEERING LTD. ALL RIGHTS RESERVED.

DESIGNED BY	MJR	CHECKED BY	A. Delaney
DRAWN BY	KMB	APPROVED BY	[Signature]
HOR. SCALE	1:500	RELEASED FOR CONSTRUCTION	[Signature]
VERT. SCALE		DATE	07/08/21

PROFESSIONAL'S SEAL

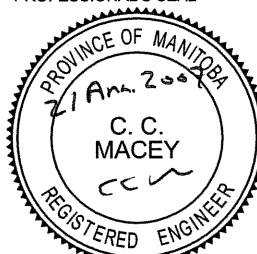

CONSULTANT DRAWING NO. 04
D265-217-03



THE CITY OF WINNIPEG WATER AND WASTE DEPARTMENT

2007 COMBINED SEWER RENEWALS BY EXTERNAL POINT REPAIRS AND REPLACEMENTS CONTRACT 15

BREDIN DRIVE (W LEG)
112m N OF BREDIN DRIVE (S LEG)
TO 43m W OF HENDERSON HIGHWAY

SHEET 4 OF 29

CITY DRAWING NUMBER

06132

REV 0