

B SIZE 11" x 17" (279mm x 432mm)

PLOT: 07/09/04 9:09:11 AM

UMA FILE NAME: D265-217-03\_01-C-1016\_RX.dwg Saved By: wdenoude

# MELBOURNE AVENUE

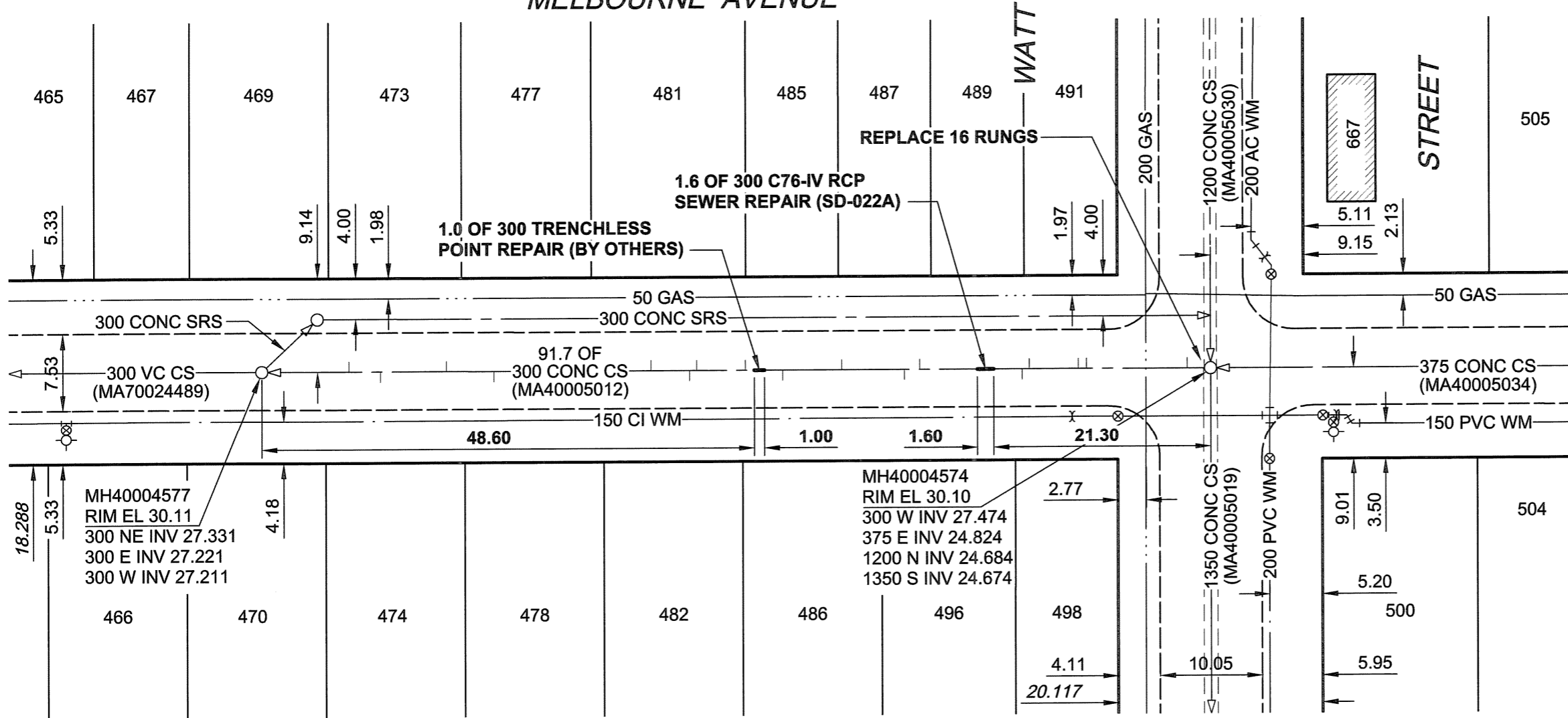

### SEWER JUNCTION INFORMATION

REF. MH*	DIST FROM* REF. MH	SIZE*	CLOCK AT*
MH40004574	2.30	150Ø	04
MH40004574	12.20	150Ø	02
MH40004574	13.00	150Ø	03
MH40004574	17.80	150Ø	03
MH40004574	18.50	150Ø	10
MH40004577	8.60	150Ø	10
MH40004577	11.70	150Ø	02
MH40004577	18.20	150Ø	09
MH40004577	22.90	150Ø	03
MH40004577	38.40	150Ø	10
MH40004577	42.20	150Ø	02
MH40004577	42.90	150Ø	10
MH40004577	47.70	150Ø	10
MH40004577	51.40	150Ø	02
MH40004577	57.20	150Ø	10
MH40004577	63.40	150Ø	02
MH40004577	64.90	150Ø	10

\*JUNCTION LOCATION FROM VIDEO INSPECTION

### WARNING

IF POWER EQUIPMENT OR EXPLOSIVES ARE TO BE USED FOR EXCAVATION ON THIS PROJECT, THE CONTRACTOR MUST:

- NOTIFY THE GAS COMPANY OF THE PROPOSED LOCATION OF EXCAVATION.
- TAKE PRECAUTION TO AVOID DAMAGE TO GAS COMPANY INSTALLATIONS. SEE PROVINCIAL REGULATION 140/92 FOR DETAILS

**METRIC**  
WHOLE NUMBERS INDICATE MILLIMETRES  
DECIMALIZED NUMBERS INDICATE METRES



Certificate of Authorization  
UMA Engineering Ltd. (MB)  
No. 256 Date: 07/09/04

### CONSTRUCTION NOTES:

- ALL SEWER AND WATER SERVICES WITHIN THE REPAIR LIMITS TO BE LOCATED IN THE FIELD BY THE CONTRACTOR

BID OPPORTUNITY NO. 573-2007

### LOCATION APPROVED UNDERGROUND STRUCTURES

SUPR. U/G STRUCTURES DATE COMMITTEE

**NOTE:**  
LOCATION OF UNDERGROUND STRUCTURES AS SHOWN ARE BASED ON THE BEST INFORMATION AVAILABLE. BUT NO GUARANTEE IS GIVEN THAT ALL EXISTING UTILITIES ARE SHOWN OR THAT THE GIVEN LOCATIONS ARE EXACT. CONFIRMATION OF EXISTENCE AND EXACT LOCATION OF ALL SERVICES MUST BE OBTAINED FROM THE INDIVIDUAL UTILITIES BEFORE PROCEEDING WITH CONSTRUCTION.

NO.	REVISIONS	YY/MM/DD	BY
1	ISSUED FOR ADDENDUM	07/08/31	WJd
0	ISSUED FOR CONSTRUCTION	07/08/21	KMB

UMA | AECOM

© 2006 UMA ENGINEERING LTD. ALL RIGHTS RESERVED.

DESIGNED BY	MJR	CHECKED BY	A. Delamio
DRAWN BY	KMB	APPROVED BY	[Signature]
HOR. SCALE	1:500	RELEASED FOR CONSTRUCTION	[Signature]
VERT. SCALE		DATE	07/09/04

PROFESSIONAL'S SEAL

CONSULTANT DRAWING NO. 16  
D265-217-03

**THE CITY OF WINNIPEG**  
**WATER AND WASTE DEPARTMENT**

**2007 COMBINED SEWER RENEWALS**  
**BY EXTERNAL POINT REPAIRS AND REPLACEMENTS**  
**CONTRACT 15**  
MELBOURNE AVENUE  
242m E OF ROCH STREET  
TO WATT STREET

SHEET 16 OF 29	REV 1
CITY DRAWING NUMBER	
<b>06144</b>	