

GENERAL NOTES:

- 1.) THESE DRAWINGS SHALL NOT BE SCALED.
- 2.) THE CONTRACTOR SHALL VISIT THE SITE AND SATISFY HIMSELF THAT ALL DIMENSIONS, DATUMS AND DETAILED INFORMATION SHOWN ARE CORRECT.
- 3.) THE CONTRACTOR IS TO REPORT ANY DISCREPANCIES PRIOR TO COMMENCEMENT OF WORK.
- 4.) THE CONTRACTOR IS TO REVIEW AND COORDINATE ARCHITECTURAL, MECHANICAL AND ELECTRICAL DRAWING INFORMATION.
- 5.) ALL OPENINGS THRU FIRE-RATED ASSEMBLIES ARE TO BE FIRESTOPPED AND SEALED WITH ULC APPROVED FIRESTOPPING TO MAINTAIN THE INTEGRITY OF THE FIRE SEPARATION, AND PROVIDE A SMOKE-TIGHT BARRIER.
- 6.) ALL PRODUCTS AND MATERIALS ARE TO BE USED AND INSTALLED IN STRICT ACCORDANCE WITH MANUFACTURER'S SPECIFICATIONS.
- 7.) THE CONTRACTOR IS RESPONSIBLE TO PATCH AND MAKE GOOD ALL EXISTING CONSTRUCTION AND FINISHES AFFECTED BY THE REMOVAL AND/OR RELOCATION OF ALL ITEMS FORMING PART OF THE DEMOLITION / RENOVATION WORK.
- 8.) DIMENSIONS ARE TAKEN TO FACE OF GYPSUM BOARD UNLESS NOTED OTHERWISE.
ALL DIMENSIONS, DATUMS, AND MATERIALS ARE IN MILLIMETERS UNLESS SHOWN OTHERWISE.

DRAWING INDEX

ARCHITECTURAL

- A.1 KEY PLAN
- A.2 GENERAL NOTES
- A.3 FLOOR PLAN
- A.4 REFLECTED CEILING PLAN
- A.5 DETAIL SHEET
- A.6 INTERIOR ELEVATION
- A.7 SIDE LITE INFILL DETAILS

MECHANICAL

MD-1 HVAC

ELECTRICAL

ED-1 DRAWING LIST, KEYPLAN AND SYMBOL LEGEND

ED-2 LIGHTING

ED-3 POWER AND SYSTEMS

ED-4 SPECIFICATION

ED-5 SPECIFICATION

ED-6 SPECIFICATION

INTERIOR PARTITION TYPES:

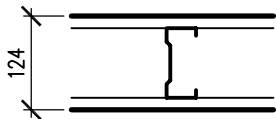

(A1)

INTERIOR PARTITION:

16 GYPSUM BOARD
92 STEEL STUD FRAMING AT 400 o.c.
16 GYPSUM BOARD

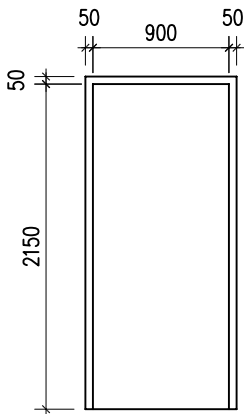

NEW DOOR D-01

900 X 2150 X 45 HOLLOW METAL - PAINT
PRESS STEEL FRAME - PAINT
3/4 HOUR U.L.C. LABEL

HARDWARE:

3 EA. HINGE	3CB1 114 X 101	652 IVE
1 EA. ENTRANCE LOCK	ND53PD RHO	626 SCHLAGE
1 EA. CLOSER	4011	689 LCN
1 EA. KICKPLATE	8400 12" X WIDTH TO SUIT	630 IVE
1 EA. DOMESTOP	FS436/FS438	626 IVE

RENOVATION NOTES.

1. PATCH AND MAKE GOOD GYPSUM BOARD, CARPET TILE, RUBBER BASE AND ACOUSTIC TILE CEILINGS TO MATCH EXISTING. REFER TO MECHANICAL AND ELECTRICAL FOR ADDITIONAL PATCHING.
2. PATCH AND MAKE GOOD ABANDONED OR REDUNDANT HOLES IN FLOOR SLAB WITH CONCRETE INFILL TO MATCH EXISTING CONSTRUCTION.
3. REFINISH EXISTING RELOCATED WOOD FRAMES TO MATCH EXISTING.
4. AT NEW GYPSUM BOARD PROVIDE NEW RUBBER BASE BOTH SIDES TO MATCH EXISTING.
5. NEW GYPSUM BOARD WALL TO BE PAINTED TO MATCH EXISTING.
6. WHERE NEW GYPSUM BOARD CONSTRUCTION AFFECTS EXISTING PAINTED GYPSUM BOARD FINISH, THE ENTIRE WALL IS TO BE REPAINTED TO NEAREST CORNER TO ACHIEVE A CONSISTENT APPEARANCE. PATCHWORK FINISH WILL NOT BE ACCEPTED.
6. AT EXTERIOR OFFICES WHERE THE ACOUSTIC TILE CEILING GRID IS TO BE EXTENDED OR DISMANTLED AND REINSTALLED, ACOUSTIC PANELS AND CROSS TEE'S ARE TO BE SALVAGED AND RE-USED. PROVIDE NEW MAIN TEE'S AND PERIMETER ANGLE. PATCHWORK OF THE CEILING GRID IS NOT ACCEPTABLE. MAKE ALLOWANCE FOR ADDITIONAL ACOUSTIC TILE PANELS FOR COMPLETE FINISH CEILING. ADJUST EXISTING DIFFUSERS AND FIXTURE LOCATIONS TO SUIT REFER TO MECHANICAL AND ELECTRICAL DRAWINGS.



Friesen Tokar Architects + Landscape + Interior Designers

200 - 2033 Portage Avenue Winnipeg, Canada R3J 0K8 tel. 204.885.9323 fax. 204.837.7235

DRAWN BY D.G.	PROJECT TITLE CITY OF WINNIPEG INTERIOR RENOVATIONS WASTEWATER SERVICES AREA 1199 PACIFIC AVE. WPG, MB	DRAWING A.2
DATE JAN. 2007	BID OPPORTUNITY NO. 56-2007	
PROJECT NO. 06.988		