



THE CITY OF WINNIPEG

WATER AND WASTE DEPARTMENT
ENGINEERING DIVISION

2007 SEWER RENEWALS BY CIPP LINING

CONTRACT 21

BID OPPORTUNITY NO. 529-2007

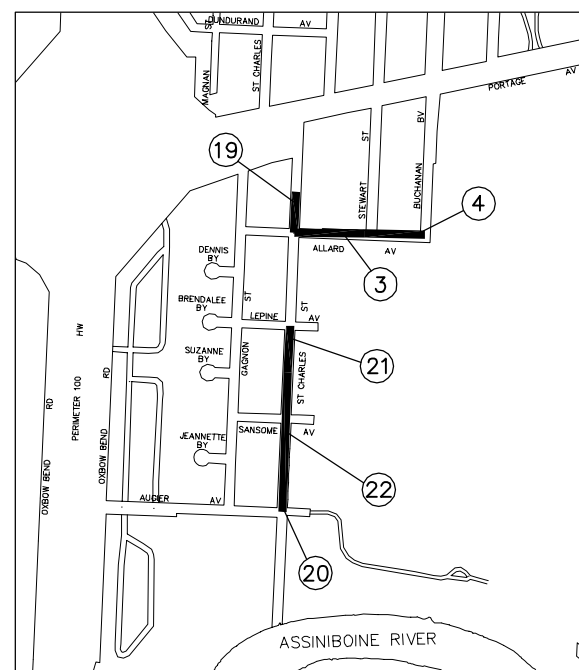
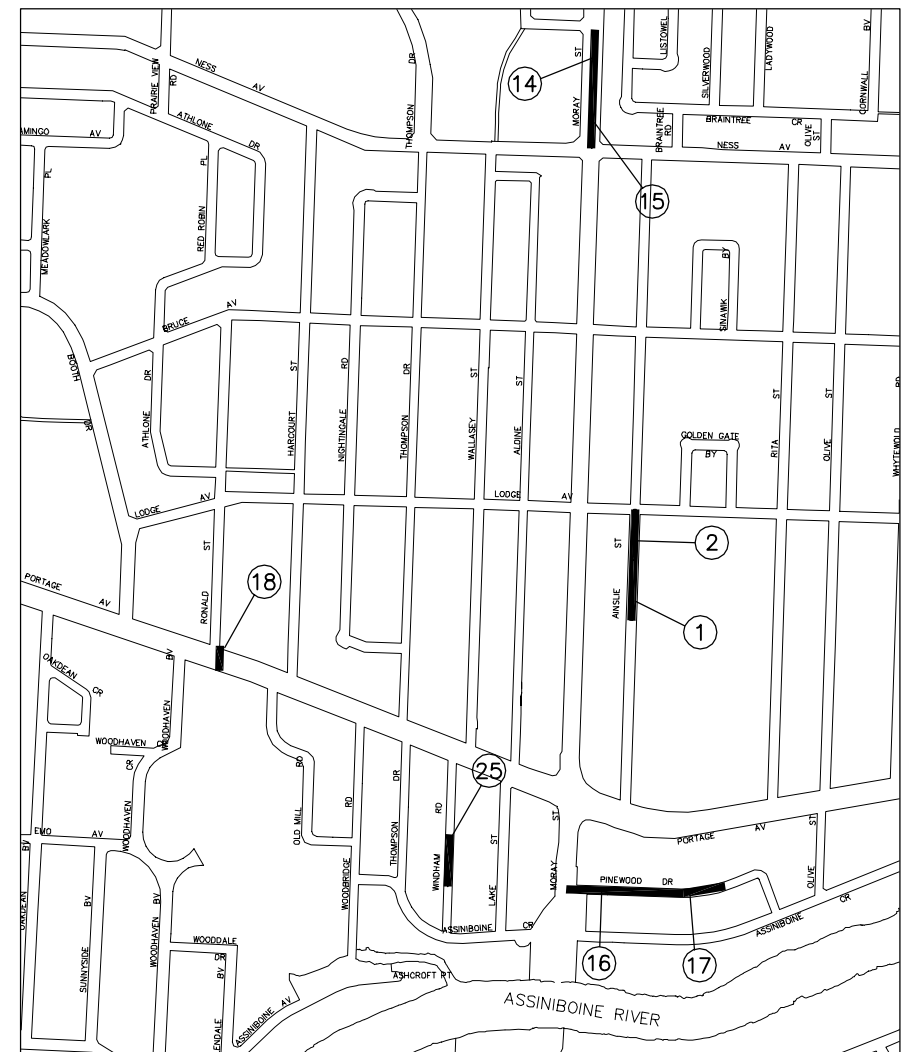
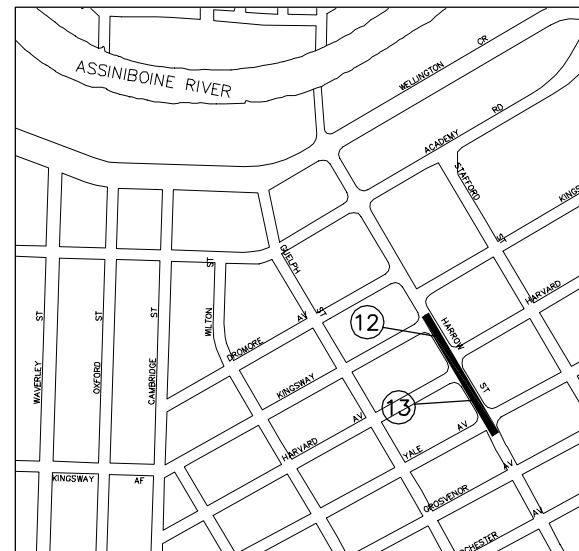
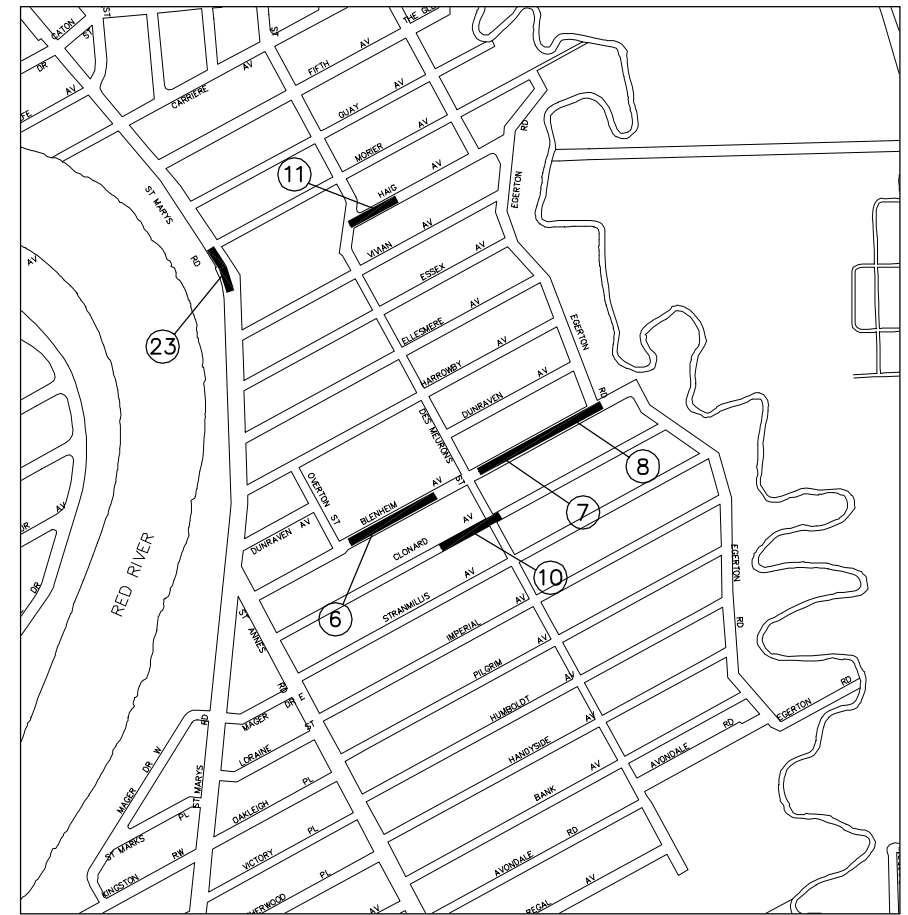

- ① 06103 AINSLIE STREET – 1ST MH S OF LODGE AVENUE TO 2ND MH S OF LODGE AVENUE
- ② 06104 AINSLIE STREET – MH AT LODGE AVENUE TO 1ST MH S OF LODGE AVENUE
- ③ 06105 ALLARD AVENUE – MH AT STEWART STREET TO MH AT ST CHARLES STREET
- ④ 06106 ALLARD AVENUE – MH AT BUCHANAN BOULEVARD TO MH AT STEWART STREET
- ⑤ 06107 ARNOLD AVENUE – 1ST MH E OF DALY STREET S TO 3RD MH E OF DALY STREET S
- ⑥ 06108 BLENHEIM AVENUE – 2ND MH W OF DES MEURONS STREET TO 1ST MH E OF OVERTON STREET
- ⑦ 06109 BLENHEIM AVENUE – 1ST MH W OF EGERTON ROAD TO 1ST MH E OF DES MEURONS STREET
- ⑧ 06110 BLENHEIM AVENUE – MH AT E ½ EGERTON ROAD TO 1ST MH W OF EGERTON ROAD
- ⑨ 06111 CLARE AVENUE – MH AT E ½ OSBORNE STREET TO 1ST MH E OF E ½ OSBORNE STREET
- ⑩ 06112 CLONARD AVENUE – 1ST MH E OF DES MEURONS STREET TO 1ST MH W OF DES MEURONS STREET
- ⑪ 06113 HAIG AVENUE – 1ST MH E OF DES MEURONS STREET TO MH AT DES MEURONS STREET
- ⑫ 06114 HARROW STREET – MH AT KINGSWAY TO MH AT HARVARD AVENUE
- ⑬ 06115 HARROW STREET – MH AT HARVARD AVENUE TO MH AT YALE AVENUE
- ⑭ 06116 MORAY STREET – MH AT STRAUSS DRIVE TO 1ST MH S OF STRAUSS DRIVE
- ⑮ 06117 MORAY STREET – 1ST MH S OF STRAUSS DRIVE TO MH AT NESS AVENUE
- ⑯ 06118 PINWOOD DRIVE – MH AT MORAY STREET TO 1ST MH E OF MORAY STREET
- ⑰ 06119 PINWOOD DRIVE – 1ST MH E OF MORAY STREET TO 3RD MH E OF MORAY STREET
- ⑱ 06120 RONALD STREET – MH AT S ½ PORTAGE AVENUE TO MH AT N ½ PORTAGE AVENUE
- ⑲ 06121 ST CHARLES STREET – 1ST MH N OF ALLARD AVENUE TO MH AT ALLARD AVENUE
- ⑳ 06122 ST CHARLES STREET – MH AT AUGIER AVENUE TO 1ST MH S OF SANSOME AVENUE
- ㉑ 06123 ST CHARLES STREET – 1ST MH S OF SANSOME AVENUE TO 1ST MH N OF SANSOME AVENUE
- ㉒ 06124 ST CHARLES STREET – MH AT LEPINE AVENUE TO 1ST MH N OF SANSOME AVENUE
- ㉓ 06125 ST MARYS ROAD – MH AT MORIER AVENUE TO 1ST MH S OF MORIER AVENUE
- ㉔ 06126 WALKER AVENUE – 1ST MH E OF DALY STREET S TO 2ND MH E OF DALY STREET S
- ㉕ 06127 WINDHAM ROAD – 2ND MH N OF ASSINIBOINE CRESCENT TO 1ST MH N OF ASSINIBOINE CRESCENT