

SEWER JUNCTION INFORMATION FROM SEWER VIDEO INSPECTION SEWER ID S-MA50013171

DISTANCE FROM MH ID S-MH50010588			
8.1	W	150#	SOUTH JN
8.1	W	150#	NORTH JN
20.2	W	150#	SOUTH JN
21.1	W	150#	NORTH JN
32.2	W	150#	SOUTH JN
34.0	W	150#	NORTH JN
46.9	W	150#	SOUTH JN
47.8	W	150#	NORTH JN
56.0	W	150#	SOUTH JN
62.4	W	150#	NORTH JN
69.8	W	150#	SOUTH JN
81.8	W	150#	NORTH JN
85.3	W	150#	SOUTH JN
96.4	W	150#	NORTH JN
101.1	W	150#	SOUTH JN
111.3	W	150#	NORTH JN
118.6	W	150#	SOUTH JN

NOTE: CHAINAGES SHOWN ARE ALONG S. R. OF CLONARD AVE.

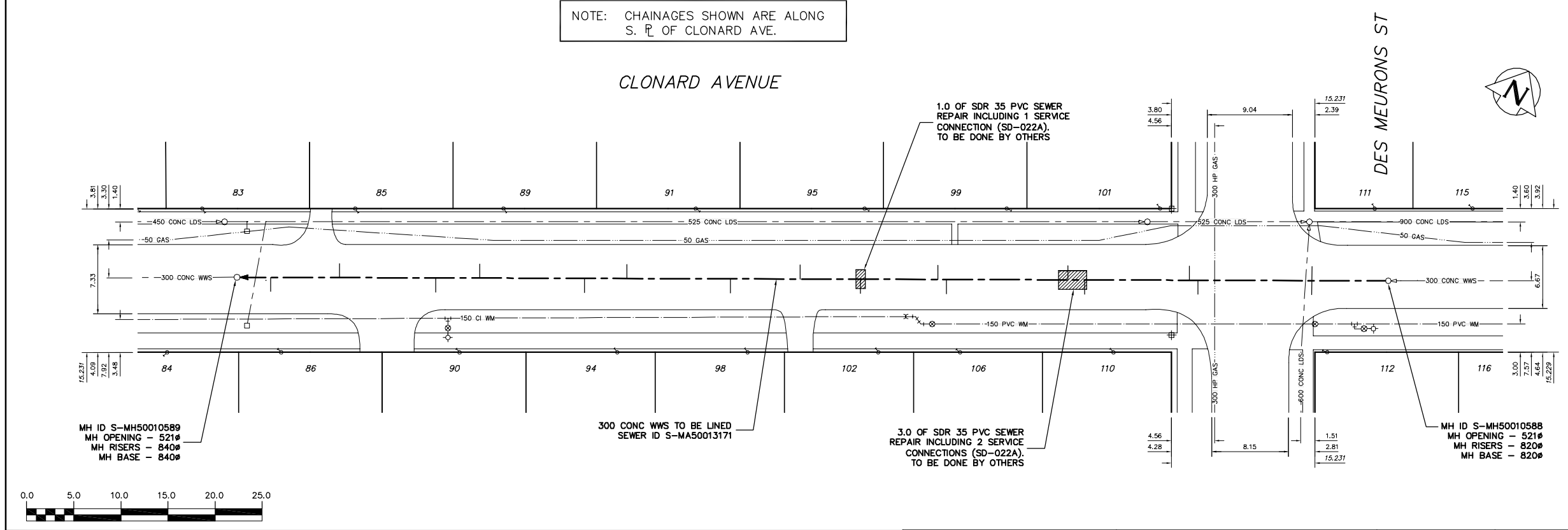

SEWER SERVICE INFORMATION

ADDRESS	SIZE	R. DIST	JUNCTION TIE
85 CLONARD AVE			NO INFORMATION AVAILABLE
86 CLONARD AVE			NO INFORMATION AVAILABLE
89 CLONARD AVE			NO INFORMATION AVAILABLE
90 CLONARD AVE			NO INFORMATION AVAILABLE
91 CLONARD AVE			NO INFORMATION AVAILABLE
94 CLONARD AVE			NO INFORMATION AVAILABLE
99 CLONARD AVE			NO INFORMATION AVAILABLE
98 CLONARD AVE			NO INFORMATION AVAILABLE
99 CLONARD AVE			NO INFORMATION AVAILABLE
101 CLONARD AVE			NO INFORMATION AVAILABLE
102 CLONARD AVE			NO INFORMATION AVAILABLE
106 CLONARD AVE			NO INFORMATION AVAILABLE
110 CLONARD AVE			NO INFORMATION AVAILABLE
111 CLONARD AVE			NO INFORMATION AVAILABLE
112 CLONARD AVE			NO INFORMATION AVAILABLE

METRIC  
WHOLE NUMBERS INDICATE MILLIMETRES  
DECIMALIZED NUMBERS INDICATE METRES

**WARNING**  
IF POWER EQUIPMENT OR EXPLOSIVES ARE TO BE USED FOR EXCAVATION ON THIS PROJECT THE CONTRACTOR MUST:  
1) NOTIFY THE GAS COMPANY OF THE PROPOSED LOCATION OF EXCAVATION.  
2) TAKE PRECAUTION TO AVOID DAMAGE TO GAS COMPANY INSTALLATIONS.  
SEE PROVINCIAL REGULATION 210/72 FOR DETAILS

200 WM	WATERMAIN	200 WM	SL, HYDRO	150 WM	WATERMAIN	150 WM
⊕	HYDRANT	⊕	MTS	+	HYDRANT	+
⊙	VALVE	⊙	TRAFFIC SIGNALS	⊙	VALVE	⊙
525 LDS	LAND DRAINAGE SEWER	525 LDS	GAS	50 GAS	300 LDS	LAND DRAINAGE SEWER
375 WWS	WASTEWATER SEWER	375 WWS	SURVEY BAR	250 WWS	300 LDS	WASTEWATER SEWER
○	MANHOLE	●	FENCE	⊕	⊕	PROFILE
□	CATCH BASIN	■	POLE - HYDRO, MTS	⊕	⊕	GROUND ABOVE PIPE
▽	CURB INLET	▽	CURB STOP	⊕	⊕	
⊕	JUNCTIONS	⊕	GUY ANCHOR	⊕	⊕	
⊕	CULVERT	⊕	LIGHT STANDARD	⊕	⊕	
⊕	ANODE	⊕	TREE	⊕	⊕	
EXISTING	LEGEND-PLAN	PROPOSED	EXISTING	LEGEND-PLAN	PROPOSED	EXISTING
				LEGEND-PROFILE	PROPOSED	

LOCATION APPROVED UNDERGROUND STRUCTURES

SUPV. U/G STRUCTURES COMMITTEE DATE

NOTE:  
LOCATION OF UNDERGROUND STRUCTURES AS SHOWN ARE BASED ON THE BEST INFORMATION AVAILABLE BUT NO GUARANTEE IS GIVEN THAT ALL EXISTING UTILITIES ARE SHOWN OR THAT THE GIVEN LOCATIONS ARE EXACT. CONFIRMATION OF EXISTENCE AND EXACT LOCATION OF ALL SERVICES MUST BE OBTAINED FROM THE INDIVIDUAL UTILITIES BEFORE PROCEEDING WITH CONSTRUCTION.

CITY OF WINNIPEG WATER AND WASTE ENGINEERING DIVISION

DESIGNED BY: SC  
CHECKED BY: TW  
DRAWN BY: CJH  
APPROVED BY: KZ  
HOR. SCALE: 1:250  
VERTICAL: 1:50  
RELEASED FOR CONSTRUCTION

ENGINEER'S SEAL  
ORIGINAL SIGNED BY: S.R.J. COURNOYER  
DATE: 07/07/23

NO. REVISIONS DATE BY

THE CITY OF WINNIPEG WATER AND WASTE DEPARTMENT

2007 SEWER RENEWALS BY CIPP LINING CONTRACT 21  
CLONARD AVENUE  
1ST MH E OF DES MEURONS STREET TO 1ST MH W OF DES MEURONS STREET

SHEET 10 OF 25  
CITY DRAWING NUMBER: 06112

FILENAME: 06112.dwg  
PLOT DATE: 2007 07 19