

TOPSOIL TEST PIT LEGEND:

- 1 TEST PIT EXCAVATED TO 350 mm DEPTH AND CONSISTED OF CONSISTENT MIX OF CLAY AND GRAVEL INDICATING DISTURBED SOIL.
- 2 TEST PIT EXCAVATED TO 250 mm DEPTH AND CONSISTED OF CONSISTENT MIX OF CLAY AND GRAVEL INDICATING DISTURBED SOIL.
- 3 TEST PIT EXCAVATED TO 300 mm DEPTH AND CONSISTED OF 175 mm DEPTH OF TOPSOIL OVER CLAY SUB GRADE.
- 4 TEST PIT EXCAVATED TO 300 mm DEPTH AND CONSISTED OF 175 mm DEPTH OF TOPSOIL OVER CLAY SUB GRADE.
- 5 TEST PIT EXCAVATED TO 250 mm DEPTH AND CONSISTED OF 125 mm DEPTH OF TOPSOIL OVER CLAY SUB GRADE.
- 6 TEST PIT EXCAVATED TO 550 mm DEPTH AND CONSISTED OF 400 mm DEPTH OF TOPSOIL OVER CLAY SUB GRADE.

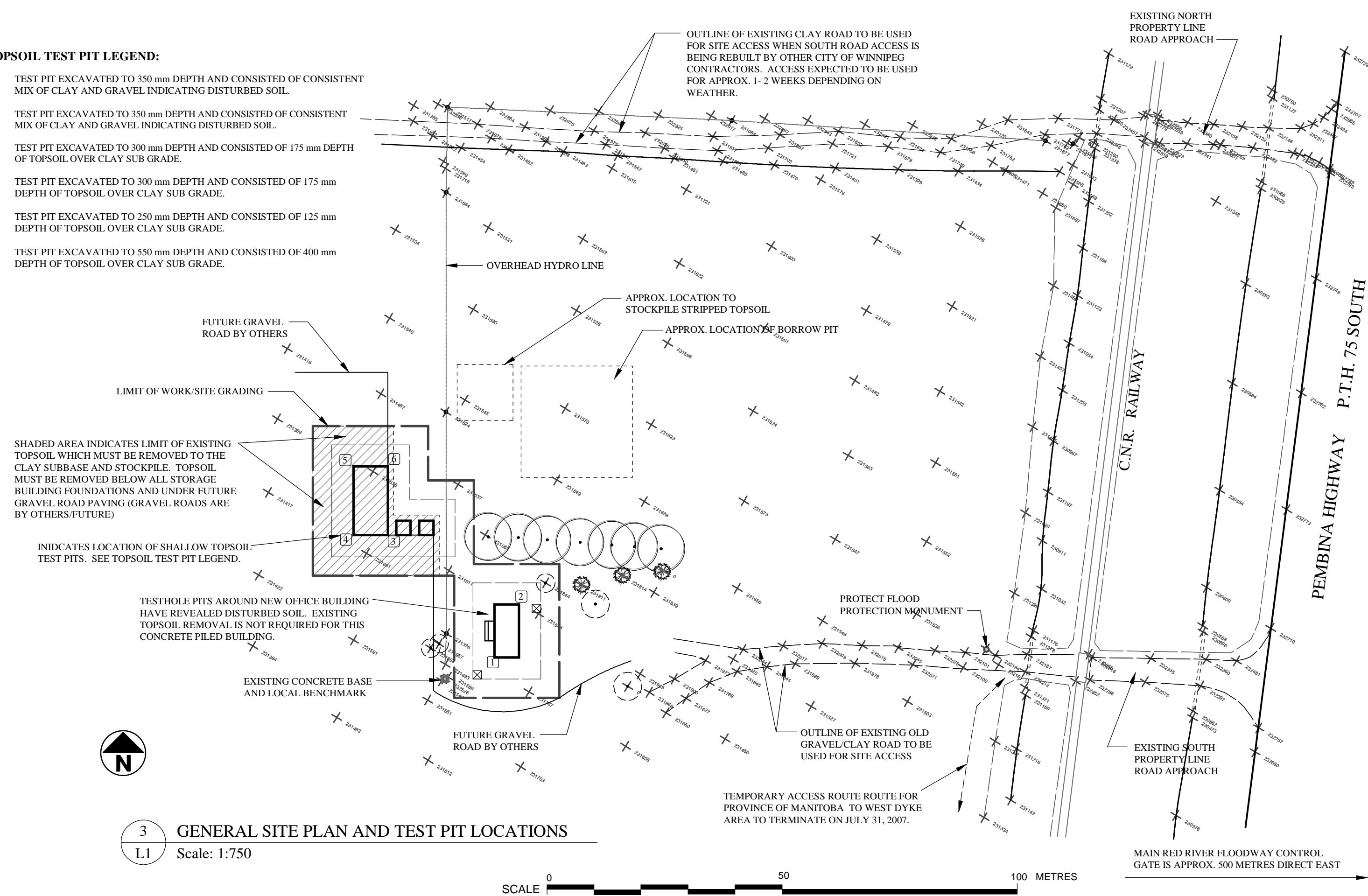

3 GENERAL SITE PLAN AND TEST PIT LOCATIONS
L1 Scale: 1:750

1 BUILDING AND CONSTRUCTION LIMIT PLAN
L1 Scale: 1:500

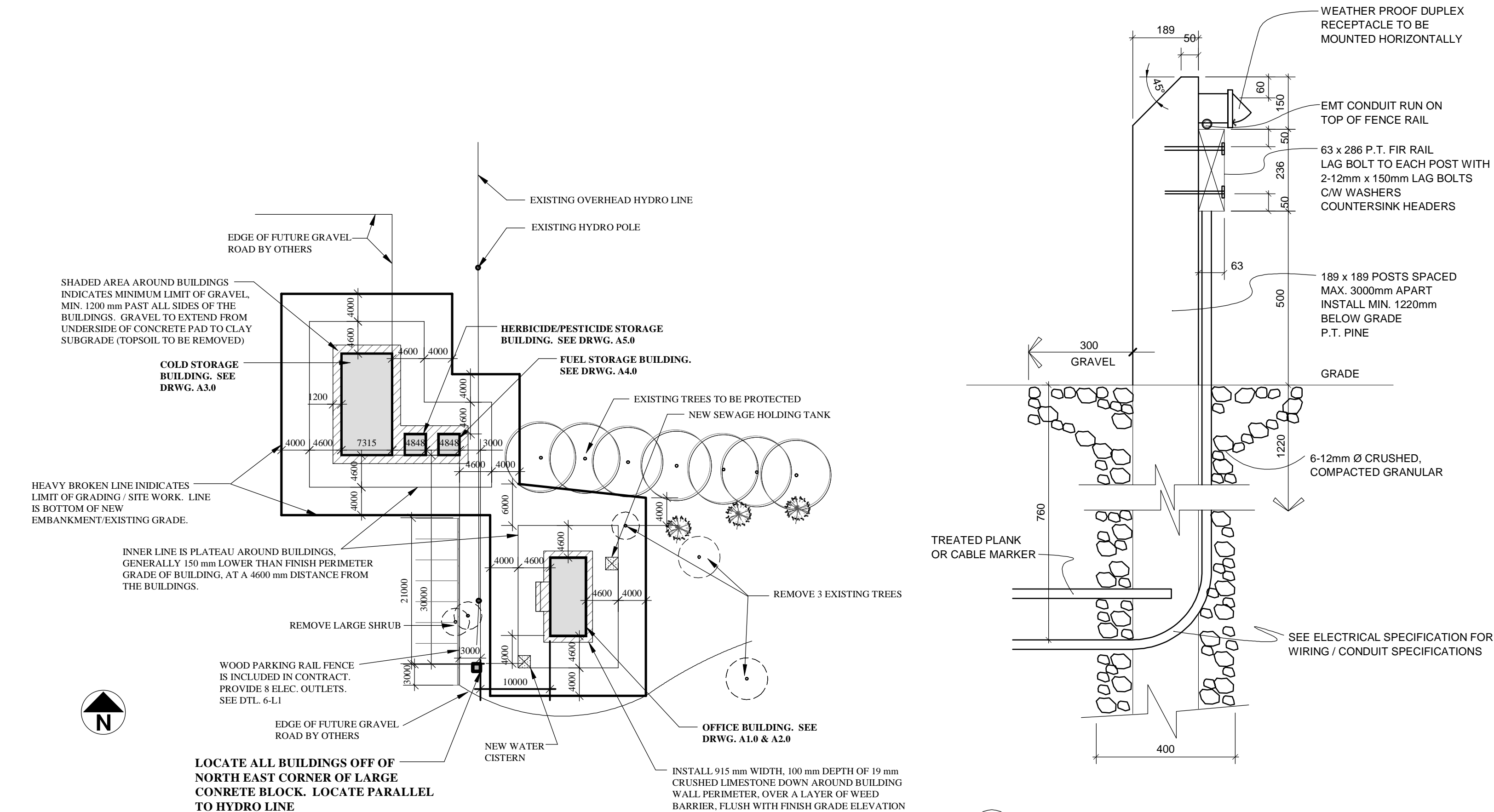

6 WOOD PARKING RAIL FENCE
L1 Scale: 1:10

GRADING NOTES:

1. EXISTING GRADE ELEVATIONS ARE BASED ON BARNES & DUNCAN SURVEY UNDERTAKEN IN APRIL OF 2007. LOCAL BENCH MARK IS TOP OF OLD CBC TOWER CONCRETE FOOTING, TOP OF IRON BOLT ON TOP OF CONCRETE FOOTING, ELEV. 232.526 METRES GEODETIC.
2. THESE BUILDINGS ARE BEING BUILT IN A DESIGNATED FLOODWAY FRINGE AREA AND THUS ALL NEW GRADE ELEVATIONS, AND DISTANCES ARE CONTROLLED BY THE PROVINCE OF MANITOBA REGULATIONS AND MUST BE MET. THE FLOOD PROTECTION LEVEL FOR THE OFFICE BUILDING IS 232.77 METRES. THE STORAGE BUILDING FLOOD PROTECTION LEVEL IS 300 mm LOWER.
3. ALL FINISH GRADES SHOWN ARE TO TOP OF GRAVEL OR SOD. THE CONTRACTOR IS TO INSTALL ALL COMPACTED CLAY TO 100 mm BELOW FINISHED GRADES. WHERE GRAVEL PAVING IS SHOWN THE GRAVEL SHALL BE INSTALLED TO THE FINISHED GRADE ELEVATIONS SHOWN. INSTALLATION OF THE TOP 100 mm TOPSOIL AND SOD IS NOT INCLUDED IN THIS CONTRACT AND IS FUTURE WORK. ROUGH GRADES SHALL BE GRADED SMOOTH.
4. THE STORAGE BUILDINGS REQUIRE GRAVEL PADS INSTALLED BELOW THE BUILDING AND TO EXTEND A MINIMUM 1200 mm PAST ALL OUTSIDE WALLS. THIS GRAVEL IS TO EXTEND DOWN TO THE CLAY SUB GRADE. THE CONTRACTOR WILL HAVE TO REMOVE ALL TOPSOIL BELOW THE NEW GRAVEL BUILDING SUPPORT BASES, AS WELL AS AREAS WHICH WILL BE LOCATED BELOW FUTURE GRAVEL ROADWAYS LOCATED WITHIN THE LIMITS OF THE CONTRACTORS WORK.

- LEGEND:
- 231.04 EXISTING GRADE ELEVATION
 - 232.47 NEW FINISHED GRADE ELEVATION
 - 4:1 DIRECTION OF DRAINAGE, HORIZ. TO VERTICAL RUN

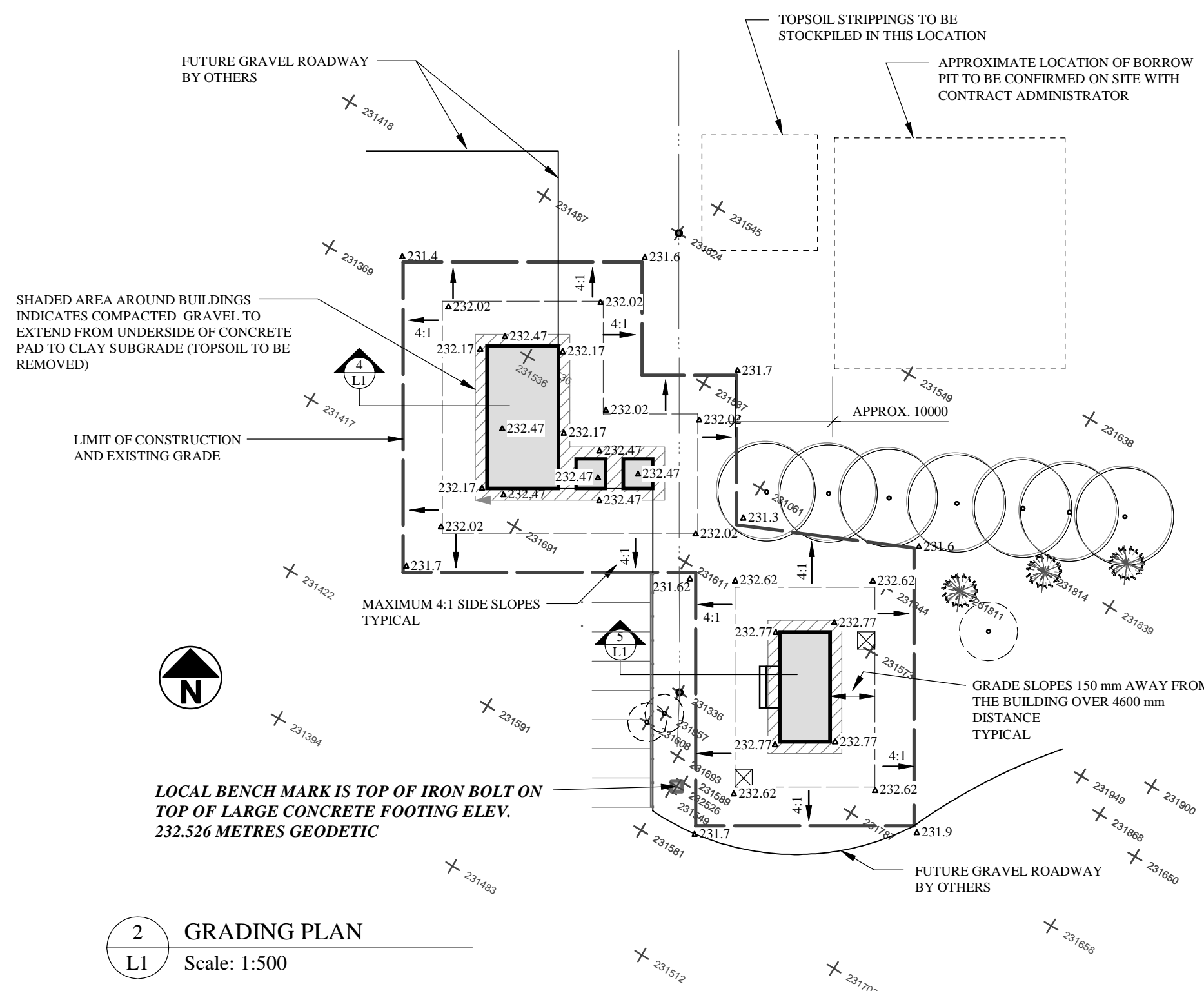

2 GRADING PLAN
L1 Scale: 1:500

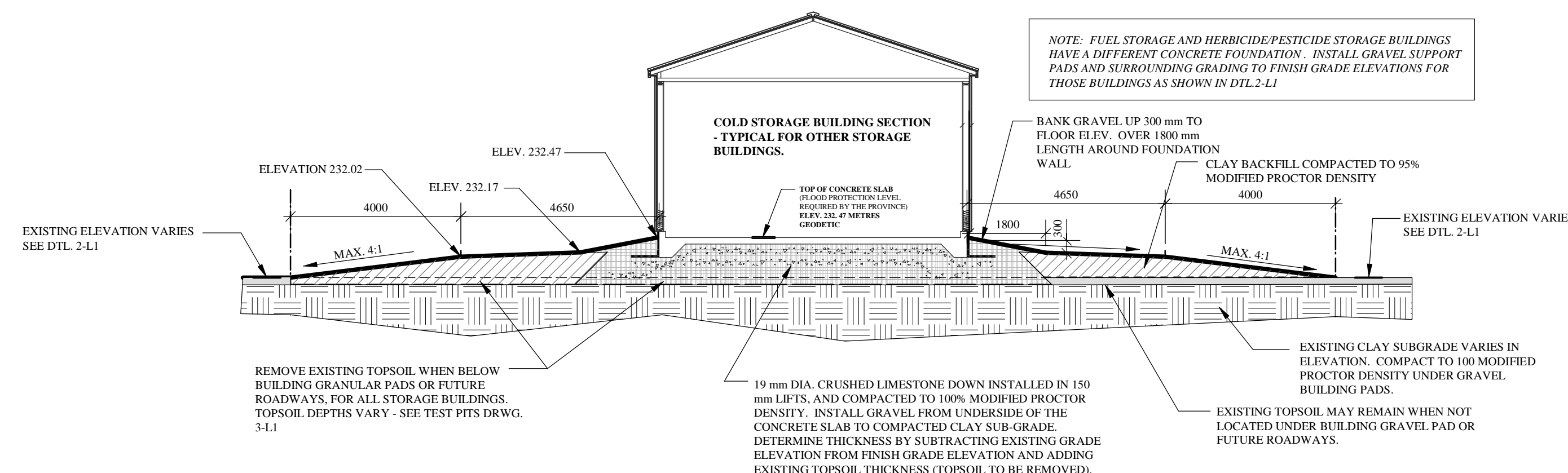

4 COLD STORAGE BUILDING EAST/WEST SECTION
L1 Scale: 1:100

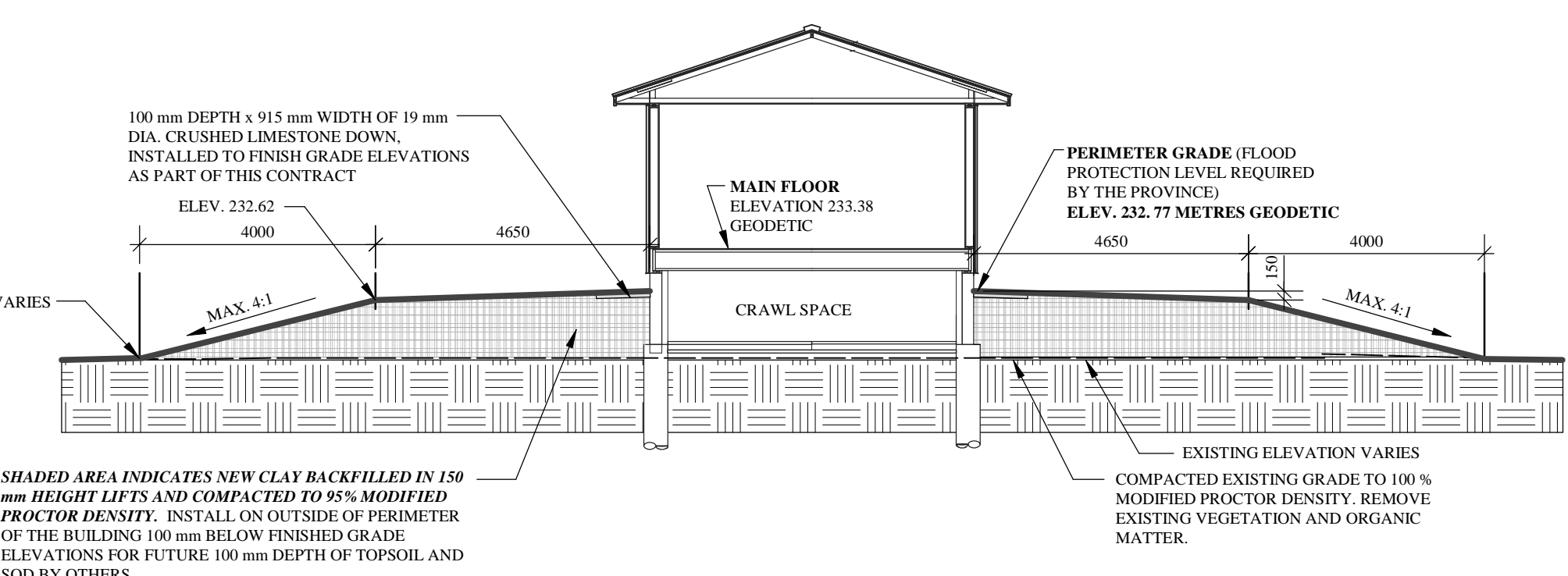

5 OFFICE BUILDING EASTWEST SECTION
L1 Scale: 1:100

NO.	REVISIONS	BY	DATE

KEN RECH LANDSCAPE ARCHITECTS INC.
1480 Wellington Crescent Winnipeg Manitoba
Fax 489-6852 R3N 0B3 Tel(204) 489-6616

PROJECT TITLE
CITY OF WINNIPEG TREE NURSERY
ST. NORBERT, MANITOBA

DRAWING TITLE
SITE PLANS & SECTIONS

DRAWN BY	SCALE	SHEET NO.
K. RECH	AS NOTED	L1
PRINT DATE	DATE	
JUNE 20/07	JUNE 20/07	
FILE NO.	REVISION	
04-06	0	

