

NOTE: CHAINAGES SHOWN ARE ALONG NORTH PL KENWOOD PL.

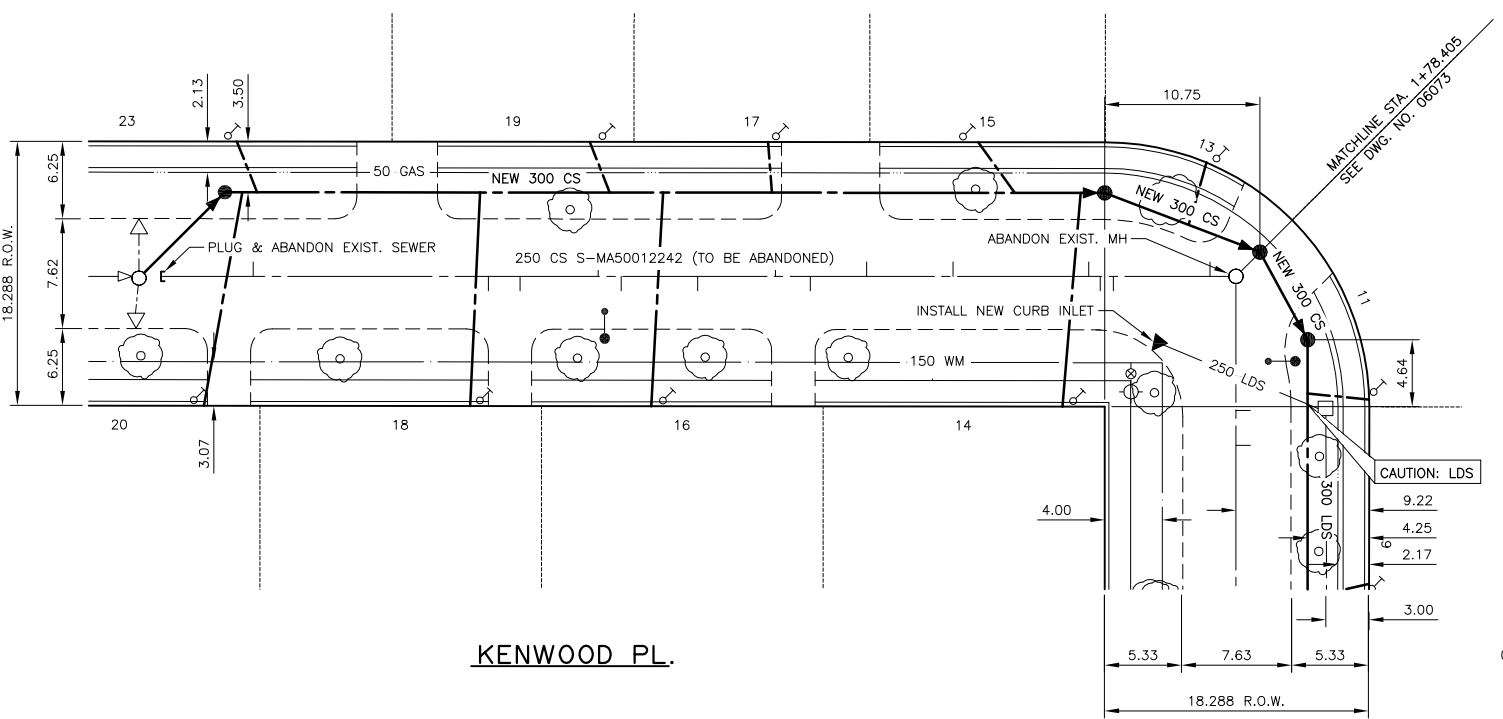

CONSTRUCTION NOTES:

1. ALL PVC PIPE SHALL HAVE CLASS B-TYPE 2 BEDDING AND ALL CONCRETE PIPE SHALL HAVE CLASS B-SAND BEDDING.
2. SEWER TO BE RENEWED BY TRENCHLESS METHODS.
3. CONFIRM THE LOCATION OF ALL SEWER SERVICES.
4. RENEW SEWER SERVICES TO PROPERTY LINE.
5. BACKFILL UNDER PAVEMENT, IN SIDEWALKS, & WITHIN 1.0 OF PAVEMENT TO BE CLASS 3.
6. BACKFILL IN BOULEVARD TO BE CLASS 5.
7. CATCHBASIN LEADS TO BE INSTALLED AT MIN. 1.0% SLOPE OR AS DIRECTED BY CONTRACT ADMINISTRATOR.
8. EXCAVATIONS TO BE LOCATED AWAY FROM EXISTING TREES

SEWER SERVICE INFORMATION (S-MA50012242) *	
DISTANCE FROM 1ST MH W OF EGERTON RD (S-MH50009838)	
5.6 E	SERVICE CONNECTION S
7.9 E	SERVICE CONNECTION N
24.2 E	SERVICE CONNECTION S
31.8 E	SERVICE CONNECTION N
38.7 E	SERVICE CONNECTION S
44.1 E	SERVICE CONNECTION N
56.4 E	SERVICE CONNECTION N
67.5 E	SERVICE CONNECTION S
74.2 E	SERVICE CONNECTION N

* - INFORMATION FROM SEWER VIDEO INSPECTION

EXISTING SEWER SERVICE LOCATION RECORDS		
ADDRESS	SIZE/TYPE	SERVICE LOCATION AT PL
NO RECORDS	INFO NOT AVAILABLE	INFO NOT AVAILABLE

* LOCATION OF SEWER SERVICE AT PL IS ASSUMED

WARNING

IF POWER EQUIPMENT OR EXPLOSIVES ARE TO BE USED FOR EXCAVATION ON THIS PROJECT THE CONTRACTOR MUST:

1. NOTIFY THE GAS COMPANY OF THE PROPOSED LOCATION OF EXCAVATION.
2. TAKE PRECAUTION TO AVOID DAMAGE TO GAS COMPANY INSTALLATIONS
SEE PROVINCIAL REGULATION 210/72 FOR DETAILS

METRIC

WHOLE NUMBERS INDICATE MILLIMETRES
DECIMALIZED NUMBERS INDICATE METRES

150 mm W.M.	150 mm W.M.	150 mm W.M.	150 mm W.M.	150 mm W.M.	150 mm W.M.	150 mm W.M.	150 mm W.M.
○	HYDRANT	○	HYDRANT	○	HYDRANT	○	HYDRANT
⊗	VALVE	⊗	VALVE	⊗	VALVE	⊗	VALVE
⊗	LAND DRAINAGE SEWER	⊗	LAND DRAINAGE SEWER	⊗	LAND DRAINAGE SEWER	⊗	LAND DRAINAGE SEWER
⊗	WASTE WATER SEWER	⊗	WASTE WATER SEWER	⊗	WASTE WATER SEWER	⊗	WASTE WATER SEWER
○	MANHOLE	○	MANHOLE	○	MANHOLE	○	MANHOLE
□	CATCH BASIN	□	CATCH BASIN	□	CATCH BASIN	□	CATCH BASIN
▽	CURB INLET	▽	CURB INLET	▽	CURB INLET	▽	CURB INLET
⊕	JUNCTIONS	⊕	JUNCTIONS	⊕	JUNCTIONS	⊕	JUNCTIONS
⊕	CULVERT	⊕	CULVERT	⊕	CULVERT	⊕	CULVERT
⊕	GAS	⊕	GAS	⊕	GAS	⊕	GAS
---	EXISTING	---	EXISTING	---	EXISTING	---	EXISTING
---	LEGEND-PLAN	---	LEGEND-PLAN	---	LEGEND-PLAN	---	LEGEND-PLAN
---	PROPOSED	---	PROPOSED	---	PROPOSED	---	PROPOSED
---	EXISTING	---	EXISTING	---	EXISTING	---	EXISTING
---	LEGEND-PROFILE	---	LEGEND-PROFILE	---	LEGEND-PROFILE	---	LEGEND-PROFILE
---	PROPOSED	---	PROPOSED	---	PROPOSED	---	PROPOSED

UNDERGROUND STRUCTURES		B.M. ELEV.
SUPV. U/G STRUCTURES COMMITTEE	DATE	
NOTE: LOCATION OF UNDERGROUND STRUCTURES AS SHOWN ARE BASED ON THE BEST INFORMATION AVAILABLE, BUT NO GUARANTEE IS GIVEN THAT ALL EXISTING UTILITIES ARE SHOWN OR THAT THE GIVEN LOCATIONS ARE EXACT. CONFIRMATION OF EXISTENCE AND EXACT LOCATION OF ALL SERVICES MUST BE OBTAINED FROM THE INDIVIDUAL UTILITIES BEFORE PROCEEDING WITH CONSTRUCTION.		
1	ISSUED FOR TENDER	06/28/07
NO. REVISIONS	DATE	BY

DESIGNED BY	CLP
DRAWN BY	SKB
CHECKED BY	SCC
APPROVED BY	
HOR. SCALE	1 : 250
VERTICAL	1 : 50
DATE	JULY 9, 2007

DILLON CONSULTING

**THE CITY OF WINNIPEG
WATER AND WASTE DEPARTMENT**

2007 SEWER RENEWALS
KENWOOD PLACE
1ST MH W OF KENWOOD PL. (E LEG) TO
MH AT KENWOOD PL. (E LEG)

CITY DRAWING NUMBER
06072

SHEET **4** OF **13**

BID OPPORTUNITY
422-2007

CONSULTANT PROJECT NO.
07-7471-1000