

UMA FILE NAME: 0265-397-00\_01-S-0705\_RX.dwg Saved By: ccrossma

PLOT: 07/05/10 12:05:12 PM

UMA FILE NAME: 0265-397-00\_01-S-0705\_RX.dwg Saved By: ccrossma

MARKS	NO BARS	SIZE	LENGTH	TYPE	A	B	C	D	E	F	G	H	J	K	L	M	O	R	SHAPE	MASS (kg)
<b>WEST ABUTMENT</b>																				
A1501X	4	15	12190	STR																76.55
A1502X	4	15	7350	STR																46.15
A1503X	12	15	1405	17		350	285	885												26.47
A1504X	12	15	840	17		570	270													15.83
A1505X	12	15	1200	X3	600	420	180													22.61
A1506X	11	15	1470	17		350	285	835												25.38
A1507X	11	15	790	17		520	270													13.64
A1508X	11	15	1150	X3	600	370	180													19.86
A1509X	11	15	1420	17		350	285	785												24.52
A1510X	11	15	740	17		470	270													12.78
A1511X	11	15	1100	X3	600	320	180													19.00
A1512X	11	15	1370	17		350	285	735												23.66
A1513X	11	15	690	17		420	270													11.92
A1514X	11	15	1050	X3	600	270	180													18.13
A1515X	4	15	4300	X8	460	1440	285					225	250							27.0
A1516X	8	15	1370	STR																17.21
A2001X	1	20	3055	X9	670	1625	760						1070	1222						7.19
A2002X	4	20	2410	X9	300	1440	670						960	1070						22.7
A2003X	1	20	2300	X9	300	1440	560						960	1070						5.42
A1517X	3	15	2675	STR																12.60
A1518X	1	15	2480	STR																3.80
A1519X	1	15	1925	STR																3.02
A1520X	1	15	1430	STR																2.25
A1521X	1	15	940	STR																1.448
A1522X	1	15	2365	16		1815	550					550		11						3.71
A1523X	1	15	2340	16		1790	550					550		11						3.67
A1524X	1	15	2180	16		1630	550					550		11						3.42
A1525X	1	15	2020	16		1470	550					550		11						3.17
A1526X	1	15	1855	16		1305	550					550		11						2.91
A1527X	1	15	1695	16		1145	550					550		11						2.66
A1528X	1	15	1535	16		985	550					550		11						2.41
A1529X	1	15	1380	16		1380	550					550		11						2.16
A1530X	1	15	2745	16		430	2315					2100		975						4.31
A1531X	7	15	1325	16		775	550					550		11						14.56
A1532X	1	15	1180	16		630	550					550		11						1.85
A1533X	1	15	1035	16		485	550					550		11						1.62
A1534X	7	15	1345	X1		795	550	550	11											14.77
A1535X	1	15	1200	X1		650	550	550	11											1.88
A1536X	1	15	1070	X1		520	550	550	11											1.68
A2001X	45	20	1505	17		350	285	870												1.6
A2002X	45	20	940	17			670	270												11.3
A2003X	3	20	2650	STR																116.0

MARKS	NO BARS	SIZE	LENGTH	TYPE	A	B	C	D	E	F	G	H	J	K	L	M	O	R	SHAPE	MASS (kg)	
<b>DECK SLAB</b>																					
D1501X	464	15	6090	STR																4436.44	
D1502X	14	15	8500	STR																186.83	
D1503X	232	15	9140	STR																3329.15	
D1504X	140	15	2060	27			1470	600							190		560		2030	452.79	
D1505X	140	15	1775	27			1230	735							146		725		1955	390.15	
D1506X	92	15	2605	X6	355	260	1395	240	360						214	195				376.27	
D1507X	116	15	3385	X7	860	425	2100								2940	20	560			616.50	
D1508X	208	15	2140	STR																698.84	
D1509X	116	15	1415	29		550	315	550							315		15		115	257.70	
D1510X	286	15	665	2	260	200												210		298.60	
D1511X	184	15	2145	X2		1000	300	315	535										300	430	619.65
D1512X	44	15	1970	STR																	136.09
D1513X	17	15	12190	STR																	325.35
D1514X	20	15	1000	STR																	31.40
D2001X	4	20	2000	STR																	18.84
D2002X	84	20	1080	STR																	213.65
D2003X	168	20	1820	2	320	1180										320					720.06
D2501X	245	25	9140	STR																	8789.25
D2502X	252	25	12190	STR																	12057.13
D2503X	72	25	7000	STR																	1978.20
D2504X	76	25	6000	STR																	1789.80
D2505X	73	25	4000	STR																	1146.10
D2506X	65	25	8600	STR																	2194.08
D2507X	126	25	4500	2	900	3600															2225.48
D2508X	126	25	3300	2	900	2400															1632.02
D2511X	12	25	3375	STR																	158.96
D2512X	60	25	5000	STR																	1177.50
D2513X	60	25	10000	STR																	2355.00

DWG TOTAL WEIGHT = 48611.78 kg MMFX

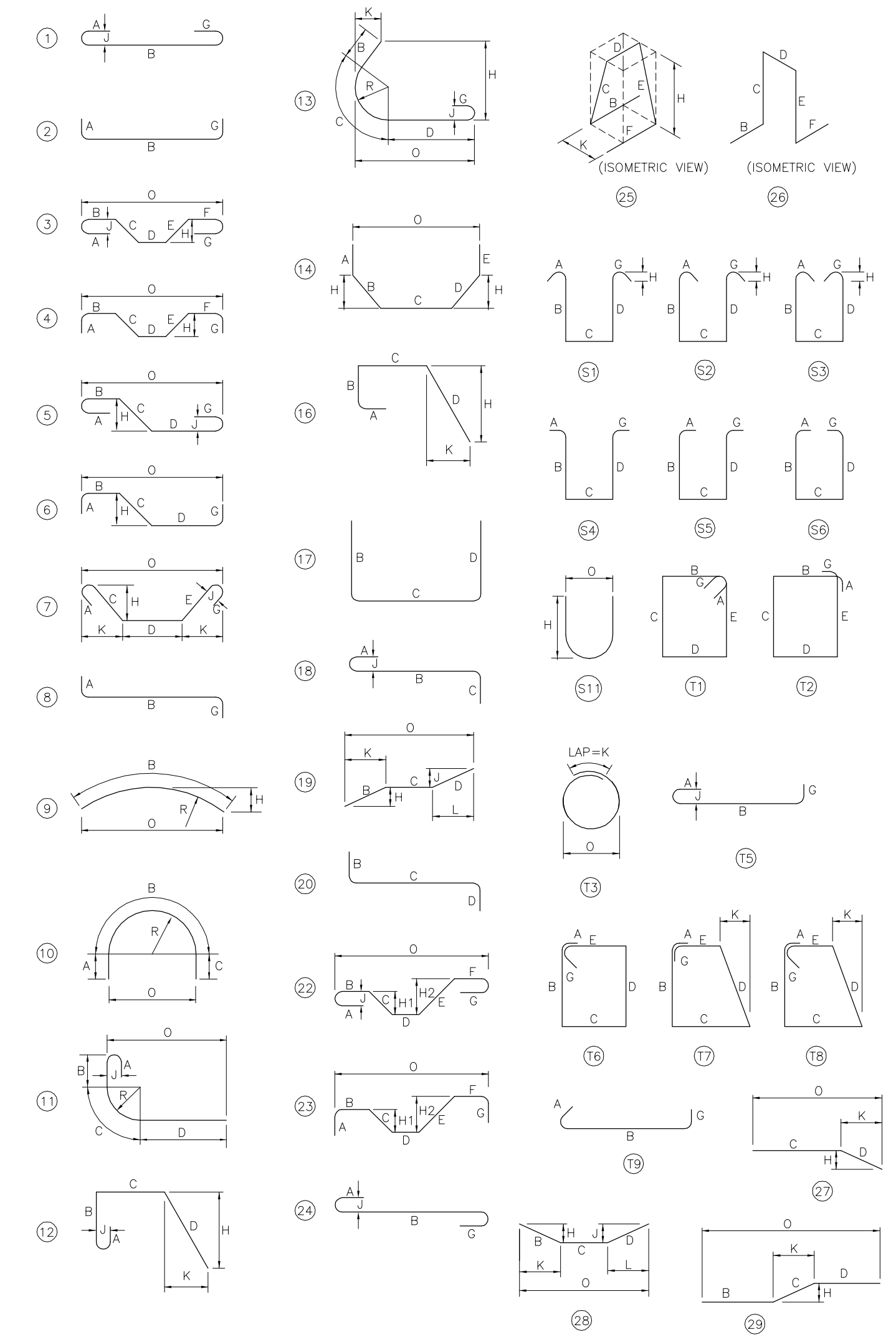

A.C.I. - TYPICAL BAR BENDS

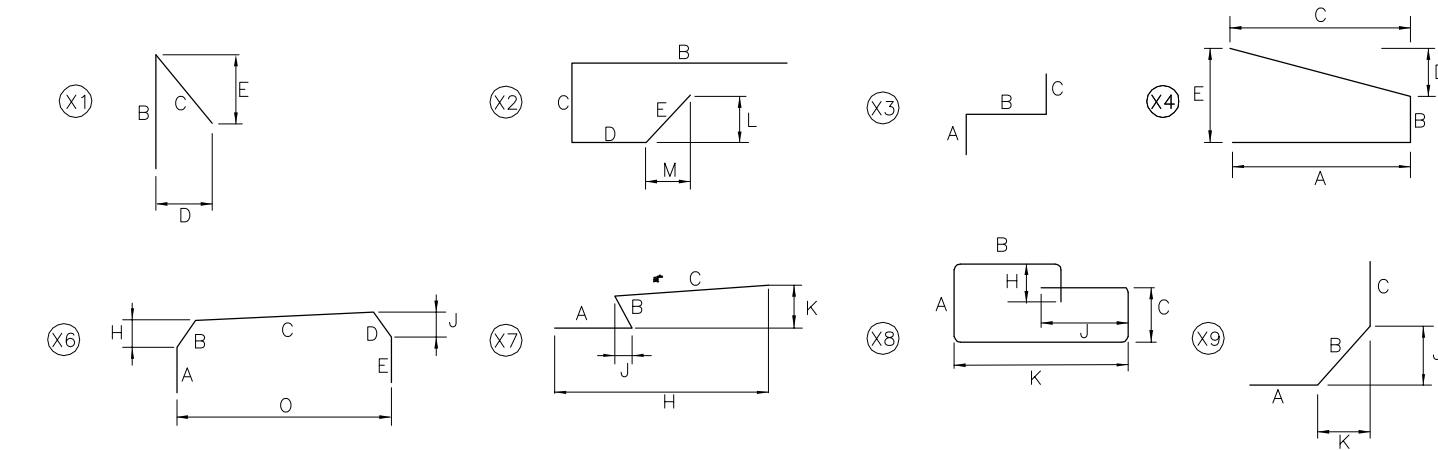

SPECIAL BAR BENDS

NOTES:

- ALL DIMENSIONS ARE OUT-TO-OUT OF A BAR EXCEPT 'A' AND 'G' ON STANDARD 180° AND 135° HOOKS.
- 'J' DIMENSION ON 180° HOOKS TO BE SHOWN ONLY WHERE NECESSARY TO RESTRICT HOOK SIZE, OTHERWISE STANDARD HOOKS ARE TO BE USED.
- ON TRUSS BARS 'J' WILL BE KEPT EQUAL TO OR LESS THEN 'H'. WHERE 'J' CAN EXCEED 'H' IT SHOULD BE SHOWN.
- THE STIRRUPS 'H' DIMENSION SHOULD BE SHOWN ONLY WHERE NECESSARY TO FIT WITHIN CONCRETE.
- CRITICAL DIMENSIONS ARE TO BE IDENTIFIED WHERE BARS ARE TO BE BENT MORE ACCURATELY THAN STANDARD BENDING TOLERANCES.
- ON TYPE T3 'G' DIMENSION IS EQUAL TO CLASS C SPLICE.
- FIGURES SHOWN IN CIRCLES SHOWN TYPES.
- ALL BAR BENDS OTHER THAN THE TYPES SHOWN ABOVE MUST BE DESIGNATED TYPE 'X'.

UNLESS OTHERWISE NOTED DIAMETER D IS THE SAME FOR ALL HOOKS AND BENDS ON A BAR.

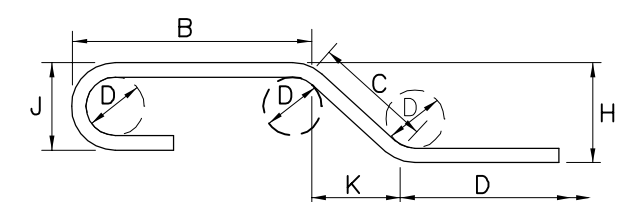

ENLARGED VIEW SHOWING BAR BENDING DETAILS

METRIC  
WHOLE NUMBERS INDICATE MILLIMETRES  
DECIMALIZED NUMBERS INDICATE METRES

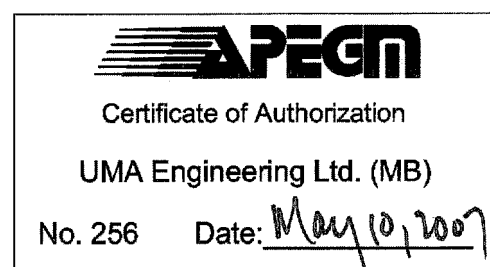

BM 40-012 ELEV 238.149m	DESIGNED BY BLL	CHECKED BY SBB
	DRAWN BY MP	APPROVED BY BWB
	HOR. SCALE AS NOTED	RELEASED FOR CONSTRUCTION DATE: May 10, 2007
	VERT. SCALE AS NOTED	
0 ISSUED FOR CONSTRUCTION	07/05/10	DJH
NO. REVISIONS	YYMMDD	BY

UMA   AECOM	
© 2007 UMA ENGINEERING LTD. ALL RIGHTS RESERVED	
DESIGNED BY 	