

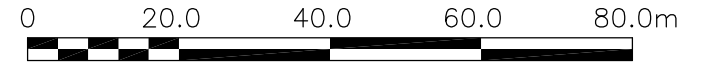

NOTE: ALL SIGNS AND BARRICADES OTHER THAN CONSTRUCTION ZONE BARRICADES
 TO BE ERECTED AND MAINTAINED BY TRAFFIC SERVICES

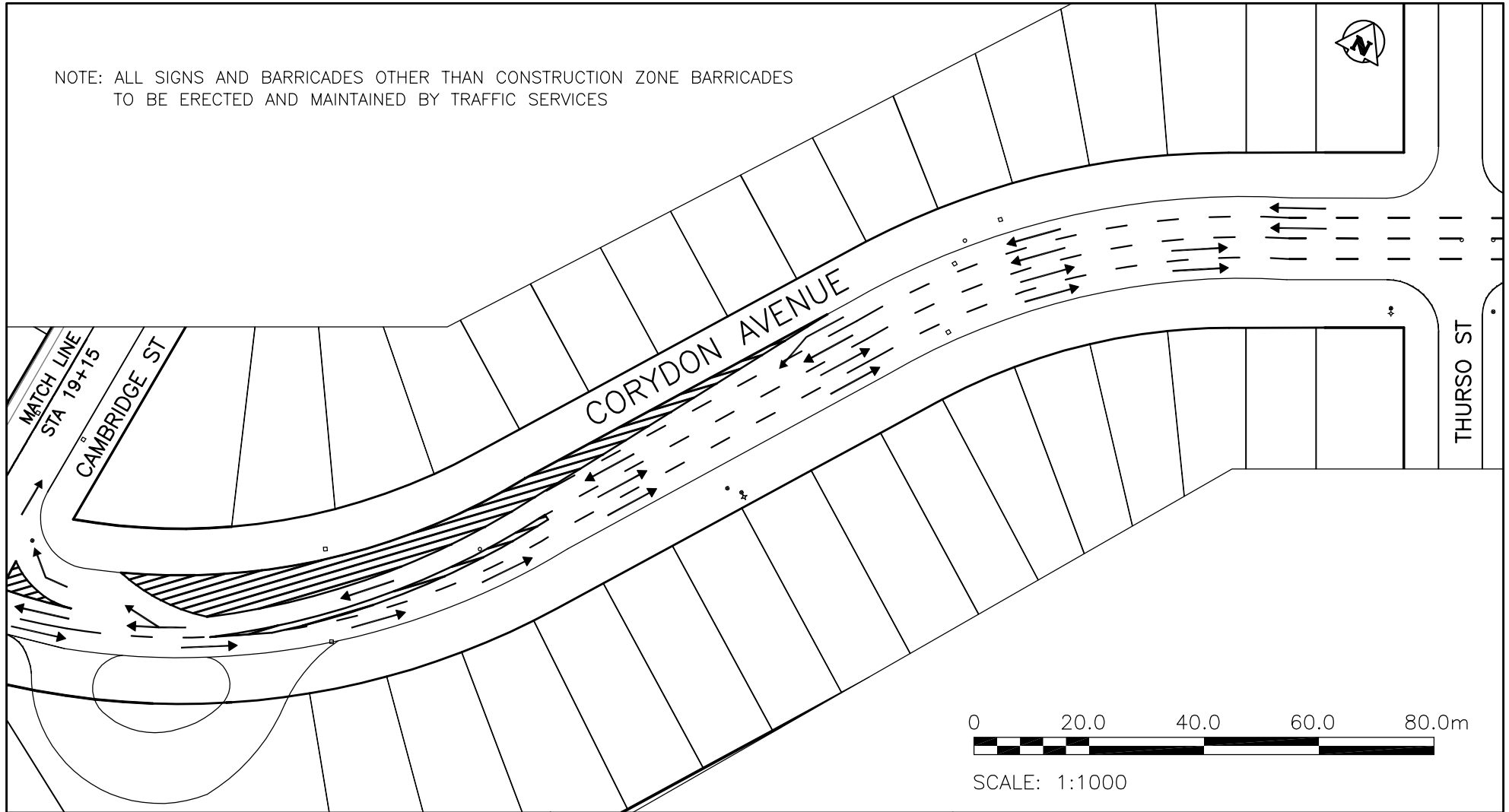

SCALE: 1:1000

LEGEND

-  TRAFFIC SIGNED LANE CLOSURE
-  TEMPORARY ASPHALT DETOUR LANE

BID OPPORTUNITY NO.-323-2007
 TEMPORARY DETOUR DIVERSION
 CAMBRIDGE STREET TO THURSO STREET

KGS
GROUP



CITY OF WINNIPEG
 PUBLIC WORKS DEPARTMENT
 STREETS ENGINEERING DIVISION

CORYDON AVENUE WESTBOUND

CORYDON AVENUE
 MONTROSE STREET TO
 CAMBRIDGE STREET

22/03/07

SK-4