

NOTE: CHAINAGES SHOWN ARE ALONG N. R. OF ROBLIN BV.

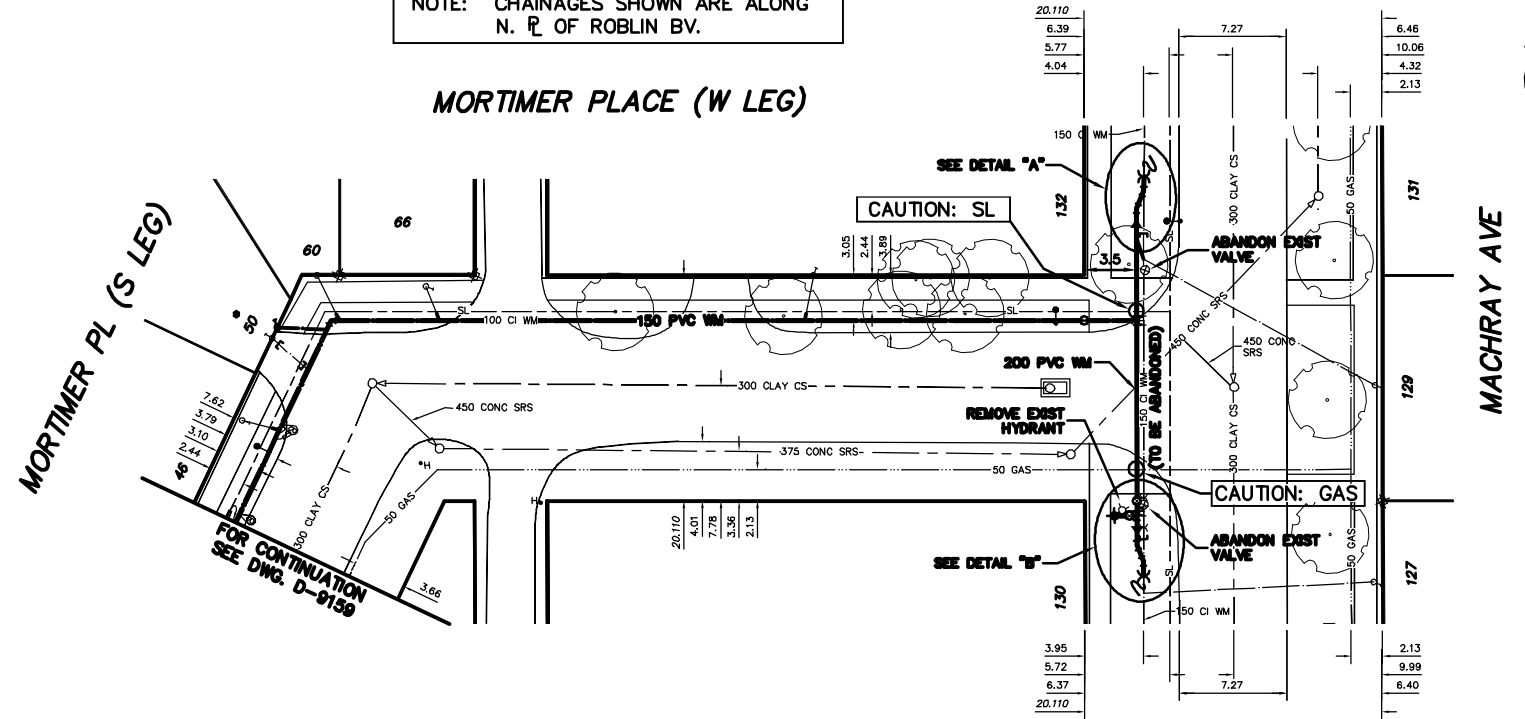

**WATER SERVICE INFORMATION**

ADDRESS	SIZE(mm) & TYPE (STREET)	SIZE(mm) & TYPE (PROP)	SHORT & LONG MEASUREMENT	CORP. LOCATION
48 MORTIMER PL RESIDENTIAL	20 COPPER	12 LEAD	1.98 EWL HSE	0.45 W OF S/C
50 MORTIMER PL RESIDENTIAL	20 COPPER	20 LEAD	105.28 WML ST CROSS	0.92 E OF S/C
50 MORTIMER PL RESIDENTIAL	20 COPPER	20 COPPER	0.33 EEL HSE	
60 MORTIMER PL RESIDENTIAL	20 COPPER	12 COPPER	111.05 WML ST CROSS	1.5 N OF S/C
66 MORTIMER PL RESIDENTIAL	20 COPPER	12 LEAD	4.35>NNL HSE	RENEW TO R/W/20 COPPER
66 MORTIMER PL RESIDENTIAL	20 COPPER	12 LEAD	51.70 SSL MACHRAY	
77 MACHRAY AVE RESIDENTIAL	20 COPPER	12 LEAD	2.43 SNL HSE	0.95 N OF S/C
77 MACHRAY AVE RESIDENTIAL	20 COPPER	12 LEAD	44.45 SSL MACHRAY	
127 MACHRAY AVE RESIDENTIAL	20 COPPER	20 COPPER	7.41 WEL HSE	0.75 E OF S/C
128 MACHRAY AVE RESIDENTIAL	20 COPPER	12 COPPER	5.48 EEL MORTIMER	8.5 W OF S/C
129 MACHRAY AVE RESIDENTIAL	20 COPPER	12 COPPER	2.10 EWL HSE	0.62 W OF S/C
130 MACHRAY AVE RESIDENTIAL	20 COPPER	12 COPPER	7.43 EWL MORTIMER	0.82 W OF S/C
130 MACHRAY AVE RESIDENTIAL	20 COPPER	12 COPPER	9.50 EWL HSE	
131 MACHRAY AVE RESIDENTIAL	20 COPPER	25 COPPER	11.80 EEL MORTIMER	0.61 S OF S/C
131 MACHRAY AVE RESIDENTIAL	20 COPPER	25 COPPER	8.46 WEL HSE	
132 MACHRAY AVE RESIDENTIAL	20 COPPER	20 COPPER	10.50 WML MORTIMER	
132 MACHRAY AVE RESIDENTIAL	20 LEAD	20 LEAD	5.23 SNL HSE	
132 MACHRAY AVE RESIDENTIAL	20 LEAD	20 LEAD	18.28 SSL MACHRAY	

\*SERVICES TO BE RENEWED TO R ALL OTHERS TO BE RECONNECTED

- CONSTRUCTION NOTES**
1. EXPOSE EXISTING WATERMAIN & CONFIRM INVERTS PRIOR TO CONSTRUCTION.
  2. CONFIRM LOCATION OF ALL SERVICES IN THE FIELD.
  3. INSTALL WATERMAIN BY TRENCHLESS METHODS.
  4. TRENCHES AND EXCAVATIONS WITHIN 1 METRE OF A PAVED AREA INCLUDING SIDEWALKS SHALL BE CLASS 3 BACKFILL.
  5. ALL MATERIALS SHALL CONFORM TO THE CITY OF WINNIPEG STANDARD CONSTRUCTION SPECIFICATIONS.
  6. MINIMUM COVER TO TOP OF WATERMAIN SHALL BE 2.4 m.
  7. REPLACE ALL EXISTING LEAD SERVICES FROM PROPOSED WATERMAIN TO R.
  8. NOTIFY ALL AFFECTED RESIDENTS AND BUSINESSES 24 HOURS IN ADVANCE OF ANY WATER SHUTDOWNS OR DISRUPTION OF SERVICE.
  9. EXCAVATIONS TO BE LOCATED AWAY FROM EXISTING TREE'S.

**METRIC**  
WHOLE NUMBERS INDICATE MILLIMETRES  
DECIMALIZED NUMBERS INDICATE METRES

NOTE: ALL VALVES TO BE INSTALLED COUNTERCLOCKWISE TO CLOSE

**WARNING**  
IF POWER EQUIPMENT OR EXPLOSIVES ARE TO BE USED FOR EXCAVATION ON THIS PROJECT THE CONTRACTOR MUST:  
1) NOTIFY THE GAS COMPANY OF THE PROPOSED LOCATION OF EXCAVATION.  
2) TAKE PRECAUTION TO AVOID DAMAGE TO GAS COMPANY INSTALLATIONS.  
SEE PROVINCIAL REGULATION 210/72 FOR DETAILS

<table border="1"> <tr> <th>200 WM</th> <th>WATERMAIN</th> <th>200 WM</th> <th>SL, HYDRO</th> <th>150 WM</th> <th>WATERMAIN</th> <th>150 WM</th> </tr> <tr> <td>⊕</td> <td>HYDRANT</td> <td>⊕</td> <td>MTS</td> <td>⊕</td> <td>HYDRANT</td> <td>⊕</td> </tr> <tr> <td>⊙</td> <td>VALVE</td> <td>⊙</td> <td>TRAFFIC SIGNALS</td> <td>⊙</td> <td>VALVE</td> <td>⊙</td> </tr> <tr> <td>525 LDS</td> <td>LAND DRAINAGE SEWER</td> <td>525 LDS</td> <td>GAS</td> <td>300 LDS</td> <td>LAND DRAINAGE SEWER</td> <td>300 LDS</td> </tr> <tr> <td>375 WWS</td> <td>WASTEWATER SEWER</td> <td>375 WWS</td> <td>SURVEY BAR</td> <td>250 WWS</td> <td>WASTEWATER SEWER</td> <td>250 WWS</td> </tr> <tr> <td>○</td> <td>MANHOLE</td> <td>○</td> <td>FENCE</td> <td>⊕</td> <td>PROFILE</td> <td>⊕</td> </tr> <tr> <td>□</td> <td>CATCH BASIN</td> <td>□</td> <td>POLE - HYDRO, MTS</td> <td>⊕</td> <td>GROUND ABOVE PIPE</td> <td>⊕</td> </tr> <tr> <td>▽</td> <td>CURB INLET</td> <td>▽</td> <td>CURB STOP</td> <td>⊕</td> <td>DITCH (NORTH &amp; WEST)</td> <td>⊕</td> </tr> <tr> <td>◁</td> <td>REDUCER</td> <td>◁</td> <td>GUY ANCHOR</td> <td>⊕</td> <td>DITCH (SOUTH &amp; EAST)</td> <td>⊕</td> </tr> <tr> <td>X</td> <td>COUPLER</td> <td>X</td> <td>LIGHT STANDARD</td> <td>⊕</td> <td>GUTTER (NORTH &amp; WEST)</td> <td>⊕</td> </tr> <tr> <td>⊕</td> <td>ANODE</td> <td>⊕</td> <td>TREE</td> <td>⊕</td> <td>GUTTER (SOUTH &amp; EAST)</td> <td>⊕</td> </tr> <tr> <td>EXISTING</td> <td>LEGEND-PLAN</td> <td>PROPOSED</td> <td>EXISTING</td> <td>LEGEND-PLAN</td> <td>PROPOSED</td> <td>EXISTING</td> </tr> </table>	200 WM	WATERMAIN	200 WM	SL, HYDRO	150 WM	WATERMAIN	150 WM	⊕	HYDRANT	⊕	MTS	⊕	HYDRANT	⊕	⊙	VALVE	⊙	TRAFFIC SIGNALS	⊙	VALVE	⊙	525 LDS	LAND DRAINAGE SEWER	525 LDS	GAS	300 LDS	LAND DRAINAGE SEWER	300 LDS	375 WWS	WASTEWATER SEWER	375 WWS	SURVEY BAR	250 WWS	WASTEWATER SEWER	250 WWS	○	MANHOLE	○	FENCE	⊕	PROFILE	⊕	□	CATCH BASIN	□	POLE - HYDRO, MTS	⊕	GROUND ABOVE PIPE	⊕	▽	CURB INLET	▽	CURB STOP	⊕	DITCH (NORTH & WEST)	⊕	◁	REDUCER	◁	GUY ANCHOR	⊕	DITCH (SOUTH & EAST)	⊕	X	COUPLER	X	LIGHT STANDARD	⊕	GUTTER (NORTH & WEST)	⊕	⊕	ANODE	⊕	TREE	⊕	GUTTER (SOUTH & EAST)	⊕	EXISTING	LEGEND-PLAN	PROPOSED	EXISTING	LEGEND-PLAN	PROPOSED	EXISTING	<p>LOCATION APPROVED UNDERGROUND STRUCTURES</p> <p>SUPV. U/G STRUCTURES COMMITTEE DATE</p> <p>NOTE: LOCATION OF UNDERGROUND STRUCTURES AS SHOWN ARE BASED ON THE BEST INFORMATION AVAILABLE BUT NO GUARANTEE IS GIVEN THAT THE GIVEN LOCATIONS ARE EXACT. CONFIRMATION OF EXISTENCE AND EXACT LOCATION OF ALL SERVICES MUST BE OBTAINED FROM THE INDIVIDUAL UTILITIES BEFORE PROCEEDING WITH CONSTRUCTION.</p>	<p>B.M. ELEV. FIELD BOOK #</p> <p>POSTED TO LBS</p>	<p><b>CITY OF WINNIPEG</b> WATER AND WASTE ENGINEERING DIVISION</p> <p>DESIGNED BY SC CHECKED BY TW DRAWN BY CJH APPROVED BY KZ</p> <p>HOR. SCALE 1:250 VERTICAL 1:50</p> <p>RELEASED FOR CONSTRUCTION</p> <p>NO. REVISIONS DATE BY DATE 2007 04 24 DATE</p>	<p>ENGINEER'S SEAL</p> <p>ORIGINAL SIGNED BY S.R.J. COURNOYER 07/04/25</p> <p>BID OPPORTUNITY: 318-2007 FILENAME: D-9160.dwg PLOT DATE: 2007 04 24</p>	<p><b>THE CITY OF WINNIPEG</b> WATER AND WASTE DEPARTMENT</p> <p>2007 WATERMAIN RENEWALS CONTRACT 3 MORTIMER PLACE (W LEG) MORTIMER PLACE (S LEG) TO MACHRAY AVENUE</p> <p>SHEET 5 OF 6 CITY DRAWING NUMBER D-9160</p>
200 WM	WATERMAIN	200 WM	SL, HYDRO	150 WM	WATERMAIN	150 WM																																																																																			
⊕	HYDRANT	⊕	MTS	⊕	HYDRANT	⊕																																																																																			
⊙	VALVE	⊙	TRAFFIC SIGNALS	⊙	VALVE	⊙																																																																																			
525 LDS	LAND DRAINAGE SEWER	525 LDS	GAS	300 LDS	LAND DRAINAGE SEWER	300 LDS																																																																																			
375 WWS	WASTEWATER SEWER	375 WWS	SURVEY BAR	250 WWS	WASTEWATER SEWER	250 WWS																																																																																			
○	MANHOLE	○	FENCE	⊕	PROFILE	⊕																																																																																			
□	CATCH BASIN	□	POLE - HYDRO, MTS	⊕	GROUND ABOVE PIPE	⊕																																																																																			
▽	CURB INLET	▽	CURB STOP	⊕	DITCH (NORTH & WEST)	⊕																																																																																			
◁	REDUCER	◁	GUY ANCHOR	⊕	DITCH (SOUTH & EAST)	⊕																																																																																			
X	COUPLER	X	LIGHT STANDARD	⊕	GUTTER (NORTH & WEST)	⊕																																																																																			
⊕	ANODE	⊕	TREE	⊕	GUTTER (SOUTH & EAST)	⊕																																																																																			
EXISTING	LEGEND-PLAN	PROPOSED	EXISTING	LEGEND-PLAN	PROPOSED	EXISTING																																																																																			