

**WATER SERVICE INFORMATION**

ADDRESS & SERVICE	SIZE (mm) & TYPE (STREET)	STOP COCK SHORT & LONG MEASUREMENT	CORPORATION LOCATION	REMARKS
#330 VICTOR STREET RESIDENTIAL	12 LEAD	OPP CENTRE HSE	OPP SC	
#331 VICTOR STREET RESIDENTIAL	30 COPPER	0.3m NNL HSE	0.6m S SC	DOUBLED WITH 333
#332 VICTOR STREET RESIDENTIAL	30 COPPER	3.5m NNL HSE	1.5m S SC	DOUBLED WITH 334
#333 VICTOR STREET RESIDENTIAL	30 COPPER	0.6m SSL HSE	0.6m S SC	DOUBLED WITH 331
#334 VICTOR STREET RESIDENTIAL	20 COPPER	0.6m SSL HSE	1.2m S SC	DOUBLED WITH 332
#335 VICTOR STREET RESIDENTIAL	30 COPPER	1.2m SSL HSE	OPP SC	DOUBLED WITH 337
#337 VICTOR STREET RESIDENTIAL	30 COPPER	1.2m SNL HSE 335	OPP SC	DOUBLED WITH 335
#338 VICTOR STREET RESIDENTIAL	30 COPPER	0.9m SSL HSE 340	0.3m S SC	DOUBLED WITH 340
#339 VICTOR STREET RESIDENTIAL	30 COPPER	2.9m NSL HSE 341	OPP SC 341	DOUBLED WITH 341
#340 VICTOR STREET RESIDENTIAL	30 COPPER	0.6m SSL HSE	0.3m S SC	DOUBLED WITH 338
#341 VICTOR STREET RESIDENTIAL	30 COPPER	2.6m NSL HSE	OPP SC	DOUBLED WITH 339
#342 VICTOR STREET RESIDENTIAL	30 COPPER	1.8m SNL HSE	OPP SC	
#344 VICTOR STREET RESIDENTIAL	16 LEAD	0.6m NSL HSE	OPP SC	DOUBLED WITH 346
#346 VICTOR STREET RESIDENTIAL	18 LEAD	0.6m NSL HSE	OPP SC	DOUBLED WITH 344
#348 VICTOR STREET RESIDENTIAL	30 COPPER	0.3m NNL HSE	0.9m S SC	DOUBLED WITH 350
#350 VICTOR STREET RESIDENTIAL	30 COPPER	1.2m SSL HSE	1.2m S SC	DOUBLED WITH 348
#351 VICTOR STREET RESIDENTIAL	30 COPPER	0.9m NSL BLDG	OPP SC	
#352 VICTOR STREET RESIDENTIAL	16 COPPER	0.3m SNL HSE	OPP SC	DOUBLED WITH 354
#354 VICTOR STREET RESIDENTIAL	18 LEAD	0.3m SNL HSE	OPP SC	DOUBLED WITH 352

\* RENEW SERVICE  
ALL OTHER SERVICES TO BE RECONNECTED

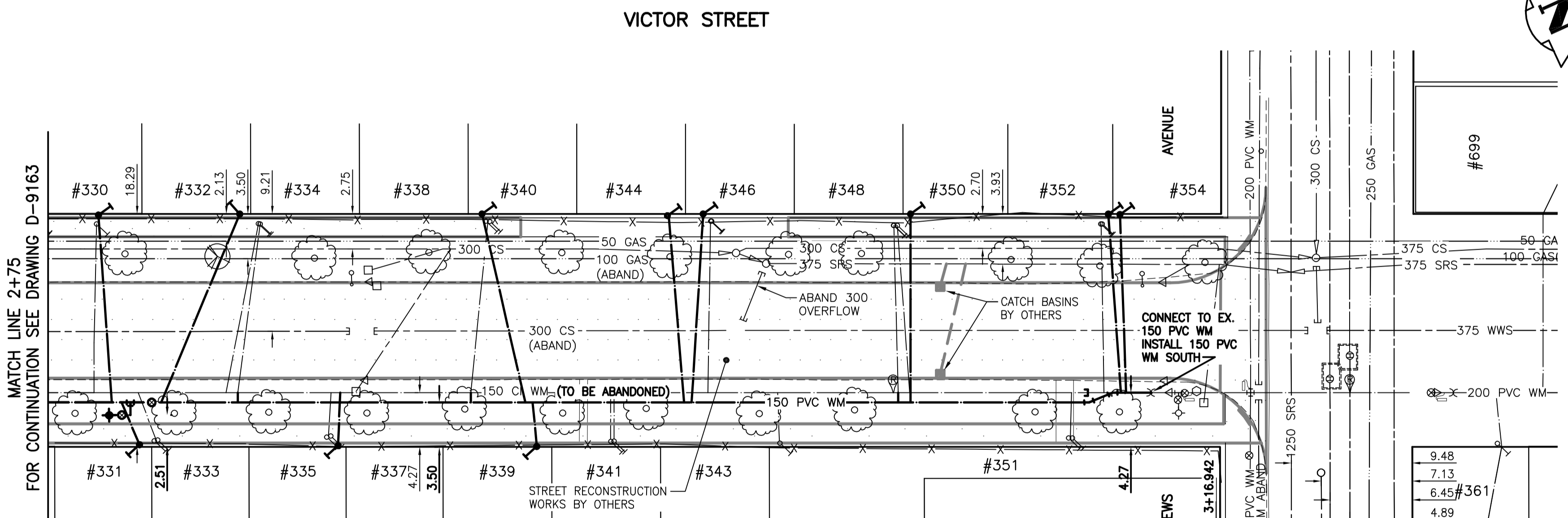

**WARNING**  
IF POWER EQUIPMENT OR EXPLOSIVES ARE TO BE USED FOR EXCAVATION ON THIS PROJECT THE CONTRACTOR MUST:  
1) NOTIFY THE GAS COMPANY OF THE PROPOSED LOCATION OF EXCAVATION.  
2) TAKE PRECAUTION TO AVOID DAMAGE TO GAS COMPANY INSTALLATIONS.  
SEE PROVINCIAL REGULATION 140/92 FOR DETAILS

**METRIC**  
WHOLE NUMBERS INDICATE MILLIMETRES  
DECIMAL NUMBERS INDICATE METRES

**NOTE:**  
STATIONS ALONG E.P. OF VICTOR ST.

**BENCH MARK:** N.E. cor. St. Matthews Ave. & Simcoe St., Tblt. in S. conc. foundation No. 345 Simcoe St., 0.5m E. & 1m below tyndall stone of S.W. cor. of bldg.

BID OPPORTUNITY 312-2007



EXISTING	LEGEND-PLAN	PROPOSED	EXISTING	LEGEND-PLAN	PROPOSED	EXISTING	LEGEND-PROFILE	PROPOSED
150 WM	WATERMAIN	150 WM	HYDRO	M.T.S.	150 WM	WATERMAIN	150 WM	HYDRANT, VALVE
300 LDS	LAND DRAINAGE SEWER	300 LDS	CONCRETE	300 LDS	LAND DRAINAGE SEWER	300 LDS	300 LDS	LAND DRAINAGE SEWER
250 WWS	WASTE WATER SEWER	250 WWS	ASPHALT	250 WWS	WASTE WATER SEWER	250 WWS	250 WWS	WASTE WATER SEWER
MANHOLE	MANHOLE	MANHOLE	SIDEWALK	MANHOLE	MANHOLE	MANHOLE	MANHOLE	MANHOLE
CATCH BASIN	CATCH BASIN	CATCH BASIN	PROPERTY LINE	CATCH BASIN	CATCH BASIN	CATCH BASIN	CATCH BASIN	CATCH BASIN
CURB INLET	CURB INLET	CURB INLET	SURVEY BAR	CURB INLET	CURB INLET	CURB INLET	CURB INLET	CURB INLET
JUNCTIONS	JUNCTIONS	JUNCTIONS	DITCH	JUNCTIONS	JUNCTIONS	JUNCTIONS	JUNCTIONS	JUNCTIONS
CULVERT	CULVERT	CULVERT	ELEVATION	CULVERT	CULVERT	CULVERT	CULVERT	CULVERT
GAS	GAS	GAS	SIDEWALK RAMP	GAS	GAS	GAS	GAS	GAS

**LOCATION APPROVED UNDERGROUND STRUCTURES**

SUPV. U/G STRUCTURES COMMITTEE	DATE

**NOTE:**  
LOCATION OF UNDERGROUND STRUCTURES AS SHOWN ARE BASED ON THE BEST INFORMATION AVAILABLE BUT NO GUARANTEE IS GIVEN THAT THE GIVEN LOCATIONS ARE EXACT. CONFIRMATION OF EXISTENCE AND EXACT LOCATION OF ALL SERVICES MUST BE OBTAINED FROM THE INDIVIDUAL UTILITIES BEFORE PROCEEDING WITH CONSTRUCTION.

**Stantec Consulting Ltd.**  
905 Waverley Street, Winnipeg, Manitoba  
Tel 204-489-5900 Fax 204-453-9012

DESIGNED BY: J.K.H.	CHECKED BY: W.B.
DRAWN BY: J.K.H.	APPROVED BY: H.A.K.
HOR. SCALE: 1:250	RELEASED FOR CONSTRUCTION: DATE
VERTICAL: 1:50	DATE: 07.04.02

**ENGINEER'S SEAL**

ORIGINAL SEALED BY: H.A. KATZ  
P. ENG. 07.04.27

CONSULTANT DRAWING NO. C-204

**THE CITY OF WINNIPEG**  
WATER AND WASTE DEPARTMENT

**2007 WATERMAIN RENEWALS, SEWER RENEWALS, AND EXTERNAL POINT REPAIRS - CONTRACT 8**  
VICTOR STREET  
STA. 2+75 TO ST. MATTHEWS AVENUE  
150 WATERMAIN RENEWAL

SHEET 4 OF 11  
CAD FILE DRAWING NUMBER 09700C-202685.dwg  
CITY DRAWING NUMBER D-9164