

REF. or DRAWING No. **WEP-286-A**
DETAILS FILE # **WS 10738**

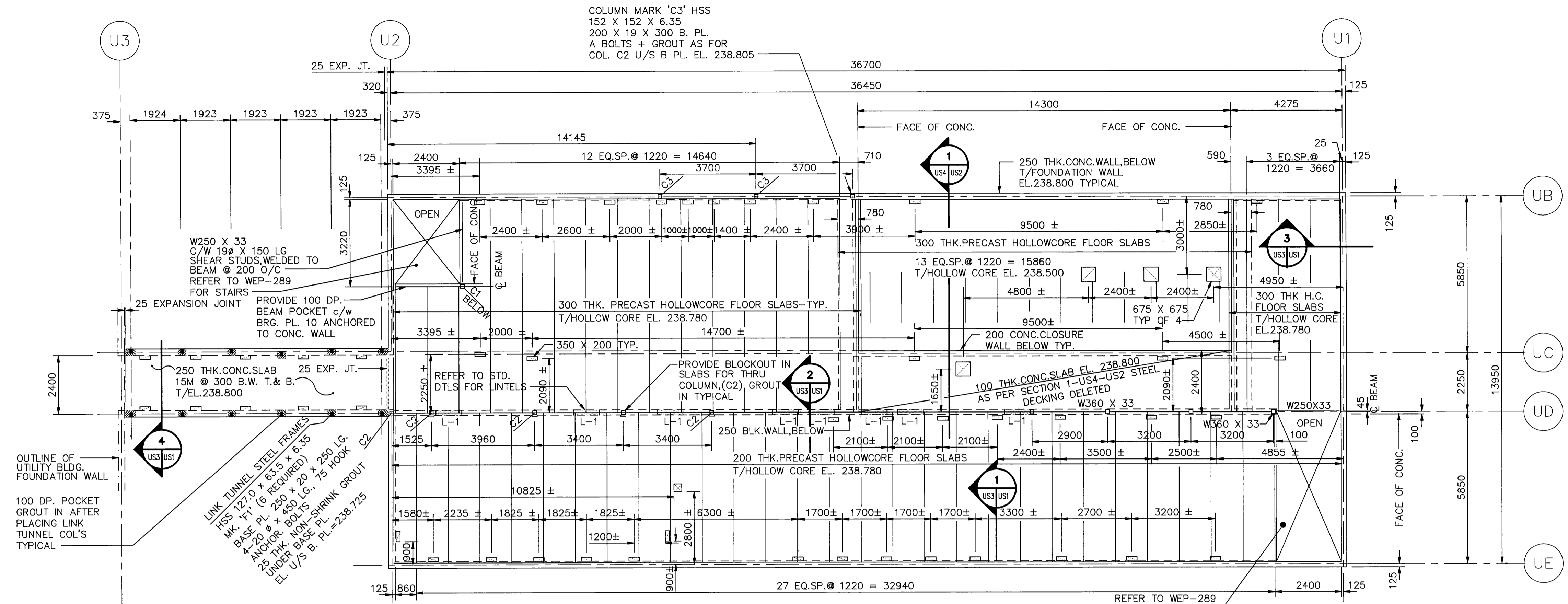

MAIN FLOOR FRAMING PLAN

MAIN FLOOR DESIGN LOADS:
LIVE LOAD = VARIES
TOTAL LOAD = VARIES

NOTE:
HOLLOWCORE FLOOR TO RECEIVE
20mm SLURRY COAT
T/EL. 238.800
HOLLOWCORE SUPPLIER TO DESIGN H.C.
FOR ALL OPENINGS, BLOCK WALL AND
CONC. SLAB SUPERIMPOSED LOADING PLUS
SPECIFIED LIVE LOAD

NOTE: WHEREVER BLOCK RESTS ON A STL BM
PROVIDE WELDED REBAR ON BEAM TO
MATCH VERT. REINF. OR SHEAR STUDS
IF NO VERT. REINFORCING

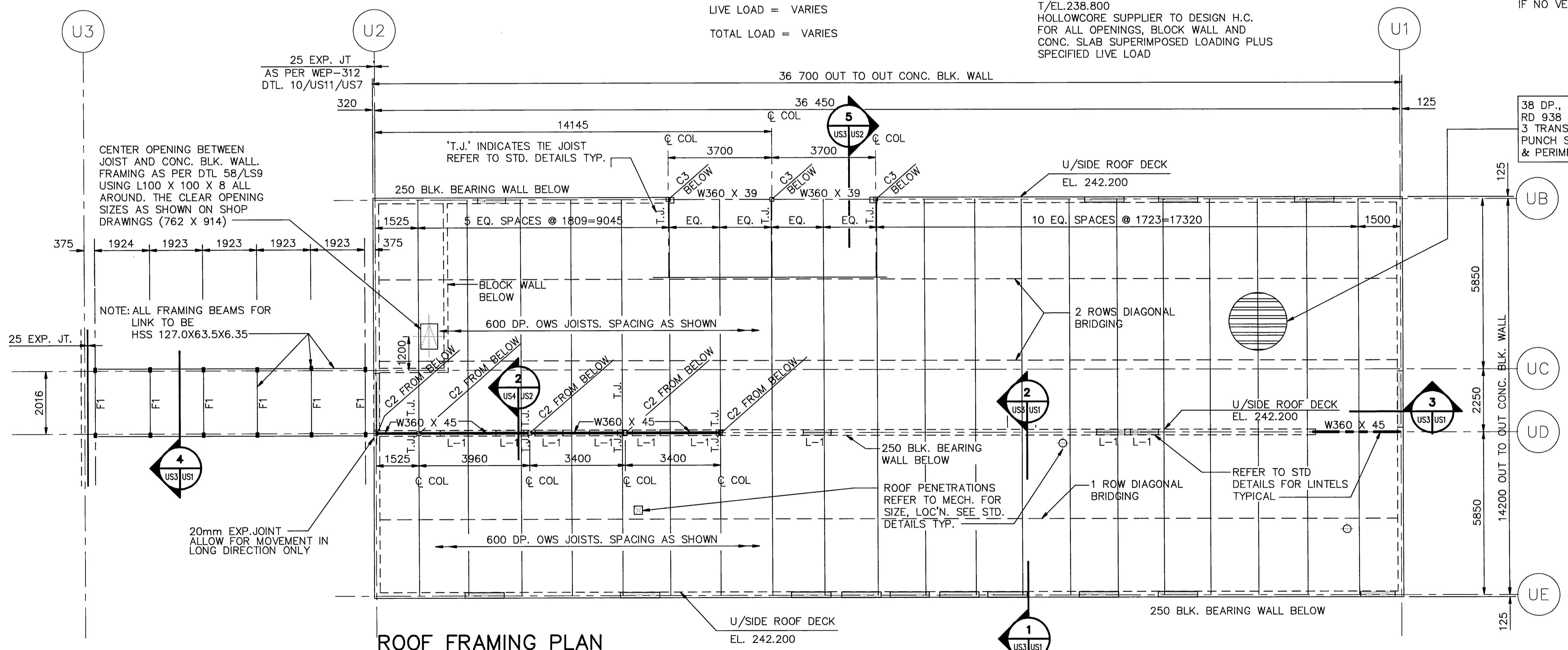

ROOF FRAMING PLAN

38 DP., 0.91mm THK. STEEL DECK,
RD 938 PROFILE OR EQUIV. 3 SPAN CONT
3 TRANSV. WELDS PER DECK UNIT, BUTT
PUNCH SIDE LAP @ 600 O.C., LONGITUDINAL
& PERIMETER WELDS @ 600 O.C.

NOTES:
WELDING SHALL BE DONE ONLY BY QUALIFIED
WELDERS WHO SHALL MAKE PRACTICE WELDS PRIOR
TO ACTUAL JOB. PRACTICE WELDS SHALL BE MADE
ON THE DECK TO BE USED TO CHECK ADEQUACY OF
THE WELDING ROD AMPERAGE AND BURN OFF RATE
TO PRODUCE SATISFACTORY FUSION FOR THE VARIOUS
WELDS REQUIRED. BOTH THE PRACTICE WELDS AND
ACTUAL JOB WELDS SHALL BE INSPECTED BY THE
STEEL DECK ERECTOR AS TO SIZE AND SPACING
AND TESTED BY PRY TESTS TO ASSURE METAL
TO METAL FUSION. (13mm PUDDLE WELDS MIN.)

detail symbol
A detail number
B drawing where detail shown
C cross reference to drawing
where detail taken

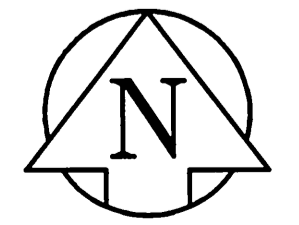

REID, CROWTHER & PARTNERS LIMITED
WINNIPEG
AS CONSTRUCTED

B.M. 69-006 ELEV. 237.636 m		Reid Crowther		ENGINEER'S SEAL	
DESIGNED BY		DRAWN BY		ORIGINAL SIGNED BY	
DRAWN BY		CHECKED BY		E.G. MARTIN	
HOR. SCALE: 1:100		APPROVED BY		91/06/04	
VERTICAL:		RELEASED FOR CONSTRUCTION:		CONSULTANT DRAWING NO.	
NO. REVISIONS		DATE		60910 - US2	
1 AS CONSTRUCTED		94/09/26 DJT		THE CITY OF WINNIPEG	
0 ISSUED FOR TENDER		91/06/17 PAL		WORKS AND OPERATIONS DIVISION	
				WEST END WATER POLLUTION CONTROL CENTRE EXPANSION	
				AREA U - ADMINISTRATION BUILDING	
				STRUCTURAL MAIN FLOOR & ROOF FRAMING PLANS	
				WEP-286-A	