

1 PUMP STATION EQUIPMENT PLAN
SCALE: 1:50

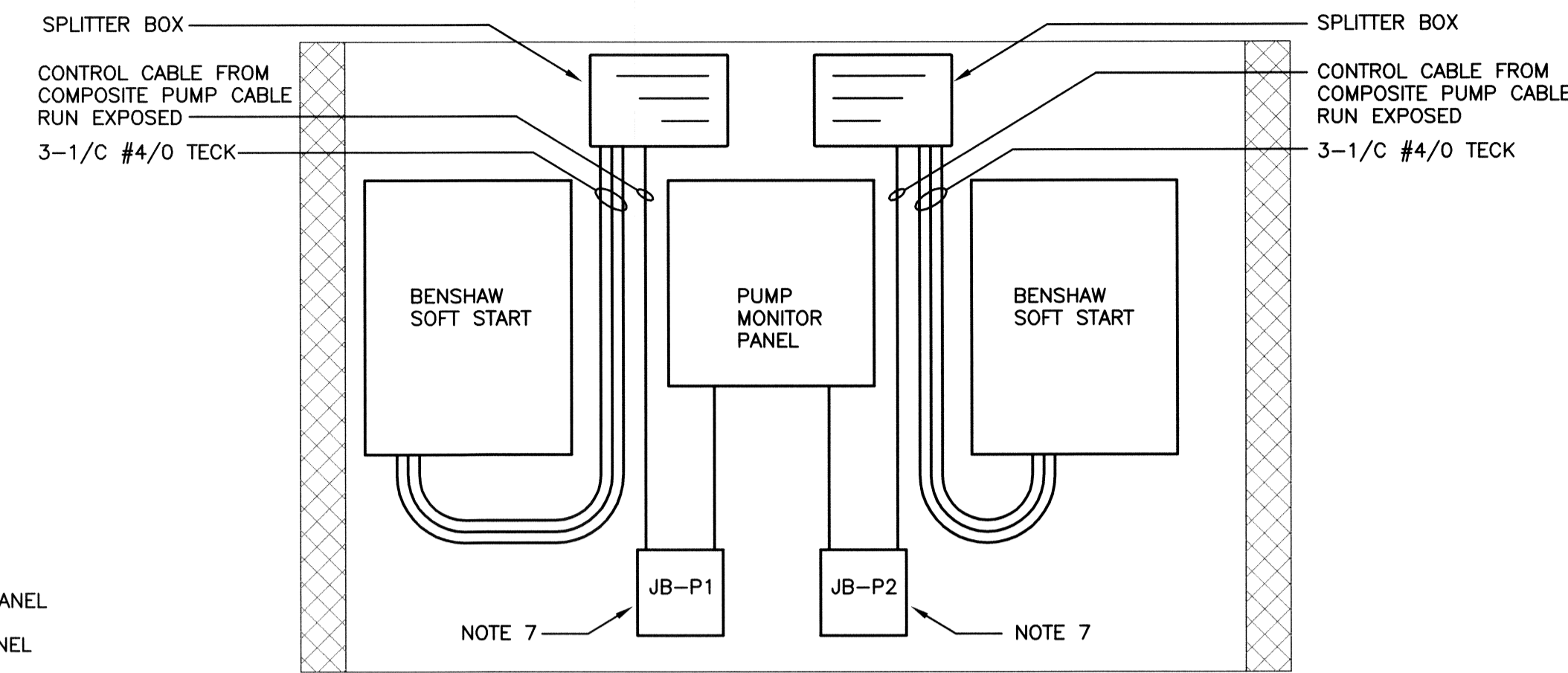

A SECTION
SCALE: 1:25

- NOTES:**
- ROUTE MAIN FEEDER CONDUITS INTO BUILDING.
 - CO-ORDINATE LOCATION OF EQUIPMENT WITH VENTILATION EQUIPMENT.
 - CITY WILL TURN OVER SCADA PANEL FOR THE CONTRACTOR TO MOUNT WITHIN THE ELECTRICAL ROOM. THE CONTRACTOR SHALL BE RESPONSIBLE FOR CONNECTION OF THE CONTROL CABLING AS INDICATED ON THE CONTROL SCHEMATIC, PROVIDING POWER TO THE PANEL AND CONNECTION OF THE PHONE LINE. THE CITY SHALL PERFORM ALL OTHER REQUIRED CONFIGURATION AND COMMISSIONING OF THE PANEL.
 - FF-1 SHALL BE A CEILING/SURFACE MOUNTED FORCE FLOW HEATER SUPPLIED BY THE CONTRACTOR RATED AT 2250W. THE HEATER SHALL BE COMPLETE WITH ALL REQUIRED SURFACE MOUNT ACCESSORIES AND AN INTERGAL THERMOSTAT SET TO MAINTAIN 15 DEGREES CELCIUS IN THE ROOM. THE UNIT SHALL BE AN OULLETTE OACp OR APPROVED EQUAL.
 - ALL WIRING WITHIN THE ELECTRICAL ROOM SHALL BE RUN IN RIGID PVC CONDUIT, UNLESS OTHERWISE NOTED.
 - MDP-1 LOCATION SHALL BE CO-ORDINATED WITH INSTALLATION OF SF-1. MDP-1 SHALL PREFERABLY BE MAXIMUM 38" WIDE.
 - STRIP CABLE AND TERMINATE CONTROL CABLES TO TERMINAL BLOCKS.

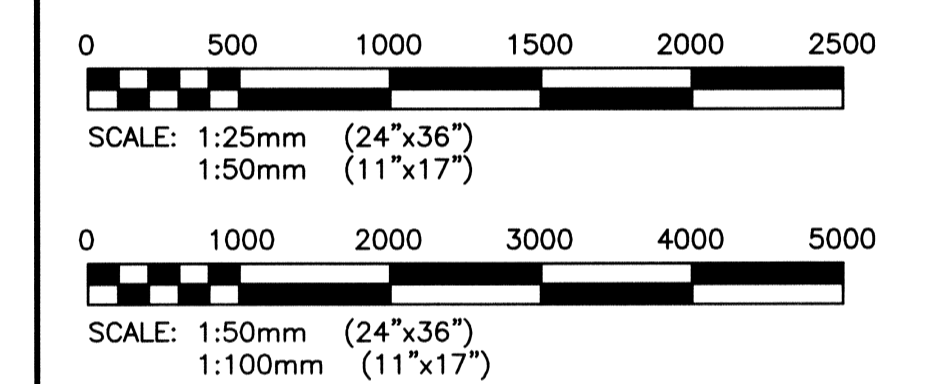

LUMINAIRE SCHEDULE				
TYPE	DESCRIPTION	VOLTAGE	LAMPS	APPROVED MANUFACTURERS
A	CHAIN SUSPENDED FLUORESCENT INDUSTRIAL LUMINAIRE c/w SLOTTED REFLECTOR AND ELECTRONIC BALLAST.	120V	2-32W T8 4100°K	LITHONIA LIGHTING: RIU 2 32 120 GEB10RS CSA
B	HPS WALLPACK CUT-OFF, HIGH POWER FACTOR BALLAST, CAST BODY POLYCARBONATE LENS c/w PHOTOCCELL CONTROL.	120V	1-70W HPS	LITHONIA LIGHTING: TWAC 70S 120 XHP CSA RK1 PEB1 CSA
C	7.62m [35'] GALVANIZED STEEL POLE WITH A 63.5mm [2-1/2"] HORIZONTAL STANCHION c/w HIGH POWER FACTOR HPS, BULLET RESISTANT, INDIRECT STYLE FIXTURE.	120V	1-400W HPS	MORLITE: BP-X SERIES FIXTURE MARTEC: POLES TO CITY OF WINNIPEG STANDARDS

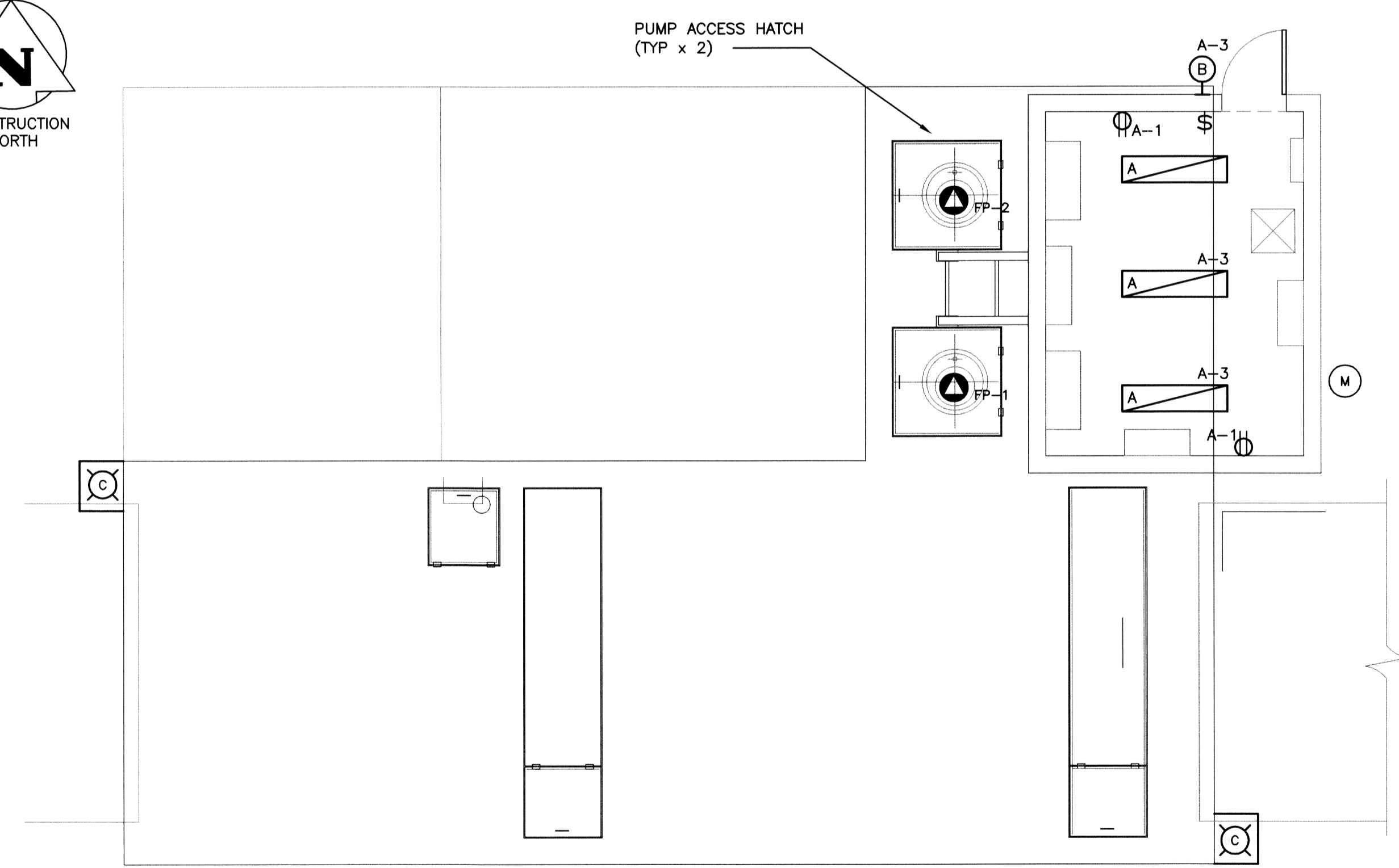

2 PUMP STATION POWER & LIGHTING PLAN
SCALE: 1:50

SUPPLY: 120/240V 1Ø 3W MAINS AMPACITY: 100A INCOMING: <input checked="" type="checkbox"/> BREAKER <input type="checkbox"/> LUGS MAIN BREAKER REQUIRED: <input checked="" type="checkbox"/> YES <input type="checkbox"/> NO MAIN BREAKER AMPS: 60A BUS MATERIAL: <input checked="" type="checkbox"/> COPPER <input type="checkbox"/> ALUMINUM BUS AND BREAKER RATING: 22 kA (SYM.) I.C.	NAME PLATE: PANEL 'A'	LOCATION: - MOUNTING: <input checked="" type="checkbox"/> SURFACE <input type="checkbox"/> FLUSH MANUFACTURER: - MODEL NO: - BREAKER: <input type="checkbox"/> PLUG-IN <input checked="" type="checkbox"/> BOLT-ON BREAKER TYPE: -
--	--	---

CCT	VA	P	BKR	L1	L2	BKR	P	VA	CCT
1 RECEPTACLE	(2)	-	1	15	15	1	1	300	2
3 LIGHTING	-	1	15	15	15	1	-	-	4
5 HEATER FOR RVS-1	-	1	15	-	-	-	-	-	6
7 HEATER FOR RVS-2	-	1	15	-	-	-	-	-	8
9 FF-1 (NOTE 4)	2250	2	15	-	-	-	-	-	10
11	-	-	-	-	-	-	-	-	12
13 JB-3 RECEPTACLE	-	2	20	-	-	-	-	-	14
15	-	-	-	-	-	-	-	-	16
17	-	-	-	-	-	-	-	-	18
19 JB-3 RECEPTACLE	-	1	30	-	-	-	-	-	20
21 SPARE	-	1	15	-	-	-	-	-	22
23 SPARE	-	1	15	-	-	-	-	-	24

00	05/04/07	Issued for Tender and Construction By City of Winnipeg	GCN	DDW	REW
0C	05/04/07	Issued for Review to City of Winnipeg	GCN	DDW	REW
0B	04/07/06	Issued with Contract C5 as Reference Only	GCN	AP	REW
0A	09/06/06	ISSUED FOR REVIEW, 90% COMPLETE	GCN	AP	REW
NO.	DATE	REVISIONS	BY	CKD	APP.

KGS GROUP

SUBCONSULTANT DWG NO.:

APEGM
 Certificate of Authorization
KGS Group
 No. 245 Expiry: April 30, 2008

DESIGNED BY: AP	DRAWN BY: GCN	SCALE: AS NOTED
CHECKED BY: REW	APPROVED BY: REW	DATE: MAY, 2006

KGS GROUP SUBMITTED BY: RICK CARSON

OWNER: **MANITOBA FLOODWAY AUTHORITY**

PROJECT: **RED RIVER FLOODWAY EXPANSION**

PHASE: **MAIN CHANNEL CONTRACT No C5**

TITLE: **KILDARE LAND DRAINAGE FLOOD PUMPING STATION ELECTRICAL WORKS FLOOD PUMPING STATION PLANS, SECTION AND SCHEDULES**

MFA acceptance:

DOUG McNEIL	VICE PRESIDENT OF ENGINEERING AND CONSTRUCTION
OWNER DWG NO.: CC5-48aE-007c	SHT. 01 REV. 00



THE CITY OF WINNIPEG WATER & WASTE DEPARTMENT

CITY OF WINNIPEG IS RESPONSIBLE FOR MECHANICAL AND ELECTRICAL WORK. MFA acceptance is limited to the Red River Floodway Expansion project only, and specifically excludes acceptance of any mechanical and electrical works indicated on this drawing, which are incorporated for the purpose of City of Winnipeg Bid Opportunity 238-2007.

24"x36"/[609x914]
 P:\Projects\2005_05-0107-17_Elect\Drawings\CC5-48aE-007c-01-00.dwg - Tab: E-007 - Jun 01, 2007 - 4:55pm - User: Name: G.Nelson