

SEWER SERVICE INFORMATION

ADDRESS	SIZE	PL TIE (SHORT/LONG)	JUNCTION TIE	REMARKS
1139 WINDERMERE AV				NO INFO
1142 WINDERMERE AV				NO INFO
1146 WINDERMERE AV				NO INFO
1201 WINDERMERE AV				NO INFO
1204 WINDERMERE AV				NO INFO
1206 WINDERMERE AV				NO INFO
1207 WINDERMERE AV				NO INFO
1208 WINDERMERE AV				NO INFO
1211 WINDERMERE AV				NO INFO
1212 WINDERMERE AV				NO INFO
1215 WINDERMERE AV				NO INFO

SEWER JUNCTION INFORMATION

REF. MH*	DIST FROM*	SIZE*	CLOCK AT*
MH60010984	13.4	1500	09
MH60010984	14.2	1500	03
MH60010984	28.1	1500	09
MH60010984	28.9	1500	03
MH60010984	36.0	1500	03
MH60010984	43.6	1500	09
MH60010984	51.2	1500	02
MH60010984	53.6	1500	10
MH60010984	66.7	1500	03
MH60010984	80.5	1500	03
MH60010984	81.3	1500	03
MH60010984	92.1	1500	09

*JUNCTION INFORMATION FROM VIDEO INSPECTION

WATER SERVICE INFORMATION

ADDRESS	DISTANCE PROPERTY	SIZE (mm) & TYPE	SHORT & LONG MEASUREMENT	CORPORATION LOCATION	CATHODIC PROTECTION	REMARKS
1139 WINDERMERE AV (RESIDENTIAL)	0.00	EEL HSE		NO INFO		
1142 WINDERMERE AV (RESIDENTIAL)	19	COPPER	2.44 EWL HSE	NO INFO		
1146 WINDERMERE AV (RESIDENTIAL)	3.35	EWL HSE		NO INFO		
1201 WINDERMERE AV (RESIDENTIAL)	4.27	EWL HSE		NO INFO		
1204 WINDERMERE AV (RESIDENTIAL)	3.05	EWL HSE		NO INFO		
1208 WINDERMERE AV (RESIDENTIAL)	25.91	W OF HYD AT 1142		NO INFO		
1207 WINDERMERE AV (RESIDENTIAL)	0.91	WEL HSE		NO INFO		
1207 WINDERMERE AV (RESIDENTIAL)	1.22	WEL HSE		NO INFO		
1208 WINDERMERE AV (RESIDENTIAL)	0.61	EEL HSE		NO INFO		CPLG 0.31 FROM SC PROP SIDE.
1211 WINDERMERE AV (RESIDENTIAL)	0.00	EEL HSE		NO INFO		
1212 WINDERMERE AV (RESIDENTIAL)	0.61	WEL HSE		NO INFO		MAY/00 - RENEWED SERVICE BOX
1215 WINDERMERE AV (RESIDENTIAL)	19	COPPER	0.00 EEL HSE	NO INFO		SC UNDER ASPH CAP

- CONSTRUCTION NOTES:**
- INSTALL NEW SEWER BY TRENCHLESS METHODS.
 - RENEW SEWER SERVICES TO PROPERTY LINE.
 - ALL SEWER AND WATER SERVICES TO BE LOCATED IN THE FIELD BY THE CONTRACTOR.
 - ABANDON EXISTING SEWER AND SEWER SERVICES.

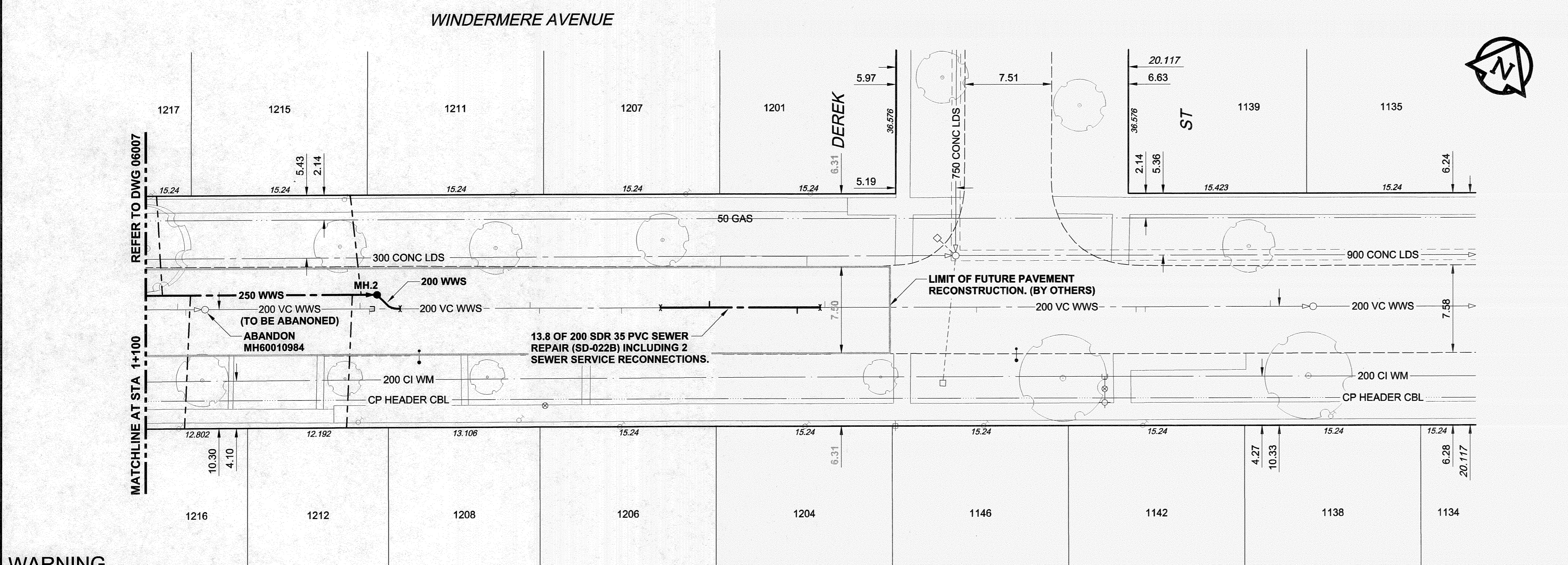

WARNING
 IF POWER EQUIPMENT OR EXPLOSIVES ARE TO BE USED FOR EXCAVATION ON THIS PROJECT, THE CONTRACTOR MUST:
 1) NOTIFY THE GAS COMPANY OF THE PROPOSED LOCATION OF EXCAVATION.
 2) TAKE PRECAUTION TO AVOID DAMAGE TO GAS COMPANY INSTALLATIONS.
 SEE PROVINCIAL REGULATION 140/92 FOR DETAILS

EXISTING	LEGEND - PLAN	NEW	EXISTING	LEGEND - PLAN	NEW	EXISTING	LEGEND - PROFILE	NEW
150 WM	WATERMAIN	150 WM	CURB STOP	150 WM	WATERMAIN	150 WM	WATERMAIN	150 WM
300 LDS	LAND DRAINAGE SEWER	300 LDS	REDUCER	300 LDS	HYDRANT	300 LDS	HYDRANT	300 LDS
250 WWS	WASTE WATER SEWER	250 WWS	COUPLING	250 WWS	VALVE	250 WWS	VALVE	250 WWS
MANHOLE	MANHOLE	ANODE	HYDRO	ANODE	LAND DRAINAGE SEWER	MANHOLE	LAND DRAINAGE SEWER	MANHOLE
CATCH BASIN	CATCH BASIN	MTS	TESTHOLE	MTS	WASTE WATER SEWER	CATCH BASIN	WASTE WATER SEWER	CATCH BASIN
CURB INLET	CURB INLET	GAS	LAMP STANDARD	GAS	PAVEMENT CROWN	CURB INLET	PAVEMENT CROWN	CURB INLET
CULVERT	CULVERT	TESTHOLE	TREE	TESTHOLE	N/W PROPERTY LINE	CULVERT	N/W PROPERTY LINE	CULVERT
PIPE ABANDONMENTS	PIPE ABANDONMENTS	LAMP STANDARD		LAMP STANDARD	S/E PROPERTY LINE	PIPE ABANDONMENTS	S/E PROPERTY LINE	PIPE ABANDONMENTS
SURVEY BAR	SURVEY BAR	TREE		TREE	N/W GUTTER	SURVEY BAR	N/W GUTTER	SURVEY BAR
					S/E GUTTER		S/E GUTTER	

LOCATION APPROVED UNDERGROUND STRUCTURES

SUPR. U/G STRUCTURES DATE COMMITTEE

NOTE:
 LOCATION OF UNDERGROUND STRUCTURES AS SHOWN ARE BASED ON THE BEST INFORMATION AVAILABLE. BUT NO GUARANTEE IS GIVEN THAT ALL EXISTING UTILITIES ARE SHOWN OR THAT THE GIVEN LOCATIONS ARE EXACT. CONFIRMATION OF EXISTENCE AND EXACT LOCATION OF ALL SERVICES MUST BE OBTAINED FROM THE INDIVIDUAL UTILITIES BEFORE PROCEEDING WITH CONSTRUCTION.

BM 65-016 ELEV 233.024m

N. side Windermere Ave., E. of Daniel St., Tbt. in S. Conc. foundation of No. 1229 Windermere Ave. 7.0m W. & 0.3m below brick of S.E. Cor. of Church.

NO.	REVISIONS	DATE	BY
0	ISSUED FOR CONSTRUCTION	07/03/22	ADL

METRIC
 WHOLE NUMBERS INDICATE MILLIMETRES
 DECIMALIZED NUMBERS INDICATE METRES

© 2006 UMA ENGINEERING LTD. ALL RIGHTS RESERVED.

DESIGNED BY	ALD	CHECKED BY	MJR
DRAWN BY	ADL	APPROVED BY	<i>[Signature]</i>
HOR. SCALE	1:250	RELEASED FOR CONSTRUCTION	<i>[Signature]</i>
VERT. SCALE	1:50	DATE	07/03/22

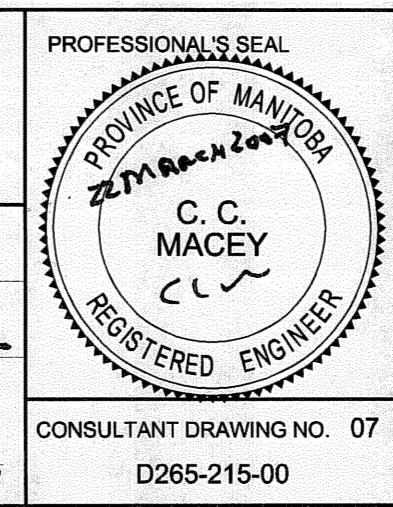
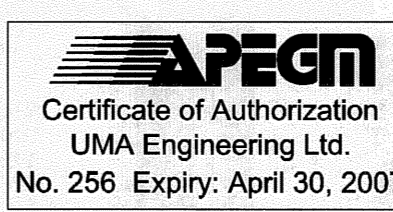

THE CITY OF WINNIPEG
 WATER AND WASTE DEPARTMENT

2007 Watermain and Sewer Renewals
 Contract 26

Windermere Avenue
 Match Line 1+100 to Derek Street

SHEET 07 OF 10
 CITY DRAWING NUMBER 06008 REV 0

BID OPPORTUNITY NO. 223-2007