

235.40
235.30
235.20
235.10
235.00
234.90
234.80
234.70
234.60
234.50
234.40
234.30
234.20
234.10
234.00
233.90
233.80
233.70
233.60
233.50
233.40
233.30
233.20

235.40
235.30
235.20
235.10
235.00
234.90
234.80
234.70
234.60
234.50
234.40
234.30
234.20
234.10
234.00
233.90
233.80
233.70
233.60
233.50
233.40
233.30
233.20

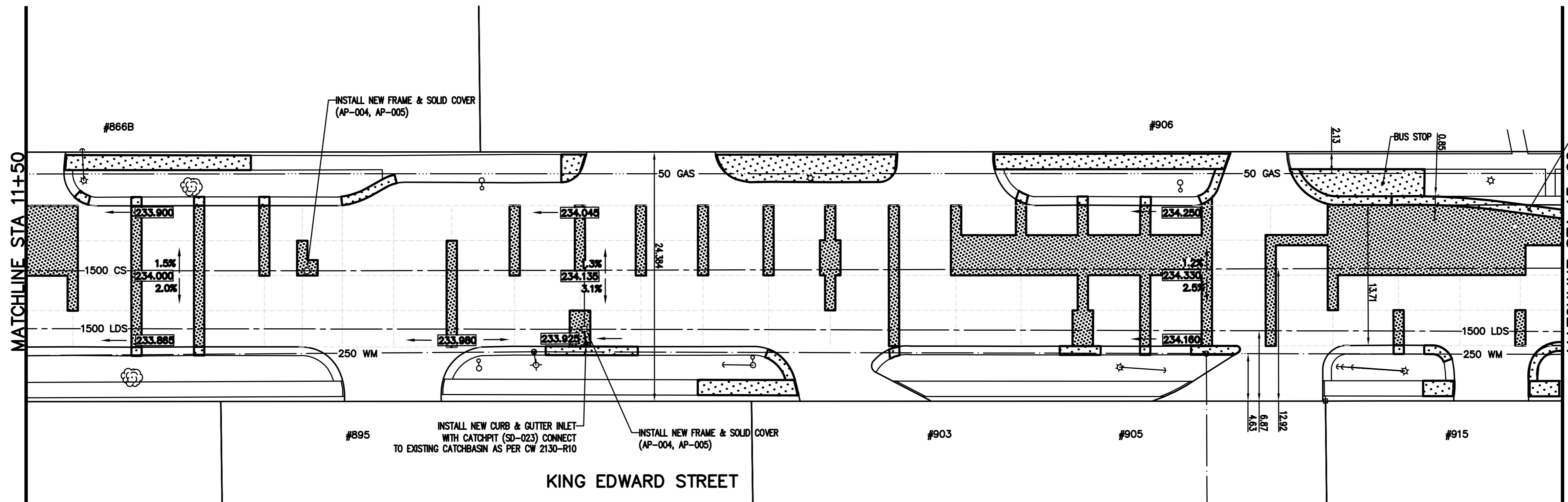
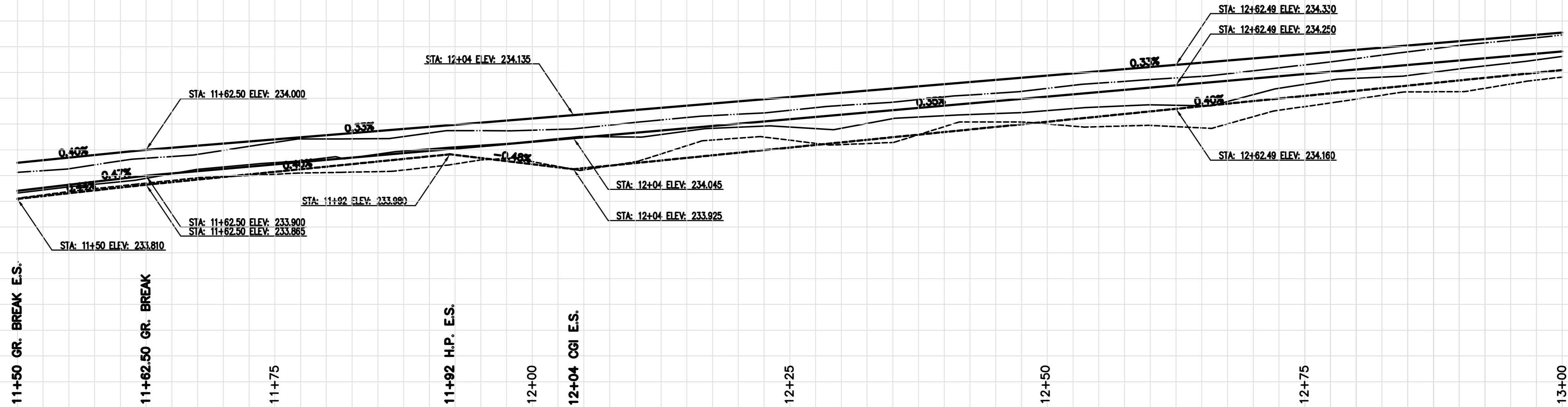

- CONSTRUCTION NOTES**
- 1) CURB REPLACEMENT AS DIRECTED BY THE CONTRACT ADMINISTRATOR
 - 2) ALL STREET RADIUS CURB UNDER 15M RADIUS SHALL BE REPLACED AS MODIFIED OR AS DIRECTED BY THE CONTRACT ADMINISTRATOR
 - 3) PAVEMENT REPAIRS SHOWN ARE ONLY A REPRESENTATIVE SAMPLE OF THE TENDERED QUANTITIES
 - 4) ASPHALT TIE-INS ON APPROACHES TO BE DETERMINED IN THE FIELD BY THE CONTRACT ADMINISTRATOR.
 - 5) ALL BULLNOSES TO HAVE SLOPED FACE.

WARNING

IF POWER EQUIPMENT OR EXPLOSIVES ARE TO BE USED FOR EXCAVATION ON THIS PROJECT THE CONTRACTOR MUST:

- 1) OBTAIN CLEARANCE FROM THE GAS UTILITY PRIOR TO EXCAVATION.
- 2) TAKE PRECAUTION TO AVOID DAMAGE TO GAS UTILITY INSTALLATIONS.

SEE PROVINCIAL REGULATION 210/72 FOR DETAILS

METRIC
WHOLE NUMBERS INDICATE MILLIMETRES
DECIMALIZED NUMBERS INDICATE METRES

BID OPPORTUNITY NO. 19-2007

150 mm WM	WATERMAIN	150 mm WM	HYDRO	WEST GUTTER	LOCATION APPROVED	B.M. ELEV.	CBM 38-014 234.539	TRANSPORTATION ENGINEERING DIVISION TECHNOLOGY SERVICES BRANCH 106 - 1155 PACIFIC AVE	ENGINEER'S SEAL 	THE CITY OF WINNIPEG PUBLIC WORKS DEPARTMENT	KING EDWARD STREET FROM DUBLIN AVENUE TO ELLICE AVENUE ASPHALT RESURFACING AND ASSOCIATED WORKS FROM STA. 11+50 TO STA. 13+00	CITY DRAWING NUMBER SE-07-8 SHEET 8 OF 13
					DESIGNED BY: A.P. CHECKED BY: B.K. / A.P. DRAWN BY: R.M. APPROVED BY: L.P.D.	HOR. SCALE: 1 : 250 VERTICAL: 1 : 10 DATE: 2007/01/25	ORIGINAL SIGNED BY L.P.D. FEBRUARY 6/07					
					SUPR. U/G STRUCTURES COMMITTEE DATE NOTE: LOCATION OF UNDERGROUND STRUCTURES AS SHOWN ARE BASED ON THE BEST INFORMATION AVAILABLE. BUT NO GUARANTEE IS GIVEN THAT ALL EXISTING UTILITIES ARE SHOWN OR THAT THE GIVEN LOCATIONS ARE EXACT. CONFIRMATION OF EXISTENCE AND EXACT LOCATION OF ALL SERVICES MUST BE OBTAINED FROM THE INDIVIDUAL UTILITIES BEFORE PROCEEDING WITH CONSTRUCTION.	NO. REVISIONS DATE BY						