

- L = 1450 m W = 8.5 m A = 15375 m²
TYPE - MAJOR REHABILITATION
- CONSTRUCTION NOTES:**
- CONTRACTOR SHALL TAKE PRECAUTIONARY STEPS TO AVOID DAMAGE FROM CONSTRUCTION ACTIVITIES TO EXISTING BOULEVARDS AND TREES WITHIN THE LIMITS OF CONSTRUCTION.
 - LOCATION OF EXISTING SERVICES ARE TO BE CONFIRMED IN THE FIELD BY THE CONTRACTOR.
 - TIE-INS TO BE VERIFIED IN THE FIELD BY THE CONTRACT ADMINISTRATOR.
 - BOULEVARD REPLACEMENT TO BE FINALIZED IN THE FIELD AS DIRECTED BY THE CONTRACT ADMINISTRATOR.
 - PLACE EXISTING ASPHALT OVERLAY WITHIN CONTRACT LIMITS TO DEPTH INDICATED BY THE CONTRACT ADMINISTRATOR. NOT ALL AREAS WILL REQUIRE PLANING.
 - CURB AND GUTTER REPLACEMENT TO BE FINALIZED IN THE FIELD AS DIRECTED BY THE CONTRACT ADMINISTRATOR.
 - JOINT AND SLAB REPAIRS TO BE FINALIZED IN THE FIELD AS DIRECTED BY THE CONTRACT ADMINISTRATOR.
 - STATIONING ALONG SOUTH GUTTER UNLESS NOTED OTHERWISE.
 - GRANULAR BOULEVARD TO BE REGRADED AS DIRECTED BY THE CONTRACT ADMINISTRATOR.

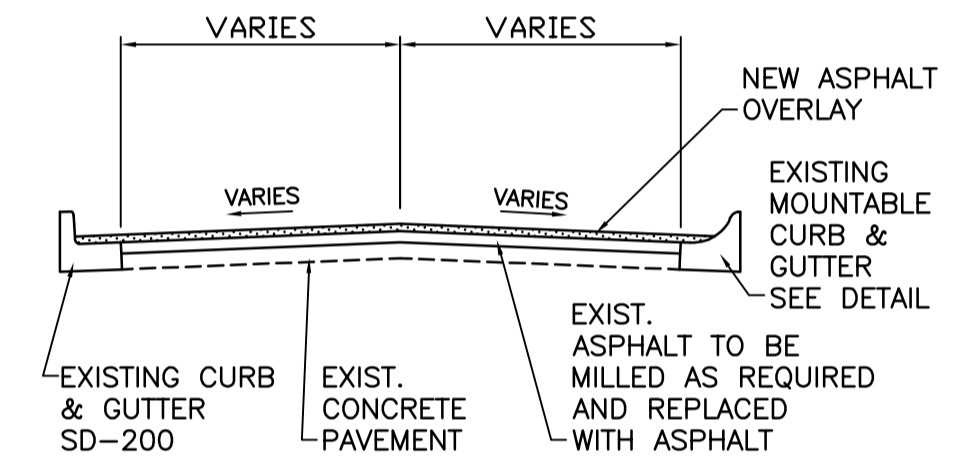

CONCRETE ROAD WITH CONCRETE CURB & GUTTER
N.T.S.

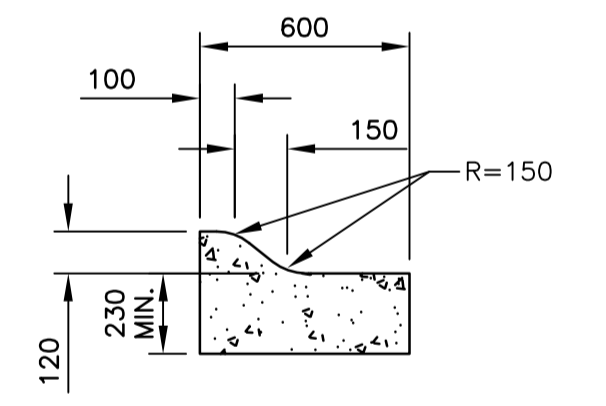

MOUNTABLE CURB & GUTTER
N.T.S.

METRIC
WHOLE NUMBERS INDICATE MILLIMETRES
DECIMALIZED NUMBERS INDICATE METRES

WARNING

- IF POWER EQUIPMENT OR EXPLOSIVES ARE TO BE USED FOR EXCAVATION ON THIS PROJECT THE CONTRACTOR MUST:
- NOTIFY THE GAS COMPANY OF THE PROPOSED LOCATION OF EXCAVATION.
 - TAKE PRECAUTION TO AVOID DAMAGE TO GAS COMPANY INSTALLATIONS
SEE PROVINCIAL REGULATION 210/72 FOR DETAILS

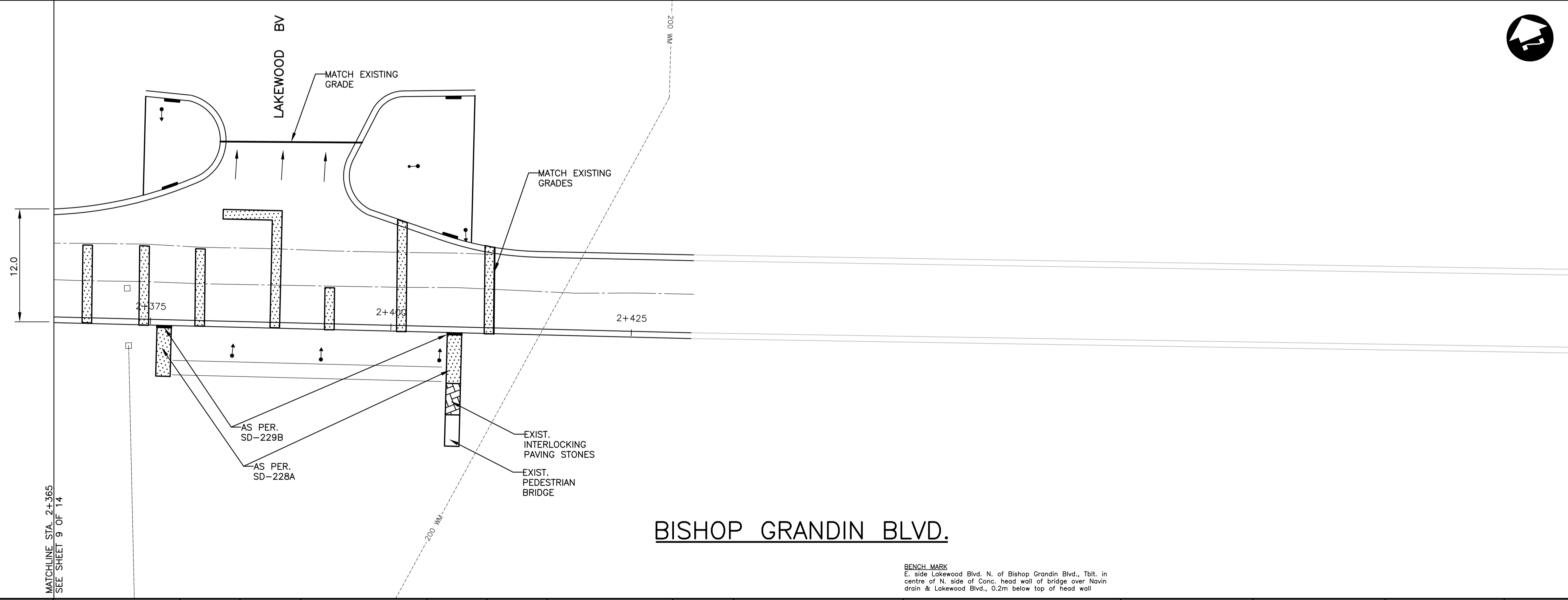

BISHOP GRANDIN BLVD.

BENCH MARK
E. side Lakewood Blvd. N. of Bishop Grandin Blvd., Tblt. in centre of N. side of Conc. head wall of bridge over Navin drain & Lakewood Blvd., 0.2m below top of head wall

150 mm W.M.	WATERMAIN	150 mm W.M.	HYDRO	150 mm W.M.	WATERMAIN	150 mm W.M.	UNDERGROUND STRUCTURES	B.M. ELEV. 55-017 232.537m	DESIGNED BY TJP		ENGINEER'S SEAL	
300 mm L.D.S.	HYDRANT VALVE	300 mm L.D.S.	M.T.S. CONCRETE	300 mm L.D.S.	HYDRANT VALVE	300 mm L.D.S.	DATE	DRAWN BY PMW	PROVINCE OF MANITOBA ORIGINAL STAMPED BY T.J. PETERS JUNE 4/07 Member 22309 REGISTERED PROFESSIONAL ENGINEER			
250 mm W.W.S.	LAND DRAINAGE SEWER	250 mm W.W.S.	ASPHALT	250 mm W.W.S.	WASTE WATER SEWER	250 mm W.W.S.	SUPPLY U/G STRUCTURES COMMITTEE	CHECKED BY DBW	RELEASED FOR CONSTRUCTION ORIGINAL SIGNED BY: KEN TURKO			
250 mm W.W.S.	WASTE WATER SEWER	250 mm W.W.S.	PLANING	250 mm W.W.S.	WASTE WATER SEWER	250 mm W.W.S.	NOTE:	APPROVED BY ORIGINAL SIGNED BY: DPK	CONSULTANT PROJECT NO. 07-7371-2000			
	MANHOLE		PAVING STONES		WASTE WATER SEWER		LOCATION OF UNDERGROUND STRUCTURES AS SHOWN ARE BASED ON THE BEST INFORMATION AVAILABLE. BUT NO GUARANTEE IS GIVEN THAT ALL EXISTING UTILITIES ARE SHOWN OR THAT THE GIVEN LOCATIONS ARE EXACT. CONFIRMATION OF EXISTENCE AND EXACT LOCATION OF ALL SERVICES MUST BE OBTAINED FROM THE INDIVIDUAL UTILITIES BEFORE PROCEEDING WITH CONSTRUCTION.	HOR. SCALE 1:250	RELEASING OFFICER'S SIGNATURE	CITY DRAWING NUMBER P-3284-10		
	CATCH BASIN		PARTIAL DEPTH REPAIR		WASTE WATER SEWER			VERTICAL 1:10	DATE MAY 2007	SHEET 10 OF 14		
	CURB INLET		PROPERTY LINE		WASTE WATER SEWER					STA: 2+365 TO STA: 2+466		
	JUNCTIONS		SURVEY BAR		WASTE WATER SEWER							
	CULVERT		PARAPLEGIC RAMP		WASTE WATER SEWER							
	GAS				WASTE WATER SEWER							
EXISTING	LEGEND-PLAN	PROPOSED	EXISTING	LEGEND-PLAN	PROPOSED	EXISTING	LEGEND-PROFILE	PROPOSED				